

Copy of letter sent by P.O.G. after Mr. Davis asked an opinion if

Mr. W. Jefferson Davis
530 W. 6th St.
Los Angeles, Cal.

Dear Mr. Davis:

Present condition would justify the creation of an Oil Station on his prop. at Junction of Highway 80 & Peutz Valley road.

Letter of 5/24/37 refers to contacting Hollywood interest re-sale of entire complex to sportsmen for private resort, as proposed by W.S.D.

After our conversation on Sunday last I reviewed the letter written to you July 28 1937 to the contents of which only little need to be added.

The traffic coming out and over the Peutz Valley road to Highway 80 is of little value, because only some 7 people use this road and several of them seem to be on relief.

Besides, the road itself is all that a traffic artery should not be, it is narrow, unbelievable steep, sharp turns abound without drainage and contains two rickety wooden bridges without actual need, for they only add a further hazard.

But (as far as traffic is concerned) should it be possible to have the road opened up, down to the lake level and for a start connected with the road from Lakeside to the Dam, then if well constructed and safe, it would be a scenic drive beyond compare so close to San Diego and Sunday drivers to the number of several hundred would pass that way and an oil station would be a profitable undertaking than.

Now there are three ways to bring this desirable state about, First: by all private action where a company would own all adjacent land with a complex of store, ect. on the highway, and a resort at the lake, with homes or cabin sites between. Second: by having the authorities undertake this as a recreational project.

Third: by bringing about sufficient joint action to have the present county road into Peutz Valley realigned and re-built (swinging as low as possible in going thru the Griffin - property) and let the present badly built roads to the lake serve for those of us that live that way (Shattuck-Gottschling) and wait until the city finally constructs the road from the Dam to the upper valley where Mr. Fletcher owns some 250 acres. The City is legally obligated to build that road for the Forest Service - if not for the people residing in that section, which in a high handed manner they do not wish to do.

I have been out again today and found the county road crew working, dragging the roadbed, because since the abandonment by Dr. Hodges of the Nude Camp idea, a new buyer of that property, with a new owner of the Benton place a mile further, have had sufficient pull to have that much done.

But it is still terrible up and down and shows of course that the authorities have no intentions of providing

us voluntarily with that loop road-highway 80-lake shore-to dam-site which would justify any sort of development either at your place or mine unless, you can unlimber bigger guns than I can at this end.

Now as to options: this is evidently a poor time to do much inquiring; Mr. Shattuck is a subdivider himself, he will not sell but he is not necessary to our plan.

Griffith, who has a really fine place (lots more trees than you or I have) wants to make a camp himself and only Wiley would sell part of the land east of the creek at any time, at about \$20 per acre.

Now you are in possession of ~~the~~ the present status of this project and it is yours now to see if there is any meat in it some way.

Enclosed find sketch map which will give you a graphic picture of the lay-out.

Yours truly

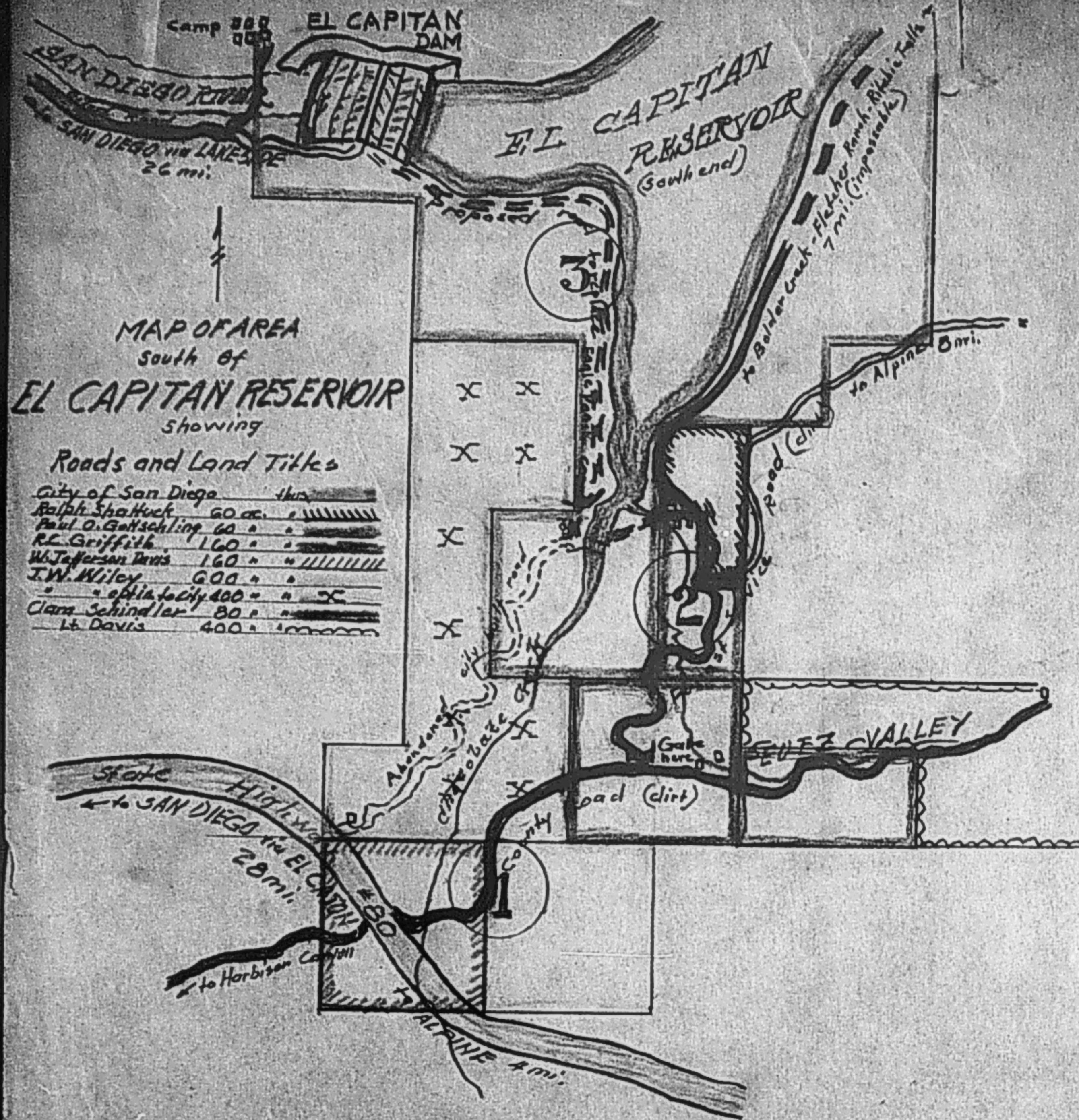

ROAD LEGEND

- ① County road total length 2 1/2 miles, to gate 1 1/2 miles
- ② Semi private, U.S. Forest Service built road, total length - Gate to Lake - 1 1/2 miles
- ③ Foot of Forest Service road to Dam 2 miles, no work done to date, but the city is obligated to replace the Flooded Area section of the old Eagle Peak County road to Julian, the road itself was definitely not vacated.

#2 El Capitan
 Col. Fletcher
 return

Answer to letter of 16th by P.O.A.

WARREN JEFFERSON DAVIS
 ATTORNEY AND COUNSELOR
 880 WEST 60TH STREET
 LOS ANGELES, CALIFORNIA

November 17, 1939

Mr. Paul O. Gottschling,
 3074 O St., San Diego.

Dear Mr. Gottschling:-

I have your interesting letter of the 16th, with map enclosed; have also received a letter from Ed Fletcher in the same mail.

May I suggest that you take Col. Fletcher a similar map, which will give him the picture of this project better than through correspondence, and after he sees what we contemplate, ask him to write me.

I have someone in mind for this development, if we can get the proper kind of road built. Col. Fletcher can be quite helpful to us and to himself too for that matter.

Write me again please after you have seen Col. Fletcher.

Very sincerely yours,

Warren Jefferson Davis

D-SS

#3
Correspondence
Folder

Copy of W. J. D. letter to Senator Fletcher

November 17, 1939

Col. Ed Fletcher,
San Diego.

My dear Senator:-

Mr. Paul O. Gottschling, of San Diego, has prepared a very good map showing his property, that owned by you, and my own acreage on highway 80. I have asked him to call on you; show you this map, and just what I propose in the way of increased highway facilities. After he has seen you, I would appreciate your writing me what you think can be done.

With kind personal regards,

Sincerely your friend,

D-SS

W. Jefferson Davis.

Ed Fletcher Papers

1870-1955

MSS.81

Box: 6 Folder: 19

General Correspondence - Davis, W. Jefferson



Copyright: UC Regents

Use: This work is available from the UC San Diego Libraries. This digital copy of the work is intended to support research, teaching, and private study.

Constraints: This work is protected by the U.S. Copyright Law (Title 17, U.S.C.). Use of this work beyond that allowed by "fair use" requires written permission of the UC Regents. Permission may be obtained from the UC San Diego Libraries department having custody of the work (<http://libraries.ucsd.edu/collections/mscl/>). Responsibility for obtaining permissions and any use and distribution of this work rests exclusively with the user and not the UC San Diego Libraries.