

# FACTS ABOUT IMPERIAL VALLEY, IMPERIAL COUNTY, CAL.

187 Miles from Los Angeles, 120 Miles from San Diego Famous Throughout the United States as a Phenomenal Crop Producer

**Elevation** is from 2 to 126 feet below sea level.

**Climate** No snows and less than one inch of rain a year, and this is not needed, as conditions are better without it.

**Cold versus Heat** The lowest temperature recorded is 24 degrees above zero. In July and August the temperature rises to about 110 degrees in the shade, but with no humidity, all occupations and pursuits are carried on, and everybody is happy.

**Population** 1914 (County Directory figures), 37,000. The population thirteen years previous was nothing.

**Assessed Valuations** 1914, about twenty-four millions.

**Land Under Irrigation** Four hundred thousand acres.

**Products of the Land** The following statement is from the report of R. G. DUN, whose facts may be depended upon as authentic:

"Imperial county, which twelve or thirteen years ago was barren, has produced crops this year amounting to from \$10,000,000 to \$11,000,000, the principal items being 25,000 bales of cotton, \$1,530,000; 1300 carloads of cattle, \$1,137,000; 3419 carloads of cantaloupes, \$2,136,875; 540 carloads of hogs, \$697,600; 5,000,000 pounds of butter, \$1,500,000; hay, \$788,100."

**Imperial Valley Churches** Imperial Valley has churches of every denomination and creed, organizations, societies and hospitals, asphalt streets, thirteen national and state banks, electric light and gas plants.

**Good Roads** The Valley has hundreds of miles of good roads, and these are constantly being improved.

**Telephone Connection** in and out of the Valley is unusually good for a new system, and a large sum of money is now being expended to make the system the best.

**Real Estate Valuations** A TIP TO THE WISE is that Imperial Valley land values should be investigated.

**A Trip to the Pacific Coast** without seeing the great Imperial Valley would be doing yourself a great injustice. Eight hours out of Los Angeles, via Southern Pacific Ry. or eight hours out of San Diego, via Automobile and you are there—Make the trip.

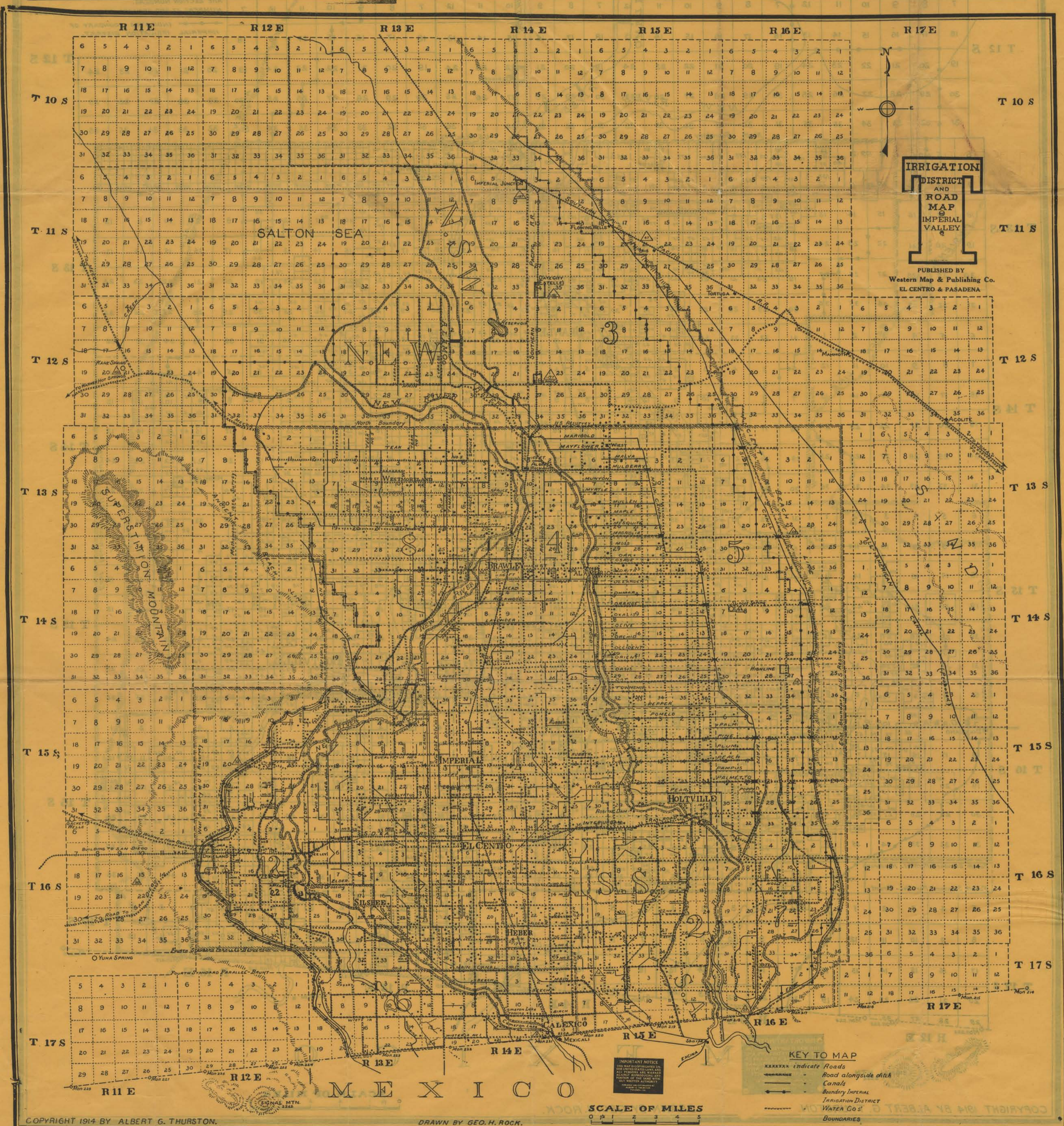

R 12 E

R 13 E

R 14 E

R 15 E

R 16 E

T 11 S

T 12 S

T 13 S

T 14 S

T 15 S

T 16 S

T 17 S

T 11 S

T 12 S

T 13 S

T 14 S

T 15 S

T 16 S

T 17 S

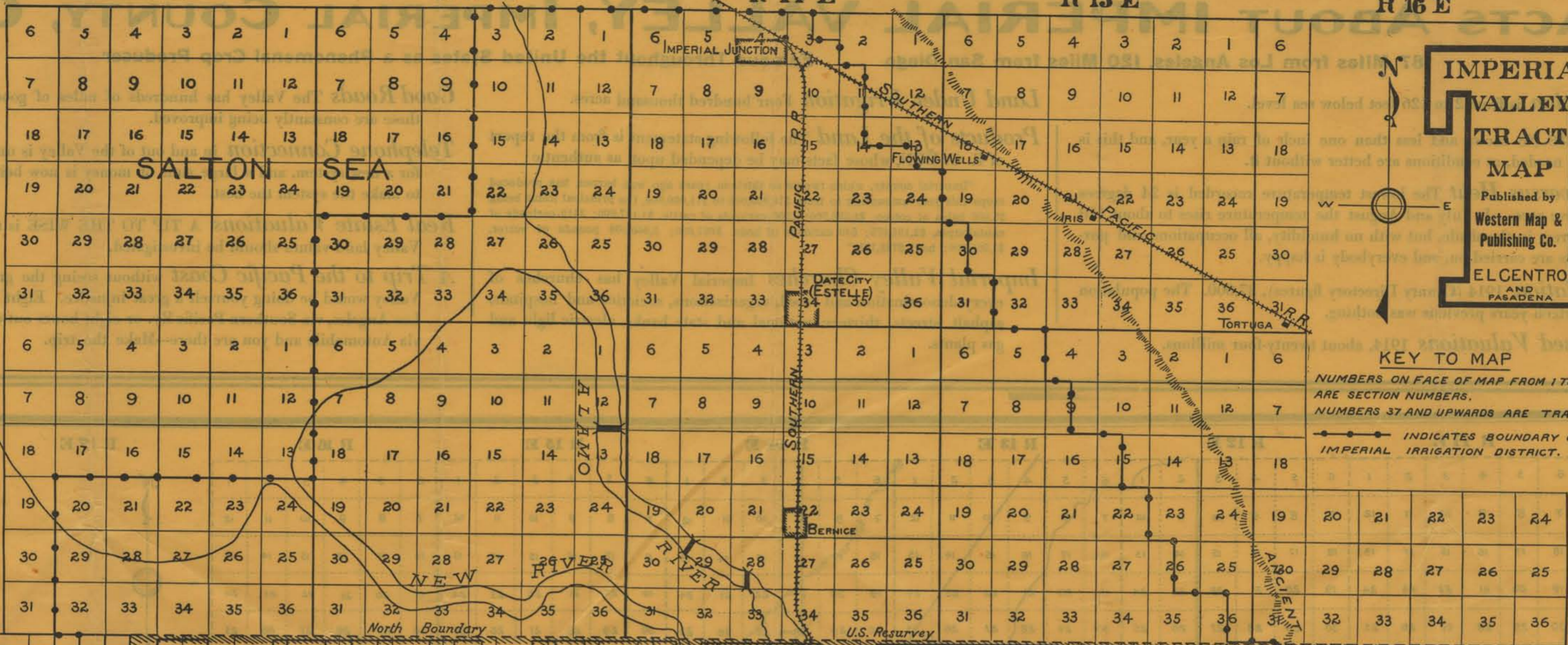

**IMPERIAL VALLEY TRACT MAP**  
 T 11 S  
 Published by Western Map & Publishing Co.  
 EL CENTRO AND PASADENA

**KEY TO MAP**  
 NUMBERS ON FACE OF MAP FROM 1 TO 36 INCLUSIVE ARE SECTION NUMBERS.  
 NUMBERS 37 AND UPWARDS ARE TRACT NUMBERS.  
 ——— INDICATES BOUNDARY OF IMPERIAL IRRIGATION DISTRICT.

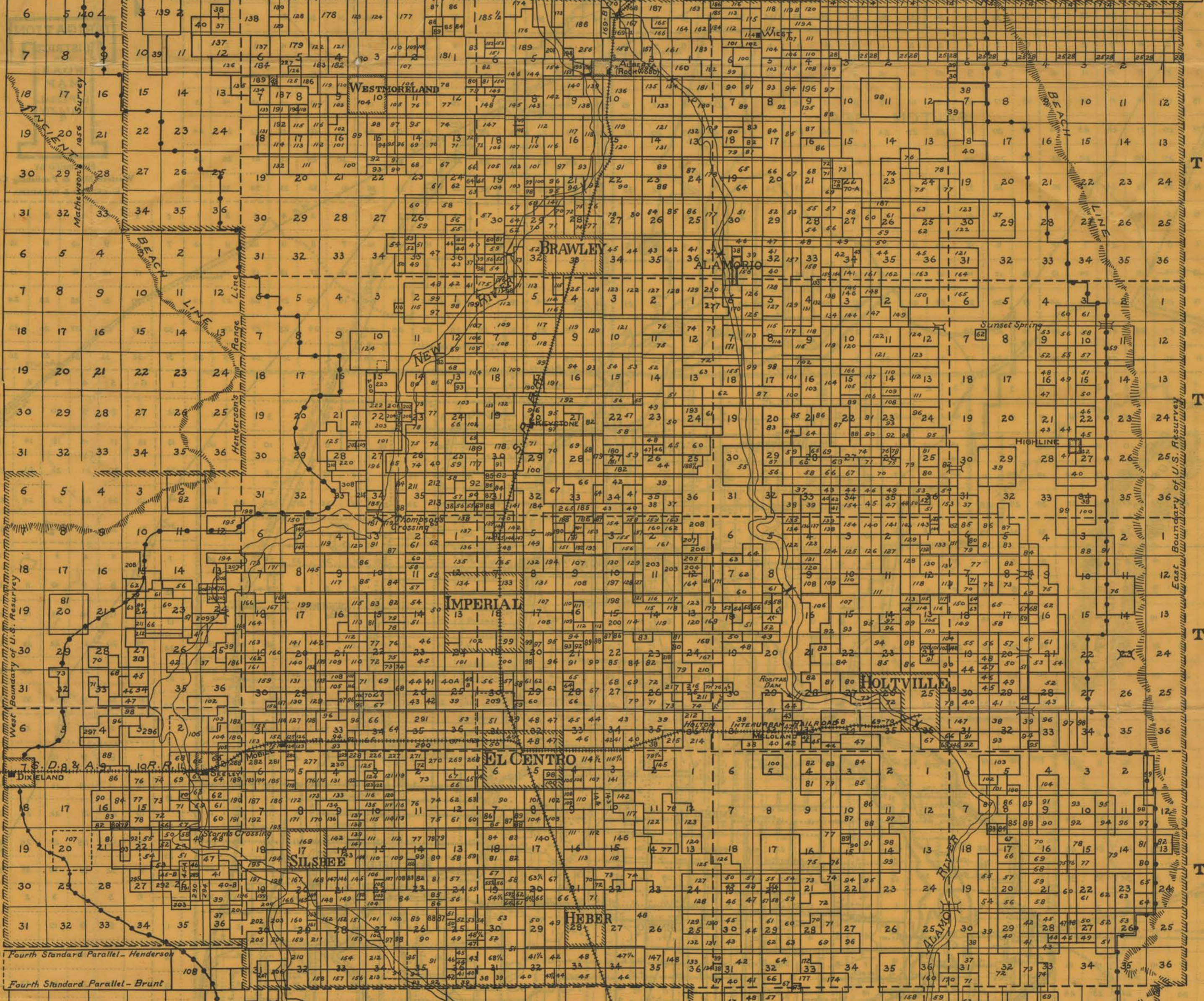

**IMPORTANT NOTICE**  
 THIS MAP IS COPYRIGHTED UNDER UNITED STATES LAWS, AND ALL PERSONS ARE WARNED AGAINST REPRODUCING ANY PORTION OF THE SAME WITH OUT WRITTEN AUTHORITY.  
 PUBLISHED AND COPYRIGHTED BY ALBERT G. THURSTON, PASADENA, CALIF.

M E X I C O

