

FIELD NOTES

of

T. 10 S. R. 3 E. S.B.M.

Pages 34 to 91

Contains a few San Jose del Valle Corners
22 etc.

Map 391 G.I.

May 10 1914

R. 3 E. 3

34

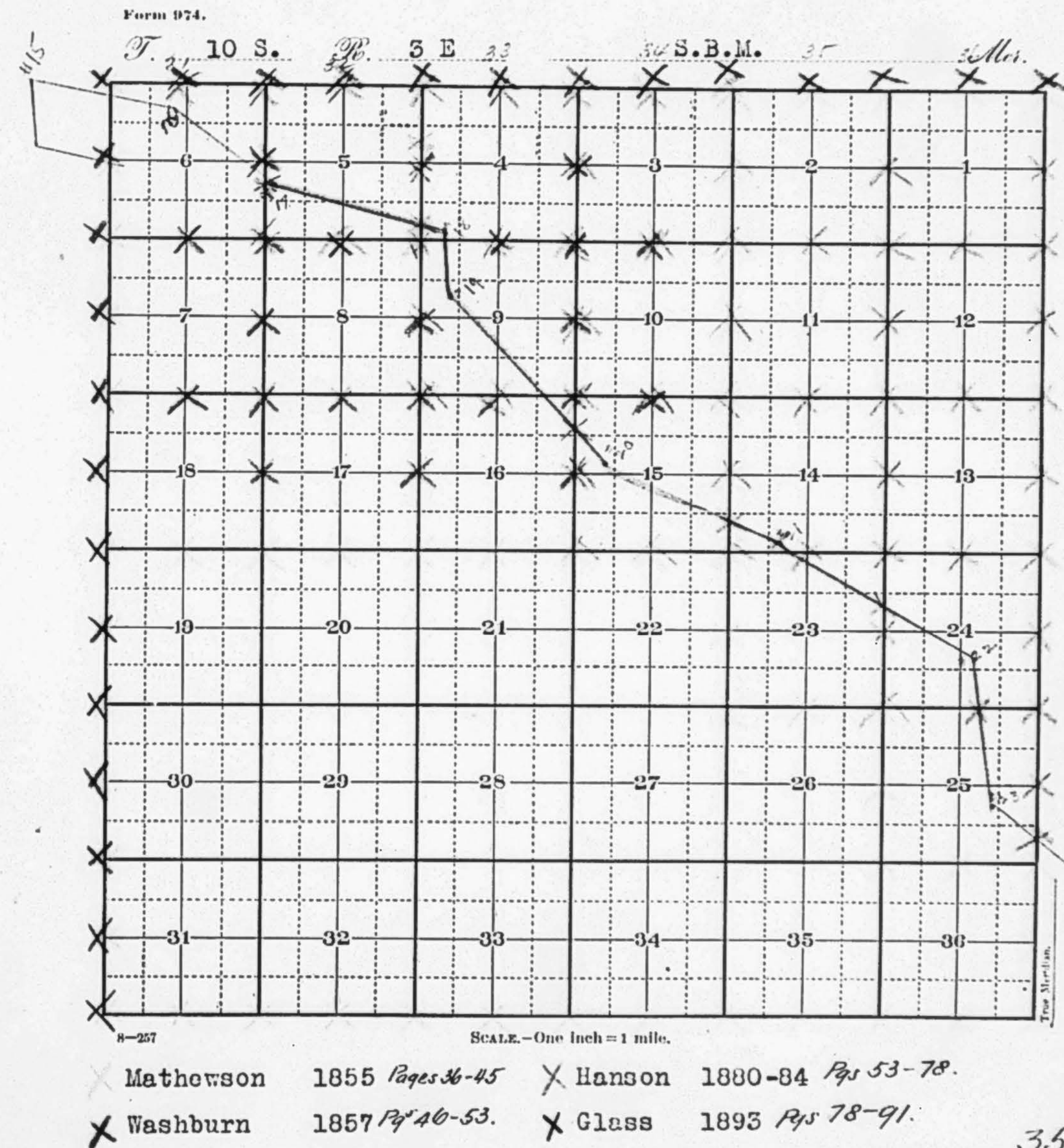

35

(E.B. T. 9 S. R. 2 E. S. .M.

Va. 13° 30' E.

South bet. secs. 31, 36, 6th Mile

80.00 Set town post cor. to Ts. 9, 10 S. Rs. 2, 3, E., in md. of
✓ earth with trench and pits as per inst.

Very rough rocky, brushy and broken mountains.

It being impracticable to run W. from this cor. on account of
high mountains and deep canons, continued

E.B. T. 10 S. R. 2 E. S.B.M.

South on E.B. of T. 10 S. R. 2 E.

Va. 13° 30' E.

1st Mile

South bet. secs. 1, 6.

40.00 Set 1/4 sec. post in md. of earth with trench and pits as per
✓ inst.

80.00 Set sec. post, cor. secs. 1, 6, 7, 12, md. of earth with trench,
and pits as per inst.

Broken, rocky and brushy mountains.

2nd. Mile

South bet. secs. 7, 12.

40.00 ✓ Set 1/4 sec. post in md. of earth with trench, &c., as per inst.

80.00 Set sec. post, cor. secs. 7, 12, 13, 18, in md. of earth with
trench and pits as per inst.

1.

(E.B. T. 10 S. R. 2 E. S.).M.

3rd Mile.

South bet. secs. 13, 18.

10.00 Cross wagon road from Temecula to Warner's ranch, brs. SE.

40.00 Set 1/4 sec. post in md. of earth with trench, &c., as per inst.

80.00 ✓ Set sec. post, cor. secs. 13, 18, 19, 24, in md. of rock on low
mountain spur N. of Warners Valley, mountain spurs sloping S.

4th Mile.

South bet. secs. 19, 24.

21.00 Leave mountains and enter Warners Valley.

40.00 Set 1/4 sec. post in md. of earth with trench, &c. as per inst.

80.00 ✓ Set sec. post, cor. secs. 19, 24, 25, 30, in mound of earth, &c.,
from which a

Willow bush 3 ins. brs. S. 35° E. 60 lks.

1st rate, level land with good grass.

5th Mile.

✓ South bet. secs. 25, 30.

33.00 Cross dry bed of branch of San Luis Rey river, 50 lks. wide, co. SW.

40.00 Set 1/4 sec. post in md. of earth with trench, &c. as per inst.

80.00 Set sec. post, cor. secs. 25, 30, 31, 36, in md. of earth with
trench and pits as per inst.

Land partly 1st rate, partly 2nd rate, with good grazing.

6th Mile.

South bet. secs. 31, 36.

40.00 Set 1/4 sec. post in md. of earth with trench, &c. as per inst.

2.

E.B. T. 10 S. R. 2 E S.B.M.

47.00 A spring of good water.
72.00 Cross road San Jose to La Puertade Cruz.
80.00 Set Tp. post, cor. Ts. 10, 11 S., Rs. 2, 3, E. in md. of earth
with trench and pits as per inst.
Land level, 2nd rate, wigh good grass, but destitute of timber.
June 15th.

E.B. T. 9 S. R. 3 E. S.B.M.

6th Mile

South bet. secs. 31, 36.

Va. 13° 30' E.

✓
80.00 Set Tp. post, cor. Ts. 9, 10 S. Rs. 3, 4, E. in md. of earth and
rock with trench, pits, and charcoal, as per inst.
Same as last mile . (Rough, rocky and brushy mountain).
June 23.

Thence ran

S.B. T. 9 S. R. 3 E. S.B.M.

West on S.B. of T. 9 S. R. 3 E., random line.

Va. 13° 30' E.

Ran W. 2 miles, thence S. to avoid impassable gulches and rough
spurs of mountains in crossing the Canon of one of the branches
of the San Luis Rey river, 3 miles; thence W. 4 miles and 72 lks.
setting tem. 1/4 sec. and sec. post, and intersected Meridian Line

S.B. T. 9 S. R. 3 E. S.B.M.

bet. Rs. 2, 3, at cor. secs. 13, 18, 19, 24.

June 25th.

Thence ran

EAST on offset in T. 10 S. R. 3 E. true line.

Va. 13° 30' E.

1st Mile.

✓ East bet. secs. 18, 19.

40.72 Set 1/4 sec. post in md. of earth with trench, &c. as per inst.

57.00 Cross Indian trail brs. NE.

74.00 Cross dry bed of branch of San Luis Rey river 3 chs. wide runs S.

80.72 Established cor. secs. 17, 18, 19, 20, on a black oak 10 ins. in
dia.

Rolling, sandy, land, 3d rate.

2nd Mile.

✓ East bet. secs. 17, 20.

17.00 Cross road from Temecula to Warner's ranch, about 5 chs. S. of the
Indian Rancheria of Puerta de Cruz.

40.00 Set 1/4 sec. post in md. of earth with trench, &c., as per inst.

80.00 Set sec. post, cor. secs. 16, 17, 20, 21, in md. of earth with
trench and pits as by inst.

Same as last mile.

3rd Mile.

✓ East bet. secs. 16, 21.

40.00 Set 1/4 sec. post in md. of rock as per inst.

(T. 10 S. R. 3 E. S.B(1.

80.00 Set sec. post, cor. secs. 15, 16, 21, 22, in md. of earth,
from which a
Black oak 36 ins. brs. S. 89° E. 4.20 lks.
Broken, worthless land in edge of Warners Valley at base of Mts.

4th Mile.

✓ East bet. secs. 15, 22.
40.00 Set 1/4 sec. post in md. of earth with trench, &c., as per inst.
80.00 Set sec. post, cor. secs. 14, 15, 22, 23, in md. of earth with
trench and pits as per inst.
Same as last mile.
Thence ran

1st Mile

✓ North bet. secs. 14, 15.
40.00 Set 1/4 sec. post in md. of rock as per inst.
80.00 Set sec. post, cor. secs. 10, 11, 15, 14, in md. of earth with
trench &c., as per inst.
Broken, brushy and rocky, slopes S.

2nd Mile

✓ North bet. secs. 10, 11.
40.00 Set 1/4 sec. post in md. of rock as per inst.
80.00 Set sec. post, cor. secs. 2, 3, 10, 11, in md. of rock as per inst.
Brushy and rocky mountainous.

(T. 10 S. R. 3 E. S.B.m.)

3rd Mile.

North bet. secs. 2, 3.
40.00 Set 1/4 sec. post in md. of rock as per inst.
80.00 Set sec. post, cor. secs. 2, 3, 34, 35, in mound of rock as per inst.
Same as last mile.
Thence ran

N.B. T. 10 S. R. 3 E. S.B.M.

5th Mile

✓ East bet. secs. 2, 35.
40.00 Set 1/4 sec. post in md. of earth with trench, &c., as per inst.
80.00 Set sec. post, cor. secs. 1, 2, 35, 36, in mound of rock as per inst.

6th Mile

✓ East bet. secs. 1, 36.
40.00 Set 1/4 sec. post in md. of rock as per inst.
80.00 To cor. Ts. 9, 10 S. Rs. 3, 4, E.
Rough, rocky, brushy mountains.

June 26.

T. 10 S. R. 3 E. S.B.M.

Finding it impracticable to run S. on E.B. of T. 10 S. R. 3 E.
from the Tp. cor. in consequence of inseparable obstacles in cross-
ing the canon of the main branch of the San Luis Rey river,
commenced June 27 at cor. secs. 14, 15, 22, 23, T. 10 S. R. 3 E.
Var. 15° 30' E. and ran

4th Mile

- ✓ South bet. secs. 22, 23.
- 35.00 Cross dry bed of main branch of San Luis Rey river, 50 lks. wide, runs SW.
- 40.00 Set 1/4 sec. post in md. of earth with trench, &c., as per inst.
- 65.00 Cross road from La Puerta de Cruz.
- Agua Caliente brs. E.
- 80.00 Set sec. post, cor. secs. 22, 23, 26, 27, in md. of earth, &c., from which a
- Black oak 30 in. brs. N. 30° E. 500 lks.
- Land rolling, broken, sandy and worthless.

5th Mile

- ✓ East bet. secs. 23, 26.
- 32.00 Cross Agua Caliente creek 5 lks. wide runs SW., water tepid.
- 40.00 Set 1/4 sec. post in md. of earth, &c., from which a
- Cottonwood 24 ins. brs. N. 10° W. 90 lks.
- 50.00 To NW. cor. of Ysabelus' house 5 chs. S. of the Indian Rancheria of Agua Caliente.
- 53.00 Cross Agua Caliente creek 5 lks. wide runs NW. Water hot.
- 80.00 Set sec. post, cor. secs. 23, 24, 25, 26, in md. of earth with trench and pits as per inst.
- Thence ran

5th Mile

South bet. secs. 25, 26.

- 2.50 ✓ Cross Agua Caliente creek 2 lks. wide runs W. about 3 chs. above the Agua Caliente Springs, water cold.
- 40.00 Set 1/4 sec. post in mound of earth with trench, &c. as per inst.
- 80.00 Set sec. post, cor. secs. 25, 26, 35, 36, in md. of earth with trench and pits as per inst.
- Broken, worthless land at base of mountain in E. edge of Warners Valley.
- Thence ran

6th Mile

- East bet. secs. 25, 36.
- 40.00 Set 1/4 sec. post in md. of earth with trench, &c. as per inst.
- 80.00 Set sec. post, cor. secs. 25, 30, 31, 36, in md. &c., from which a
- Black oak 18 ins. brs. S. 10° W. 100 lks.

6th Mile

- South bet. secs. 31, 36.
- 40.00 Set 1/4 sec. post in md. of rock as per inst.
- 49.00 Cross trail from Agua Caliente to San Ysidro brs. SE.
- 80.00 Set Tp. post cor. Ts. 10, 11 S. Rs. 3, 4, E. in md. of earth with trench, pits and charred stake as per inst., in edge of Warners Valley at base of mountain brs. NW. & SE.
- Land rolling, brushy, and broken.
- Thence ran

June 27.

S.B. T. 10 S. R. 3 E. S.B.M.

West on S.B. of T. 10 S. R. 3 E. random line.

Va. 13° 30' E.

Ran W. 6 miles and 96 lks., setting temp. 1/4 sec. and sec. post and intersected Meridian Line bet. Rs. 2, 3, at cor. Ts. 10, 11 S. Rs. 2, 3, E. Thence

East on S.B. of T. 10 S. R. 3 E. true line.

Va. 13° 30' E.

1st Mile

East bet. secs. 6, 31.

40.96 Set 1/4 sec. post in md. of earth with trench, &c. as per inst.

80.96 Set sec. post, cor. secs. 5, 6, 31, 32, in md. of earth with trench and pits as per inst.

2nd rate, undulating land with good grass.

2nd Mile

East bet. secs. 5, 32.

40.00 Set 1/4 sec. post in md. of earth with trench &c. as per inst.

80.00 Set sec. post, cor. secs. 4, 5, 32, 33, in md. of earth with trench and pits as per inst.

Same as last mile.

3rd Mile

East bet. secs. 4, 33.

24.00 Cross wagon road from Temecula to Warner's ranch brs. SE.

40.00 Set 1/4 sec. post in md. of earth with trench, &c., as per inst.

S.B. T. 10 S. R. 3 E. S.B.M.

80.00 Set sec. post, cor. secs. 3, 4, 33, 34, in md. of earth with trench and pits as per inst.

Same as last mile.

4th Mile

East bet. secs. 3, 34.

40.00 Set 1/4 sec. post in md. of earth with trench, &c. as per inst.

43.50 Cross trail from Auga Calienta to Buna Vista or Warner's old residence, which is about 60 chs. to the S.

80.00 Set sec. post, cor. secs. 2, 3, 34, 35, in md. of earth with trench and pits as per inst.

Same as last mile.

5th Mile.

East bet. secs. 2, 35.

40.00 Set 1/4 sec. post in md. of earth with trench, &c., as per inst.

80.00 Established cor. secs. 1, 2, 35, 36, by a stone 2 ft. high 5 ins. wide and 2 ins. thick in md. of earth with trench and pits as per inst.

Same as last mile.

6th Mile.

East bet. secs. 1, 36.

34.00 Cross trail from Agua Calienta to San Felipe brs. SE.

40.00 Set 1/4 sec. post in md. of earth with trench, &c., as per inst.

80.00 To cor. Ts. 10, 11 S. Rs. 3, 4, E.

S.B. T. 10 S. R. 3 E. S.B.M.

Land undulating with good bunch grass, the whole 6 miles destitute of timber.

June 28. 1855

R. C. MATHEWSON.

Vol. 173-14

T. 10 S. R. 3 E. S.B.M.

Commenced at cor. secs. 15, 16, 21 and 22, a mound made by R. C. Matthewson, and run North bet. secs. 15 and 16.

Va. 13° 35' E.

40.00 Drove charred stake for 1/4 sec. cor. and raised mound of earth with pits and trench as per inst.

80.00 Drove charred stake cor. secs. 9, 10, 15, and 16, and raised mound of earth with pits and trench as per inst.
Land rolling, good grass, oak timber and good 2nd rate soil.

East on a random line bet. secs. 10 and 15.

Va. 13° 35' E.

40.00 Set a post for temp. 1/4 sec. cor.

11.

T. 10 S. R. 3 E. S.B.M.

80.12 Int. N. & S. line 7 lks. N. of cor. secs. 10, 11, 14, 15, from which cor. I run

West on a true line bet. secs. 10 and 15.

Va. 13° 32' E.

40.06 Drove charred stake for 1/4 sec. cor. and raised mound of stone as per inst.

80.12 To cor. to secs. 9, 10, 15 and 16.

Land rolling, oak brush, scattering oak timber and 2nd rate soil.

North bet. secs. 9 and 10.

Va. 13° 35' E.

40.00 Drove charred stake for 1/4 sec. cor. and raised mound of stone as per inst.

80.00 Drove charred stake, cor. secs. 3, 4, 9 and 10, and raised mound of stone as per inst.

Land rolling, oak brush and 2nd rate soil.

East on a random line bet. secs. 3 and 10.

Va. 13° 35' E.

40.00 Set a post for temp. 1/4 sec. cor.

79.91 Int. N. & S. line 10 lks. N. of cor. secs. 2, 3, 10 and 11, from which cor. I run

West on a true line bet. secs. 3 and 10.

Va. 13° 31' E.

39.95 Drove charred stake for 1/4 sec. cor. and raised mound of stone as per inst.

79.91 To cor. secs. 3, 4, 9 and 10.

12.

(T. 10 S. R. 3 E. S.B.M.)

Land rolling, oak brush and 2nd rate soil.

✓ North bet. secs. 3 and 4.

Va. 13° 35' E.

40.00 Drove charred stake for 1/4 sec. cor. and raised mound of stone
as per inst., foot of rock mountains, course E. & W.
Land rolling, oak brush and 2nd rate soil.

✓ North bet. secs. 16 and 17.

Va. 13° 35' E.

40.00 Drove charred stake for 1/4 sec. cor. and raised mound of stone
as per inst.
80.00 Drove charred stake, cor. secs. 8, 9, 16 and 17, and raised a
mound of stone as per inst.
Land mostly level, good grass and 1st rate soil.

East on a random line bet. secs. 9 and 16.

Va. 13° 35' E.

40.00 Set a post for temp. 1/4 sec. cor.
79.89 Int. N. & S. line 4 lks. S. of cor. secs. 9, 10, 15 and 16,
from which cor. I ran
West on a true line bet. secs. 9 and 16.

Va. 13° 37' E.

25.00 Leave rolling hills, enter table land.
39.94 Drove charred stake for 1/4 sec. cor. and raised mound of earth
with trench and pits as per inst.
79.89 To cor. to secs. 8, 9, 16 and 17.

(T. 10 S. R. 3 E. S.B.M.)

Table land and 1st rate soil.

✓ North bet. secs. 8 and 9.

Va. 13° 35' E.

40.00 Drove charred stake for 1/4 sec. cor. and raised mound of earth
with trench and pits as per inst.
70.00 Leave table land, enter brushy hills.
80.00 Drove charred stake, cor. secs. 4, 5, 8 and 9, and raised mound
of stone as per inst.
Land mostly level, good grass and 1st rate soil.

East on random line bet. secs. 4 and 9.

Va. 13° 35' E.

40.00 Set a post for temp. 1/4 sec. cor.
80.13 Int. N. & S. line 8 lks. N. of cor. to secs. 3, 4, 9 and 10,
from which cor. I run
West on a true line bet. secs. 4 and 9.

Va. 13° 32' E.

20.00 Dry run, course N. 20 lks. wide.
40.06 Drove charred stake for 1/4 sec. cor. and raised mound of stone
as per inst.
80.13 To cor. secs. 4, 5, 8 and 9.
Land rolling and 2nd rate soil.

North bet. secs. 4 and 5.

Va. 13° 35' E.

- 40.00 Drove charred stake for 1/4 sec. cor. and raised mound of stone
✓ as per inst.
- 55.00 Witness mound of stone as per inst., foot of rocky brush mountain,
course E. & W.
Rolling and 2nd rate soil.

February 6, 1857

North bet. secs. 17 and 18.

Va. 13° 35' E.

- 17.50 Dry run, course W. 15 lks. wide.
- 20.00 Ranchorio and garden.
- 22.50 Leave the same.
- 35.00 Enter willow brush.
- 40.00 Drove charred stake for 1/4 sec. cor. and raised mound of earth
with pits and trench as per inst.
- 60.00 Wagon road, course NW. & SE.
- 80.00 Drove charred stake, cor. secs. 7, 8, 17 and 18, and raised mound
of earth with trench and pits as per inst.
Land level, good grass, oak and willow timber and 1st rate soil.

✓ East on random line bet. secs. 8 and 17.

Va. 13° 35' E.

- 40.00 Set a post for temp. 1/4 sec. cor.
- 80.07 Int. N. & S. line 6 lks. N. of cor. secs. 8, 9, 16 and 17,
from which cor. I run
West on a true line bet. secs. 8 and 17.

Va. 13° 32' E.

- 40.03 Drove charred stake for 1/4 sec. cor. and raised mound of earth
with pits and trench as per inst.
- 80.07 ✓ To cor. secs. 7, 8, 17 and 18.
Land level and 1st rate soil.

West on random line bet. secs. 7 and 18.

Va. 13° 35' E.

- 40.00 Set a post for temp. 1/4 sec. cor.
- 80.61 Int. W.B. 5 lks. N. of cor. secs. 7 and 18,
from which cor. I run
✓ East on a true line bet. secs. 7 and 18.

Va. 13° 37' E.

- 40.61 Drove charred stake for 1/4 sec. cor. and raised mound of stone
as per inst.
- 80.61 To cor. secs. 7, 8, 17 and 18.
Land mostly level, good grass, and good 2nd rate soil.

✓ North bet. secs. 7 and 8.

Va. 13° 35' E.

- 40.00 Drove charred stake for 1/4 sec. cor. and raised mound of stone
as per inst.
- 68.00 Enter rolling, brushy hills.
- 80.00 Drove charred stake, cor. secs. 5, 6, 7 and 8, and raised mound
of stone as per inst.
Land mostly level, oak and willow timber, good grass and 1st
rate soil.

East on a random line bet. secs. 5 and 8.

Va. 13° 35' E.

40.00 Set a post for temp. 1/4 sec. cor.

79 89 Int. N. & S. line 10 lks. S. of cor. secs. 4, 5, 8 and 9,
from which cor. I run

West on a true line bet. secs. 5 and 8.

Va. 13° 39' E.

39.94 Drove charred stake for 1/4 sec. cor. and raised mound of stone
as per inst.

79.89 To cor. secs. 5, 6, 7 and 8.

Land rolling, oak brush and good 2nd rate soil.

West on random line bet. secs. 6 and 7.

Va. 13° 35' E.

40.00 Set a post for temp. 1/4 sec. cor.

80.50 Int. W.B. 6 lks. S. of cor. secs. 6 and 7,
from which cor. I run

East on a true line bet. secs. 6 and 7.

Va. 13° 32' E.

40.50 Drove charred stake for 1/4 sec. cor. and raised mound of earth
with trench and pits as per inst.

80.50 To cor. secs. 5, 6, 7 and 8.

Land mostly level, oak timber, good 2nd rate soil.

North bet. secs. 5 and 6.

Va. 13° 35' E.

40.00 Drove charred stake for 1/4 sec. cor. and raised mound of stone

as per inst., foot of rocky mountains, course E. & W.
Land rolling and 2nd rate soil.

February 7, 1857

H. S. WASHBURN.

Vol. 262-6

NOTE: Field notes of Survey of Boundaries of Lot No. 37,
Rancho San Jose del Valle, by Wm. Minto, 1878, will be
found under separate cover.

From the cor. to secs. 2, 3, 34 and 35, I run
W. on a random line on S.B. of Tp.

Va. 12° 38' E.

I set temp. cor. at every 1/2 mile and at 3 miles, 76.50 chs., I
arrive at a point 271 lks. S. of cor. to Tps. 9, 10 S. Rs. 2, 3, E.,
from which cor. I run

South 89° 31' E. on a true line bet. secs. 6, 31.

Va. 12° 38' E.

Ascend.

36.50 Set post 4 in. dia. 2 ft. in earth 2 ft. above for 1/4 sec. cor.,
from which brs. a

Live oak 23 in. dia. S. 61° E. 36 lks. dist.

Live oak 14 in. dia. N. 46° W. 70 lks. dist.

- 53.60 Top of ridge brs. N. & S. & descend.
76.40 Cross low sag and ascend.
76.50 Set post 4 in. sq. 1 ft. in earth 1 ft. above stone mound 4½ ft.
in dia. at base by 2 ft. in height for cor. to secs. 5, 6, 31, 32.
Land mountainous, soil 2nd and 3d rate.
Timber & undergrowth of oak and chemisal.

S. 89° 31' E. on a true line bet. secs. 5, 32.

Va. 12° 38' E.

Ascend.

- 40.00 Set stone 14 x 10 x 7 in stone mound 4 ft. in dia. at base by 2 ft
in height for 1/4 sec. cor.
70.00 Top of spur brs. N. & S. & descend.
80.00 Set stone 26 x 7 x 5 in stone mound 4½ ft. in dia. at base by 2 ft.
in height for cor. to secs. 4, 5, 32, 33.
Land mountainous, soil 3d rate.
Timber & undergrowth of oak and chemisal.

S. 89° 31' E. on a true line bet. secs. 4, 33.

Va. 12° 38' E.

Descend.

- 58.30 Cross creek 18 lks. wide course SW. & ascend.
40.00 Set stone 17 x 9 x 6 in earth mound 4 ft. in dia. at base by 2 ft.
in height and dug pit 24 x 18 x 12, 8 lks. N. for 1/4 sec. cor.

- 80.00 Set stone 15 x 10 x 6 in earth mound 4½ ft. in dia. at base by 2 ft.
in height and dug pits 24 x 18 x 12, 8 lks. dist. at 4 angles for
cor. to secs, 3, 4, 33, 34.
Land mountainous, soil 3d rate.
Timber & undergrowth of oak and chemisal.

S. 89° 31' E. on a true line bet. secs. 3, 34.

Va. 12° 38' E.

Ascend.

- 5.40 Top of spur brs. NE. & SW. & descend.
27.50 Cross gulch 20 lks. wide course S. 27° W. & ascend.
40.00 Set stone 22 x 13 x 9 in earth mound 4 ft. in dia. at base by 2 ft.
in height and dug pit 24 x 18 x 12, 8 lks. N. for 1/4 sec. cor.
80.00 The cor. to secs. 2, 3, 34 and 35.
Land mountainous, soil 3d rate.
Timber & undergrowth of oak and chemisal.

July 1, 1880

A. P. HANSON.

Vol. 174-23

✓ From the cor. to secs. 25, 26, 30 and 31, I run
North on a true line bet. secs. 25 and 30.

Va. 12° 38' E.

Descend.

- 13.40 Int. Bdy. of Rancho San Jose del Valle at a point from which cor.
No. 23, brs. N. 57° W. 23.50 chs. dist.
Set post 4 in. sq. 1 ft. in earth 1 ft. above earth mound 4½ ft.
in dia. at base by 2 ft. in height and dug pits 24 x 18 x 12, 128
lks. dist. at 4 angles for cor. to frac. secs. 25 and 30,
from which brs. a
Willow 12 ins. in dia. N. 11 E. 106 lks. dist.
- 15.43 Cross creek 25 lks. wide course S. 15° W. & ascend.
- 40.00 Set post 4 in. dia. 1 ft. in earth 1 ft. above earth mound 4 ft.
in dia. at base by 2 ft. in height and dug pits 24 x 18 x 12, 8 lks.
N. for 1/4 sec. cor. on top of ridge brs. NE. & SW. & descend.
- 71.73 A spring flows NW.
- 80.00 Set post 4 in. sq. 1 ft. in earth 1 ft. above earth mound 4½ ft.
in dia. at base by 2 ft. in height and dug pits 24 x 18 x 12, 8 lks.
dist. at 4 angles for cor. to secs. 24, 25, 19 and 30,
from which brs. a
Live oak 11 in. dia. S. 8° E. 10 lks. dist.
Live oak 15 in. dia. N. 18° E. 25 lks. dist.
Live oak 24 in. dia. N. 30° W. 39 lks. dist.
Land mountainous, soil 2nd rate.
Timber and undergrowth of oak and chamisal.
-
- North on a true line bet. secs. 19 and 24
Va. 12° 38' E.
- Descend.
- 20.76 Cross gulch 14 lks. wide course SW. & ascend.

- 40.00 Set post 4 in. dia. 1 ft. in earth 1 ft. above earth mound 4 ft.
in dia. at base by 2 ft. in height and dug pit 24 x 18 x 12, 8 lks.
E. for 1/4 sec. cor.
Vineyard along line.
- 80.00 Set post 4 in. sq. 1 ft. in earth, 1 ft. above earth mound, 4½ ft.
in dia. at base by 2 ft. in height, and dug pits 24 x 18 x 12,
8 lks. dist. at 4 angles for cor. to secs. 13, 24, 18 and 19.
Land mountainous, soil 2nd and 3d rate.
Timber & undergrowth of oak and chamisal.
-
- North on a true line bet. secs. 13 and 18.
Va. 12° 38' E.
- Ascend.
- 30.58 Top of spur brs. NE. & SW. & descend.
- 40.00 Set stone 32 x 17 x 12 in stone mound 4 ft. in dia. at base by 2 ft.
in height for 1/4 sec. cor.
- 78.00 Cross gulch 15 lks. wide course S. 50° W. & ascend.
- 80.00 Set post 4 in. sq. 1 ft. in earth 1 ft. above stone mound 4½ ft.
in dia. at base by 2 ft. in height for cor. to secs. 12, 13, 7
and 18, from which brs. a
Live oak 14 in. dia. S. 44° E. 56 lks. dist.
White oak 18 in. dia. S. 55° W. 18 lks. dist.
Land mountainous, soil 2nd and 3d rate.
Timber & undergrowth of oak and chamisal.
-
- North on a true line bet. secs. 7 and 12.

E.B. T. 10 S. R. 3 E. S.B.M.

Va. 12° 38' E.

Ascend.

- 22.95 Top of spur brs. N. 50° E. & S. 50° W. & descend.
40.00 Set stone 20 x 14 x 11 in stone mound 4 ft. in dia. at base by
2 ft. in height for 1/4 sec. cor.
61.12 Cross creek 40 lks. wide course W., soon turns SW. & ascend.
80.00 Set post 4 in. sq. 1 ft. in earth 1 ft. above stone mound 4 1/2
ft. in dia. at base by 2 ft. in height for cor. to secs. 1, 6,
7 and 12.

Land mountainous, soil 2nd and 3d rate.

Timber & undergrowth of oak and chamisal.

The land in advance consisting of rough and broken mountains,
devoid of valuable timber, with soil unfit for cultivation, I
discontinue the line.

July 2, 1880

A. P. HANSON.

Vol. 357-4

RETRACING NE. BDY. OF Rancho San Jose del Valle
through T. 10 S. R. 3 E. S.B.M.

From cor. No. 23 on Bdy. of Ro. San Jose del Valle, which is a
stone, set firmly in the ground, marked W. XXIII with a stone
mound in good order alongside, I run
S. 57° E. on a random line along Bdy.

Va. 13° 30' E.

T. 10 S. R. 3 E. S.B.M.)

- 23.46 To old closing cor. to frac. secs. 25 and 30, on E.B. of Tp.
which is a post, set firmly in the ground, marked C.C.T. 10 S.
on N., R. 4 E. S. 30 on E. and R. 3 E. S. 25 on W. faces, with
6 notches on N. E. & W. faces, with pits N. E. & W. of post,
5 1/2 ft. dist. and a mound of earth, in good order around post,
from which brs. a

Black oak 18 in. dia. S. 10° W. 100 lks. dist.

marked T. 10 S. R. 3 E. S. 25 B.T.

From Cor. No. 23, on bdy. line, I run

N. 16° W. on a random line along bdy.

Va. 13° 30' E.

- 77.51 To cor. No. 22, which is a post, set firmly in the ground, marked
W. XXII, with a stone mound in good order around post.

Thence I run

N. 56 3/4° W. on a random line along bdy.

Va. 13° 30' E.

- 111.80 To cor. No. 21, which is a stone set firmly in the ground, marked
W. XXI, with a stone mound in good order alongside.

Thence I run

N. 64 1/2° W. on a random line along bdy.

Va. 13° 30' E.

- 103.07 To cor. No. 20, which is a slate stone, set firmly in the ground,
marked W. XX, with a stone mound in good order alongside.

February 1, 1884

Thence I run

N. $41\frac{1}{2}^{\circ}$ W. on a random line along bdy.

Va. $13^{\circ} 30'$ E.

118.52 To cor. No. 19, which is a post set firmly in the ground, marked W. XIX, with a stone mound in good order, around post.

Thence I run

N. 19° W. on a random line along bdy.

Va. $13^{\circ} 30'$ E.

27.00 To cor. No. 18, which is a post, set firmly in the ground, marked W. XXIII with a stone mound in good order around post.

Thence I run

N. 71° W. on a random line along bdy.

Va. $13^{\circ} 30'$ E.

92.12 To cor. No. 17, which is a granite stone, set firmly in the ground marked W. with a stone mound in good order alongside.

From the cor. to secs. 1, 6, 7 and 12, on E.B. of Tp., I run North on a random line bet. secs. 1 and 6.

Va. $13^{\circ} 30'$ E.

40.00 Set temp. $1/4$ sec. cor.

80.52 Int. N.B. of Tp. 75 lks. W. of cor. to Tps. 9 and 10 S. Rs. 3 and 4 E. which is a post set firmly in the ground, marked T. 9 S. S. 31 on NE., R. 4 E. S. 6 on SE., T. 10 S. S. 1 on SW. and R. 3 E. S. 36 on NW. faces, with 6 notches on each edge, and a stone mound, covered with earth around post.

Thence I run

S. $32'$ W. on a true line bet. secs. 1 and 6.

Va. $13^{\circ} 30'$ E.

Ascend.

11.52 Top of ridge brs. NW. & SE. & descend.

40.52 Set a granite stone 18 x 14 x 10 ins. 12 ins. in the ground for $1/4$ sec. cor., marked $1/4$ on W. face and raised a stone mound alongside. Pits impracticable.

80.52 The cor. to secs. 1, 6, 7 and 12.

Land hilly and mountainous, soil 3d rate.

Dense undergrowth of chemisal.

February 2, 1884

A. P. HANSON.

Vol. 174-24

From the cor. to secs. 19, 24, 25 and 30, on E.B. of Tp. I run West on a true line bet. secs. 24 and 25.

Va. $13^{\circ} 30'$ E.

Descend.

6.30 Cross road brs. N. 34° E. & S. 34° W.

61.45 Cross fence brs. N. 34° E. & S. 34° W.

10.40 Enter vineyard brs. N. & S.

13.80 Leave vineyard brs. N. & S.

14.00 Cross fence brs. N. 15° E. & S. 15° W.

- 16.37 ✓ Cross fence brs. N. & S.
- 29.67 Cross fence brs. N. 20° W. & S. 20° E.
- 35.04 Int. NE. bdy. of Rancho San Jose del Valle at a point 20.71 chs. S. from cor. No. 22, and
Set a post 4 ft. long 4 ins. sq. 12 ins. in the ground, for closing cor. to secs. 24 and 25, marked C.C.T. 10 S. R. 3 E. on E., S. 24 on N. and S. 25 on S. faces and raised a mound of stone 2 ft. high 4½ ft. base around post. Pits impracticable.
- 80.00 Set blank post at point for cor. to secs. 23, 24, 25 and 26, Soil 2nd and 3d rate. Land rolling.
Timber of live oak. Dense undergrowth of chamisal.
-
- North bet. secs. 23 and 24.
Va. 13° 30' E.
- ✓ Through Rancho.
- 40.00 Set blank post at point for 1/4 sec. cor.
- 46.84 Int. NE. bdy. of Rancho San Jose del Valle at a point 47.84 chs. N. 56½° W. from cor. No. 22 and
Set a post 4 ft. long 4 ins. sq. 12 ins. in the ground for closing cor. to secs. 23 and 24, marked C.C. 10 S. R. 3 E. on N., S. 24 on E. and S. 23 on W. face, with 1 notch on E. and 5 notches on W. faces and raised a mound of stone 2 ft. high 4½ ft. base around post. Pits impracticable.
- 80.00 Set a post 4 ft. long 4 ins. sq. with marked stone 12 ins. in the ground for cor. to secs. 13, 14, 23 and 24, marked T. 10 S. S. 13 on NE., R. 3 E. S. 24 on SE., S. 23 on SW. and S. 14 on NW. face with 3 notches on S. and 1 notch on E. edges. Dug pits 18x18x12 in.

in each sec. 5½ ft. dist., and raised a mound of earth 2 ft. high 4½ ft. base around post.
Land mountainous, soil 2nd and 3d rate.
Dense undergrowth of chamisal.

East on a random line bet. secs. 13 and 24.

Va. 13° 30' E.

- 40.00 Set temp. 1/4 sec. cor.
- 80.21 Int. E.B. of Tp. 32 lks. N. of cor. to secs. 13, 18, 19 and 24, from which cor. I run
N. 89° 46' W. on a true line bet. secs. 13 and 24.
Va. 13° 30' E.

Ascend.

- 10.50 Top of spur brs. N. 10° W. & S. 10° E. & descend.
- 40.10 Set a granite stone 18 x 16 x 7 ins. 12 ins. in the ground for 1/4 sec. cor. marked 1/4 on N. face and raised a mound of stone alongside. Pits impracticable, from which a
Live oak 12 in. dia. brs. S. 25° W. 52 lks. dist.
marked 1/4 S.B.T.
Live oak 10 in. dia. brs. N. 13° W. 60 lks. dist.
marked 1/4 S.B.T.

- 72.50 Cross trail brs. N. 5° W. & S. 5° E.
- 80.21 The cor. to secs. 13, 14, 23 and 24.
Land mountainous, soil 3d rate.
Timber of live oak. Dense undergrowth of chamisal.

North bet. secs. 13 and 14.

Va. 13° 30' E.

Descend.

- 5.28 Cross creek 5 lks. wide course S. 60° W. & ascend.
- 13.00 Top of ridge brs. N. 80° W. & S. 80° E. & descend.
- 40.00 Set a post 3 ft. long 3 ins. dia. with marked stone 12 ins. in the ground for 1/4 sec. cor. marked 1/4 S. on W. face and raised a mound of stone 1 1/2 ft. high 3 1/2 ft. base around post. Pits impracticable.
- 46.00 Top of bluff, brs. NE. & SW. & descend.
- 49.60 Cross creek 40 lks. wide course S. 50° W. & ascend.
- 71.00 Top of hill brs. E. & W. & descend.
- 80.00 Set a post 4 ft. long 4 ins. sq. with marked stone 12 ins. in the ground for cor. to secs. 11, 12, 13 and 14, marked T. 10 S. S. 12 on NE., R. 3 E. S. 13 on SE., S. 14 on SW. and S. 11 on NW. face with 4 notches on S. and 1 notch on E. edges and raised a mound of stone 2 ft. high 4; ft. base around post. Pits impracticable. Land mountainous, soil 2nd rate. Dense undergrowth of chamisal.

East on a random line bet. secs. 12 and 13.

Va. 13° 30' E.

- 40.00 Set temp. 1/4 sec. cor.
- 80.53 Int. E.B. of Tp. 22 lks. N. of cor. to secs. 7, 12, 13 and 18, from which cor. I run N. 89° 51' W. on a true line bet. secs. 12 and 13.

Va. 13° 30' E.

Ascend.

- 15.00 Top of hill brs. N. 30° E. & S. 30° W. & descend.
- 35.00 Foot of hill and over rolling land.
- 40.26 Set a sand stone 15 x 11 x 7 ins. 10 ins. in the ground for 1/4 sec. cor. marked 1/4 on N. face and raised a mound of stone alongside. Pits impracticable.
- 64.00 Top of bank brs. NE. & SW. & descend.
- 66.00 Cross creek 40 lks. wide course S. 55° W. & ascend.
- 80.53 The cor. to secs. 11, 12, 13 and 14. Land rolling, soil 2nd and 3d rate. Dense undergrowth of chamisal.

February 5, 1884

North bet. secs. 11 and 12.

Va. 13° 30' E.

Descend.

- 12.47 Cross gulch 20 lks. wide course N. 75° E. & ascend.
- 34.00 Top of ridge brs. E. & W. & descend.
- 40.00 Set a sandstone 14 x 12 x 6 ins. 9 ins. in the ground for 1/4 sec. cor. marked 1/4 on W. face and raised a mound of stone alongside. Pits impracticable.
- 70.00 Cross creek 20 lks. wide course S. 80° E. & ascend.
- 80.00 Set a sand stone 14 x 10 x 7 ins. 9 ins. in the ground for cor. to secs. 1, 2, 11 and 12, marked with 5 notches on S. and 1 notch on E. edges and raised a mound of stone alongside. Pits impracticable. Land mountainous, soil 3d rate.

T. 10 S. R. 3 E. S.B.M.

Dense undergrowth of chamisal.

East on a random line bet. secs. 1 and 12.

Va. 13° 30' E.

40.00 Set temp. 1/4 sec. cor.

80.38 Int. E.B. of Tp. 14 lks. S. of cor. to secs. 1, 6, 7 and 12,
from which cor. I run

S. 89° 54' W. on a true line bet. secs. 1 and 12.

Va. 13° 30' E.

Descend.

40.19 Set a sandstone 15 x 12 x 7 ins. 10 ins. in the ground for 1/4
sec. cor. marked 1/4 on N. face and raised a mound of stone along-
side. Pits impracticable.

71.03 Cross gulch 20 lks. wide course S. 30° E. & ascend.

80.38 The cor. to secs. 1, 2, 11 and 12.

Land rolling, soil 3d rate.

Dense undergrowth of chamisal.

North on a random line bet. secs. 1 and 2.

Va. 13° 30' E.

40.00 Set temp. 1/4 sec. cor.

80.47 Int. N.B. of Tp. 51 lks. W. of cor. to secs. 1, 2, 35 and 36,
which is a post set firmly in the ground marked T. 9 S. S. 36 on
NE., R. 3 E. S. 1 on SE., T. 10 S. S. 2 on SW. and S. 35 on NW
face with 1 notch on E. and 5 notches on W. edges and a stone
mound around it, from which cor. I run

T 10 S. R. 3 E. S.B. .

South 22° W. on a true line bet. secs. 1 and 2.

Va. 13° 30' E.

Ascend

40.47 Set a sand stone 15 x 10 x 10 ins. 10 ins. in the ground for 1/4
sec. cor. marked 1/4 on W. face and raised a mound of stone along-
side. Pits impracticable.

49.00 Top of spur brs. E. & W. & descend.

80.47 The cor. to secs. 1, 2, 11 and 12.

Land mountainous, soil 3d rate.

Dense undergrowth of chamisal.

From the cor. to secs. 13, 14, 23 and 24, I run
West on a true line bet. secs. 14 and 23.

Va. 13° 30' E.

Descend.

13.00 Cross creek 5 lks. wide course SW. & ascend.

40.00 Set a sand stone 14 x 12 x 11 ins. 9 ins. in the ground for 1/4
sec. cor. marked 1/4 on N. face and raised a mound of stone along-
side. Pits impracticable.

52.18 Int. NE. bdy. of Rancho San Jose del Valle at a point 2.46 chs.
S. 56 $\frac{3}{4}$ ° E. from cor. N. 21 and

Set a granite stone 20 x 18 x 10 ins. 15 ins. in the ground for
closing cor. to secs. 14 and 23, marked C.C. with 3 notches on E.
and 3 notches on N. edges and raised a mound of stone alongside.
Pits impracticable.

80.00 Set blank post at true point for cor. to secs. 14, 15, 22 and 23.
Land rolling and hilly, soil 2nd and 3d rate.
Dense undergrowth of chamisal.

North bet. secs. 14 and 15.

Va. 13° 30' E.

Through Rancho.

- 14.03 Int. NE. bdy. of Rancho San Jose del Valle at a point 29.00 chs. N. 64½° W. from cor. No.21 and Set a post 4 ft. long 4 ins. sq. 12 ins. in the ground for closing cor. to secs. 14 and 15, marked C.C. T. 10 S. R. 3 on N., S. 14 on E. and S.15 on W. faces with 2 notches on E. and 4 notches on W. faces and raised a mound of stone 2 ft. high 4½ ft. base around post. Pits impracticable.
- 22.90 Cross gulch 6 lks. wide course S. 86° W. & ascend. After diligent search being unable to find old cor., I
- 40.00 Set a granite stone 12 x 10 x 8 ins. 8 ins. in the ground for 1/4 sec. cor. marked 1/4 on W. face and raised a mound of stone alongside. Pits impracticable.
- 80.00 Set a granite stone 16 x 14 x 8 ins. 11 ins. in the ground for cor to secs. 10, 11, 14 and 15, marked with 4 notches on S. and 2 notches on E. edges and raised a mound of stone alongside. Pits impracticable.
- Land rolling and hilly, soil 3d rate. Dense undergrowth of chamisal.

East on a random line bet. secs. 11 and 14.

Va. 13° 30' E.

- 40.00 Set temp. 1/4 sec. cor.
- 79.87 Int. N. & S. line 13 lks. S. of cor. to secs. 11, 12, 13 and 14, from which co I run

S. 89° 54' W. on a true line bet. secs. 11 and 14.

Va. 13° 30' E.

- 11.50 Top of hill brs. NE. & SW. & descend.
- 33.01 Cross gulch 10 lks. wide course S. 10 E. & ascend.
- 39.93 Set a post 3 ft. long 3 ins. dia. with marked stone 12 ins. in the ground for 1/4 sec. cor., marked 1/4 S. on N. face and raised a mound of stone 1 1/2 ft. high 3 1/2 ft. base around post. Pits impracticable.
- 79 87 The cor. to secs. 10, 11, 14 and 15. Land hilly and rolling, soil 3d rate. Dense undergrowth of chamisal.

North bet. secs. 10 and 11.

Va. 13° 30' E.

Descend.

After diligent search being unable to find old cor., I

- 40.00 Set a granite stone 18 x 12 x 12 ins. 12 ins. in the ground for 1/4 sec. cor. marked 1/4 on W. face and raised a mound of stone alongside. Pits impracticable.
- 49.30 Cross Arroyo Seco 20 lks. wide course S. 20° W.
- 80.00 After diligent search, being unable to find old cor., I set a granite stone 14 x 10 x 7 ins. 9 ins. in the ground for cor. to secs. 2, 3, 10 and 11, marked with 5 notches on S. and 2 notches on E. edges and raised a mound of stone alongside. Pits impracticable.
- Land rolling, soil 3d rate. Undergrowth of chamisal.

East on a random line bet. secs. 2 and 11.

Va. 13° 30' E.

40.00 Set temp. 1/4 sec. cor.

80.16 Int. N. & S. line 37 lks. N. of cor. to secs. 1, 2, 11 and 12,
from which cor. I run

N. 89° 44' W. on a true line bet. secs. 2 and 11.

Va. 13° 30' E.

Ascend.

23.00 Top of spur brs. N. & S. & descend.

40.08 Set a sand stone 14 x 8 x 4 ins. 9 ins. in the ground for 1/4 sec.
cor. marked 1/4 on N. face and raised a mound of stone alongside.
Pits impracticable.

80.16 The cor. to secs. 2, 3, 10 and 11.

Land rolling, soil 3d rate.

Undergrowth of chamisal.

North on a random line bet. secs. 2 and 3.

Va. 13° 30' E.

After diligent search, being unable to find old cor., I set temp.
1/4 sec. cor.

80.39 Int. N.B. of Tp. 44 lks. W. of cor. to secs. 2, 3, 34 and 35,
which is a post set firmly in the ground marked T. 9 S. S. 35 on
NE., R. 3 E. S. 2 on SE., T. 10 S. S. 3 on SW. and S. 34 on NW.
faces with 2 notches on E. and 4 notches on W. edges and a stone
mound in good order around post, from which cor. I run

South 19' W. on a true line bet. secs. 2 and 3.

Va. 13° 30' E.

Descend.

33.77 Cross canon 12 lks. wide course N. 80° W. & ascend.

40.39 Set a granite stone 14 x 14 x 5 ins. 9 ins. in the ground for 1/4
sec. cor. marked 1/4 on W. face and raised a mound of stone along-
side. Pits impracticable.

80.39 The cor. to secs. 2, 3, 10 and 11.

Land hilly, soil 2nd and 3d rate.

Undergrowth of chamisal.

February 7, 1884

From the blank post, set a true point for the cor. to secs. 14, 15
22 and 23, I run

West on a blank line bet. secs. 15 and 22.

Va. 13° 30' E.

40.00 Set blank post at point for 1/4 sec. cor.

80.00 Set blank post at true point for cor. to secs. 15, 16, 21 and 22,
Land rolling, soil 3d rate.

Undergrowth of chamisal.

North bet. secs. 15 and 16.

Va. 13° 30' E.

40.00 Set blank post at true point for 1/4 sec. cor. inside Rancho San
Jose del Valle.

61.67 Int. NE. bdy. Rancho San Jose del Valle at a point 20.79 chs.

N. 41 1/4° W. from cor. No. 20 on bdy. and

Set a post 4 ft. long 4 ins. sq. 12 ins. in the ground for closing

cor. to secs. 15 and 16, marked C.C.T. 10 S. R. 3 E. on N., S. 15 on E. and S. 16 on W. faces with 3 notches on E. and 3 notches on W. faces and raised a mound of stone 2 ft. high $4\frac{1}{2}$ ft. base around post. Pits impracticable.

After diligent search, being unable to find old cor., I

80.00 Set a post 4 ft. long 4 ins. sq. with marked stone 12 ins. in the ground for cor. to secs. 9, 10, 15 and 16, marked T. 10 S. S. 10 on NE., R. 3 E. S. 15 on SE., S. 16 on SW. and S. 9 on NW. face with 4 notches on S. and 3 notches on E. edges and raised a mound of stone 2 ft. high, $4\frac{1}{2}$ ft. base around post. Pits impracticable. Land rolling, soil 2nd and 3d rate. Undergrowth of chamisal.

East on a random line bet. secs. 10 and 15.

Va. $13^{\circ} 30'$ E.

40.00 After diligent search, being unable to find old cor., I set temp. $1/4$ sec. cor.

80.30 Int. N. & S. line 27 lks. N. of cor. to secs. 10, 11, 14 and 15, from which cor. I run

N. $89^{\circ} 48'$ W. on a true line bet. secs. 10 and 15.

Va. $13^{\circ} 30'$ E.

Descend

14.60 Cross Arroyo Seco 20 lks. wide course S. & ascend.

25.00 Top of ridge brs. NW. & S. & descend.

40.15 Set a granite stone 10 x 10 x 6 ins. 7 ins. in the ground for $1/4$ sec. cor. marked $1/4$ on N. face and raised a mound of stone along side. Pits impracticable.

80.30 The cor. to secs. 9, 10, 15 and 16.

Land mountainous, soil 3d rate.

Dense undergrowth of chamisal.

North bet. secs. 9 and 10.

Va. $13^{\circ} 30'$ E.

Ascend

34.00 Top of ridge brs. NW. & SE. & descend.

40.00 After diligent search, being unable to find old cor., I Set a granite stone 16 x 10 x 8 ins. 11 ins. in the ground for $1/4$ sec. cor. marked $1/4$ on W. face and raised a mound of stone alongside. Pits impracticable.

80.00 After diligent search, being unable to find old cor., I set a granite stone 20 x 13 x 4 ins. 15 ins. in the ground for cor. to secs. 3, 4, 9 and 10, marked with 5 notches on S. and 3 notches on E. edges and raised a mound of stone alongside.

Pits impracticable.

Land rolling, soil 3d rate.

Undergrowth of chamisal.

East on a random line bet. secs. 3 and 10.

Va. $13^{\circ} 30'$ E.

40.00 After diligent search, being unable to find old cor., I set temp. $1/4$ sec. cor.

80.15 Int. N. & S. line 16 lks. N. of cor. to secs. 2, 3, 10 and 11, from which cor. I run

N. 89° 53' W. on a true line bet. secs. 3 and 10.

Va. 13° 30' E.

Descend

40.07 Set a granite stone 12 x 10 x 8 ins. 8 ins. in the ground for 1/4
sec. cor. marked 1/4 on N. face and raised a mound of stone along-
side. Pits impracticable.

47.14 Cross gulch 10 lks. wide course S. & ascend.

80.15 The cor. to secs. 3, 4, 9 and 10.

Land rolling, soil 3d rate.

Undergrowth of chamisal.

North on a random line bet. secs. 3 and 4.

Va. 13° 30' E.

40.00 After diligent search, being unable to find old cor., I set temp.
1/4 sec. cor.

80.42 Int. N.B. of Tp. 30 lks. W. of cor. to secs. 3, 4, 33 and 34,
from which cor. I run

S. 13° W. on a true line bet. secs. 3 and 4.

Va. 13° 30' E.

Descend

22.94 Cross gulch 15 lks. wide course W. & ascend.

40.42 Set a granite stone 15 x 14 x 8 ins. 10 ins. in the ground for 1/4
sec. cor. marked 1/4 on W. face and raised a mound of stone along-
side. Pits impracticable.

41.00 Top of ridge brs. N. 60° E. & S. 60° W. & descend.

80.42 The cor. to secs. 3, 4, 9 and 10.

Land mountainous, soil 3d rate.

Dense undergrowth of chamisal.

I carefully examined the adjustments of my solar compass to-day,
particularly the latitude and reversing apparatus and found them
correct.

February 8, 1884

✓ From the cor. to secs. 9, 10, 15 and 16, I run
West on a true line bet. secs. 9 and 16.

Va. 13° 30' E.

Descend.

16.19 Int. NE. bdy. of Rancho San Jose del Valle 45.72 chs. N. 41 1/4° W.
from cor. No. 20 and

Set a granite stone 16 x 14 x 8 ins. 11 ins. in the ground for
closing cor. to secs. 9 and 16, marked C.C. with 2 notches on N.
and 4 notches on S. edges and raised a mound of stone alongside.
Pits impracticable.

40.00 Set blank post at true point for 1/4 sec. cor.

80.00 Set blank post at true point for cor. to secs. 8, 9, 16 and 17.
Land rolling, soil 2nd rate.

Undergrowth of chamisal.

✓ -----
North bet. secs. 8 and 9.

Va. 13° 30' E.

40.00 Set blank post at true point for 1/4 sec. cor. inside Rancho San
Jose del Valle.

80.00 To a point 8.08 chs. W. of cor. No. 18 on NE. bdy. of Rancho San
Jose del Valle and raised a stone mound 2 1/2 ft. high 4 ft. base

at true point for cor. to secs. 4, 5, 8 and 9 inside Rancho.

Land rolling, soil 2nd rate.

Undergrowth of chamisal.

East on a random line bet. secs. 4 and 9.

Va. 13° 30' E.

40.00 After diligent search, being unable to find old cor., I set temp. 1/4 sec. cor.

80.04 Int. N. & S. line 28 lks. N. of cor. to secs. 3, 4, 9 and 10, from which cor. I run

N. 89° 46' W. on a true line bet. secs. 4 and 9.

Va. 13° 30' E.

Ascend.

31.00 Top of ridge brs. N. 35° W. & S. 35° E. & descend.

40.02 Set a granite stone 17 x 12 x 4 ins. 11 ins. in the ground for 1/4 sec. cor., marked 1/4 on N. face and raised a mound of stone alongside. Pits impracticable.

71.96 The cor. No. 18 on bdy. of Rancho.

80.04 The cor. to secs. 4, 5, 8 and 9.

Land rolling, soil 2nd rate.

Undergrowth of chamisal.

North on a random line bet. secs. 4 and 5.

Va. 13° 30' E.

After diligent search, being unable to find old cor., I

40.00 Set temp. 1/4 sec. cor.

80.24 Int. N.B. of Tp. 26 lks. W. of cor. to secs. 4, 5, 32 and 33.

Thence I run

South 11' W. on a true line bet. secs. 4 and 5.

Va. 13° 30' E.

Ascend.

21.24 Top of ridge brs. E. & W. & descend.

40.24 Set a granite stone 14 x 10 x 10 ins. 9 ins. in the ground for 1/4 sec. cor. marked 1/4 on W. face and raised a stone mound alongside. Pits impracticable.

58.24 Cross San Luis Rey river 50 lks. wide course SW. & ascend.

77.46 Int. N.E. bdy. of Rancho San Jose del Valle 8.60 chs. N. 71° W.

from cor. No. 18 and set a post 4 ft. long 4 ins. sq. with marked stone 12 in. in the ground for closing cor. to frac. secs. 4 and 5, marked C.C.T. 10 S. R. 3 E. on N., S. 4 on E. and S. 5 on W. faces with 4 notches on E. and 2 notches on W. edges and raised a stone mound around post. Pits impracticable.

80.24 The cor. to secs. 4, 5, 8 and 9.

Land mountainous, soil 3d rate.

Dense undergrowth of chamisal.

West on a true line bet. secs. 5 and 8.

Va. 13° 30' E.

Through Rancho San Jose del Valle.

40.00 Set blank post at true point for 1/4 sec. cor.

80.00 Set blank post for cor. to secs. 5, 6, 7 and 8.

Land rolling, soil 2nd rate. Undergrowth of chamisal.

From the cor. to secs. 5, 6, 7 and 8, I run
North on a random line bet. secs. 5 and 6.

Va. 13° 30' E.

After diligent search being unable to find old cor., I

40.00 Set temp. 1/4 sec. cor.

80.20 Int. N.B. of Tp. 21 lks. W. of cor. to secs. 5, 6, 31 and 32,
Thence I run

South 9' W. on a true line bet. secs. 5 and 6.

Va. 13° 30' E.

Descend.

7.84 Cross gulch 9 lks. wide course NW. & ascend.

40.20 Set a granite stone 14 x 7 x 5 ins. 9 ins. in the ground for 1/4
sec. cor. marked 1/4 on W. face and raised a stone mound alongside.
Pits impracticable.

49.53 Int. NE. bdy. of Rancho San Jose del Valle 1.22 chs. N. 55° W.
from cor. No. 17 and

Set a granite stone 15 x 12 x 7 ins. 10 ins. in the ground for
closing cor. to secs. 5 and 6, marked C.C. with 5 notches on E.
and 1 notch on W. edges and raised a stone mound alongside.
Pits impracticable.

80.20 The cor. to secs. 5, 6, 7 and 8.
Land mountainous, soil 3d rate.
Dense undergrowth of chamisal.

February 9, 1884

Vol. 357-5

A. P. HANSON.

As the divergency of the random from the true line bet. Tps. 9
and 10 S. R. 3 E. renders it difficult to take the topography
with accuracy, from the established cor. to Tps. 9 and 10 S.
Rs. 2 and 3 E. which is a sandstone 15 x 12 x 6 ins. above ground,
marked with 6 notches on each edge, from which

An oak 20 in. dia. vrs. S. 0°40' E. 57 lks. dist.

marked T. 10 S. R. 3 E. S. 6 B.T.

An oak 15 in. dia. brs. N. 29° 45' E. 165 lks. dist.

marked T. 9 S. R. 3 E. S. 31 B.T.

and a mound of stone 3½ ft. high 6 ft. base alongside.

Thence I run

S. 89° 31' E. on a true line bet. secs. 6 and 31.

Va. 13° 46' E.

Over broken and brushy mesa with scattering oak.

0.10 Gulch about 30 ft. deep course S.

3.65 Wire fence, course S. 69° 30' E. Leave "Warner Ranch"

32.00 Gulch about 30 ft. deep, course S.

36.50 Set a granite stone 21 x 14 x 6 ins. 16 ins. in the ground for 1/4
sec. cor., marked 1/4 on N. face; from which

An oak 16 in. dia. brs. N. 16° 25' W. 116 lks. dist.

marked T. 9 S. R. 3 E. S. 31 B.T. (error in marking should
be 1/4 S.B.T.)

No other trees within limits and raised a mound of earth 3½ ft. high
7 ft. base alongside.

Cleared brush 10 ft. around.

70.00 Leave mesa, ascend steep broken mountain.

76.50 A granite rock in place $3\frac{1}{2} \times 3\frac{1}{2} \times 2\frac{1}{2}$ ft. above ground which I mark for cor. to secs. 5, 6, 31 and 32, with a cross (X) at the exact cor. point and 5 notches on E. and 1 notch on W. faces and raised a mound of stone $3\frac{1}{2}$ ft. high $4\frac{1}{2}$ ft. base alongside. Pits impracticable. Cleared brush 10 ft. around. Land broken table, soil rocky, 3d rate. Timber scattering oak. Dense undergrowth of redwood and chamisal, 76.50 chs.

S. $89^{\circ} 31'$ E. on a true line bet. secs. 5 and 32.

Va. $13^{\circ} 46'$ E.

Ascend.

7.50 Mouth of ravine course SW. Ascend abruptly.
28.00 Top of spur about 300 ft. above gulch, course SW.
33.00 Gulch course SW.
40.00 A granite rock in place $9 \times 8 \times 6$ ft. high which I mark for $1/4$ sec. cor., with a cross (X) at the exact cor. point and $1/4$ on SE. face and raised a mound of stone 3 ft. high 4 ft. base on top of rock in place. Pits impracticable. Cleared brush 10 ft. around.
40.60 Gulch course NW.
52.50 Top of ridge about 700 ft. above last sec. cor.
55.00 Descend steeply.
72.40 Gulch about 300 ft. below ridge, course SE.
80.00 Set a granite stone $18 \times 8 \times 8$ ins. 13 ins. in the ground for cor. to secs. 4, 5, 32 and 33, marked with 4 notches on E. and 2 notches

on W. edges and raised a mound of stone 4 ft. high $4\frac{1}{2}$ ft. base alongside. Pits impracticable. Cleared brush 10 ft. around. From this cor. Lenten's house brs. S. $73^{\circ} 10'$ E. Land mountainous, soil rocky, 4th rate. Dense undergrowth of redwood and chamisal, 80.00 chs.

S. $89^{\circ} 31'$ E. on a true line bet. secs. 4 and 33.

Va. $13^{\circ} 46'$ E.

Descend over broken and brushy mountains.

14.20 Gulch about 200 ft. below last sec. cor., course SE.
31.60 Gulch about 350 ft. below last sec. cor., course SE.
40.00 A granite rock in place $24 \times 18 \times 12$ ins. above ground which I mark for $1/4$ sec. cor., with a cross (X) at the exact cor. point and $1/4$ on E. face and raised a mound of earth and stone 3 ft. high 4 ft. base alongside. Pits impracticable.
46.20 Puerta la Cruz creek 5 lks. wide, precipitous walls on each side 50 ft. high, course SW.
52.50 Gulch, course NW. Ascend over broken hills.
79.60 Trail course N. & S.
80.00 Set granite stone $23 \times 12 \times 6$ ins. 18 ins. in the ground for cor. to secs. 3, 4, 33 and 34, marked with 3 notches on E. & W. edges and raised a mound of stone 3 ft. high 4 ft. base on top of a boulder $20 \times 6 \times 5$ ft. high S. of stone. Pits impracticable. Land mountainous, soil rocky, 3d and 4th rate. Timber, scattering oak the last 40 chs. Dense undergrowth of redwood and chamisal, 80.00 chs.

Dec. 2, 1893

N.B. T. 10 S. R. 3 E. (L.B.M.)

S. 89° 31' E. on a true line bet. secs. 3 and 34.

Va. 13° 46' E.

Ascend over boulder and through brush.

20.00 Ascend precipitous bluff.

27.72 Lenten's house brs. S. 24° 45' W.

31.00 Top of bluff about 350 ft. above sec. cor., course SE.

Ascend over broken and brushy mesa.

40.00 A granite rock in place 8 x 4 x 2½ ft. above ground which I mark for 1/4 sec. cor., with a cross (X) at the exact cor. point and 1/4 on N. face and raised a mound of stone 3 ft. high 4 ft. base on top of rock in place and S. of cross. Pits impracticable. Cleared brush 10 ft. around.

55.00 Low ridge course NW.

62.40 Gulch with stream 2 lks. wide course NW.

76.00 Puerta la Cruz creek 4 lks. wide course NW.

80.00 Set a porphyry stone 22 x 12 x 10 ins. 16 ins. in the ground for cor. to secs. 2, 3, 34 and 35, marked with 2 notches on E. and 4 notches on W. edges, from which an

Oak partly decayed 12 ft. high 15 ins. in dia. brs.

S. 83° 50' E. 83 lks. dist.

marked T. 10 S. R. 3 E. S. 2 B.T.

and raised a mound of stone 3 ft. high 4 ft. base alongside; falls in the creek bottom 40 lks. N. of stream.

Land mountainous, soil rocky 3d rate.

Timber, scattering oak. Dense undergrowth of redwood and chamisal, 80.00 chs.

N.B. T. 10 S. R. 3 E. S.B..)

Thence

East on a true line bet. secs. 3 and 35.

Va. 13° 46' E.

Ascend over broken and brushy mesa.

14.60 Puerta la Cruz creek 4 lks. wide course SW.

40.00 Set a granite stone 19 x 8 x 8 ins. 15 ins. in the ground for 1/4 sec. cor. marked 1/4 on N. face; dug pits 18 x 18 x 12 ins. E. and W. of stone 5½ ft. dist. and raised a mound of earth and stone 3½ ft. high 4½ ft. base alongside.

43.00 Ascend precipitous mountain.

55.00 Top of spur about 300 ft. above mesa, course S.

60.00 Ascend precipitous mountain.

72.90 Jagged ridge, course NW., blazed a pint 6 ins. in dia. 10 lks. S. of line about 900 ft. above mesa.

73.50 Blazed a pine 12 ins. in dia. 40 N. of line.

76.40 Gulch about 30 ft. below ridge, course SW.

80.00 Set a granite stone 24 x 16 x 5 ins. 18 ins. in the ground for cor to secs. 1, 2, 35 and 36, marked with 1 notch on E. and 5 notches on W edges and raised a mound of earth and stone 3½ ft. high 4½ ft. base alongside. Pits impracticable.

This cor. is about 50 ft. above gulch.

Land mountainous, soil rocky, 4th rate.

Timber, few pine on ridge. Dense undergrowth of manzanita, chamisal and redwood, 80.00 chs.

East on a true line bet. secs. 1 and 36.

Va. 13° 46' E.

- 1.50 Descend steeply.
- 6.30 Gulch 100 ft. below last sec. cor, course NW.
- 17.00 Top of spur about 300 ft. above gulch, course NW.
- 29.70 Canon, course NW. Same elevation as spur, ascend.
- 35.00 Gulch about 30 ft. deep, course SW.
- 40.00 Set a quartzite stone 18 x 8 x 6 ins. 13 ins. in the ground for 1/4 sec. cor., marked 1/4 on N. face and raised a mound of earth and stone 3 1/2 ft. high 4 1/2 ft. base alongside. Pits impracticable.
- 60.60 Top of blunt spur about 400 ft. above canon, course S.
- 64.50 Top of flat spur about 600 ft. above canon, course S. Descend.
- 69.00 Gulch about 200 ft. below spur, course S.
- Ascend precipitous slope.
- 80.00 Set a granite stone 30 x 10 x 10 ins. on a rock in place for cor. to Tps. 9 and 10 S. Rs. 3 and 4 E. marked with 6 notches on each edge and raised a mound of stone 4 ft. high 5 ft. base around it. Pits impracticable.
- This cor. falls at the foot of steep granite reef, course SE. & NW
- Among large boulders and is about 8 chs. W. of the top of the highest mountain for miles around.
- The Pacific Ocean is visible from this cor.
- This cor. is about 450 ft. above gulch and about 3,000 ft. above Oak Grove.
- Land mountainous, soil rocky, 4th rate.
- Dense undergrowth of manzanita, buckbrush, chamisal, soapbrush and redwood, 80.00 chs.

Dec. 3, 1893

From the cor. to Tps. 10 and 11 S. Rs. 2 and 3 E. in "Warner Valley" which is a granite stone 18 x 12 x 10 ins. marked with 6 notches on each edge in a mound of stone 1 1/2 ft. high 3 ft. base.

(This does not answer description of cor. called for in the original notes but it is in the proper position as the topography demonstrate conclusively), I run

N. 0° 01' E. on a true line bet. secs. 31 and 36.

Va. 13° 46' E.

Over rolling hills.

- 7.15 Road from Oak Grove to Santa Isabel, course S. 10° W.
- 39.64 Reestablish cor. at proportionate distance, as follows:
- Set a post 7 ft. long 4 ins. sq. with marked stone 2 1/2 ft. in the ground for 1/4 sec. cor., marked 1/4 S. on W. face; dug pits 60 c 40 x 12 ins. N. & S. of post 5 1/2 ft. dist. and raised a mound of earth 3 1/2 ft. high 8 ft. base around post.
- 51.70 Top of ridge about 80 ft. above Tp. cor., course W.
- 67.00 Enter bog from which there is a stream 3 lks. wide running SW.
- 73.00 Leave bog.
- 79.28 Reestablish cor. at proportionate dist. as follows:
- Set a post 8 ft. long 4 ins. sq. with marked stone 2 1/2 ft. in the ground for cor. to secs. 25, 30, 31 and 36, marked T. 10 S. S. 30 on NE., R. 3 E. S. 31 on SE., R. 2 E. S. 36 on SW. S. 25 on NW. faces with 5 notches on N. and 1 notch on S. edges; dug pits 90 x 40 x 12 ins. crosswise of the line N. & S. of post 5 1/2 ft. dist. and raised a mound of earth 4 ft. high 8 ft. base around post. I departed from the usual form for pits in order to get more earth that was in shoveling distance.

Land hilly, soil gravelly and loam, 2nd rate. No timber.

North 0° 01' E. on a true line bet. secs. 25 and 30.

Va. 13° 46' E.

Over rolling hills.

- 12.75 Wire fence course E. & W.
- 27.50 Top of hill about 40 ft. high, course W.
- 34.40 Top of hill about 50 ft. high.
- 39.64 Reestablish cor. at proportionate dist. as follows:
Set a granite stone 16 x 8 x 6 ins. 12 ins. in the ground for 1/4 sec. cor. marked 1/4 on W. face and dug pits 36 x 36 x 12 ins. N. & S. of stone 5½ ft. dist. and raised a mound of earth 3½ ft. high 7 ft. base alongside.
- 42.00 Top of hill about 30 ft. above 1/4 sec. cor.
- 49.20 Stream 20 lks. wide with willow and cottonwood.
This is a branch of the San Luis Rey river, course SW.
Leave hills, enter valley.
- 52.30 Wire fence course NE. & SW.
- 60.45 Wire fence, course E. & W.
- 73.00 Stream 8 lks. wide, course SW.
- 79.28 Reestablish cor. at proportionate dist. as follows:
Set a post 8 ft. long 4 ins. in dia. with marked stone 2 ft. in the ground for cor. to secs. 19, 24, 25 and 30, marked T. 10 S. S. 19 on NE., R. 3 E. S. 30 on SE., R. 2 E. S. 25 on SW. S. 24 on NW. faces with 4 notches on N. and 2 notches on S. edges; dug pits 18 x 18 x 12 ins. in each sec. 5½ ft. dist. and raised a mound of earth 3½ ft. high 7 ft. base around post.

From this cor. chimney on adobe house at the old Rincon rancho
brs. S. 23° 30' E. 20.20 chs. dist.

Land rolling hills, 50.00 chs. Remainder, valley.

Soil gravelly and sandy, 2nd rate.

Timber, willow and cottonwood along stream, as noted above.

North 0° 01' E. on a true line bet. secs. 19 and 24.

Va. 13° 46' E.

Over level valley.

- 4.00 Enter grassy bog.
- 20.00 Leave grassy bog.
- 24.00 Enter cottonwood and willow grove.
- 39.64 Reestablish cor. at proportionate dist. as follows:
Set a post 8 ft. long 4 ins. sq. with marked stone 2 ft. in the ground for 1/4 sec. cor., marked 1/4 S. on W. face, from which a
Cottonwood 26 in. in dia. brs. S. 49° 00' W. 12 lks. dist.
marked 1/4 S.B.T.
Cottonwood 55 in. in dia. brs. S. 81° 5' E. 176 lks. dist.
marked 1/4 S.B.T.
Dug pits 36 x 36 x 12 ins. N. & S. of post 5½ ft. dist. and raised a mound of earth 3½ ft. high 7 ft. base around post.
This cor. falls in the sandy bed of a flat wash.
- 41.60 Wire fence, course E. & W. Leave grove.
- 62.00 Leave "Warner Valley" Ascend steep spur.
- 66.25 Wire fence, course E. & W.
- 66.80 Top of spur about 100 ft. above valley, course E.

- 71.00 Dry wash about 40 ft. below spur, course E.
- 79 28 Reestablish cor. at proportionate dist., as follows:
Set a granite stone 28 x 10 x 5 ins. 21 ins. in the ground for
cor. to secs. 13, 18, 19 and 24, marked with 3 notches on N. & S.
edges and raised a mound of earth and stone 3½ ft. high 6 ft.
base alongside. Pits impracticable.

✓ This cor. falls on top of ridge, course SE.

Land, valley 62.00 chs.; remainder mountainous,

Soil, sandy, 2nd rate; rocky, 3d rate.

Timber, willow and cottonwood as above noted.

Undergrowth, sage and chamisal on mountain.

Dec. 11, 1893

North 0° 01' E. on a true line bet. secs. 13 and 18.

Va. 13° 46' E.

- 9.50 Gulch, about 40 ft. below last sec. cor., course SE.
- 17.80 Top of spur about 100 ft. above gulch, course E.
- 21.70 Gulch about 100 ft. below spur course E.
- 29.80 Top of spur about 150 ft. above gulch course E.
- 34.60 Gulch about 120 ft. below spur, course E.
- 39.64 Reestablish cor. at proportionate dist. as follows:
Set a porphyry stone 18 x 12 x 5 ins. 13 ins. in the ground for
1/4 sec. cor. marked 1/4 on W. face, from which an

✓ Oak 15 in. in dia. brs. N. 20°10' W. 315 lks. dist.

marked 1/4 S.B.T.

No other trees within limits and raised a mound of earth and stone

- 3½ ft. high 6 ft. base alongside.
- 56.60 Gulch, course NE. Continue skirting broken and brushy E. slope.
- 79.28 Reestablish cor. at proportionate dist. as follows:
Set a triangular pyramidal quartz stone 23 x 14 x 14 ins. 16 ins.
in the ground for cor. to secs. 7, 12, 13 and 18, marked with 2
notches on N. and 4 notches on S. edges and raised a mound of
earth and quartz 3½ ft. high 4½ ft. base alongside.
Pits impracticable. Cleared brush 10 ft. around.
Land mountainous, soil rocky, 3d rate.
Timber, scattering oak in gulches.
Dense undergrowth of chamisal and redwood, 79,28 chs.

North 0° 01' E. on a true line bet. secs. 7 and 12.

Va. 13° 46' E.

- ✓ Over broken and brushy mountains.
- 0.60 Gulch about 40 ft. below last sec. cor., course E.
- 6.40 Top of spur about 80ft. below gulch, course SE.
- 15.00 Head of numerous gullies which unite and form a gulch further
down the mountain.
- 23.00 Top of spur course NE.
- 26.00 Gulch about 60 ft. deep course NE.
- 27.10 Gulch course NE.
- 33.60 Summit of ridge in saddle about 1000 ft. above Warner's Valley,
course E.
- 38.50 Head of gulch, about 50 ft. below ridge course NE.
- 39.64 Reestablish cor. at proportionate dist. as follows:

✓ Set a granite stone 30 x 11 x 11 ins. 22 ins. in the ground for 1/4 sec. cor. marked 1/4 on W. face and raised a mound of earth and stone alongside. Pits impracticable.

Cleared brush 10 ft. around.

41.70 Top of spur, same elevation as 1/4 sec. cor., course NE.

Descend, through dense brush.

76.10 Gulch about 450 ft. below 1/4 sec. cor. with scattering oak and cottonwood, course NE.

79.28 Reestablish cor. at proportionate dist. as follows:

Set a granite stone 22 x 15 x 6 ins. 16 ins. in the ground for cor. to secs. 1, 6, 7 and 12, marked with 1 notch on N. and 5 notches on S. edges, from which a

Cottonwood 20 in. in dia. brs. S. 8° 30' E. 276 lks. dist.

marked T. 10 S. R. 3 E. S. 7 B.T.

No other trees within limits and raised a mound of earth and stone 3 ft. high 4½ ft. base alongside.

Land mountainous, soil rocky, 3d rate.

✓ Timber, oak and cottonwood as above noted.

Dense undergrowth of chamisal, redwood and oak brush, 79.28 chs.

North 0° 01' E. on a true line bet. secs. 1 and 6.

Va. 13° 46' E.

Descend over broken and brushy mountains and mesa.

39 64 Reestablish cor. at proportionate dist., as follows:

Set a granite stone 23 x 12 x 9 ins. 16 ins. in the ground for 1/4 sec. cor. marked 1/4 on W. face; from which an

Oak 22 in. in dia., growing bet. two immense boulders brs. N. 27° 25' E. 258 lks. dist. marked 1/4 S.B.T.

No other trees within limits and raised a mound of stone 3½ ft. high 4 ft. base on top of a boulder 3 ft. high 5 ft. base alongside.

39.70 Gully, course E.

49.00 Arroyo de Canada Almenga, about 20 ft. deep, course E.

58.90 Road from Oak Grove to "Warner's ranch" course E. & W.

61.60 Dry creek about 40 ft. below road, course SE.

79 28 The proportionate dist. cor. to Tps. 9 and 10 S. Rs. 2 and 3 E., which is a sandstone with 6 notches on each edge, from which an

Oak 20 in. in dia. brs. S. 0° 40' E. 57 lks. dist.

marked T. 10 S. R. 3 E. S. 6 B.T.

Oak 15 in. in dia. brs. N. 29° 45' E. 165 lks. dist.

marked T. 9 S. R. 3 E. S. 31 B.T.

and a mound of stone 3½ ft. high 6 ft. base alongside.

Land broken table 30 chs.; remainder mountainous.

Timber, scattering oak on last 30.00 chs.

Soil, rocky 3d rate.

Dense undergrowth of chamisal, redwood and oak brush, 79.28 chs.

Dec. 10, 1893

✓ C. R. GLASS.

Vol. 391-17

Ed Fletcher Papers

1870-1955

MSS.81

Box: 42 Folder: 23

**Business Records - Field Notes - Township
10 S., Range 3 E., San Bernardino Meridian**



Copyright: UC Regents

Use: This work is available from the UC San Diego Libraries. This digital copy of the work is intended to support research, teaching, and private study.

Constraints: This work is protected by the U.S. Copyright Law (Title 17, U.S.C.). Use of this work beyond that allowed by "fair use" requires written permission of the UC Regents. Permission may be obtained from the UC San Diego Libraries department having custody of the work (<http://libraries.ucsd.edu/collections/mscl/>). Responsibility for obtaining permissions and any use and distribution of this work rests exclusively with the user and not the UC San Diego Libraries.