

Instructions To The Performance

First gather the proper amount, and kind, of patchcords needed, as the score indicates.

Patch the piece, and monitor on ear-phones, if possible.

Check to see that the playback system is in order.

Assistants may be used.

Introduce the piece by bringing up the gate pots, gradually, to full on.

You may move any of the pots anytime, so long as the effect is in Good Taste.

Terminate the piece as you must.

If there is anything you don't understand, feel free to ask the composer.

Vladimir Vooss  
March 16, 1970

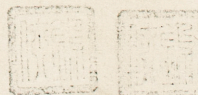



## Instructions To The Performer

Round connections are DC connections  
Triangular connections are AC connections.

The numbers in the lower-left-hand-corner of the modules are the model numbers for that module. See enclosed conversion - Index I.

Numbers in array, or numbers other than model numbers are pot-position indications.

5 as in 5 o'clock is (to the right)  
full on.  
7 as in 7 o'clock is (to the left)  
full off.

An array of numbers, or any other number other than model number, corresponds in space to that array of pots, or pot, on the module itself.

Int., and Ext., are Internal and External, respectively, switching indications.

There are four channels which are unused in 107 (VCM). These may be used to mix any other sources which are at the discretion of the performer. Voltage control these by stacking jacks from A, B, or C of 123 (SVS).

All pot-positions are starting positions.



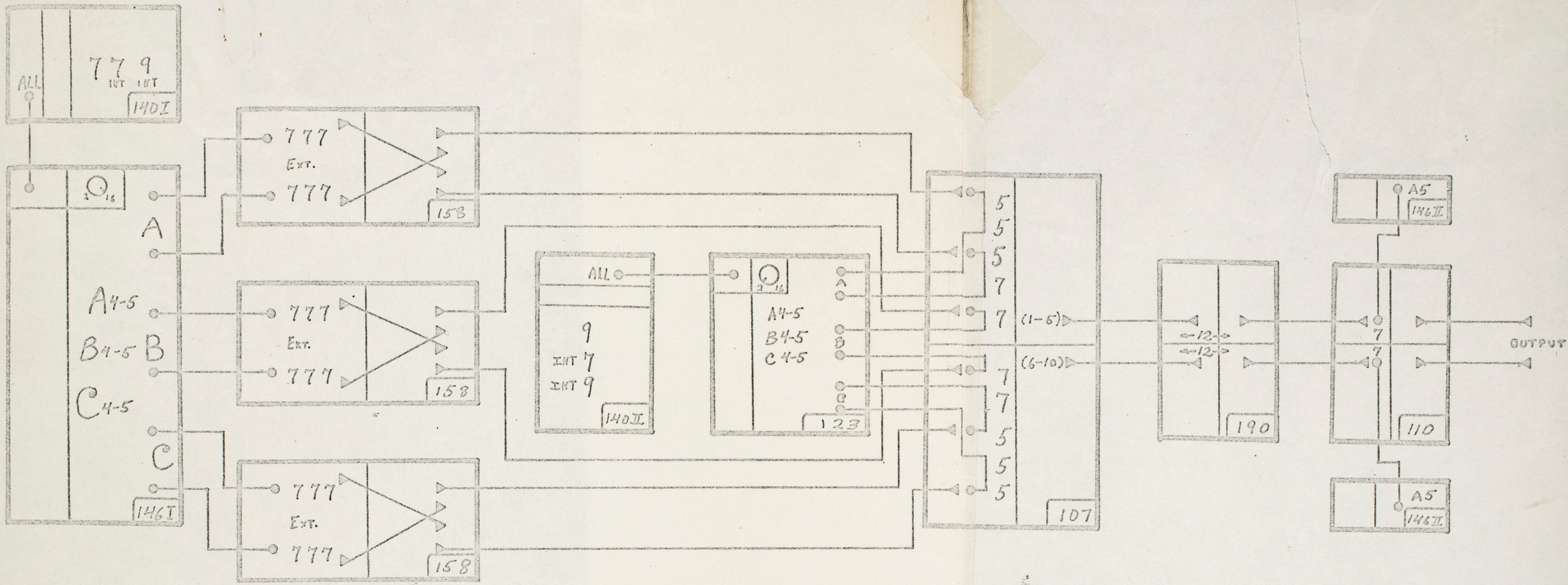

PULL YOURSELF TOGETHER

*Robbie's Class  
Pacific Beach  
March 16, 1970*

