

FIELD NOTES
of part of
T. 9 S. R. 2 W. S.B.M.

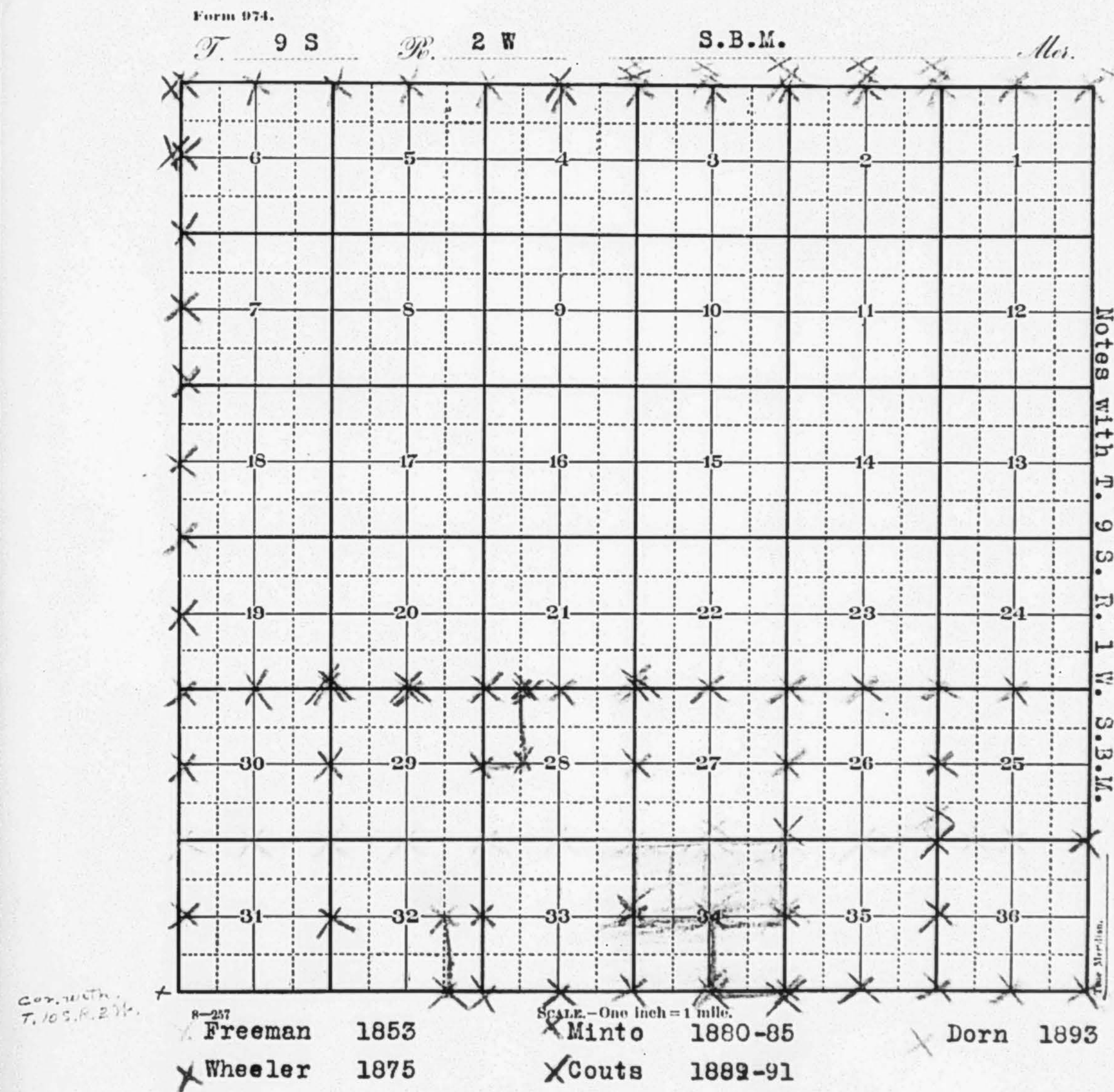

OFFSET IN

T 9 S. R. 2 W. S.B.M.

West bet. secs. 25 and 36.

Va. 12° 15' E.

27.00 Begin to descend hill, course NW. & SE.

36.50 Enter rocky bed of boulders.

40.00 Set 1/4 sec. post, from which a

Sycamore 12 in. dia. brs. N. 62° E. 128 lks.

Sycamore 10 in. dia. brs. S. 16° W. 31 lks.

58.50 San Luis Rey creek 70 lks. wide course NW., along the base of high mountain.

Set post for witness cor., from which a

Sycamore 16 in. dia. brs. N. 10° E. 16 lks.

Sycamore 8 in. dia. brs. N. 5° W. 80 lks.

Offset North 8.00 chs.

80.00 To line bet. secs. 25 and 26. At N. base of same mountain and S. of creek.

Some timber along creek.

Land, part level, part broken, 2nd rate. Some weeds.

West from point in line 8 chs. N. of cor. to secs. 25 and 26.

Va. 12° 15' E.

West 20.00 chs.

South 8.00 chs. to line bet. secs. 26 and 35.

20.00 Set post for witness cor., from which a

Black oak 10 in. dia. brs. S. 42° E. 172 lks.

Make trench as per inst.

40.00 Set 1/4 sec. post. Deposited rock 6 x 12. Make mound with trench as per inst. One pit 10 lks. S., one pit 10 lks. NW.

Va. 14° E.

Offset in
T. 9 S. R. 2 W. S.B.M.

58.50 Descend to foot of mountain, course NW. & SW.

61.00 Same creek 60 lks. wide course S. 60° W. 12 in. deep.

80.00 Set post cor. of secs. 26, 27, 34 and 35., from which a Willow 5 in. dia. brs. S. 89° 30' E. 190 lks.

Make trench as per inst.

SW. cor. of adobe fence brs. N. 35° W.

West of creek very sandy; E. of creek mountains.

December 20, 1853

West bet. secs. 27 and 34.

Va. 12° 30' E.

7.00 Trail N. & S.

19.00 Trail course N. & S.

20.50 Willow 10 in. dia.

30.00 A trail course N.

40.00 Set 1/4 sec. post, from which a

Willow 6 in. dia. brs. N. 61° W. 30 lks.

Made trench as per inst.

47.00 Enter Indian field course N. & S.

50.00 Leave same, course N. & S.

71.00 To bend of San Luis Rey creek.

75.00 Cross part of creek course NW.

80.00 To cor. of secs. 27, 28, 33 and 34, from which a

Willow 6 in. dia. brs. S. 29° W. 210 lks.

Willow 10 in. dia. brs. S 5° E 197 lks.

Made trench as per inst.

Land level, soil mostly 1st rate.

Growth, willow, vines and mustard.

Offset in

T. 9 S. R. 2 W. S.B.M.

West bet. secs. 28 and 33.

Va. 13° 15' E.

- 28.50 Mission or San Luis Rey creek, course W. Line runs in creek.
Offset SOUTH 200 lks.
- 38.50 Reduce offset and came back to line and leave creek, course SW.
- 40.00 Set 1/4 sec. post, from which a
Willow 7 in. dia. brs. S. 40° E. 19 lks.
Willow 8 in. dia. brs. N. 15° E. 41 lks.
- 42.00 Stream 25 lks. wide course NW. Part of Mission creek.
- 55.50 Cross same, course SW.
- 61.00 Leave willow thicket and enter wild mustard, course S. 5° W. & N. 70° E.
- 65.00 Trail N. 55° E. to Mission.
- 77.00 Leave mustard.
- 79.50 A stream 15 lks. wide course SW., rapid current.
- 80.00 Set post, cor. of secs. 28, 29, 32 and 33, from which an
Alder 8 in. dia. brs. S. 68½° E. 87 lks.
A Willow 8 in. dia. brs. S. 61° W. 59 lks.
Another 6 in. dia. N. 57½° W. 95 lks.
Another 4 in. dia. brs. N. 21° E. 73 lks.
- Level soil, sandy and loam.
- Along line on E. 1/2 is willow, vines and weeds. W. end 1st rate.

West bet. secs. 29 and 32.

Va. 12° 31' E.

- 11.50 Road to Pala Rancheria and Old Mission, from San Luis Rey, course S. 60° W. & NE.
- 19.00 Pala Mission brs. N. 76½° E.

Offset in

T. 9 S. R. 2 W. S.B.M.

- 40.00 Set 1/4 sec. post. Raise mound of earth and stone with trench as per inst.
- 45.00 Commence ascending mountain, course S.
- 67.00 House brs. S. 27½° E. on S. side of the creek valley.
- 80.00 Set post, cor. of secs. 29, 30, 31 and 32.
E. 1/2 level, 2nd rate; W. 1/2, steep mountain, 3d rate.
Soil, clay, loam and sand.
Deposited rock 6 x 6, and raised mound with trench as per inst.

West bet. secs. 30 and 31.

Va. 12° 30' E.

- 1.00 Top of mountain, course S.
- 30.00 Descend to base of mountain.
- 40.00 Set 1/4 sec. post. Deposited quartz rock 8 x 8, and raised mound with trench as per inst.
- 59.00 Dry bed of stream 20 lks. wide, course S.
Enter chaparral. Brush N. & S.
- 80.00 To Tp. line. Set post, cor. of secs. 25, 30, 31 and 36.
Deposited rock 5 x 5 and raise mound with trench as per inst.
Land, 3d rate. E. 1/2, rocky and mountains; W. 1/2, brushy, some grass along bed of stream.

December 21, 1853

Vol. 250-4

JAMES E. BREEMAN

Commence this survey at the established SW. cor. of the Tp.

Thence

North on random line bet. secs. 31 and 36, R. 2 & 3 W.

Va. 13° E.

9.00 Top of low ridge course E. & W. Descend.
 13.00 A ravine 100 lks. wide runs NE.
 Var. changes to 14° E.
 35.00 A ravine 50 lks. wide runs E.
 40.00 Set temp. 1/4 sec. cor.
 41.00 A gulch 20 lks. wide runs E.
 53.50 A gully 25 lks. wide runs E.
 64.00 Top of ridge course E. & W.
 82.20 Int. established cor. to secs. 30 and 31, 25 and 36, Rs. 2 and 3 W
 from which cor. I run
 South on a true line bet. secs. 31 and 36.
 Va. 14° E.
 42.20 Set a granite 24 x 18 x 10, for 1/4 sec. cor. on E. face of low hill.
 Double live oak 14 and 10 ins. dia. S. 80° E. 40 lks. dist.
 82.20 The cor. to Tps. 9 and 10 S. Rs. 2 and 3 W.
 Land low, brushy hills, 3d rate.

 From the cor. to secs. 30 and 31,
 North bet. secs. 25 and 30.
 Va. 14° E.
 Along E. face of hill.
 40.00 Set granite 30 x 20 x 15 for 1/4 sec. cor. on brushy hillside sloping
 East.
 53.00 A creek 8 lks. wide, in timbered ravine 100 lks. wide runs SE.

53.20 A Sycamore 18 in. dia. on line.
 74.50 A gulch 20 lks. wide runs SW.
 80.00 Deposited charred stake and set granite 18 x 12 x 8 for cor. to
 secs. 19 and 30, 24 and 25, at W. base of hill.
 Land brushy hillsides, 4th rate.
 Timber, scattering oak and sycamore in ravine.

 North bet. secs. 19 and 24.
 Va. 13° E.
 4.70 A gully 10 lks. wide runs SW.
 10.00 A gully 20 lks. wide runs SW.
 14.50 A gulch 50 lks. wide runs SW.
 25.00 A ravine 30 lks. wide runs SW.
 40.00 Set oak post 4 ft. long 3 ins. dia. 12 ins. deep in earth mound
 with 2 pits, 18 ins. sq. 12 ins. deep, for 1/4 sec. cor., in
 thick brush.
 41.00 A creek 5 lks. wide runs SW.
 51.00 A gully 10 lks. wide runs W.
 62.00 Enter barren hills.
 70.50 A creek 5 lks. wide runs W. Ascend.
 76.00 Top of red hills, descend.
 Va. 12° E.
 79.50 A creek 3 lks. wide runs W.
 80.00 Deposited charred stake, and set granite 14 x 12 x 8 for cor. to
 secs. 18, 19, 13 and 24.
 Land broken, brushy hills, 4th rate.

February 15, 1875

North bet. secs. 13 and 18.

Va. 12° E.

10.00 Top of ridge course E. & W. Descend.
 21.00 A creek 8 lks. wide runs W. Ascend.
 36.00 Top of ridge course E. & W. Descend.
 40.00 Set granite 16 x 14 x 3 on N. face of hill, for 1/4 sec. cor.
 43.00 A ravine 75 lks. wide, runs W.
 60.20 A creek 5 lks. in ravine, 150 lks. wide, runs N. 70° W.
 75.50 A ravine 50 lks. wide runs W.
 80.00 Deposited charred stake, and set granite 24 x 15 x 12, for cor. to secs. 7, 18, 12 and 13, on small flat, some 15 chs. E. of S. end Vallecitos.
 Land, rough hills; 4th rate.

North bet. secs. 7 and 12.

Va. 12° E.

21.30 Top of low ridge course E. & W.
 Larsen's house brs. N. 40° W.
 Romero's house brs. N. 34° W.
 40.00 To a granite boulder 24 in. high, marked for 1/4 sec. cor
 47.30 A creek 3 lks. wide runs NW.
 61.00 Enter side of Vallecitos valley.
 80.00 Set sycamore post 4 ft. long 4 in. sq. 12 in. deep, deposited charred stake and built earth mound, for cor. to secs. 6, 7, 1 and 12; also drove another stake 2 1/2 in. sq. marked like true cor. in the pit SE. of the cor. The pits are 18 in. sq. 12 ins. deep and are placed 6 ft. from the cor. post.
 Larson's house brs. S. 81 1/2° W.
 Romero's house brs. S. 87° W.

A Sycamore 18 in. dia. N. 14° W. 575 lks. dist.
 Land rough hills, 4th rate. Valley 1st rate.

North bet. secs. 1 and 6.

Va. 12° E.

6.50 A creek 10 lks. wide runs S. 80° W.
 12.00 Leave Vallecitos, ascend along W. slope of hills.
 40.00 Set a granite 30 x 24 x 12 on W. slope of a rough hill, for 1/4 sec. cor.

Black oak 12 in. dia. N. 35 1/2° E. 60 lks. dist.
 63.00 Top of ridge, dividing the two Vallecitos, course E. & W.
 80.00 Set oak post 4 1/2 ft. long 4 in. sq. 12 ins. deposited charred stake and raised a stone mound for cor. to Tps. 8 and 9 S. Rs. 2 and 3 W. on W. face of hill, about 10.00 chs. E. of road from San Luis Rey to Temecula.

Black oak 18 in. dia. S. 11 1/2° W. 550 lks. dist.
 Land rough hilly, bordering the Vallecitos, 4th rate.
 Timber, very scattering oak.

February 16, 1875

From the cor. to secs. 1, 2, 11 and 12,
 North on true line bet. secs. 1 and 2.

Va. 12° E.

80.00 Deposited charred stake, set an oak post, 4 ft. long 4 in. sq. in earth mound for cor. to secs. 1, 2, 35 and 36, and N.B. of Tp. 8.

Also drove an oak stake $2\frac{1}{2}$ in. sq. marked like true cor. in pit, SE. of cor. The pits being 18 in. sq. 12 in. deep and 6 ft. from the cor. stake.

Land S. 30.00 chs., level mesa, 3d rate; balance low, broken hills at base of Smith's mountains.

February 23, 1875

West bet. secs. 2 and 35, Tps. 8 and 9 S. R. 2 W.

Va. 13° E.

31.00 Enter timbered ravine, course NW.
34.00 Leave same, and ascend.
40.00 Set granite 16 x 8 x 8 on N. face of brushy hill, for $\frac{1}{4}$ sec. cor.
55.00 Top of hill and enter level mesa.
72.40 Road to Temecula course NW. & SE.
80.00 Set granite 16 x 12 x 8, and deposited charred stake, for cor. to secs. 2, 3, 34 and 35.
Land E 55.00 chs. low, rough hills, worthless; balance, level, 3d rate. Timber, oak in ravine.

West bet. secs. 3 and 34.

Va. $12^{\circ} 15'$ E.

40.00 Set granite 16 x 12 x 12 for $\frac{1}{4}$ sec. cor.
46.00 A dry wash 50 lks. wide runs S.
53.70 A trail course N. & S.
65.00 Top of low ridge course N. & S.
80.00 To an oak 10 in. in dia. at N. base of rocky knoll, marked for cor. to secs. 3, 4, 33 and 34.
Land level and brushy, 3d rate.

West bet. secs. 4 and 33.

Va. 13° E.

10.20 New road from Pala to Temecula course N. & S.
24.00 A ravine 150 lks. wide runs NE. Ascend.
40.00 Set granite 16 x 12 x 6 on E. face of a rocky mountain, for $\frac{1}{4}$ sec. cor.
Country too rough to continue the line, it being a mass of boulders from this point to NW. cor. of Tp.
Land rolling, 3d rate. Timber, scattering oak.

February 24, 1875

T. 9 S. R. 2 W. S.B.M.

From the established witness cor. 8.00 chs. N. of true cor. to secs. 25, 26, 35 and 36,
North bet. secs. 25 and 26.

Va. 13° E.

13.00 San Luis Rey river 50 lks. wide runs W.
15.00 Enter mesa; the Indian, Sebastian's house brs. S. 50° W., some 20.00 chs. dist.
25.50 Road from Pala to Pauma, E. & W.
29.00 Road from Pala to Aqua Tepia, course NE. & SW.
32.00 Set elder post 4 in. dia. 4 ft. long 12 in. deep in stone mound for $\frac{1}{4}$ sec. cor.
45.50 A wash 75 lks. wide runs SW.
64.50 A wash 50 lks. wide runs SW.
72.00 Deposited charred stake, and set sycamore post 4 ft. long 4 in. dia

in stone mound for cor. to secs. 23, 24, 25 and 26.
Land level mesa, 3d rate. Valley along the river, 2nd rate.
Timber, scattering sycamore along river.

February 19, 1875

East on random line bet. secs. 24 and 25.

Va. 13° 30' E.

4.00 A wash 50 lks. wide runs SW.
22.00 A wash 75 lks. wide runs SW.
25.00 A road course N. & S.
32.00 Leave mesa and ascend rough hill.
40.00 Set temp. 1/4 sec. cor.
60.00 Top of ridge course N. & S. Descend.
80.42 Int. E.B. of Tp. 12 lks. N. of cor. to secs. 24 and 25,
from which cor. I run
N. 89° 55' W. on true line bet. secs. 24 and 25.
Va. 12° 15' E.
40.21 Set granite 18 x 14 x 8 on W. face of rocky hill, for 1/4 sec. cor.
80.42 The cor. to secs. 23, 24, 25 and 26.
Land rolling, stony, soil 3d rate.

From the established cor. to secs. 26, 27, 34 and 35,
South bet. secs. 34 and 35.

Va. 13° 30' E.

15.00 Enter mesa and follow W. face of rough mountain.
40.00 Set alder post 4 ft. long 4 in. dia. 12 in. deep in earth mound
with pits 18 in. sq. and 12 ins. deep, for 1/4 sec. cor., on Indian
rancho brs. N. 66° W. about 20.00 chs. dist.

57.50 A ravine 20 lks. wide runs NW.
73.00 A ravine 40 lks. wide runs NW.
80.00 Deposited charred stake, set elder post, 4 ft. long, 4 ins. dia.
in earth mound for cor. to secs. 34, 35, 2 and 3.

Black oak 15 in. dia. S. 70° W. 33 lks. dist.

Land E. of line, rough mountains, worthless; W. of line, low
table land, 2nd rate

From cor. to secs. 26, 27, 34 and 35,
North bet. secs. 26 and 27.

Va. 13° 30' E.

22.50 To left bank of San Luis Rey river runs W.
27.00 To right bank of San Luis Rey river.
30.00 Leave river bottom and enter level mesa.
32.00 Road from Palo to Pauma, course E. & W.
39.00 Belfry to Palo church brs. S. 85° W.
40.00 Set elder post, 3 in. sq. 4 ft. long 12 in. deep in earth mound for
1/4 sec. cor., with pits 18 in. sq. 12 ins. deep.
52.00 A gully 25 lks. wide runs SW.
64.75 A trail course NE. & SW.
80.00 Set sycamore post in stone mound, cor. to secs. 22, 23, 26 and 27.
Belfry to Palo church brs. S. 31° W.
Sycamore 15 in. dia. N. 75° W. 230 lks. dist.
Sycamore 18 in. dia. N. 64° E. 310 lks. dist.
Land level, 2nd rate. Valley sandy mesa, stony.

East, random line bet. secs. 23 and 26.

Va. 13° 30' E.

8.00 A wash 50 lks. wide runs SW.
 14.00 A trail course NE. & SW.
 22.50 A gully 25 lks. wide runs SW.
 40.00 Set temp. 1/4 sec. cor.
 62.00 A wash 40 lks. wide runs SW.
 79.86 Int. cor. to secs. 23, 24, 25 and 26, from which cor. I run
 West on true line bet. secs. 23 and 26.

Va. 13° 30' E.

39.93 Set sycamore post 5 in. dia. 4 ft. long, set 12 in. deep in earth
 mound for 1/4 sec. cor., with pits 18 in. sq. 12 in. deep.
 79.86 The cor. to secs. 22, 23, 26 and 27.
 Land level mesa, 2nd rate.

 From established cor. to secs. 27, 28, 33 and 34,
 South bet. secs. 33 and 34.

Va. 13° 30' E.

9.00 A road course E. & W.
 20.00 An Indian hut brs. S. 84° W. 60 lks. dist.
 33.00 An Indian hut on line.
 35.00 An Indian hut 100 lks. W. of line.
 Leave valley and ascend.
 40.00 Set elder post 4 ft. long 3 in. dia. 12 in. deep in earth mound, at
 base of a rough mountain, for 1/4 sec. cor., with pits (two) 18 in
 sq. 12 in. deep.
 Country too rough to continue the line further.
 Land in valley, 1st rate. Timber, cottonwood and willow.

 East through sec. 34, descending.

Va. 13° 30' E.

2.00 A brush fence course N. & S. Enter valley.
 5.10 A brush fence course N. & S.
 8.80 A trail course N. & S.
 31.00 A brush fence course N. & S.
 40.00 Set elder post 3½ ft. dia. 4 ft. long 12 in. deep in earth mound on
 S. side of valley, for interior 1/4 sec. cor.
 Land 1st rate.

 South through sec. 34, descending.

Va. 13° 30' E.

13.00 Top of low hill, descend.
 20.00 A ravine 50 lks. wide runs SE. Ascend.
 27.00 Top of ridge course E. & W.
 36.00 A ravine 25 lks. wide runs E.
 40.00 Set oak post 4 in. dia. 4 ft. long 12 in. deep, in earth mound,
 on N. face of steep hill for 1/4 sec. cor. and Tp. line bet. secs.
 3 and 34.
 Land, low hills, 3d rate.

 East bet. secs. 3 and 34, descending.

Va. 13° 30' E.

10.00 A ravine 20 lks. wide runs NE.
 13.75 A ravine 25 lks. wide runs NE.
 15.00 A ravine 30 lks. wide runs N.
 28.00 A gully 10 lks. wide runs NE.
 33.00 Enter a ravine running N.
 35.00 Road from San Diego to Pala course N. & S.
 37.00 A dry wash 50 lks. wide runs N. 20° W.

40.12 Int. cor. to secs. 34 and 35.
Land, low hills, 3d rate, grazing. Timber, scattering oak in ravine.

From the cor. to secs. 27, 28, 33 and 34,
North bet. secs. 27 and 28.
Va. 13° 30' E.

22.50 Left bank of San Luis Rey river runs W.
24.00 Right bank of same.
33.00 Ascend to low hills.
37.50 Road from San Luis Rey to Palo course E. & W.
40.00 Set sycamore post 4 in. dia. 4 ft. long 12 in. deep in earth mound
for 1/4 sec. cor.
An adobe house brs. S. 84° E.

47.00 An adobe house brs. S. 60° E.
64.00 A trail course E. & W.
72.00 A ravine 25 lks. wide runs SW. Ascend.
80.00 Deposited charred stake and set sycamore post 4 ft. long 4 ins. sq
12 ins. deep in earth mound for cor. to secs. 21, 22, 27 and 28,
on S. face of hill, also drove another sycamore post 2½ in. sq.
marked like the true cor. in pit SE. of cor.; the pits being 18 in
sq. 12 in. deep, and 6 ft. from cor. post.
Land valley, sandy 2nd rate; balance grazing hills, 3d rate.
Timber cottonwood in valley.

East on random line bet. secs. 22 and 27.
Va. 13° E.

3.00 A ravine 25 lks. wide runs SW.
6.00 Top of ridge course N. & S.
13.00 A ravine 100 lks. wide runs S.

15.

24.00 A creek 5 lks. wide runs S., enter level mesa.
35.50 Road from Pala to Temecula, course N. & S.
40 .00 Set temp. 1/4 sec. cor.
80.24 Int. N. & S. line 35 lks. S. of cor. to secs. 22, 23, 26 and 27,
from which cor. I run
S. 89° 45' W. on true line bet. secs. 22 and 27.
Va. 13° 30' E.

40.12 Set sycamore post 3 in. dia. 4 ft. long 12 in. deep in stone mound
for 1/4 sec. cor.
80.24 The cor. to secs. 21, 22, 27 and 28.
Land W. 24.00 chs. low hill, 3d rate.; balance level mesa, 2nd rate.
February 27, 1875

From the established cor. to secs. 28 29, 32 and 33,
South bet. secs. 32 and 33.
Va. 13° 15' E.

9.00 Right bank of San Luis Rey river runs SW.
11.00 Left bank of San Luis Rey river.
20.25 Road course NE. & SW.
25.00 Leave valley and ascend along W. slope of rough mountain.
26.70 A triple black oak on line.
37.00 A ravine 75 lks. wide runs NW.
40.00 Set granite stone 18 x 12 x 4 for 1/4 sec. cor. on W. face of hill
Country too rough to continue the line further.
Land, valley moist, sandy, 2nd rate; balance worthless.
Timber, cottonwood in valley, and scattering oak around base of hills

West through sec. 32, descending.
Va. 13° 15' E.

16.

8.00 Foot of hill, enter valley, course NE. & SW.
Narbold's house brs. S. 12° W.

20.00 To station and set sycamore post, 3 in. dia. 4 ft. long 12 in.
deep in earth mound.
Harbolt's house brs. S. 41° E.

South

Va. 13° 15' E.

28.00 Road course NE. & SW., leave valley and ascend.

37.00 A ravine 75 lks. wide runs NW.

40.00 To S. bdy. of Tp. set oak post 4 ft. long 4 in. dia. and 12 in.
deep, in earth mound at W. base of rough mountain, for witness cor.
to secs. 32, 33, 4 and 5.

Black oak 10 in. dia. S. 55° E. 75 lks. dist.

Land, valley 1st rate; balance rocky, worthless hills.

Timber, very scattering oak, along base of mountain.

From cor. to secs. 28, 29, 32 and 33,
North bet. secs. 28 and 29.

Va. 13° 15' E.

1.75 A creek 20 lks. wide runs SW.

17.75 Road from San Luis Rey to Pala course NE. & SW. Leave valley and
ascend rough, steep hills.

40.00 Set granite 14 x 12 x 8 on S. face of steep hills for 1/4 sec. cor.
Country too rough to continue the line.
Land, valley 1st rate; balance, rough hillside, 4th rate.

Thence offset

EAST, descending.

Va. 13° 15' E.

8.00 A ravine 40 lks. wide runs SE.

19.00 Foot of hill, enter valley.

20.00 Set sycamore post 4 in. dia. 4 ft. long 12 in. deep in earth mound.
An Indian hut brs. S. 80° W. 80 lks. dist.
Thence
North along E. base of rough mountains.

Va. 13° 15' E.

31.00 A creek 5 lks. wide runs SE.

36.00 Leave ravine and ascend.

40.00 Set granite 20 x 10 x 6 for witness cor. to cor. secs. 20, 21, 28
and 29, 20.00 chs. E. of true cor. on W. face of hill.
Land, valley sandy, 2nd rate; balance rough hills of but little
value. Timber, sycamore, scattering along the creek.

East on random line bet. secs. 21 and 28.

Va. 13° 15' E.

Ascending.

12.50 A ravine 50 lks. wide runs SW.

20.00 Set temp. 1/4 sec. cor. on ridge, running W. & S.

27.00 A ravine 50 lks. wide runs S.

60.22 Int. N. & S. line 40 lks. S. of cor. to secs. 21, 22, 27 and 28,
from which cor. I run
S. 89° 37' W. on true line bet. secs. 21 and 28.

Va. 13° E.

40.14 Set granite 20 x 10 x 4 for 1/4 sec. cor.

60.22 To witness cor. to secs. 20, 21, 28 and 29.
Land rough hills, 3d rate, grazing.

From the established cor. to secs. 29, 30, 31 and 32
South bet. secs. 31 and 32.

Va. 12° 30' E.

8.00 Descend.
Wertz' house brs. S. 29° E.

26.00 A ravine 40 lks. wide runs SE.

29.00 Top of ridge runs E. & W.

34.50 A ravine 30 lks. wide runs E.

40.00 Set granite 20 x 16 x 8 on E. face of a hill for 1/4 sec. cor.
Werty's house brs. S. 66° E.

78.00 Enter valley course E. & W.

79.00 A creek 10 lks. wide runs W.

80.00 Set redwood post 4 ft. long 4 in. sq. in earth mound for cor. to
secs. 31, 32, 6 and 5, from which brs. a
Sycamore 10 in. dia. S. 33° W. 55 lks. dist.
Cottonwood 15 in. dia. S. 72° E. 45 lks. dist.
D. H. Wright's house N. 45° W. 400 lks. dist.
Land, low hills, 3d rate.
Timber, cottonwood and sycamore in valley.

East on random line along S.B. of sec. 32, and N.B. of sec. 5.
Va. 13° E.

23.25 Road from San Luis Rey to Pala course N. & S.

24.00 Right bank of San Luis Rey river course SW.

26.50 Left bank of same.

40.00 Set temp. 1/4 sec. cor. in Dr. Wright's garden.

41.25 Road course NE. & SW. Leave valley and ascend.

51.00 Dr. Wright's house brs. N. 32° W. 10 chs. dist.

59.86 Int. N. & S. line 14 lks. N. of witness cor. to cor. secs. 32 and 33

from which cor. I run
N. 89° 52' W. on true line along S.B. of sec. 32.

Va. 13° E.

19.95 Set a sycamore post 3 in. dia. 4 ft. long 12 in. deep in earth
mound for 1/4 sec. cor.

59.86 The cor. to secs. 31 and 32.
Land valley, 1st rate; balance low hills, 2nd rate.
Timber, cottonwood and sycamore in valley.

West on random line along S.B. of sec. 31.

Va. 13° E.

3.40 A road course N. & S.

18.00 A creek 10 lks. wide runs S. 70° W.

36.50 A road course N. & S.

40.00 Set temp. 1/4 sec. cor.

49.00 A creek 30 lks. wide runs S.

56.00 Ascend low hill.

72.00 Top of ridge course N. & S.

80.70 Int. W.B. of Tp. 205 lks. N. of SW. cor., from which cor. I run
N. 88° 32' E. on true line along the S.B. of sec. 31.
Va. 13° E.

31.00 A creek 30 lks. wide runs S.

40.70 Set granite 16 x 10 x 6 for 1/4 sec. cor. in valley 300 lks. N.
of San Luis Rey river.

59.00 A creek 10 lks. wide runs S. 70° W.

80.70 The cor. to secs. 31 and 32.
Land valley, 1st rate; balance 2nd rate hills.
Timber, cottonwood and sycamore in valley

From cor. to secs. 29, 30, 31 and 32.

North bet. secs. 29 and 30.

Va. 12° 30' E.

- 9.50 A ravine 50 lks. wide runs NW. & follows along W. slope of hill.
 40.00 Set oak post 3 in. dia. 4 ft. long 12 in. deep in earth mound for 1/4 sec. cor.
 44.00 A ravine 75 lks. wide runs W.
 53.00 Top of low ridge runs E. & W. Descend.
 70.00 Foot of hill, enter bushy flat.
 80.00 Deposited charred stake, and set granite 20 x 12 x 4, 15 in. deep for cor. to secs. 19, 20, 29 and 30.
 Land, low brushy hills, 3d rate.

East on true line bet. secs. 20 and 29.

Va. 12° 30' E.

- 15.00 Ascend and follow N. slope of hill.
 40.00 Set granite 16 x 8 x 6 for 1/4 sec. cor., on the N. slope of rough hill.
 Country too rough to continue the line.
 Land, W. 15.00 chs. level, 2nd rate; balance rough 4th rate.

From cor. to secs. 19, 20, 29 and 30

West on random line bet. secs. 19 and 30.

Va. 12° 30' E.

- 0.10 A road course NE. & SW.
 14.00 A timbered ravine 100 lks. wide runs S. Ascend.
 40.00 Set temp. 1/4 sec. cor.
 53.00 Top of high ridge, runs N. & S. Descend.

74.50 A ravine 50 lks. wide runs SW.

79.88 Int. W.B. of Tp. 22 lks. N. of cor. to secs. 19 and 30, from which cor. I run N. 89° 51' E. on true line bet. secs. 19 and 30.

Va. 13° E.

39.88 Set granite 24 x 18 x 12 for 1/4 sec. cor.

79.88 The cor. to secs. 19, 20, 29 and 30.

Land rolling, brushy 3d rate.

Timber, oak and sycamore in ravine.

March 5, 1875

M. G. WHEELER.

Vol. 300-34

From the cor. to secs. 2, and 3, T. 9 S. R. 2 W.

EAST on a true line on N.B. of sec. 2.

Va. 12° 57' E.

This cor. is a stone as described in Wheeler's Notes.

Ascend.

5.30 A road course NW. & SE.

28.00 Descend.

40.00 Find no 1/4 sec. cor. Set granite stone 22 x 10 x 5 for 1/4 sec. cor. Made a mound 24 in. high, pits 24 x 18 x 12 as inst.
 A granite boulder 6 ft. high E. 3 lks.

41.68 Dry creek 40 lks. wide runs NW. in deep canon. Ascend.
 80.00 Find no cor. Set post 60 x 4 x 4 in, 18 in. deep for Stand.
 cor. to secs. 1 and 2, Made a mound 24 ins. high with pits
 24 x 18 x 12 as per inst.
 Land broken and mountainous. Soil 2nd and 3d rate. Chaparral.

East on random line on N.B. sec. 1.
 Va. 13° E.

Ascend.

20.50 Ravine course NW.
 40.00 Set temp. 1/4 sec. cor. Steep ascent.
 92.00 Ravine course NW.
 99.52 Int. the line bet. Rs. 1 and 2 W. 17.42 chs. N. of the closing cor.
 to Tps. 8 S. 1 and 2 W.
 This error is so great that it seems better to set a closing cor.
 than to run a diagonal line and I set a granite stone 18 x 16 x 7 ins.
 for closing cor. to Tps. 8 and 9 S. R. 2 W. Made stone mound 30 in.
 high, thence
 West on true line on NB. of sec. 1.
 Va. 13° E.

59.52 Set post 48 x 3 x 3 in. 12 in. deep for 1/4 sec. cor., made a stone
 mound 18 in. high.
 99.52 To cor. to secs. 1 and 2.
 Land steep W. slope of mountain, soil 2d rate. Chaparral.

From the standard cor. to sec. 2 and 3, T. 9 S.
 West on blank line on N.B. of sec. 3.
 Va. 12° 57' E.

39.60 To a point 10 lks. S. of 1/4 sec. cor.
 47.00 Dry creek 50 lks. wide runs S. 20° W. Ascend.
 78.94 The cor. to secs. 3 and 4, an oak, as per Wheeler's notes.

West on N.B. of sec. 4.
 Va. 13° 39' E.

Descend.

9.70 Road to Pala N. 25° E. & S. 25° W. Ascend.
 40.00 Find no cor. Set granite stone 30 x 14 x 5 in. for 1/4 sec. cor.,
 made stone mound 24 in. high.
 63.00 Summit of mountain SE. & N. 65° W.
 80.00 Set granite 20 x 15 x 8 in. for standard cor. to secs. 4 and 5,
 and made mound of stone on a large granite ledge.
 Land mountainous, soil 2nd and 3d rate. Rocky. Chaparral.
 June 12, 1880

West on random line on N.B. of secs. 5 and 6.
 Va. 13° E.

Set temp. cors. at 40 chs. and at 158.13 chs. to a point 12.40 chs.
 S. of the standard cor. to Tps. 9 S. Rs. 2 and 3 W. which agrees
 with the Notes from the Surveyor-General's office.
 Thence
 S. 85° 31' E. on true line on N.B. of sec. 6.
 Va. 11° 51' E.

Ascend mountain.

20.00 Spur sloping S.
 38.24 Set granite stone 28 x 20 x 10 in for 1/4 sec. cor., made stone
 mound 24 in. high.

78.36 Set granite stone 30 x 18 x 10 in for standard cor. to secs. 5 & 6.
Made stone mound 24 in. high, pits, 24 x 18 x 12, located as per
inst.

Land rock mountain, soil 2nd and 3d rate. Chaparral.

S. 85° 31' E. on true line on N.B. of sec. 5.

Va. 12° E.

Ascend.

19.00 Ravine course S. 20° W.

40.12 Set granite stone 20 x 14 x 8 for 1/4 sec. cor., made mound 24 in.
high, pits 24 x 18 x 12, as per inst.

52.00 Spur sloping S.

66.50 Ravine course S. (Timber)

80.25 To cor. to secs. 4 and 5.

Land mountainous, soil, 2nd and 3d rate.

Rocky. Chaparral.

June 14, 1880

WM. MINTO.

Vol. 195-14

From the cor. to secs. 33 and 34, on 2nd standard S. R. 2 W.,
a granite stone 14 in. above the ground 15 x 5 marked with 3 notches
on E. & W. cors. and C.C. in a stone mound.

I run

East on S.B. of sec. 34.

Va. 13° 45' E.

7.25 An Indian trail, course NE.

10.70 Road course N. & S.

13.00 Dry creek 50 lks. wide runs S. in deep ravine.

20.78 To 1/4 sec. cor., a stone mound.

40.00 Set a granite stone 20 x 8 x 8 in. marked 1/4, 10 in. deep for
1/4 sec. cor. S. of sec. 34.

60.32 Standard cor. to secs. 2 and 3, a granite stone agreeing with the
notes from the Surveyor General's office, in a stone mound.

64.85 An old mound course NW. & SE.

79 98 To cor. to secs. 34 and 35, a granite stone 10 in. above ground,
18 x 13 in. marked with 2 notches on E. and 4 on W. and C.C.

Land mountainous and broken, soil 2nd and 3d rate.

Dense growth of chaparral.

× East on S.B. of sec. 35.

Va. 15° E.

9.50 Descend.

10.50 Ravine course N.

20.40 To 1/4 sec. cor. N. of sec. 2, a granite stone 10 x 5 in. marked
1/4 in mound, a granite boulder 6 ft. high brs. E. 3 lks.

22.00 Dry creek 45 lks. wide runs NW. Steep ascent.

50.00 A sharp broken ridge course NW. & SE.

52.00 Along N. slope

60.60 To cor. to secs. 1 and 2, a post 4 x 4 in. marked T. 9 S. R. 2 W.
S. 1 and S. 2, with 1 notch on E. and 5 to W. and S.C. in mound,
and pits as per inst.

62.00 A sharp spur sloping N.

80.13 To cor. to secs. 35 and 36, a granite stone 8 x 8 in. marked 1 notch

on E. and 5 to W. and C.C., from which brs. a
Live oak 20 in. dia. N. $62\frac{1}{2}^{\circ}$ W. 184 lks. dist.
marked T. 8 S. R. 2 W. S. 35 B.T.
Made the stone mound 24 in. high alongside.
Land very rough and mountainous, soil 2nd and 3d rate.
Dense growth of chaparral.

July 21, 1885

WM. MINTO.

Vol. 382-27

May 4, 1889

Commenced from 1/4 sec. cor. bet. secs. 34 and 3 on N.B. of Tp.
which I found on N. slope of hill and being an oak post 3 ins. sq.
in earth mound 24 in. out of the ground and marked 1/4 on N. face,
WEST on random line along N. line of sec. 3.

Va. $15^{\circ} 30'$ E.

40.00 Set temp. cor. to secs. 4, 3, 33 and 34,
Ascending along very steep rock and brushy Mt.
West on random line along N.B. of sec. 4.

Va. $15^{\circ} 30'$ E.

40.00 Set temp. 1/4 sec. cor.

80.00 Set temp. cor. to secs. 5, 4, 32 and 33.

Thence

West on random line along N.B. of sec. 5

Va. $15^{\circ} 30'$ E.

22.68 To cor. on N. line of sec. 5, set 19.86 chs. from 1/4 sec. cor.
secs. 32, 5; this cor. I found 43 lks. N. of my line and is a
cedar post put in place of oak post (which had rolled and fallen)
by Marion Wright. The old oak post was on the ground but marks
too indistinct to make out. This falling being 24 lks. per mile,
I start from this cor. and ran
S. $89^{\circ} 50'$ E. on true line bet. secs. 32 and 5.

Va. $15^{\circ} 30'$ E.

Ascending.

20.14 Set granite rock 14 x 12 x 12 ins. 8 ins. in the ground for cor.
to secs. 5, 4, 32 and 33, marked with 4 notches on E. and 2 notches
on W. edges and raised a mound of stone alongside.
The land on this 1/4 mile is brushy, rocky and worthless.

Commencing from the 1/4 sec. cor. on N. line of sec. 3, as already
described and having found my falling to be 24 lks. per mile, I ran
N. $89^{\circ} 50'$ W. on true line along N.B. of sec. 3.

Va. $15^{\circ} 30'$ E.

2.50 Small ravine course NE. Ascending.

5.00 Small divide . Descending N. slope of low hill.

15.30 Ravine course N. Ascend.

18.00 Summit of small hill. Descend.

24.00 End of Camach's grain.

33.00 Out of grain.

35.00 Creek 8 lks. wide brs. NW. Ascend rocky and brushy Mt.

40.84 Set granite rock 20 x 10 x 8 ins. 12 ins. in the ground for cor. to
secs. 3, 4, 33, 34, marked with 3 notches on E. and 3 notches on
W. edges and raised a mound of stone alongside. This cor. is on

S. slope of brushy hill.

A Live oak brs. S. 39° W. 320 lks.

The land along this 1/2 mile is of a rolling nature and the 1st 35 chs. of it is grassy and soil is 1st and 2nd rate.

The last 5 chs. is brushy, rocky and worthless.

From cor. to secs. 3, 4, 33 and 34, I ran

N. 89° 50' W. on true line alongside N.B. of sec. 4.

Va. 15° 30' E.

Ascending along S. face of steep rocky Mt.

- 4.70 Gulch 100 lks. wide 26 lks. deep N.
 - 8.00 Ravine brs. NE. towards San Luis Rey valley. Ascend a steep, rocky and brushy Mt.
 - 24.00 Large rock on line, sloping with Mt. 40 lks. high 100 lks. wide. Chainmen had to pull off their shoes to climb and even then it was very difficult.
 - 29.00 Foot of large boulder. Made pile of stones.
 - 33.00 Top of very rocky point.
 - 40.84 Set granite rock 18 x 12 x 4 ins. 10 ins. in the ground for 1/4 sec. cor. marked 1/4 on N. face and raised a mound of stone alongside. This cor. is on small flat on top of 1st rocky Mt. From here ascend a steeper and rockier Mt.
 - 54.00 Top of Mt. Descend very steep and rocky.
 - 62.80 Foot of very steep and broken descent. Thence a gradual descent along W. slope of Mt.
 - 82.70 To cor. secs. 4, 5, 32 and 33.
- The land along this mile is very rocky, mountainous and worthless.

From old cor. to secs. 34, 35, 2 and 3 which I found on E. side of Bear Valley and Pala road, the same being the stump of an oak post in an earth mound, I ran East on N. line of sec. 2.

Va. 15° 30' E.

Ascending.

- 11.00 Gulch 25 lks. wide course NW.
- 40.00 Set granite rock 16 x 6 x 7 in. 8 in. in the ground for 1/4 sec. cor. marked 1/4 on N. face and raised a mound of stone alongside. This cor. is on N. slope of Mt. on rocky point.
- 53.00 Deep rocky canon 75 lks. deep 150 lks. wide with timber course SW.
- 59.00 Cross same canon course NE.
- 78.50 Brushy canon 125 lks. wide course SW.
- 80.00 Set granite rock 20 x 16 x 10 ins. 10 ins. in the ground with 1 notch on E. and 5 notches on W. edges, for cor. to secs. 35, 36, 1 and 2, and raised a mound of stone alongside. This cor. is on E. side of deep ravine and on W. slope of Mt. The land along the 1st 1/2 mile N. & S. of this line is rolling and under cultivation. The soil is 1st and 2nd rate. The last 1/2 mile is broken and rocky and almost worthless.

East along N.B. of sec. 1.

Va. 15° 30' E.

Ascending.

- 20.00 Summit of rocky Mt. Descend into very heavy and high brush, almost impassible on account of rocks and height of brush.
- 40.00 Set granite rock 18 x 10 x 6 in. 10 ins. in the ground for 1/4 sec cor. marked 1/4 on N. face and raised a mound of stone alongside.

This cor. is on E. side of ravine 40 lks. deep, 100 lks. wide, course NW. on N. slope of Mt. Here I was compelled to drop line as it is utterly impracticable to proceed further E.

Mts. are very rocky, brushy and abrupt.

From this cor., I ran

West 20 chs.

From there I started South 20 chs.

Thence East 60 chs.

Thence North 20 chs. where I set granite rock 25 x 8 x 6 ins.

12 ins. in the ground for cor. to Tps. 9 and 10 S. Rs. 1 and 2 W.

marked 6 notches on each edge and raised a mound of stone alongside.

The land along this mile is rocky, brushy and worthless.

May 7, 1889

CAVE J. COUTS.

Vol. 129-25

April 4, 1891

Commencing from cor. to secs. 19, 20, 29, 30, which was shown me by Josiah Cooper and is a granite rock 6 x 10 ins. 8 ins. out of the ground marked with 2 notches on S. and 5 notches on E. edges, in stone mound on W. slope of brushy hill, 06 lks. E. of road, running NE. & SW.

Cooper's house brs. S. 15° W. 14 chs. dist.

From here I ran

North bet. secs. 19 and 20.

From cor. to secs. 21, 22, 27, 28, which was shown me by Cayetano Golch, and which I found on top of ridge sloping S. and is an earth mound with 4 pits, a burnt stake in centre, I set a granite rock 16 x 24 x 30 ins. on top of earth mound and marked it with 3 notches on E. and 2 notches on S. edges, I ran

S. 89° 37' W. to find witness cor. to secs. 20, 21, 28, 29.

Descending.

Va. 13° 15' E.

16.00 Ravine course S. Ascend.

38.00 Ridge course S. Descend.

60.22 Granite rock 6 x 10 x 18 ins. in stone mound, no marks. This cor. is on W. face of brushy, rocky mountain, from which I ran West.

Descending.

Va. 13° 15' E.

4.00 Foot of hill, enter valley.

5.00 Creek 12 lks. wide course SE.

7.00 Foot of hill. Ascend rocky mountain, covered with burnt brush.

20.00 To large black boulder 36 ins. in dia. and 30 ins. above ground, which I marked with a X at exact dist. and 2 notches on S. and 4 notches on E. edges, for cor. to secs. 20, 21, 28, 29.

This cor. is on SE. slope of rocky mountain, covered with burnt brush and is 100 lks. N. of ravine, course SE.

The land along this 20 chs. is steep. Soil in valley is 1st rate.

The balance is rocky and worthless.

From cor. to secs. 20, 21, 28 and 29, I ran

West on random bet. secs. 20 and 29.

Va. 13° 15' E.

40.46 To 1/4 sec. cor. bet. secs. 20 and 29, which I found to be a granite rock 6 x 8 x 16 ins. in stone mound marked 1/4 on N. face, on N. slope of rocky, brushy hill and is 32 lks. N. of my line. From here I ran S. 89° 33' E. on true line bet. secs. 20 and 29. Ascending.

Va. 13° 15' E.

11.00 Foot of steep mountain, very brushy. Ascend and continue along N. slope of mountain.
23.00 Ridge sloping N. + 250. Descend along S. slope of spur projecting E. from Mt.
24.00 Head of ravine 200 lks. S. of line.
40.46 To cor. secs. 20, 21, 28, 29.
The land along this 1/2 mile is steep and broken.
Soil rocky and worthless. April 9th.

Commencing from witness cor. on line bet. secs. 25 and 26, which is 8.00 chs. N. of cor. to secs. 25, 26, 35 36, which is an oak post 4 ft. long 3 ins. sq., no marks in stone mound. This was shown me by Cayetano Golch and is on N. face of mountain, From here I ran South bet. secs. 25 and 26. Ascending.

Va. 13° E.

8.00 Set a granite rock 4 x 16 x 20 ins. 10 ins. in the ground for cor. to secs. 26, 25, 35 36, which I marked with 1 notch on S. & E. edges and raised a mound of stone around it. This cor. is on N. slope of steep mountain.

From cor. to secs. 25, 26, 35 and 36, I ran South on random bet secs. 35 and 36. Ascending.

Va. 13° E.

40.00 Set temp. 1/4 cor.
80.23 Int. S.B. sec. 36, .42 lks. E. of cor. to secs. 35, 36, on S.B. of Tp. This cor. is a granite rock 10 x 14, ins. 10 ins. out of ground marked with 5 notches on W. and 1 notch on E. edges and is on W. slope of mountain, on E. side of deep ravine, which runs SW. From here I ran N. 0° 18' E. on true line bet. secs. 35 and 36. Descending along W. slope of mountain.

Va. 13° E.

2.00 Ravine 100 lks. deep, .40 lks. wide course SW.
28.00 Ravine 48 lks. wide course NW.
40.12 Set granite rock 10 x 21 x 14 ins. for 1/4 sec. cor. marked 1/4 on W. face for 1/4 sec. cor. bet. secs. 35 and 36. This cor. is on NW. face of mountain.
53.00 Depression in mountains.
80.23 To cor. secs. 25, 26, 35, 36.
The land along this line is broken and steep specially to the E.

April 22, 1891

Commencing from 1/4 sec. cor. secs. 6 and 1 on W.B. of Tp. which is a burned elder post in stone mound on W. slope of rocky mountain, I ran North bet. secs. 6 and 1. Ascending.

Va. 12° E.

T. 9 S. R. 2 W. S.B.M.

40.00 No signs of any cor. but knowing where the NW. cor. of the Tp. is,
I continue NORTH

52.92 To NW. cor. of T. 9 S. R. 2 W. which is an oak post 4 ins. in dia.
marked but post has been charred by recent fires and marks too
indistinct to make out.
This cor. is in stone mound on W. face of very rocky mountain.
A Black oak 20 ins. in dia. brs. S. 11°15' W. 350 lks.
April 20, 1891
CAVE J. COUTS.

Vol. 129-16

S.B. T. 9 S. R. 2 W. S.B.M.

From cor. to Tps. 9 and 10 S. Rs. 1 and 2 W., I ran
WEST Va. 15° 30' E.
As all the heaviest brush was burnt off last Fall, I can run
directly W. instead of on the offset 20.00 chs. S.

79.89 To cor. secs. 2 and 1, on N.B. T. 10 S. 2 W

159.72 To cor. secs. 3, 2, on N.B. T. 10 S 2 W.
May 16th.

T. 9 S. R. 2 W. S.B.M.

From cor. to secs. 34, 35, 3 and 2, I ran
North bet. secs. 34 and 35.
Va. 13½° E.

80.21 To cor. secs. 26, 27, 34, 35, which is a willow stake at cor. of
Cayetano Golch's fence.
35.

T. 9 S. R. 2 W. S.B.M.

From cor. to secs. 27, 26, 34 and 35, I ran
East bet. secs. 26 and 35.
Va. 13½° E.

80.32 To cor. secs. 26, 25, 35 and 36, which is a granite rock 16 x 4 in
10 ins. out of the ground, marked with 1 notch on S. & E. edges,
in stone mound on N. face of mountain.
From cor. to secs. 25, 26, 35, 36, I ran
East bet. secs. 25 and 36.
Va. 13° E.

82.28 To cor. secs. 25, 30, 36, 31, which is an elder post 4 ins. in
dia. in earth mound marked S. 25 S. 30 S. 36, S. 31.
May 17th 1891.
CAVE J. COUTS.

Vol. 129-15

Subdivision for allotments of a portion of secs.

33 and 34, T. 9 S. R. 2 W. S.B.M.

I begin the survey with a Heller and Brightly engineer's Transit.
I set my transit at the established cor. to secs. 26, 27, 34, 35,
it being a willow stake 4 ins. dia. marked 26, 27, 34, 35, in a
large mound of earth and stone.

No trace of a bearing tree could be found. I have a flag placed
upon the cor. to secs. 27, 28, 33 and 34, which is an elder stake
in a mound of earth with 3 pits, the 4th pit having been washed
away by an irrigation ditch. I sight to this flag and run
West bet. secs. 27 and 34.

Va. $13\frac{1}{2}^{\circ}$ E.

17.50 Set 9 ins. deep a granite rock 14 x 10 x 6 ins. marked 1 on the S.E.
face and 2 on the SW. face, and built a mound of stone alongside,
 $1\frac{1}{2}$ ft. high and $2\frac{1}{2}$ ft. base for the cor. to lots 1 and 2.

19.70 Cross road from Pala to Escondido course N. & S.

20.00 Set 8 ins. deep a granite rock 12 x 10 x 10 ins. marked 2 on the SE
face and built a mound of stone alongside, $1\frac{1}{2}$ ft. high and $2\frac{1}{2}$ ft.
base for the NW. cor. of lot 2.

40.00 To the $1/4$ sec. cor. bet. secs. 34 and 27, it being an elder post
4 x 4 ins. 2 ft. above ground in a mound of earth.

60.00 Set 8 ins. deep a granite rock 12 x 10 x 6 ins. marked 5 on the SW.
face and built a mound of stone alongside $1\frac{1}{2}$ ft. high and $2\frac{1}{2}$ ft.
base for the NE. cor. of lot 5.

65.00 Set 8 ins. deep a granite rock 12 x 8 x 6 ins. marked 5 on the SE.
face and 6 on the SW face, and built a mound of stone alongside
 $1\frac{1}{2}$ ft. high $2\frac{1}{2}$ ft. base for the cor. lots 5 and 6.

70.00 Set 8 ins. deep a granite rock 10 x 8 x 7 ins. marked 6 on the SE.
face and 7 on the SW face and built a mound of stone alongside $1\frac{1}{2}$ ft

Allotments in secs. 33, 34
T. 9 S. R. 2 W. S.B.M.

high $2\frac{1}{2}$ ft. base for the cor. to lots 6 and 7.

75.00 Set 8 in. deep a granite rock 10 x 8 x 8 ins. marked 7 on the SE.
face and 8 on the SW. face and built a mound of stone alongside,
 $1\frac{1}{2}$ ft. high $2\frac{1}{2}$ ft. base for the cor. of lots 7 and 8.

80.00 To the cor. of secs. 27, 28, 33, 34.
Land level, soil 1st rate. Sandy loam.

July 28, 1893

From the cor. to secs. 26, 27, 34 and 35, I run
South on a random line bet. secs. 34 and 35.

Va. $13\frac{1}{2}^{\circ}$ E.

40.00 Find no trace of $1/4$ sec. cor. Set temp. $1/4$ sec. cor.

80.00 Cor. to secs. 2, 3, 34 and 35, from which a
Black oak tree stump 15 ins. dia. brs. S. 70° W. 33 lks. dist.
The stake being gone and the mound nearly destroyed I set a granite
rock 14 x 10 x 8 ins. 10 ins. in the ground marked with 2 notches
on E. and 4 notches on W. edges and built a mound of stone along-
side $1\frac{1}{2}$ ft. high 2 ft. base, from which I run
North on a true line bet. secs. 34 and 35.

Va. $13\frac{1}{2}^{\circ}$ E.

40.00 Set 8 ins. deep a granite rock 12 x 10x 6 ins. marked $1/4$ on W.face
and built a mound of stone alongside, $1\frac{1}{2}$ ft. high $2\frac{1}{2}$ ft. base for
the $1/4$ sec. cor. bet. secs. 34 and 35.

60.00 To a granite rock 16 x 12 ins. and 10 ins. above ground marked $1/8$
I R, which I also marked 4 on the NW. face for the SE. cor. to lot 4.

71.67 Set 8 ins. deep a granite rock 12 x 10 x 6 ins. marked 1 on NW.
face and 4 on SW. face and built a mound of stone alongside $1\frac{1}{2}$ ft.
high and $2\frac{1}{2}$ ft. base for the cor. to lots 1 and 4.

Allotments in secs. 33, 34
T. 9 S. R. 2 W. S.B.M.

80.00 To the cor. of secs. 26, 27, 34, 35.

To establish the SW. cor. of the NE. 1/4 of the NE. 1/4 of sec. 34,
I run

West on a random line from the 1/4 sec. cor. bet. secs. 34, 35.

Va. $13\frac{1}{2}^{\circ}$ E.

40.05 To the interior 1/4 sec. cor. of sec. 34, from which I run
East on a true line through sec. 34.

20.02 Set a temp. peg from which to run
North.

40.05 To the 1/4 sec. cor. bet. secs. 34, 35.

From my temp. station 20.03 chs. W. of the 1/4 sec. cor. bet. secs
34 and 35, I run

North on a true line through sec. 34.

Va. $13\frac{1}{2}^{\circ}$ E.

20.00 Set 10 ins. deep a granite rock 14 x 10 x 10 in. marked 3 on NE.
face and built a mound of stone alongside $1\frac{1}{2}$ ft. high $2\frac{1}{2}$ ft. base
for the SW. cor. of lot 3.

25.35 Set 12 ins. deep a granite rock 18 x 16 x 14 in. marked 3 on SE.
face and 2 on NE. face and built a mound of stone alongside $1\frac{1}{2}$ ft.
high and $2\frac{1}{2}$ ft. base for the cor. to lots 2 and 3.

40.00 Int. the line bet. secs. 27, 34, at the N. 1/4 1/4 cor. to the
NE. 1/4 of sec. 34, being also the NW. cor. of lot 2.

July 29th.

From the cor. to secs. 27, 28, 33, 34, I run
South on a true line bet. secs. 33, 34.

Va. $13\frac{1}{2}^{\circ}$ E.

Allotment in secs. 33, 34
T. 9 S. R. 2 W. S.B.M.

10.00 Set 10 ins. deep a granite rock 20 x 14 x 8 ins. marked 8 on the
NE. face and 9 on the SE. face and built a mound of stone alongside
 $1\frac{1}{2}$ ft. high $2\frac{1}{2}$ ft. base for the cor. to lots 8 and 9, sec. 34.

20.00 Set 16 ins. deep a granite rock 26 x 12 x 4 in. marked 9 on the
NE. face and 1 on the SW. face and built a mound of stone alongside
for the cor. to lot 9, sec. 34 and lot 1, sec. 33.

40.00 To the 1/4 sec. cor. bet. secs. 33, 34, it being a mound of earth
with pits in good condition. The stake being missing, I set an
oak stake 3 in. dia. 4 ft. long 1 ft. in the ground and marked 1/4
S. for 1/4 sec. cor. bet. secs. 33, 34.

Thence I run

West through sec. 33.

Va. $13\frac{1}{2}^{\circ}$ E.

10.00 To a granite boulder 8 x 3 ft. and 3 ft. above ground marked with
2 X also marked 1 on NE. face and 2 on NW. face and built a mound
of stone alongside $1\frac{1}{2}$ ft. high 2 ft. base for the cor. to lots 1 and
2, sec. 33.

15.00 To a granite boulder 3 x 3 ft. above ground marked with 3 X also
marked 2 - 3 and built a mound of stone alongside $1\frac{1}{2}$ ft. high 2 ft
base for the cor. to lots 2 and 3.

20.00 Set 12 ins. deep a granite rock 18 x 18 x 18 ins. marked 3 on the
NE. face and built a mound of rock alongside $1\frac{1}{2}$ ft. high 2 ft. base
for the SW. cor. to lot 3.

The country W. of here is an unsurveyable and worthless mountain.

From cor. to lot 9 in sec. 34 and lot 1 in sec. 33, I run
West through sec. 33.

Allotments in secs. 33, 34.
T. 9 S. R. 2 W. S.B.M.

Va. $13\frac{1}{2}^{\circ}$ E.

- 10.00 Set 10 in. deep a granite rock 14 x 12x8 ins. marked 1 on SE.face and 2 on SW. face and built a mound of stone alongside $1\frac{1}{2}$ ft. high 2 ft. base for the cor. to lots 1 and 2, sec. 33.
- 15.00 To a granite boulder 3 x 3 ft. and 3 ft. above ground which I marked with a cross . Also marked 2 on SE. face and 3 on SW. face and built a mound of stone alongside, $1\frac{1}{2}$ ft. high and 2 ft. base for the cor. to lots 2 and 3.
- 20.00 Set 12 in. deep a granite rock 18 x 12 x 10 in. marked 3 on SE. face and built a mound of stone alongside $1\frac{1}{2}$ ft. high 2 ft. base for the NW. cor. to lot 3, sec. 33.
- The land W. of here is a rough, worthless mountain.

July 31.

From the NW. cor. lot 3, sec. 33, I run
South along W.B. lot 3.

Va. $13\frac{1}{2}^{\circ}$ E.

- 20.00 To the SW. cor. of lot 3.
From the cor. lots 2 and 3, I run
South bet. lots 2 and 3.

Va. $13\frac{1}{2}^{\circ}$ E.

- 20.00 To the cor. lots 2 and 3.
From the cor. lots 1 and 2, I run
South bet. lots 1 and 2.

Va. $13\frac{1}{2}^{\circ}$ E.

- 20.00 To the cor. lots 1 and 2.

Allotments in sec. 33, 34.
T. 9 S. R. 2 W. S.B.M.

To establish the center of the NW $\frac{1}{4}$ of sec. 34

I begin at the $1/4$ sec. cor. bet. secs. 33 and 34 and run
East through sec. 34 on a random line.

Va. $13\frac{1}{2}^{\circ}$ E.

- 40.40 To the interior $1/4$ sec. cor. of sec. 34, it being an elder post 3 in. dia. and 3 ft. above ground in a mound of earth, from which I run
West on a true line through sec. 34.

Va. $13\frac{1}{2}^{\circ}$ E.

- 20.20 Set a temp. peg from which to run NORTH
40.40 To $1/4$ sec. cor. bet. secs. 33 and 34.

From my temp. peg, 20.20 chs. E. of the $1/4$ sec. cor. bet. secs. 33 and 34, I run
North on true line through sec. 34.

- 20.00 Set 12 in. deep a granite rock 20 x 16 x 12 in. marked 12 on the NW. face and built a mound of stone alongside $1\frac{1}{2}$ ft. high 2 $\frac{1}{2}$ ft. base for the center of the NW. $1/4$ sec. 34, also the SE. cor. lot 12.
- 30.00 Set 7 in. deep a granite rock 10 x 8 x 8 ins. marked 12 on SW.face and 5 on NW. face and built a mound of stone alongside $1\frac{1}{2}$ ft. high 2 ft. base for the cor. to lots 5 and 12.
- 40.00 Int. the line bet. secs. 27 and 34 at the $1/4$ $1/4$ cor. on the N. of the NW. $\frac{1}{4}$ sec. 34, which is also the NE. cor. lot 5.

From the cor. to lots 8 and 9 on the line bet. secs. 33 and 34, I run
East on a true line through sec. 34.

Va. $13\frac{1}{2}^{\circ}$ E.

5.00 Set 10 in. deep a granite rock 16 x 14 x 6 marked 7 on NE., 8 on NW
 9 on SW. and 10 on SE. faces and built a mound of stone alongside
 1½ ft. high 2 ft. base for the cor. to lots 7, 8, 9 and 10, sec. 34.
 10 00 Set 8 in. deep a granite rock 12 x 10 x 6 in. marked 6 on NE., 7
 on NW., 10 on SW., 11 on SE. faces and built a mound of rock
 alongside 1½ ft. high 2 ft. base for the cor. to lots 6, 7, 10, 11.
 15.00 Set 8 in. deep a granite rock 12 x 10 x 10 in. marked 5 on NE., 6
 on NW., 11 on SW., 12 on SE. faces and built a mound of stone along-
 side 1½ ft. high 2 ft. base for the cor. to lots 5, 6, 11 and 12.
 20.00 To the cor. of lots 5 and 12

From the cor. to lot 9 in sec. 34 and lot 1, sec. 33, I run
 East through sec. 34.

Va. 13½° E.

5.03 Set 10 in. deep a granite rock 16 x 14 x 10 in. marked 9 on NW. and
 10 on NE. faces and built a mound of stone alongside 1½ ft. high
 and 2 ft. base for the cor. to lots 9 and 10.
 10.05 Set 8 in. deep a granite rock 12 x 12 x 10 in. marked 10 on NW.
 and 11 on NE. face and built a mound of stone alongside 1½ ft. high
 and 2 ft. base for the cor. to lots 10 and 11.
 15.07 Set 8 in. deep a granite rock 12 x 10 x 8 ins. marked 11 on NW and
 12 on NE. face and built a mound of stone alongside 1½ ft. high and
 2 ft. base for the cor. to lots 11 and 12.
 20.10 To the SE. cor. of lot 12, being the center of the NW¼ of sec. 34.

Aug. 1.

From the cor. to lot 4, sec. 34, it being the SE. cor. of the NE¼
 of the NE¼ of sec. 34, I run
 West on a true line through sec. 34.

Va. 13½° E.

1.90 Set 8 in. deep a granite rock 12 x 10 x 8 in. marked 3 on the NW.
 face and 4 on the NE. face and built mound of stone alongside 1½
 ft. high and 2 ft. base for the cor. to lots 3 and 4.
 20.00 To the SW. cor. of lot 3, sec. 34.

From the N. cor. of lots 5 and 6, sec. 34, I run
 South bet. lots 5 and 6.

Va. 13½° E.

10.00 Cor. lots 5, 6, 11 and 12.
 20.00 S. cor. lots 11 and 12.
 From the N. cor. of lots 7 and 6, I run
 South bet. lots. 7 and 6.

Va. 13½° E.

10.00 Cor. lots 6, 7, 10 and 11.
 20.00 S. cor. lots 10 and 11.
 From the N. cor. lots 8 and 7, I run
 South bet. lots 8 and 7.

Va. 13½° E.

10.00 Cor. lots 7, 8, 9 and 10.
 20.00 S. cor. lots 9 and 10.

From the cor. to lots 1 and 2, sec. 34 on the line bet. secs.
 27 and 34, I run
 South 49° E.

Va. 13½° E.

3.70 Set 10 in. deep a granite rock 16 x 12 x 8 ins. marked 1 on E. and
 2 on W. faces and built a mound of stone alongside 1½ ft. high 2 ft.

base for the cor. to lots 1 and 2.

Thence I run

South $75\frac{1}{2}^{\circ}$ E.

Va. $13\frac{1}{2}^{\circ}$ E.

- 7.74 Set 8 in. deep a granite rock 12 x 12 x 8 in. marked 1 on E. and 2 on W. face and built a mound of stone alongside $1\frac{1}{2}$ ft. high 2 ft base for the cor. to lots 1 and 2, thence I run South 19° E.

Va. $13\frac{1}{2}^{\circ}$ E.

- 5.33 Set 10 in. deep a granite rock 14 x 14 x 12 in. marked 1 on NE., 2 on NW., 3 on SW. and 4 on SE. faces and built a mound of stone alongside $1\frac{1}{2}$ ft. high 2 ft. base for the cor. to lots 1, 2, 3 and 4, thence I run South 71° W.

Va. $13\frac{1}{2}^{\circ}$ E.

- 8.75 Set 10 in. deep a granite rock 14 x 12 x 8 ins. marked 2 on N. and 3 on S. face and built a mound of stone alongside $1\frac{1}{2}$ ft. high 2 ft. base for the cor. to lots 2 and 3, thence I run South 45° W.

Va. $13\frac{1}{2}^{\circ}$ E.

- 4.44 Set 12 in. deep a granite rock 18x 8 x 6 ; also a willow stake 5 x 4 ins. 4 ft. long 12 ins. in the ground marked 2 on N. and 3 on S. faces and built a mound of earth around it, $1\frac{1}{2}$ ft. high $2\frac{1}{2}$ ft. base for the cor. to lots 2 and 3, thence I run North 75° W.

Va. $13\frac{1}{2}^{\circ}$ E.

- 3.10 To the cor. of lots 2 and 3 at the intersection of the line bet. the E. & W. halves of the NE $\frac{1}{4}$ of sec. 34.

From the cor. to lots 1, 2, 3 and 4, sec. 34, I run South 19° E.

Va. $13\frac{1}{2}^{\circ}$ E.

- 11.20 Int. the S.B. of the NE $\frac{1}{4}$ of NE $\frac{1}{4}$ sec. 34 at the cor. to lots 3 & 4
From the cor. to lots 1, 2, 3 and 4, sec, 34, I run North $78\frac{1}{2}^{\circ}$ E.

Va. $13\frac{1}{2}^{\circ}$ E.

- 5.60 Int. the line bet. secs. 34, 35, at the cor. to lots 1 and 4.

August 2, 1893

E. L. DORN.

Vol.394-25

EXTRACTS FROM FIELD NOTES OF PART OF T. 9 S., R. 2 W., S.B.M.

N.B. T. 9 S., R. 2 W., S.B.M.

From the cor. to secs. 1, 2, 11 and 12,

North on true line bet. secs. 1 and 2.

Va. 12° E.

80.00 Deposited charred stake, set an oak post, 4 ft. long 4 in. sq. in earth mound for cor. to secs. 1, 2, 35 and 36, and N.B. of Tp. Also drove an oak stake 2½ in. sq. marked like true cor. in pit, SE. of cor. The pits being 18 in. sq. 12 in. deep and 6 ft. from the cor. stake.

Land S. 30.00 chs. level mesa, 3d rate; balance low, broken hills at base of Smith's mountains.

February 23, 1875

West bet. secs. 2 and 35, Tps. 8 and 9 S., R. 2 W.

Va. 13° E.

31.00 Enter timbered ravine, course N.W.

34.00 Leave same, and ascend.

40.00 Set granite 16 x 8 x 8 on N. face of brushy hill, for 1/4 sec. cor.

55.00 Top of hill and enter level mesa.

72.40 Road to Temecula course NW. & SE.

80.00 Set granite 16 x 12 x 8, and deposited charred stake, for cor. to secs. 2, 3, 34 and 35.

Land E 55.00 chs. low, rough hills, worthless; balance, level, 3d rate. Timber, oak in ravine.

N.B. T. 9 S., R. 2 W., S.B.M.

West bet. secs. 3 and 34.

Va. 12° 15' E.

40.00 Set granite 16 x 12 x 12 for 1/4 sec. cor.

46.00 A dry wash 50 lks. wide runs S.

53.70 A trail, course N. & S.

65.00 Top of low ridge course N. & S.

80.00 To an oak in dia. base of rocky knoll, marked for cor. to secs. 3, 4, 33 and 34.

Land level and brushy, 3d rate.

From the cor. to secs. 2 and 3, T. 9 S., R. 2 W.

EAST on a true line on N.B. of sec. 2.

Va. 12° 57' E.

This cor. is a stone as described in Wheeler's Notes.

Ascend.

5.30 A road course NW. & SE.

28.00 Descend.

40.00 Find no 1/4 sec. cor. Set granite 22 x 10 x 5 for 1/4 sec.

cor. Made a mound 24 in. high pits 24 x 18 x 12 as inst.

A granite boulder 6 ft. high E. 3 lks.

41.68 Dry creek 40 lks. wide runs NW. in deep canon. Ascend.

80.00 Find no cor. Set post 60 x 4 x 4 in., 18 in. deep for Stand. cor. to secs. 1 and 2. Made a mound 24 ins. high with pits 24 x 18 x 12 as per inst.

Land broken and mountainous. Soil 2nd and 3d rate. Chapparral.

N.B. T. 9 S., R. 2 W., S.B.M.

East on random line on N.B. sec. 1,

Va. 13° E.

Ascend.

20.50 Ravine course NW.
40.00 Set temp. 1/4 sec. cor. Steep ascent.
92.00 Ravine course N.W.
99.52 Int. the line bet. Rs. 1 and 2 W. 17.42 chs. N. of the closing cor.
to Tps. 8 S. 1 and 2 W.

This error is so great that it seems better to set a closing cor.
than to run a diagonal line and I set a granite stone 18 x 16 x
7 ins. for closing cor. to Tps. 8 and 9 S. R. 2 W. Made a mound
30 ins. high, thence,

West on true line on NB. of sec. 1.

Va. 13° E.

59.52 Set post 48 x 3 x 3 in. 12 in. deep for 1/4 sec. cor., made a stone
mound 18 in. high.

99.52 To cor. to secs. 1 and 2.

Land steep W. slope of mountain, soil 3d rate. Chaparral.

From the standard cor. to sec, 2 and 3, T. 9 S.

West on blank line on N.B. of sec. 3.

Va. 12° 57' E.

S.B. T. 8 S. R. 2 W., S.B.M.

East on S.B. of sec. 35.

Va. 13° E.

9.50 Descend.
10.50 Ravine course N.
20.40 To 1/4 sec. cor. N. of sec. 2, a granite stone 10 x 5 in.
marked 1/4 in mound, a granite boulder 6 ft. high brs. E. 3 lks.
22.00 Dry creek 45 lks. wide runs NW. Steep ascent.
50.00 A sharp broken ridge course NW. & SE.
52.00 Along N. slope
60.60 To cor. to secs. 1 and 2, a post 4 x 4 in. marked T. 9 S., R. 2 W.
S. 1 and S. 2, with 1 notch on E. and 5 to W. and S.C. in mound
and pits as per inst.
62.00 A sharp spur sloping N.
80.13 To cor. to secs. 35 and 36, a granite stone 8 x 8 in. marked 1
notch on E. and 5 to W. and C.C. from which brs. a,
Live oak 20 in. dia. N. 62½° W. 184 lks. dist.
marked T. 8 S. R. 2 W. S. 35 B.T.
Made the stone mound 24 in. high alongside.
Land very rough and mountainous, soil 2nd and 3d rate.
Dense growth of caparral.

July 21, 1885

WM. MINTO.

Vol. 382-27

Ed Fletcher Papers

1870-1955

MSS.81

Box: 42 Folder: 17

**Business Records - Field Notes - Township 9 S.,
Range 2 W., San Bernardino Meridian, with Extracts**



Copyright: UC Regents

Use: This work is available from the UC San Diego Libraries. This digital copy of the work is intended to support research, teaching, and private study.

Constraints: This work is protected by the U.S. Copyright Law (Title 17, U.S.C.). Use of this work beyond that allowed by "fair use" requires written permission of the UC Regents. Permission may be obtained from the UC San Diego Libraries department having custody of the work (<http://libraries.ucsd.edu/collections/mscl/>). Responsibility for obtaining permissions and any use and distribution of this work rests exclusively with the user and not the UC San Diego Libraries.