

Keep this until Mr.

Murray arrives.

Ed Fletcher.

JUL 26 1918

September 9, 1918.

Mr. E. Melville,
Chula Vista, Calif.

Dear Sir:

Answering yours of the 5th, will say that
I have taken this matter up with Mr. Murray, and he
does not care to sell the land that you speak of, but
will lease same to you for \$25 a year, if desired.

Yours very truly,

F-S

PHONE HOME
CHULA VISTA 682

E. MELVILLE REALTY CO.

REAL ESTATE, LOANS, INSURANCE

CONTRACTORS AND BUILDERS
HOUSES BUILT ON MONTHLY
PAYMENTS

CHULA VISTA RANCH AND CITY PROPERTY
A SPECIALTY

E. MELVILLE
RESIDENCE PHONE 184

CHULA VISTA, CAL., 7/25/18.

Mr. Ed. Fletcher,

San Diego, Cal.,

Dear Sir:-

As per your request, I am enclosing you a plat of your land
at the old Monte pumping station. There is about $2\frac{1}{2}$ acres, with
the exceptions of the triangular piece, now occupied by the old
pumping plant.

I think this piece of land is worth about \$250.00 .

Very truly yours,

E. Melville

mathews

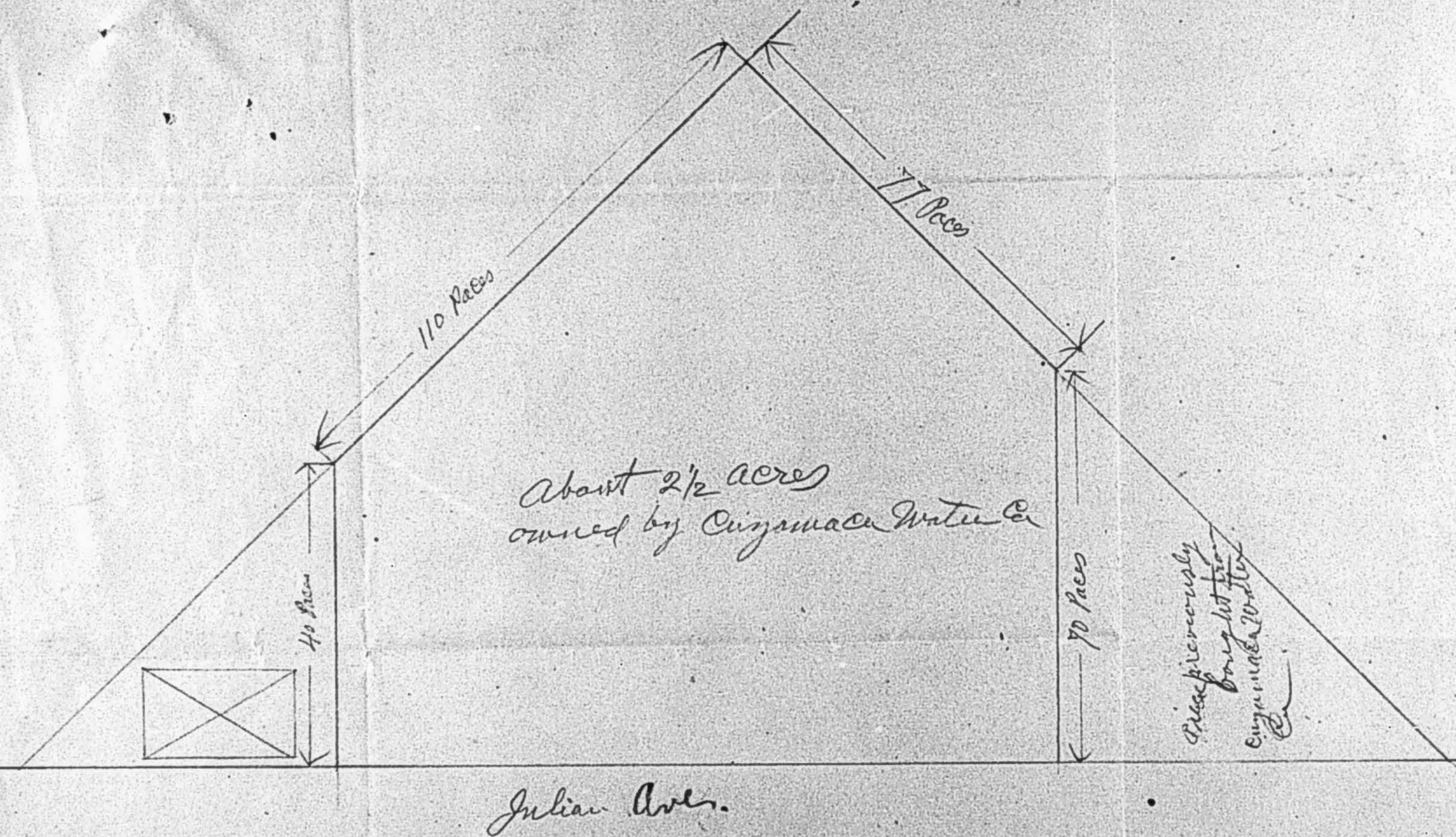

Ed Fletcher Papers

1870-1955

MSS.81

Box: 55 Folder: 18

**Business Records - Water Companies - Cuyamaca
Water Company - Cuyamaca Customers
- Customer correspondence - Melville, E.**



Copyright: UC Regents

Use: This work is available from the UC San Diego Libraries. This digital copy of the work is intended to support research, teaching, and private study.

Constraints: This work is protected by the U.S. Copyright Law (Title 17, U.S.C.). Use of this work beyond that allowed by "fair use" requires written permission of the UC Regents. Permission may be obtained from the UC San Diego Libraries department having custody of the work (<http://libraries.ucsd.edu/collections/mscl/>). Responsibility for obtaining permissions and any use and distribution of this work rests exclusively with the user and not the UC San Diego Libraries.