

A. M. SCHRAMM.

ESTABLISHED 1865.

A. H. STOCKER.

Oakland, Cal. Nov. 7. 1887

Mr. E. O. Crosby

To STOCKER & SCHRAMM, Dr.

Searchers of Records for Alameda County,

No. 420 EIGHTH STREET, Blake & Moffitt Building.

Certificate of Search of The Northern
1/2 of Lot 1 in Block "D" Alameda Station
Homestead. Alameda County. Cal.

Said Stocker & Schramm

\$5.00

Certificate of Search.

relating to
Land fronting 42 feet on the Eastern line of
Park Street lying to the Southward of Buena Vista
Avenue, being Lot No. 2 (two) in Block marked
II of the Alameda Station Homestead Tract
in the Town of Alameda as the same is partic-
ularly described in my Certificate of Search
under date June 18, 1878.

State of California }
County of Alameda } S.S.

J. G. W. McTeard.

Having examined the County records of Alameda
County as to the foregoing described real estate
in continuation of my Certificate of Search under
date June 18, 1878, do, as the result thereof hereby
certify that a valid title thereto is now vested in
E. O. Crosby free from incumbrance, but affected
by a Declaration of Homestead by Frances A.
Crosby, bearing date September 23, 1878, of record on
September 24, 1878.

I direct attention to the circumstance that in

the preamble to the deed bearing date June 30, 1880,
of record in Liber 213 of Deeds at page 460 et seq.,
by the omission to write the words "party of the first
part" after the words "Henry E. Robinson, deceased",
the description of the parties to the instrument reads
Between S. G. Murphy, Executor &c of Henry E. Robinson,
deceased and E. O. Crosby, the party of the second part,
but this deficiency I do not regard as a material
defect.

The suit instituted by the Town of Alameda & re-
ferred to in my Certificate of June 18, 1878, has
been dismissed.

I further certify that State & County and Town of Alameda
Taxes thereon, up to and inclusive of the past fiscal
year of 1881-2, have been paid; those for the succeeding
and current fiscal year of 1882-3 as assessed to E. O.
Crosby, being now receivable as follows:

State & County Taxes \$17.³², Town of Alameda Taxes \$8.⁵⁵.

I also certify that there are no street assessments.

Wm. W. W. W.
Searcher of Records.

Oakland, the tenth day of November A. D. one thousand
eight hundred and eighty two, at twelve o'clock M.

Certificate of Search.

Relating to
Lot No 2 in Block D of the Alameda Station
Homestead Tract in the Town of Alameda, County
of Alameda and State of California

by
G. W. McKEAND,
Searcher of Records,

S. E. Cor. 4th & Broadway Sts.
OAKLAND, CAL

Certificate of Search.

relating to
All that piece or parcel of land situated in the
Town of Alameda, County of Alameda & State of
California, described as follows, to-wit: Com-
mencing at a point on the Eastern line of
Park street, distant 300 (three hundred) feet
Southernly from the Southern line of Buena Vista
Avenue, and running thence Easterly, parallel
with Buena Vista Avenue 140 (one hundred &
forty) feet; thence Southernly 42 (forty two) feet
to a point on a line parallel with Buena Vista
Avenue and distant 140 (one hundred & forty) feet
three inches Easterly from the Eastern line of Park
street; thence Westerly, parallel with Buena
Vista Avenue to said Eastern line of Park street,
and thence Northerly along Park street 42 (forty
two) feet to the place of beginning: being Lot
No. 2 in Block marked "D", as the same are
delineated and so designated on the map
entitled "Alameda Station Homestead Tract"
etc., filed on February 22, 1868 in the County
Recorder's office of said Alameda County.

by
G. W. McKend,
Searcher of Records for Alameda County
at Oakland.

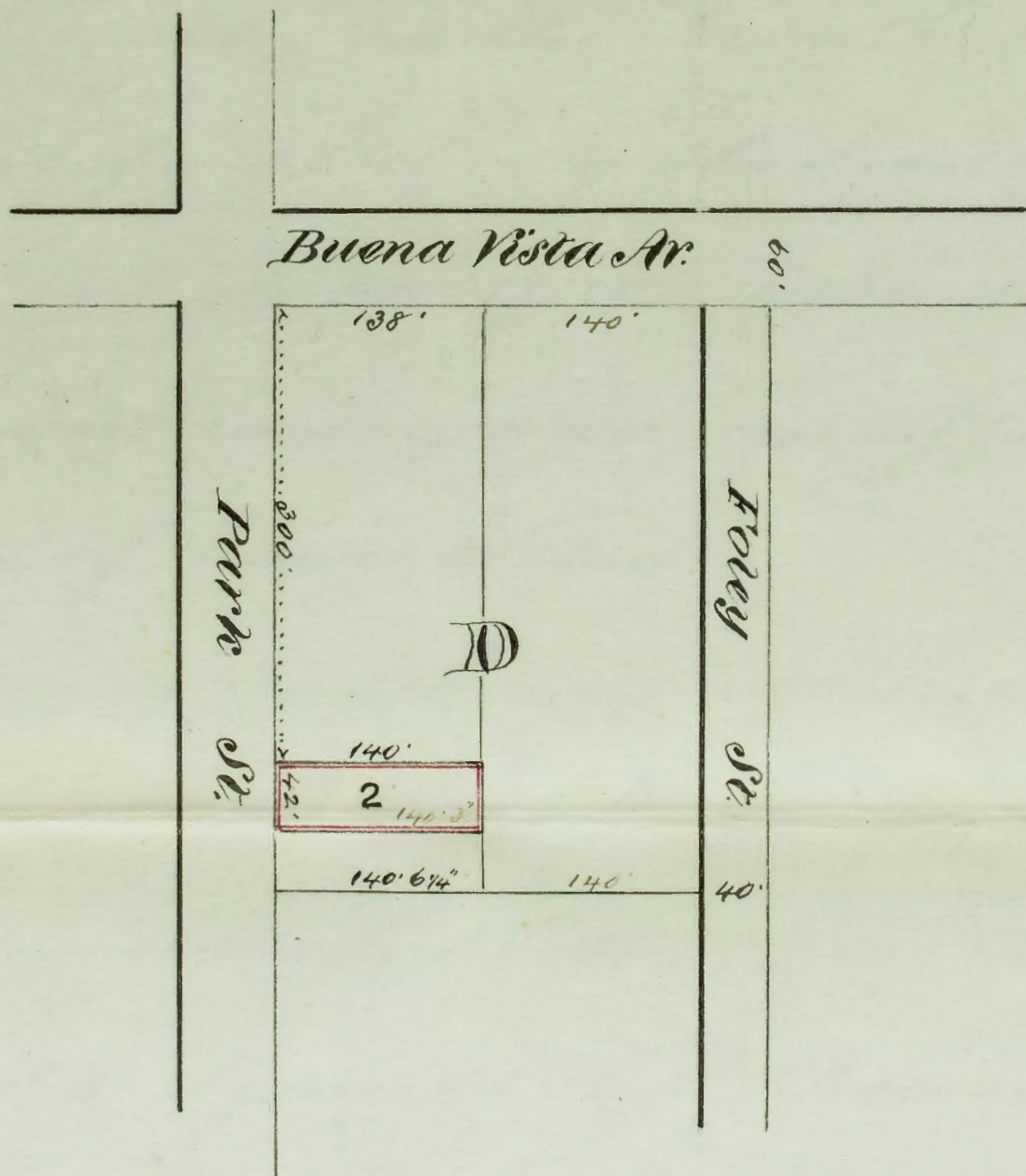
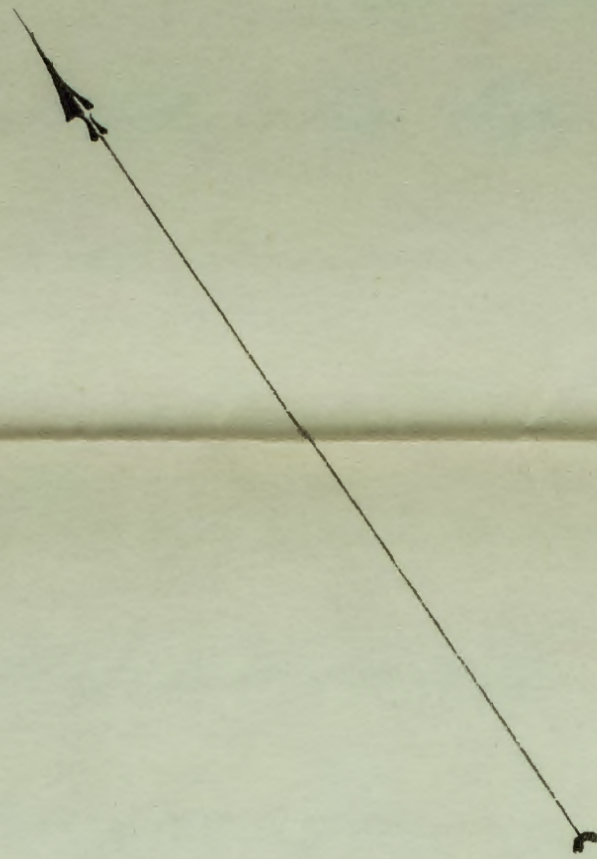

State of California }
County of Alameda } SS

J. G. W. McKeand,

having examined the County records of Contra Costa & Alameda Counties (within the limits of the former of which, the premises in question were at one time comprehended) as to the condition of the title to the foregoing described real estate, do, as the result thereof, hereby certify that a valid title thereto is vested in Henry E. Robinson, free from incumbrance and unaffected by any claim of homestead.

Suit however has been instituted in the 3rd District Court for Alameda County on March 12, 1877, by the Town of Alameda against C. R. Bowen and numerous others, amongst whom is Mathias Wahl [through whom title is deraigned] to effect the widening of Park Street to eighty feet, and for which purpose it is proposed to condemn a strip ten feet wide lying to the Eastward

of the Western line thereof, and to cause contribution to be made therefor by the owners of lands at the rear thereof who may be found to be benefitted thereby.

I further certify that State & County and Town of Alameda Taxes thereon, up to and inclusive of the fiscal year of 1877-8, have been paid; as also all street assessments.

Wm. McKeand

Searcher of Records.

Oakland, the eighteenth day of June
A.D. one thousand eight hundred
and seventy eight, at 4 o'clock P.M.

Source of Search.

relating to

Lot No. 2 in Block "D" of Alameda Station
Homestead Tract, Town of Alameda,
County of Alameda & State of California

by

G. W. McKEAND,
Searcher of Records,
S. E. Cor. 4th & Broadway Sts.,
OAKLAND, CAL.

Search

Franklin, A. Broadway

Index 213.
Book 4601