

AMS

DEPARTMENT OF THE INTERIOR

UNITED STATES LAND OFFICE

Los Angeles, California.

(Place)

January 7, 1924.

(Date)

United States)

Vs.)

Irene Tait)

Involving T. or S. application
No. 035264.

NOTICE CHANGING DATE OF HEARING

In the above entitled case, the parties are hereby notified that the date of taking testimony has been changed from February 18, 1924, to 10 o'clock A.M., on February 8, 1924, before the Clerk of the Superior Court at San Diego, Calif.

The final hearing will be had as heretofore set at 10 o'clock A.M., March 20, 1924, before the Register and Receiver in the United States Land Office at Los Angeles, California.

Judley O. Valentine

Register.

[Signature]

Receiver.

The applications of
J.L. Doyle, R.S. Doyle, M.C.B.
Fletcher, Cora Belle Fletcher
Ed. Fletcher, Jr., K.L. May, Irene
Tait, Catherine F. Taylor
Withdrawn on March 4, 1924.

AMS

DEPARTMENT OF THE INTERIOR Serial 035269

UNITED STATES LAND OFFICE

G.C. 5202

Los Angeles, California.
(Place)

January 7, 1924.
(Date)

United States)

Vs.)

Ed. Fletcher, Jr.)

Involving T. or S. application
No. 035269.

NOTICE CHANGING DATE OF HEARING.

In the above entitled case, the parties are hereby notified that the date of taking testimony has been changed from February 18, 1924, to 10 o'clock A.M. on February 8, 1924, before the Clerk of the Superior Court, San Diego, Calif.

The final hearing will be had as heretofore set at 10 o'clock A.M., March 20, 1924, before the Register and Receiver in the United States Land Office at Los Angeles, California.

Handley O. Valentine Register.

[Signature] Receiver.

NFG

AMS

DEPARTMENT OF THE INTERIOR Serial 035267

UNITED STATES LAND OFFICE

G.C. 5200

Los Angeles, California.
(Place)

January 7, 1924.
(Date)

United States)

Vs.)

K. L. May)

Involving T. or S. application 035267.

NOTICE CHANGING DATE OF HEARING.

In the above entitled case, the parties are hereby notified that the date of taking testimony has been changed from February 20th, 1924, to 10 o'clock A.M., February 7, 1924, before the Clerk of the Superior Court, San Diego, Calif.

The final hearing will be had as heretofore set at 10 o'clock A.M., March 20th, 1924, before the Register and Receiver in the United States Land Office at Los Angeles, California.

Handley O. Valentine Register.

_____ Receiver.

NFG

AMS DEPARTMENT OF THE INTERIOR Serial 035270
UNITED STATES LAND OFFICE G. C. 5203
Los Angeles, California.
(Place)
January 7, 1924.
(Date)

United States)
Vs.) Involving T. or S. application
Charles K. Fletcher) No. 035270.

NOTICE CHANGING DATE OF HEARING.

In the above entitled case, the parties are hereby notified that the date of taking testimony has been changed from February 19, 1924, to 10 o'clock A.M. February 6, 1924, before the Clerk of the Superior Court San Diego, Calif.

The final hearing will be had as heretofore set at 10 o'clock A.M., March 20, 1924, before the Register and Receiver, in the United States Land Office at Los Angeles, California.

Studley O. Valentine Register.
[Signature] Receiver.

AMS DEPARTMENT OF THE INTERIOR
UNITED STATES LAND OFFICE
Los Angeles, California.
(Place)
January 7, 1924.
(Date)

United States)
Vs.) Involving T. or S. application
Cora B. Fletcher) No. 035266.

NOTICE CHANGING DATE OF HEARING

In the above entitled case, the parties are hereby notified that the date of taking testimony has been changed from February 19, 1924, to 10 o'clock A.M. on February 6, 1924, before Clerk of the Superior Court, San Diego, Calif.

The final hearing will be had as heretofore set at 10 o'clock A.M., March 20, 1924, before the Register and Receiver in the United States Land Office at Los Angeles, California.

Studley O. Valentine Register.
[Signature] Receiver.

AMS

DEPARTMENT OF THE INTERIOR

UNITED STATES LAND OFFICE

Los Angeles, California.
(Place)

January 7, 1924.
(Date)

Serial 035265

G.C. 5198

United States)

Vs.)

Catherine F. Taylor)

Involving T. or S. application
No. 035265

NOTICE CHANGING DATE OF HEARING

In the above entitled case, the parties are hereby notified that the date of taking testimony has been changed from February 18, 1924, to 10 o'clock A.M. on February 8, 1924, before Clerk of the Superior Court at San Diego, Cal.

The final hearing will be had as heretofore set at 10 o'clock A.M., March 20, 1924, before the Register and Receiver in the United States Land Office at Los Angeles, California.

Ludley P. Valentine Register.

[Signature] Receiver.

NFG

AMS

DEPARTMENT OF THE INTERIOR

UNITED STATES LAND OFFICE

Los Angeles, California.
(Place)

January 7, 1924.
(Date)

Serial 035289

G. C. 5205

United States)

Vs.)

Mary C.B. Fletcher)

Involving T. or S. application
No. 035289.

NOTICE CHANGING DATE OF HEARING.

In the above entitled case, the parties are hereby notified that the date of taking testimony has been changed from February 19, 1924, to 10 o'clock A.M., February 6, 1924, before the Clerk of the Superior Court, San Diego, Calif.

The final hearing will be had as heretofore set at 10 o'clock A.M., March 20, 1924, before the Register and Receiver in the United States Land Office at Los Angeles, California.

Ludley P. Valentine Register.

[Signature] Receiver.

NFG

AMS DEPARTMENT OF THE INTERIOR Serial 035268
UNITED STATES LAND OFFICE G. C. 5201

Los Angeles, California.
(Place)

January 7, 1924.
(Date)

United States)
Vs.) Involving T. or S. application
Rebecca F. Doyle,) No. 035268.

NOTICE CHANGING DATE OF HEARING.

In the above entitled case, the parties are hereby notified that the date of taking testimony has been changed from February 19, 1924, to 10 o'clock A.M., February 7, 1924, before the Clerk of the Superior Court, San Diego, Calif.

The final hearing will be had as heretofore set at 10 o'clock A.M., March 20, 1924, before the Register and Receiver in the United States Land Office at Los Angeles, California.

Hudley D. Valentine Register.

Receiver.

NFG

AMS DEPARTMENT OF THE INTERIOR Serial 035271
UNITED STATES LAND OFFICE G. C. 5204 ✓

Los Angeles, California.
(Place)

January 7, 1924.
(Date)

United States)
Vs.) Involving T. or S. application
Jarvis L. Doyle) No. 035271.

NOTICE CHANGING DATE OF HEARING.

In the above entitled case, the parties are hereby notified that the date of taking testimony has been changed from February 20th, 1924, to 10 o'clock A.M. on February 7, 1924, before the Clerk of the Superior Court, San Diego, Calif.

The final hearing will be had as heretofore set at 10 o'clock A.M., March 20, 1924, before the Register and Receiver, in the United States Land Office, at Los Angeles, California.

Hudley D. Valentine Register.

Receiver.

NFG

Delivered personally
by Col Fitchas 7/27/23

Two complete sets
properly signed & returned
to me.

DEPARTMENT OF THE INTERIOR
UNITED STATES LAND OFFICE

Los Angeles, Cal.

(Place)

June 28, 1923.

(Date)

Irene Pitt

Rt. 1, Box 126,
National City, Cal.

Serial 035264

In reference to your application under the timber and stone
law for the NE¹ NW¹ Sec. 6, T. 10 N., R. 1 W., S.B.M.

you are advised that under date of June 20, 1923 the
Commissioner of the General Land Office allowed you to file

your affidavit, corroborated by that of two witnesses, setting
forth facts tending to disprove the report of the Chief of Field
division that the land is more valuable for grazing than for tim-
ber and stone. If the required affidavit is filed, a hearing
will be ordered to determine the character of the land; if not
filed, the case will be closed on our records.
You must show that the land is chiefly valuable for its timber or
stone.

Thirty days from notice are allowed within which to comply
with the requirements of the Commissioner, or to appeal from
his decision to the Secretary of the Interior; and upon your
failure to take action within the time specified the case will
be reported for appropriate action.

~~A copy of the decision is inclosed.~~

In responding hereto, refer to the Serial number.

Very respectfully,

[Signature], Register.
[Signature], Receiver.

DEPARTMENT OF THE INTERIOR
United States Land Office
Los Angeles, Cal.

AFFIDAVIT OF IRENE FAIT AND CORROBORATING WITNESSES-Serial 035264

United States of America }
State of California } SS IRENE FAIT
County of San Diego }

being first duly sworn deposes and says:

That affiant is personally familiar with the character of land embraced in affiant's application for ^(Lit 6) NE $\frac{1}{4}$ NW $\frac{1}{4}$ Sec. 64, T. 10 S., R. 1 W., S.B.M., under timber and stone application under the General Statutes of the United States;

That the land embraced in the said application is not of a character that could be used for grazing or for agricultural purposes as the soil is extremely rocky and could not produce sufficient vegetation of any kind to support animal life in sufficient quantities to justify its use for that purpose; and

That the said land is chiefly valuable for use of the stone and timber thereon and not for any other purpose;

That attached hereto and made a part of this affidavit are the affidavits of two corroborating witnesses. Both of them have been engaged for a number of years in the business of grazing cattle and are familiar with land suitable and adaptable for grazing purposes and their affidavits for that reason are entitled to full credit.

THEREFORE affiant prays that said application be granted.

Signed- Irene Fait

Subscribed and sworn to before me this _____ day of July, 1923.

Notary Public in and for the County of San Diego, State of California

My commission expires _____

DEPARTMENT OF THE INTERIOR
United States Land Office
Los Angeles, Cal.

AFFIDAVIT OF IRENE FAIT AND CORROBORATING WITNESSES - Serial 035264

United States of America)
State of California) SS
County of San Diego)

FRANK A. SALMONS being

first duly sworn deposes and says:

That affiant has personal knowledge of the land embraced in the application mentioned in the affidavit to which this affidavit is attached, to-wit:

SEE 1/4 NW 1/4 Sec. 45, T. 10 S., R. 1 W., S. B. M. (Lot 6)

and is familiar with the character of land embraced in said application.

That it is the opinion of affiant that all of the said land is more valuable for the stone and timber thereon than for grazing or agricultural purposes, as the land is extremely rocky and steep in a general way and the soil is not of a character that would produce sufficient vegetation to make grazing profitable;

That affiant for a great number of years was engaged in the business of grazing cattle in the vicinity of which this land is located and that affiant's statement is based on his personal knowledge and experience in that respect;

THEREFORE, affiant is of the opinion, based upon his said experience and personal knowledge that the said land is more valuable for stone and timber than for grazing;

That affiant is not related to or employed by the applicant herein on this land;

Further affiant sayeth not.

signed- FRANK A. SALMONS

---oOo---

Subscribed and sworn to before me this _____ day of
July, 1923.

Notary Public in and for the
County of San Diego, State of
California

My commission expires _____

DEPARTMENT OF THE INTERIOR
United States Land Office
Los Angeles, Cal.

AFFIDAVIT OF IRENE FAIT AND CORROBORATING WITNESSES - Serial 035264

United States of America)
State of California) SS
County of San Diego)

E. C. BATCHELDER _____ being

first duly sworn deposes and says:

That affiant has personal knowledge of the land embraced in the application mentioned in the affidavit to which this affidavit is attached, to-wit:

~~NE NW~~ Sec. 25, T. 10 S., R. 2 W., S. B. M. (Lot 6)

and is familiar with the character of land embraced in said application.

That it is the opinion of affiant that all of the said land is more valuable for the stone and timber thereon than for grazing or agricultural purposes, as the land is extremely rocky and steep in a general way and the soil is not of a character that would produce sufficient vegetation to make grazing profitable;

That affiant for a great number of years was engaged in the business of grazing cattle in the vicinity of which this land is located and that affiant's statement is based on his personal knowledge and experience in that respect;

THEREFORE, affiant is of the opinion, based upon his said experience and personal knowledge that the said land is more valuable for stone and timber than for grazing;

That affiant is not related to or employed by the applicant herein on this land;

Further affiant sayeth not.

Signed - E. C. BATCHELDER

---oOo---

Subscribed and sworn to before me this _____ day of
July, 1923.

Notary Public in and for the
County of San Diego, State of
California

My commission expires _____

DEPARTMENT OF THE INTERIOR
UNITED STATES LAND OFFICE

Los Angeles, Cal.

^(Place)
June 28, 1923.

_(Date)

Catherine F. Taylor,
3174 B St.,
San Diego, Calif.

Serial 035265

In reference to your timber and stone application for
lot 3, Sec. 5, T. 10 S., R. 1 W., S.B.M.,
you are advised that under date of June 20, 1923 the
Commissioner of the General Land Office allowed you to file your
affidavit, corroborated by that of two witnesses, showing that
the land is chiefly valuable for its timber or stone, and tending
to disprove the report of Chief of Field Division that the land
is more valuable for grazing than for timber and stone. If the
required affidavit is filed, a hearing will be ordered to determine
the character of the land; if not filed, the case will be closed on
our records.

Thirty days from notice are allowed within which to comply
with the requirements of the Commissioner, or to appeal from
his decision to the Secretary of the Interior; and upon your
failure to take action within the time specified the case will
be reported for appropriate action.

~~A copy of the decision is inclosed.~~

In responding hereto, refer to the Serial number.

Very respectfully,

[Signature], Register.
[Signature], Receiver.

DEPARTMENT OF THE INTERIOR
United States Land Office

Los Angeles, Cal.

AFFIDAVIT OF CATHERINE F. TAYLOR AND CORROBORATING WITNESSES-Serial No. 035265

United States of America }
State of California } SS
County of San Diego }

CATHERINE F. TAYLOR

being first duly sworn deposes and says:

That affiant is personally familiar with the character of land embraced in affiant's application for Lot 3, Section 5, Township 10 South, Range 1 West, S. B. M. under timber and stone application under the General Statutes of the United States;

That the land embraced in the said application is not of a character that could be used for grazing or for agricultural purposes as the soil is extremely rocky and could not produce sufficient vegetation of any kind to support animal life in sufficient quantities to justify its use for that purpose; and

That the said land is chiefly valuable for use of the stone and timber thereon and not for any other purpose;

That attached hereto and made a part of this affidavit are the affidavits of two corroborating witnesses. Both of them have been engaged for a number of years in the business of grazing cattle and are familiar with land suitable and adaptable for grazing purposes and their affidavits for that reason are entitled to full credit.

THEREFORE affiant prays that said application be granted.

Signed-CATHERINE F. TAYLOR

Subscribed and sworn to before me this _____ day of July, 1923.

Notary Public in and for the County of San Diego, State of California

My commission expires _____

DEPARTMENT OF THE INTERIOR
United States Land Office
Los Angeles, Ca.

AFFIDAVIT OF CATHERINE F. TAYLOR AND CORROBORATING WITNESSES
Serial-035265

United States of America)
State of California)) SS
County of San Diego)

E. C. BATCHELDER

being first duly sworn deposes and says:

That affiant has personal knowledge of the land embraced in the application mentioned in the affidavit to which this affidavit is attached, to-wit:

Lot 3, Section 5, T. 10 S., R. 1 W., S. B. M.

and is familiar with the character of land embraced in said application.

That it is the opinion of affiant that all of the said land is more valuable for the stone and timber thereon than for grazing or agricultural purposes, as the land is extremely rocky and steep in a general way and the soil is not of a character that would produce sufficient vegetation to make grazing profitable;

That affiant for a great number of years was engaged in the business of grazing cattle in the vicinity of which this land is located and that affiant's statement is based on his personal knowledge and experience in that respect;

THEREFORE, affiant is of the opinion, based upon his said experience and personal knowledge that the said land is more valuable for stone and timber than for grazing;

Further affiant sayeth not.

E. C. Batchelder

---oOo---

Subscribed and sworn to before me this _____ day of
July, 1925.

Notary Public in and for the
County of San Diego, State of
California.

My commission expires _____

DEPARTMENT OF THE INTERIOR
United States Land Office
Los Angeles, Cal.

AFFIDAVIT OF CATHERINE F. TAYLOR AND CORROBORATING WITNESSES-Serial
035265

United States of America)
State of California) SS
County of San Diego)

FRANK A. SALMONS

being

first duly sworn deposes and says:

That affiant has personal knowledge of the land embraced in the application mentioned in the affidavit to which this affidavit is attached, to-wit:

Lot 3, Sec. 5, T. 10 S., R. 1 W., S. B. M.

and is familiar with the character of land embraced in said application.

That it is the opinion of affiant that all of the said land is more valuable for the stone and timber thereon than for grazing or agricultural purposes, as the land is extremely rocky and steep in a general way and the soil is not of a character that would produce sufficient vegetation to make grazing profitable;

That affiant for a great number of years was engaged in the business of grazing cattle in the vicinity of which this land is located and that affiant's statement is based on his personal knowledge and experience in that respect;

THEREFORE, affiant is of the opinion, based upon his said experience and personal knowledge that the said land is more valuable for stone and timber than for grazing;

That affiant is not related to or employed by the applicant herein on this land;

Further affiant sayeth not.

signed- Frank A. Salmons

---00---

Subscribed and sworn to before me this _____ day of
July, 1923.

Notary Public in and for the
County of San Diego, State of
California.

My commission expires _____

271

AMS

DEPARTMENT OF THE INTERIOR
UNITED STATES LAND OFFICE

Los Angeles, Cal.

(Place)

June 28, 1923.

(Date)

Cora Belle Fletcher,
1453 8th St.,
San Diego, Calif.

Serial 035266



In reference to your timber and stone application for the
S $\frac{1}{2}$ NE $\frac{1}{2}$; NE $\frac{1}{2}$ SW $\frac{1}{2}$ Sec. 15, NW $\frac{1}{2}$ SW $\frac{1}{2}$ Sec. 14, T. 11 S., R. 2 E., S.B.M.,
you are advised that under date of June 19, 1923 the
Commissioner of the General Land Office allowed you to file your
affidavit, corroborated by that of two witnesses, setting forth facts
tending to disprove the report of the Chief of Field Division that
the land is more valuable for grazing than for timber and stone. If
the required affidavit is filed a hearing will be ordered to deter-
mine the character of the land; if not filed, the case will be closed
on our records.
You must show that the land is chiefly valuable for its timber
or stone.

Thirty days from notice are allowed within which to comply
with the requirements of the Commissioner, or to appeal from
his decision to the Secretary of the Interior; and upon your
failure to take action within the time specified the case will
be reported for appropriate action.

~~A copy of the decision is inclosed.~~

In responding hereto, refer to the Serial number.

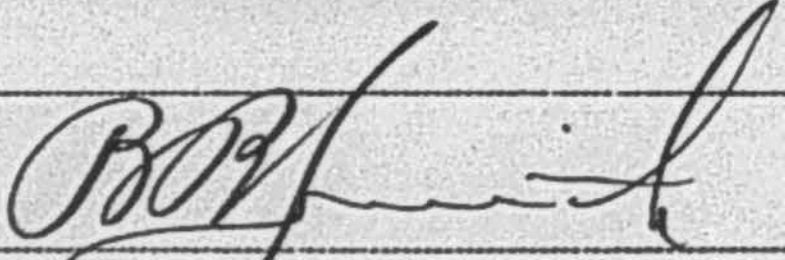
Very respectfully,

, Register.
, Receiver.

DEPARTMENT OF THE INTERIOR
United States Land Office
Los Angeles, Cal.

AFFIDAVIT OF CORA BELLE FLETCHER AND CORROBORATING WITNESSES-Serial
035266

United States of America }
State of California } SS
County of San Diego }

CORA BELLE FLETCHER

being first duly sworn deposes and says:

That affiant is personally familiar with the character of land embraced in affiant's application for S $\frac{1}{2}$ NE $\frac{1}{2}$, NE $\frac{1}{2}$ SE $\frac{1}{2}$, Sec. 15, NW $\frac{1}{2}$ SW $\frac{1}{2}$ Sec. 14, T. 11 S., R. 2 E., S. B. M. under timber and stone application under the General Statutes of the United States;

That the land embraced in the said application is not of a character that could be used for grazing or for agricultural purposes as the soil is extremely rocky and could not produce sufficient vegetation of any kind to support animal life in sufficient quantities to justify its use for that purpose; and

That the said land is chiefly valuable for use of the stone and timber thereon and not for any other purpose;

That attached hereto and made a part of this affidavit are the affidavits of two corroborating witnesses. Both of them have been engaged for a number of years in the business of grazing cattle and are familiar with land suitable and adaptable for grazing purposes and their affidavits for that reason are entitled to full credit.

THEREFORE affiant prays that said application be granted.

Signed- Cora Belle Fletcher

Subscribed and sworn to before me this 27th day of
July, 1925.

Lou B. Matthews
Notary Public in and for the County
of San Diego, State of California
My commission expires Dec. 7-1926.

DEPARTMENT OF THE INTERIOR
United States Land Office
Los Angeles, Cal.

AFFIDAVIT OF CORA BELLE FLETCHER AND CORROBORATING WITNESSES-Serial
035266

United States of America)
State of California) SS
County of San Diego)

GEO. SAWDAY being

first duly sworn deposes and says:

That affiant has personal knowledge of the land embraced in the application mentioned in the affidavit to which this affidavit is attached, to-wit:

S $\frac{1}{2}$ NE $\frac{1}{4}$, NE $\frac{1}{4}$ SE $\frac{1}{4}$ Sec. 15, NW $\frac{1}{4}$ SW $\frac{1}{4}$ Sec. 14, T. 11 S., R. 2 E., S.B.M. and is familiar with the character of land embraced in said application.

That it is the opinion of affiant that all of the said land is more valuable for the stone and timber thereon than for grazing or agricultural purposes, as the land is extremely rocky and steep in a general way and the soil is not of a character that would produce sufficient vegetation to make grazing profitable;

That affiant for a great number of years has been engaged in the business of grazing cattle in the vicinity of which this land is located, and that affiant's statement is based on his personal knowledge and experience in that respect;

THEREFORE, affiant is of the opinion, based upon his said experience and personal knowledge that the said land is more valuable for stone and timber than for grazing;

That affiant is not related to or employed by the applicant herein on this land;

Further affiant sayeth not.

(Signed) Geo. Sawday

ooOo

Subscribed and sworn to before me this 27th day of
July, 1923.

Lou B Mathews
Notary Public in and for the
County of San Diego, State of
California

My commission expires Dec. 7-1926.

DEPARTMENT OF THE INTERIOR
United States Land Office
Los Angeles, Cal.

AFFIDAVIT OF CORA BELLE FLETCHER AND CORROBORATING WITNESSES-Serial
035266

United States of America }
State of California } ss
County of San Diego }

MAX J. BOWEN being

first duly sworn deposes and says:

That affiant has personal knowledge of the land embraced in the application mentioned in the affidavit to which this affidavit is attached, to-wit:

S $\frac{1}{2}$ NE $\frac{1}{4}$, NE $\frac{1}{4}$ SE $\frac{1}{4}$ Sec. 15, NW $\frac{1}{4}$ SW $\frac{1}{4}$ Sec. 14, T. 11 S., R. 2 E., S.B.M. and is familiar with the character of land embraced in said application.

That it is the opinion of affiant that all of the said land is more valuable for the stone and timber thereon than for grazing or agricultural purposes, as the land is extremely rocky and steep in a general way and the soil is not of a character that would produce sufficient vegetation to make grazing profitable;

That affiant for a great number of years has been engaged in the business of grazing cattle in the vicinity of which this land is located, and that affiant's statement is based on his personal knowledge and experience in that respect;

THEREFORE, affiant is of the opinion, based upon his said experience and personal knowledge that the said land is more valuable for stone and timber than for grazing;

That affiant is not related to or employed by the applicant herein on this land;

Further affiant sayeth not.

(signed) MAX J. BOWEN

ooOo

Subscribed and sworn to before me this _____ day of
July, 1923.

Notary Public in and for the
County of San Diego, State of
California

My commission expires _____

DEPARTMENT OF THE INTERIOR
UNITED STATES LAND OFFICE

Los Angeles, Cal.

(Place)

June 28, 1923.

(Date)

K. L. May,
3526 Park Blvd.
San Diego, Calif.

Serial 035267

In reference to your timber and stone application for the
E $\frac{1}{2}$ NW $\frac{1}{4}$ Sec. 15, T. 11 S., R. 2 E., S.B.M.,
you are advised that under date of June 20, 1923 the
Commissioner of the General Land Office allowed you to file
your affidavit, corroborated by that of two witnesses, setting
forth facts tending to disprove the report of the Chief of Field
Division that the land is more valuable for grazing than for tim-
ber and stone. If the required affidavit is filed, a hearing will
be ordered to determine the character of the land; if not filed,
the case will be closed on our records.
You must show that the land is chiefly valuable for its timber or
stone.

Thirty days from notice are allowed within which to comply
with the requirements of the Commissioner, or to appeal from
his decision to the Secretary of the Interior; and upon your
failure to take action within the time specified the case will
be reported for appropriate action.

~~A copy of the decision is inclosed.~~

In responding hereto, refer to the Serial number.

Very respectfully,

B. B. Smith, Register.
B. B. Smith, Receiver.

DEPARTMENT OF THE INTERIOR
United States Land Office
Los Angeles, Cal.

AFFIDAVIT OF K. L. MAY AND CORROBORATING WITNESSES-Serial 035267

United States of America }
State of California } SS
County of San Diego }

K. L. May

being first duly sworn deposes and says:

That affiant is personally familiar with the character of land embraced in affiant's application for E $\frac{1}{2}$ NW $\frac{1}{2}$, Sec. 15, T. 11 S., R. 2 E., S. B. M. under timber and stone application under the General Statutes of the United States;

That the land embraced in the said application is not of a character that could be used for grazing or for agricultural purposes as the soil is extremely rocky and could not produce sufficient vegetation of any kind to support animal life in sufficient quantities to justify its use for that purpose; and

That the said land is chiefly valuable for use of the stone and timber thereon and not for any other purpose;

That attached hereto and made a part of this affidavit are the affidavits of two corroborating witnesses. Both of them have been engaged for a number of years in the business of grazing cattle and are familiar with land suitable and adaptable for grazing purposes and their affidavits for that reason are entitled to full credit.

THEREFORE affiant prays that said application be granted.

Signed-K. L. May

Subscribed and sworn to before me this _____ day of

July, 1923.

Notary Public in and for the County
of San Diego, State of California

My commission expires _____

DEPARTMENT OF THE INTERIOR
United States Land Office
Los Angeles, Cal.

AFFIDAVIT OF K. L. MAY AND CORROBORATING WITNESSES-Serial 035267

United States of America }
State of California } ss
County of San Diego }

GEO. SAWDAY being

first duly sworn deposes and says:

That affiant has personal knowledge of the land embraced in the application mentioned in the affidavit to which this affidavit is attached, to-wit:

E $\frac{1}{2}$ NW $\frac{1}{2}$ Sec. 15, T. 11 S., R. 2 E., S. B. M.

and is familiar with the character of land embraced in said application.

That it is the opinion of affiant that all of the said land is more valuable for the stone and timber thereon than for grazing or agricultural purposes, as the land is extremely rocky and steep in a general way and the soil is not of a character that would produce sufficient vegetation to make grazing profitable;

That affiant for a great number of years has been engaged in the business of grazing cattle in the vicinity of which this land is located, and that affiant's statement is based on his personal knowledge and experience in that respect;

THEREFORE, affiant is of the opinion, based upon his said experience and personal knowledge that the said land is more valuable for stone and timber than for grazing;

That affiant is not related to or employed by the applicant herein on this land;

Further affiant sayeth not.

(Signed) GEO. SAWDAY

ooOoo

ooOoo

Subscribed and sworn to before me this _____ day of
July, 1923.

Notary Public in and for the
County of San Diego, State of
California

My commission expires _____

#271

DEPARTMENT OF THE INTERIOR
United States Land Office
Los Angeles, Cal.

AFFIDAVIT OF K. L. MAY AND CORROBORATING WITNESSES-Serial 035267

United States of America }
State of California } SS
County of San Diego }

MAX J. BOWEN

being

first duly sworn deposes and says:

That affiant has personal knowledge of the land embraced in the application mentioned in the affidavit to which this affidavit is attached, to-wit:

E $\frac{1}{2}$ NW $\frac{1}{2}$ Sec. 15, T. 11 S., R. 2 E., S. B. M.

and is familiar with the character of land embraced in said application.

That it is the opinion of affiant that all of the said land is more valuable for the stone and timber thereon than for grazing or agricultural purposes, as the land is extremely rocky and steep in a general way and the soil is not of a character that would produce sufficient vegetation to make grazing profitable;

That affiant for a great number of years has been engaged in the business of grazing cattle in the vicinity of which this land is located, and that affiant's statement is based on his personal knowledge and experience in that respect;

THEREFORE, affiant is of the opinion, based upon his said experience and personal knowledge that the said land is more valuable for stone and timber than for grazing;

That affiant is not related to or employed by the applicant herein on this land;

Further affiant sayeth not.

(signed) MAX J. BOWEN

ooOoo

ooOoo

Subscribed and sworn to before me this _____ day of
July, 1923.

Notary Public in and for the
County of San Diego, State of
California

My commission expires _____

DEPARTMENT OF THE INTERIOR
UNITED STATES LAND OFFICE

Los Angeles, Cal.

(Place)

June 28, 1923.

(Date)

#271

Rebecca F. Doyle,
3427 4th St.,
San Diego, Calif.

Serial 035268

In reference to your timber or stone application for SW $\frac{1}{4}$ SE $\frac{1}{4}$
Sec. 25, T. 11 S., R. 2 E., S.B.M.

you are advised that under date of June 20, 1923 the
Commissioner of the General Land Office allowed you to file your
affidavit corroborated by that of two witnesses setting forth facts
tending to show that the report of the Chief of Field Division that
the land is more valuable for grazing than for timber and stone is
in error, which showing is necessary in order that a hearing may
be ordered to determine the character of the land. If the required
showing is not made the case will be closed on our records.

You must show that the land is chiefly valuable for its timber or
stone.

Thirty days from notice are allowed within which to comply
with the requirements of the Commissioner, or to appeal from
his decision to the Secretary of the Interior; and upon your
failure to take action within the time specified the case will
be reported for appropriate action.

~~A copy of the decision is inclosed.~~

In responding hereto, refer to the Serial number.

Very respectfully,

[Signature], Register.
[Signature], Receiver.

DEPARTMENT OF THE INTERIOR
United States Land Office
Los Angeles, Cal.

AFFIDAVIT OF REBECCA F. DOYLE AND CORROBORATING WITNESSES-Serial
035268

United States of America }
State of California } SS
County of San Diego }
REBECCA F DOYLE

being first duly sworn deposes and says:

That affiant is personally familiar with the character of land embraced in affiant's application for SE $\frac{1}{4}$ SE $\frac{1}{4}$ Sec. 23, T. 11 S., R. 2 E., S. B. M. under timber and stone application under the General Statutes of the United States;

That the land embraced in the said application is not of a character that could be used for grazing or for agricultural purposes as the soil is extremely rocky and could not produce sufficient vegetation of any kind to support animal life in sufficient quantities to justify its use for that purpose; and

That the said land is chiefly valuable for use of the stone and timber thereon and not for any other purpose;

That attached hereto and made a part of this affidavit are the affidavits of two corroborating witnesses. Both of them have been engaged for a number of years in the business of grazing cattle and are familiar with land suitable and adaptable for grazing purposes and their affidavits for that reason are entitled to full credit.

THEREFORE affiant prays that said application be granted.

signed-Rebecca F. Doyle

Subscribed and sworn to before me this _____ day of
July, 1923.

Notary Public in and for the County
of San Diego, State of California

My commission expires _____

DEPARTMENT OF THE INTERIOR
United States Land Office
Los Angeles, Cal.

AFFIDAVIT OF REBECCA E. DOYLE AND CORROBORATING WITNESSES-Serial 035268

United States of America)
State of California) ss
County of San Diego)

GEO SAWDAY

_____ being

first duly sworn deposes and says:

That affiant has personal knowledge of the land embraced in the application mentioned in the affidavit to which this affidavit is attached, to-wit:

S. E. $\frac{1}{4}$ of S. E. $\frac{1}{4}$ Sec. 23, T. 11 S., R. 2 E., S.B.M.

and is familiar with the character of land embraced in said application.

That it is the opinion of affiant that all of the said land is more valuable for the stone and timber thereon than for grazing or agricultural purposes, as the land is extremely rocky and steep in a general way and the soil is not of a character that would produce sufficient vegetation to make grazing profitable;

That affiant for a great number of years has been engaged in the business of grazing cattle in the vicinity of which this land is located and that affiant's statement is based on his personal knowledge and experience in that respect;

THEREFORE, affiant is of the opinion, based upon his said experience and personal knowledge that the said land is more valuable for stone and timber than for grazing;

That affiant is not related to or employed by the applicant herein on this land;

Further affiant sayeth not.

Signed - GEO SAVDAY

-----000-----

Subscribed and sworn to before me this _____ day of
July, 1923.

Notary Public in and for the
County of San Diego, State of
California

My commission expires _____

DEPARTMENT OF THE INTERIOR
United States Land Office
Los Angeles, Cal.

AFFIDAVIT OF REBECCA E. DOYLE AND CORROBORATING WITNESSES-Serial 035268

United States of America)
State of California) ss
County of San Diego)

MAX J. BOWEN

being

first duly sworn deposes and says:

That affiant has personal knowledge of the land embraced in the application mentioned in the affidavit to which this affidavit is attached, to-wit:

S. E. $\frac{1}{4}$ of S. E. $\frac{1}{4}$ Sec. 23, T. 11 S., R. 2 E., S.B.M.
and is familiar with the character of land embraced in said application.

That it is the opinion of affiant that all of the said land is more valuable for the stone and timber thereon than for grazing or agricultural purposes, as the land is extremely rocky and steep in a general way and the soil is not of a character that would produce sufficient vegetation to make grazing profitable;

That affiant for a great number of years has been engaged in the business of grazing cattle in the vicinity of which this land is located and that affiant's statement is based on his personal knowledge and experience in that respect;

THEREFORE, affiant is of the opinion, based upon his said experience and personal knowledge that the said land is more valuable for stone and timber than for grazing;

That affiant is not related to or employed by the applicant herein on this land;

Further affiant sayeth not.

Signed - MAX J. BOWEN

-----000-----

Subscribed and sworn to before me this _____ day of
July, 1923.

Notary Public in and for the
County of San Diego, State of
California

My commission expires _____

DEPARTMENT OF THE INTERIOR
UNITED STATES LAND OFFICE

Los Angeles, Cal.

(Place)
June 28, 1923.

(Date)

Ed Fletcher, Jr.
810 Ash St.,
San Diego, Cal.

Serial 035269

In reference to your application under the Timber and Stone law for the $N\frac{1}{2}$ SW $\frac{1}{4}$, SW $\frac{1}{4}$ NW $\frac{1}{4}$ Sec. 24, T. 11 S., R. 2 E., SBM you are advised that under date of June 20, 1923 the Commissioner of the General Land Office allowed you to file your affidavit, corroborated by that of two witnesses, showing that the land is chiefly valuable for its timber and stone and tending to disprove the report of the Chief of Field Division that the land is more valuable for grazing than for timber and stone. If the required affidavit is filed a hearing will be ordered; if not filed, the case will be closed on our records.

Thirty days from notice are allowed within which to comply with the requirements of the Commissioner, or to appeal from his decision to the Secretary of the Interior; and upon your failure to take action within the time specified the case will be reported for appropriate action.

~~A copy of the decision is inclosed.~~

In responding hereto, refer to the Serial number.

Very respectfully,

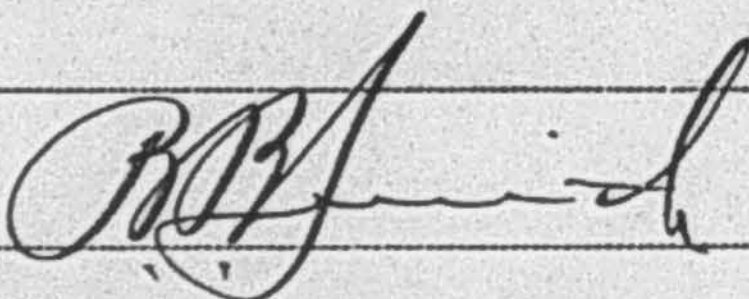
 , Register.
_____, Receiver.

DEPARTMENT OF THE INTERIOR
United States Land Office

Los Angeles, Cal.

AFFIDAVIT OF ED FLETCHER, JR., AND CORROBORATING WITNESSES-Serial No. 035269

United States of America }
State of California } SS
County of San Diego }

ED FLETCHER, JR

being first duly sworn deposes and says:

That affiant is personally familiar with the character of land embraced in affiant's application for N $\frac{1}{2}$ of SW $\frac{1}{2}$, SW $\frac{1}{2}$ of NW $\frac{1}{2}$, Section 24, T. 11 S., R. 2 E., S.B.M. under timber and stone application under the General Statutes of the United States;

That the land embraced in the said application is not of a character that could be used for grazing or for agricultural purposes as the soil is extremely rocky and could not produce sufficient vegetation of any kind to support animal life in sufficient quantities to justify its use for that purpose; and

That the said land is chiefly valuable for use of the stone and timber thereon and not for any other purpose;

That attached hereto and made a part of this affidavit are the affidavits of two corroborating witnesses. Both of them have been engaged for a number of years in the business of grazing cattle and are familiar with land suitable and adaptable for grazing purposes and their affidavits for that reason are entitled to full credit.

THEREFORE affiant prays that said application be granted.

Signed- Ed Fletcher, Jr

Subscribed and sworn to before me this _____ day of July, 1923.

Notary Public in and for the County of San Diego, State of California

My commission expires _____

DEPARTMENT OF THE INTERIOR
United States Land Office
Los Angeles, Cal.

AFFIDAVIT OF ED FLETCHER, JR. AND CORROBORATING WITNESSES-Serial 035269

United States of America }
State of California } ss
County of San Diego }

GEO SAWDAY being

first duly sworn deposes and says:

That affiant has personal knowledge of the land embraced in the application mentioned in the affidavit to which this affidavit is attached, to-wit:

N $\frac{1}{2}$ SW $\frac{1}{4}$, SW $\frac{1}{2}$ NW $\frac{1}{2}$ Sec. 24, T. 11 S., R. 2 E., S.B.M.

and is familiar with the character of land embraced in said application.

That it is the opinion of affiant that all of the said land is more valuable for the stone and timber thereon than for grazing or agricultural purposes, as the land is extremely rocky and steep in a general way and the soil is not of a character that would produce sufficient vegetation to make grazing profitable;

That affiant for a great number of years has been engaged in the business of grazing cattle in the vicinity of which this land is located, and that affiant's statement is based on his personal knowledge and experience in that respect;

THEREFORE, affiant is of the opinion, based upon his said experience and personal knowledge that the said land is more valuable for stone and timber than for grazing;

That affiant is not related to or employed by the applicant herein on this land;

#271

Further affiant sayeth not.

(Signed) GEO. SAWDAY

-----oOo-----

Subscribed and sworn to before me this _____ day of
July, 1923.

Notary Public in and for the
County of San Diego, State of
California

My commission expires _____

DEPARTMENT OF THE INTERIOR
United States Land Office
Los Angeles, Cal.

AFFIDAVIT OF ED FLETCHER, JR. AND CORROBORATING WITNESSES-Serial 035269

United States of America }
State of California } ss
County of San Diego }

MAX J. BOWEN being

first duly sworn deposes and says:

That affiant has personal knowledge of the land embraced in the application mentioned in the affidavit to which this affidavit is attached, to-wit:

N $\frac{1}{2}$ SW $\frac{1}{2}$, SW $\frac{1}{2}$ NW $\frac{1}{2}$ Sec. 24, T. 11 S., R. 2 E., S.B.M.

and is familiar with the character of land embraced in said application.

That it is the opinion of affiant that all of the said land is more valuable for the stone and timber thereon than for grazing or agricultural purposes, as the land is extremely rocky and steep in a general way and the soil is not of a character that would produce sufficient vegetation to make grazing profitable;

That affiant for a great number of years has been engaged in the business of grazing cattle in the vicinity of which this land is located, and that affiant's statement is based on his personal knowledge and experience in that respect;

THEREFORE, affiant is of the opinion, based upon his said experience and personal knowledge that the said land is more valuable for stone and timber than for grazing;

That affiant is not related to or employed by the applicant herein on this land;

Further affiant sayeth not.

(Signed) MAX J. BOWEN

---oO---

Subscribed and sworn to before me this _____ day of
July, 1923.

Notary Public in and for the
County of San Diego, State of
California

My commission expires _____

#271

AMS

4-485

DEPARTMENT OF THE INTERIOR
UNITED STATES LAND OFFICE

Los Angeles, Cal.

(Place)
June 28, 1923.

(Date)

Charles K. Fletcher,
1453 8th St.,
San Diego, Cal.

Serial 035270

In reference to your timber and stone application for
NW $\frac{1}{4}$ NE $\frac{1}{4}$ Sec. 23, T. 11 S., R. 2 E., S.B.M.,

you are advised that under date of June 20, 1923 the
Commissioner of the General Land Office allowed you to file
your affidavit, corroborated by that of two witnesses, setting
forth facts tending to disprove the report of the Chief of Field
Division that the land is more valuable for grazing than for
timber and stone. If the required affidavit is filed a hear-
ing will be ordered to determine the character of the land; and
if not filed, the case will be closed on our records.
You must show that the land is chiefly valuable for its timber or
stone.

Thirty days from notice are allowed within which to comply
with the requirements of the Commissioner, or to appeal from
his decision to the Secretary of the Interior; and upon your
failure to take action within the time specified the case will
be reported for appropriate action.

~~A copy of the decision is inclosed.~~

In responding hereto, refer to the Serial number.

Very respectfully,

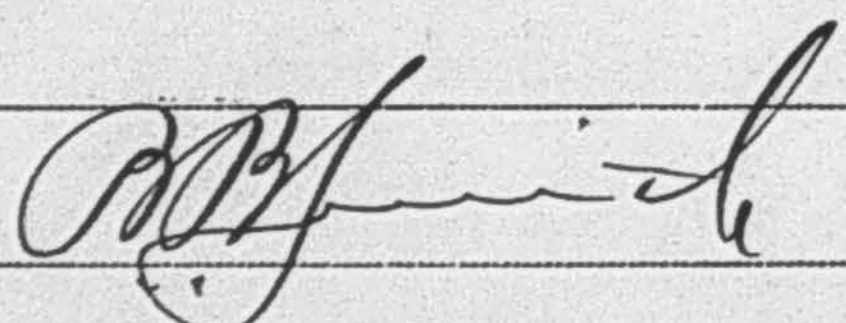
 Register.
Receiver.

DEPARTMENT OF THE INTERIOR
United States Land Office
Los Angeles, Cal.

AFFIDAVIT OF CHARLES K. FLETCHER AND CORROBORATING WITNESSES-Serial
035270

United States of America }
State of California } SS
County of San Diego }
CHARLES K. FLETCHER

being first duly sworn deposes and says:

That affiant is personally familiar with the character of land embraced in affiant's application for NW $\frac{1}{4}$ NE $\frac{1}{4}$, Sec. 23, T. 11 S., R. 2 E., S. B. M. under timber and stone application under the General Statutes of the United States;

That the land embraced in the said application is not of a character that could be used for grazing or for agricultural purposes as the soil is extremely rocky and could not produce sufficient vegetation of any kind to support animal life in sufficient quantities to justify its use for that purpose; and

That the said land is chiefly valuable for use of the stone and timber thereon and not for any other purpose;

That attached hereto and made a part of this affidavit are the affidavits of two corroborating witnesses. Both of them have been engaged for a number of years in the business of grazing cattle and are familiar with land suitable and adaptable for grazing purposes and their affidavits for that reason are entitled to full credit.

THEREFORE affiant prays that said application be granted.

SIGNED* CHARLES K. FLETCHER
CK Fletcher

Subscribed and sworn to before me this _____ day of

July, 1923.

Notary Public in and for the County
of San Diego, State of California

My commission expires _____

DEPARTMENT OF THE INTERIOR
United States Land Office
Los Angeles, Cal.

AFFIDAVIT OF CHARLES K. FLETCHER AND CORROBORATING WITNESSES-Serial
035270

United States of America)
State of California) ss
County of San Diego)

GEO. SAWDAY being

first duly sworn deposes and says:

That affiant has personal knowledge of the land embraced in the application mentioned in the affidavit to which this affidavit is attached, to-wit:

NW $\frac{1}{4}$ NE $\frac{1}{4}$ Sec. 23, T. 11 S., R. 2 E., S. B. M.

and is familiar with the character of land embraced in said application.

That it is the opinion of affiant that all of the said land is more valuable for the stone and timber thereon than for grazing or agricultural purposes, as the land is extremely rocky and steep in a general way and the soil is not of a character that would produce sufficient vegetation to make grazing profitable;

That affiant for a great number of years has been engaged in the business of grazing cattle in the vicinity of which this land is located, and that affiant's statement is based on his personal knowledge and experience in that respect;

THEREFORE, affiant is of the opinion, based upon his said experience and personal knowledge that the said land is more valuable for stone and timber than for grazing;

That affiant is not related to or employed by the applicant herein on this land;

Further affiant sayeth not.

GEO. SAWDAY

000

Subscribed and sworn to before me this _____ day of
July, 1925.

Notary Public in and for the
County of San Diego, State of
California.

My commission expires _____

DEPARTMENT OF THE INTERIOR
United States Land Office
Los Angeles, Cal.

AFFIDAVIT OF CHARLES K. FLETCHER AND CORROBORATING WITNESSES-Serial
035270

United States of America)
State of California) ss
County of San Diego)

MAY J. BOWEN being

first duly sworn deposes and says:

That affiant has personal knowledge of the land embraced in the application mentioned in the affidavit to which this affidavit is attached, to-wit:

NW¹ NE¹ Sec. 25, T. 11 S., R. 2 E., S. B. M.

and is familiar with the character of land embraced in said application.

That it is the opinion of affiant that all of the said land is more valuable for the stone and timber thereon than for grazing or agricultural purposes, as the land is extremely rocky and steep in a general way and the soil is not of a character that would produce sufficient vegetation to make grazing profitable;

That affiant for a great number of years has been engaged in the business of grazing cattle in the vicinity of which this land is located, and that affiant's statement is based on his personal knowledge and experience in that respect;

THEREFORE, affiant is of the opinion, based upon his said experience and personal knowledge that the said land is more valuable for stone and timber than for grazing;

That affiant is not related to or employed by the applicant herein on this land;

Further affiant sayeth not.

(Signed) Max J. Bowen

~~-----000-----~~

Subscribed and sworn to before me this _____ day of
July, 1923.

Notary Public in and for the
County of San Diego, State of
California.

My commission expires _____

DEPARTMENT OF THE INTERIOR
UNITED STATES LAND OFFICE

Los Angeles, Cal.

(Place)

June 28, 1923.

(Date)

Jarvis L. Doyle,
3427 4th St.,
San Diego, Calif.

Serial 035271

In reference to your timber and stone application for the
SE¹ SE¹ Sec. 24, T. 11 S., R. 2 E., S.B.M.

you are advised that under date of June 20, 1923 the
Commissioner of the General Land Office allowed you to file your
affidavit corroborated by that of two witnesses setting forth
facts tending to show that the land is chiefly valuable for its
timber and stone and to disprove the report of the Chief of Field
Division that the land is more valuable for grazing than for tim-
ber and stone. If the required affidavit is filed, a hearing
will be ordered to determine the character of the land; if not
filed, the case will be closed on our records.

Thirty days from notice are allowed within which to comply
with the requirements of the Commissioner, or to appeal from
his decision to the Secretary of the Interior; and upon your
failure to take action within the time specified the case will
be reported for appropriate action.

~~A copy of the decision is inclosed.~~

In responding hereto, refer to the Serial number.

Very respectfully,

[Signature], Register.
[Signature], Receiver.

DEPARTMENT OF THE INTERIOR
United States Land Office
Los Angeles, Cal.

AFFIDAVIT OF JARVIS L. DOYLE AND CORROBORATING WITNESSES-Serial
035271

United States of America }
State of California } SS
County of San Diego }

JARVIS L. DOYLE

being first duly sworn deposes and says:

That affiant is personally familiar with the character of land embraced in affiant's application for SE $\frac{1}{4}$ SE $\frac{1}{4}$ Sec. 24, T. 11 S., R. 2 E., S.B.M., under timber and stone application under the General Statutes of the United States;

That the land embraced in the said application is not of a character that could be used for grazing or for agricultural purposes as the soil is extremely rocky and could not produce sufficient vegetation of any kind to support animal life in sufficient quantities to justify its use for that purpose; and

That the said land is chiefly valuable for use of the stone and timber thereon and not for any other purpose;

That attached hereto and made a part of this affidavit are the affidavits of two corroborating witnesses. Both of them have been engaged for a number of years in the business of grazing cattle and are familiar with land suitable and adaptable for grazing purposes and their affidavits for that reason are entitled to full credit.

THEREFORE affiant prays that said application be granted.

signed- Jarvis L. Doyle

Subscribed and sworn to before me this _____ day of

July, 1923.

Notary Public in and for the County
of San Diego, State of California

My commission expires _____

DEPARTMENT OF THE INTERIOR
United States Land Office
Los Angeles, Cal.

AFFIDAVIT OF JARVIS L. DOYLE and CORROBORATING WITNESSES-Serial 035271

United States of America }
State of California } SS
County of San Diego }

MAX J. BOWEN

being

first duly sworn deposes and says:

That affiant has personal knowledge of the land embraced in the application mentioned in the affidavit to which this affidavit is attached, to-wit:

SE $\frac{1}{2}$ SE $\frac{1}{2}$ Sec. 24, T. 11 S., R. 2 E., S.B.M.

and is familiar with the character of land embraced in said application.

That it is the opinion of affiant that all of the said land is more valuable for the stone and timber thereon than for grazing or agricultural purposes, as the land is extremely rocky and steep in a general way and the soil is not of a character that would produce sufficient vegetation to make grazing profitable;

That affiant for a great number of years has been engaged in the business of grazing cattle in the vicinity of which this land is located and that affiant's statement is based on his personal knowledge and experience in that respect;

THEREFORE, affiant is of the opinion, based upon his said experience and personal knowledge that the said land is more valuable for stone and timber than for grazing;

That affiant is not related to or employed by the applicant herein on this land;

Further affiant sayeth not.

Signed - Max J. Bowen

-----000-----

Subscribed and sworn to before me this _____ day of
July, 1923.

Notary Public in and for the
County of San Diego, State of
California

My commission expires _____

DEPARTMENT OF THE INTERIOR
United States Land Office
Los Angeles, Cal.

AFFIDAVIT OF JARVIS L. DOYLE and CORROBORATING WITNESSES-Serial 035271

United States of America }
State of California } SS
County of San Diego }

GEO SAWDAY

being

first duly sworn deposes and says:

That affiant has personal knowledge of the land embraced in the application mentioned in the affidavit to which this affidavit is attached, to-wit:

SE $\frac{1}{2}$ SE $\frac{1}{2}$ Sec. 24, T. 11 S., R. 2 E., S.B.M.

and is familiar with the character of land embraced in said application.

That it is the opinion of affiant that all of the said land is more valuable for the stone and timber thereon than for grazing or agricultural purposes, as the land is extremely rocky and steep in a general way and the soil is not of a character that would produce sufficient vegetation to make grazing profitable;

That affiant for a great number of years has been engaged in the business of grazing cattle in the vicinity of which this land is located and that affiant's statement is based on his personal knowledge and experience in that respect;

THEREFORE, affiant is of the opinion, based upon his said experience and personal knowledge that the said land is more valuable for stone and timber than for grazing;

That affiant is not related to or employed by the applicant herein on this land;

Further affiant sayeth not.

signed - GEO SAWDAY

-----000-----

Subscribed and sworn to before me this _____ day of
July, 1923.

Notary Public in and for the
County of San Diego, State of
California

My commission expires _____

AMS

#271

DEPARTMENT OF THE INTERIOR
UNITED STATES LAND OFFICE

Los Angeles, Cal.

(Place)

June 28, 1923.

(Date)

Mrs. Mary C. B. Fletcher,
810 Ash St.,
San Diego, Cal.

Serial 035289

In reference to your timber and stone application for the SW¹ SW¹ Sec. 10, T. 11 S., R. 2 E., S.B.M., you are advised that under date of June 15, 1923 the Commissioner of the General Land Office allowed you to file your affidavit, corroborated by that of two witnesses, showing that the land is chiefly valuable for its timber or stone, and tanding to disprove report of the Chief of Field Division that the land is chiefly valuable for grazing and not for timber and stone. If the required affidavit is filed, a hearing will be ordered to determine the character of the land; if not filed, the case will be closed on our records.

Thirty days from notice are allowed within which to comply with the requirements of the Commissioner, or to appeal from his decision to the Secretary of the Interior; and upon your failure to take action within the time specified the case will be reported for appropriate action.

~~A copy of the decision is inclosed.~~

In responding hereto, refer to the Serial number.

Very respectfully,

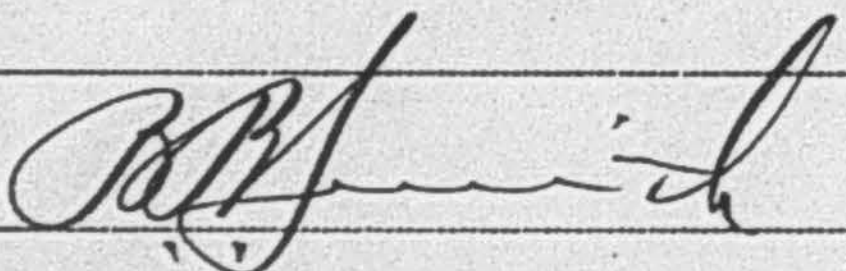
 , Register.
_____, Receiver.

DEPARTMENT OF THE INTERIOR
United States Land Office
Los Angeles, Cal.

AFFIDAVIT OF MARY C. B. FLETCHER AND CORROBORATING WITNESSES-Serial
035289

United States of America }
State of California } SS
County of San Diego }

MARY C. B. FLETCHER

being first duly sworn deposes and says:

That affiant is personally familiar with the character of land embraced in affiant's application for SW $\frac{1}{4}$ SW $\frac{1}{4}$ Sec. 10, T. 11 S., R. 2 E., S.B.M., under timber and stone application under the General Statutes of the United States;

That the land embraced in the said application is not of a character that could be used for grazing or for agricultural purposes as the soil is extremely rocky and could not produce sufficient vegetation of any kind to support animal life in sufficient quantities to justify its use for that purpose; and

That the said land is chiefly valuable for use of the stone and timber thereon and not for any other purpose;

That attached hereto and made a part of this affidavit are the affidavits of two corroborating witnesses. Both of them have been engaged for a number of years in the business of grazing cattle and are familiar with land suitable and adaptable for grazing purposes and their affidavits for that reason are entitled to full credit.

THEREFORE affiant prays that said application be granted.

Signed-Mary C. B. Fletcher

Subscribed and sworn to before me this _____ day of
July, 1923.

Notary Public in and for the County
of San Diego, State of California
My commission expires _____

DEPARTMENT OF THE INTERIOR
United States Land Office
Los Angeles, Cal.

AFFIDAVIT OF MRS. MARY C. B. FLETCHER AND CORROBORATING WITNESSES-Serial
035289

United States of America }
State of California } ss
County of San Diego }

GEO. SAWDAY being

first duly sworn deposes and says:

That affiant has personal knowledge of the land embraced in the application mentioned in the affidavit to which this affidavit is attached, to-wit:

SW $\frac{1}{4}$ SW $\frac{1}{4}$ Sec. 10, T. 11 S., R. 2 E., S. B. M.

and is familiar with the character of land embraced in said application.

That it is the opinion of affiant that all of the said land is more valuable for the stone and timber thereon than for grazing or agricultural purposes, as the land is extremely rocky and steep in a general way and the soil is not of a character that would produce sufficient vegetation to make grazing profitable;

That affiant for a great number of years has been engaged in the business of grazing cattle in the vicinity of which this land is located, and that affiant's statement is based on his personal knowledge and experience in that respect;

THEREFORE, affiant is of the opinion, based upon his said experience and personal knowledge that the said land is more valuable for stone and timber than for grazing;

That affiant is not related to or employed by the applicant herein on this land;

Further affiant sayeth not.

(Signed) GEO. SAWDAY

-----000-----

Subscribed and sworn to before me this _____ day of
July, 1923.

Notary Public in and for the
County of San Diego, State of
California

My commission expires _____

DEPARTMENT OF THE INTERIOR
United States Land Office
Los Angeles, Cal.

AFFIDAVIT OF MRS. MARY C. B. FLETCHER AND CORROBORATING WITNESSES-Serial
035289

United States of America }
State of California } ss
County of San Diego }

MAX J. BOWEN

being

first duly sworn deposes and says:

That affiant has personal knowledge of the land embraced in the application mentioned in the affidavit to which this affidavit is attached, to-wit:

SW $\frac{1}{4}$ SW $\frac{1}{4}$ Sec. 10, T. 11 S., R. 2 E., S. B. M.

and is familiar with the character of land embraced in said application.

That it is the opinion of affiant that all of the said land is more valuable for the stone and timber thereon than for grazing or agricultural purposes, as the land is extremely rocky and steep in a general way and the soil is not of a character that would produce sufficient vegetation to make grazing profitable;

That affiant for a great number of years has been engaged in the business of grazing cattle in the vicinity of which this land is located, and that affiant's statement is based on his personal knowledge and experience in that respect;

THEREFORE, affiant is of the opinion, based upon his said experience and personal knowledge that the said land is more valuable for stone and timber than for grazing;

That affiant is not related to or employed by the applicant herein on this land;

Further affiant sayeth not.

(Signed) MAX. J. BOWEN

-----000-----

Subscribed and sworn to before me this _____ day of
July, 1923.

Notary Public in and for the
County of San Diego, State of
California

My commission expires _____

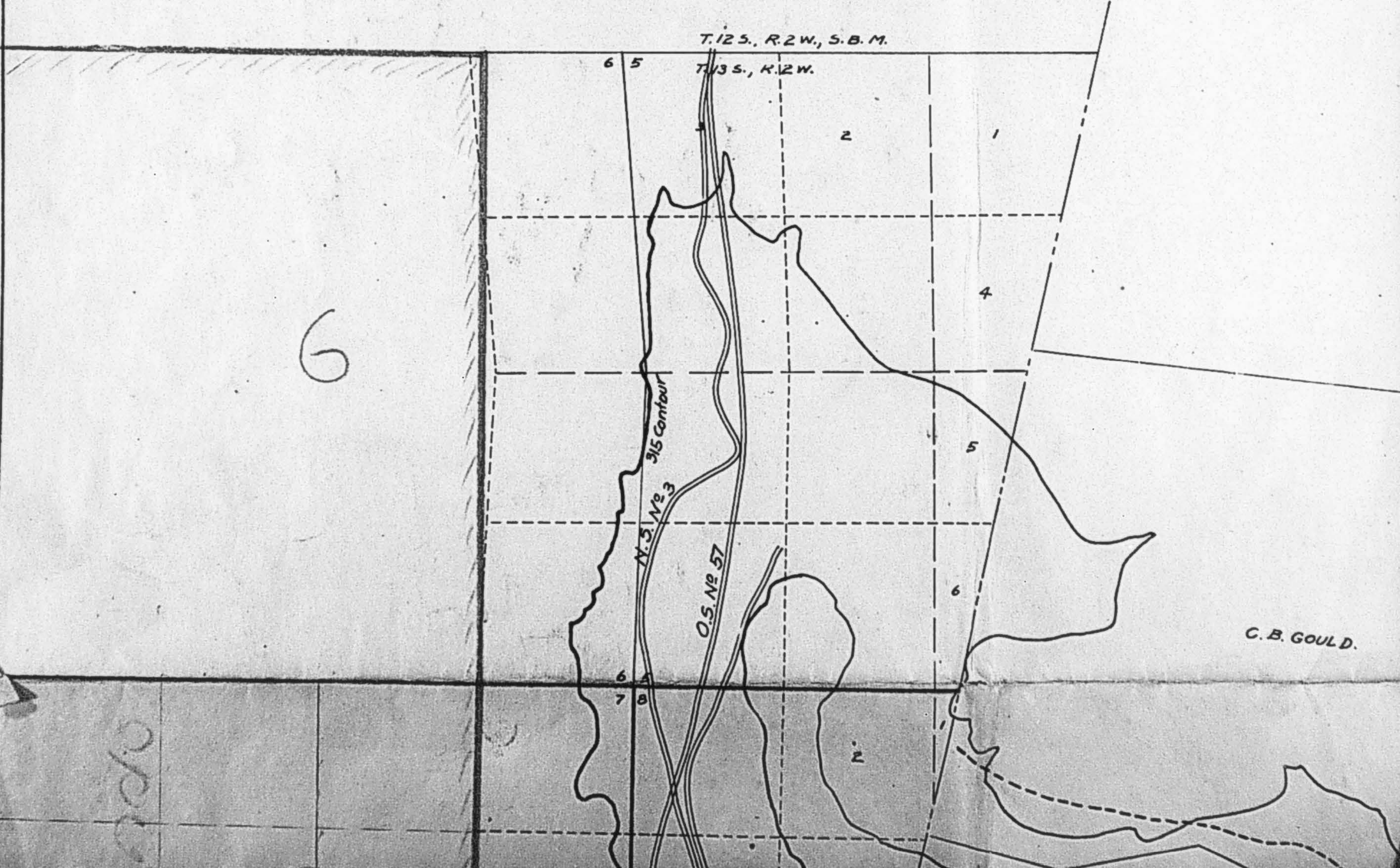

6

65

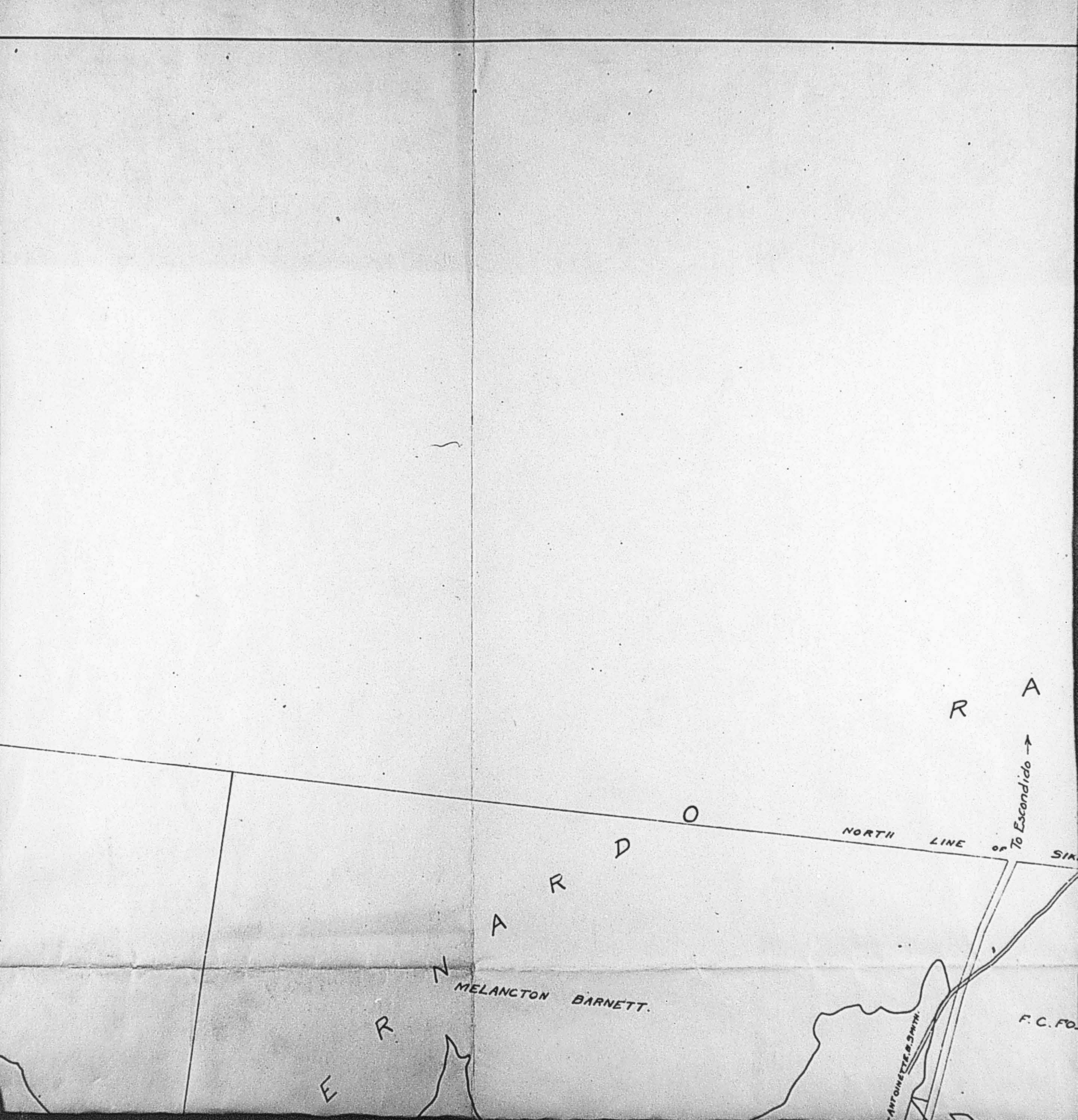

E

R

N

A

R

D

O

NORTH

LINE

of

To Escandido →

SIX

MELANCTON BARNETT.

ANTONETTE B. SMITH.

F. C. FO.

R

A

R
A
N
C
H
O

To Escondido →

O.S. No 9

SIKES TRACT

F. C. FOSTER

H. G. FENTON

San Bernardo

TH

LINE OF

ANTONETTE S. SMITH

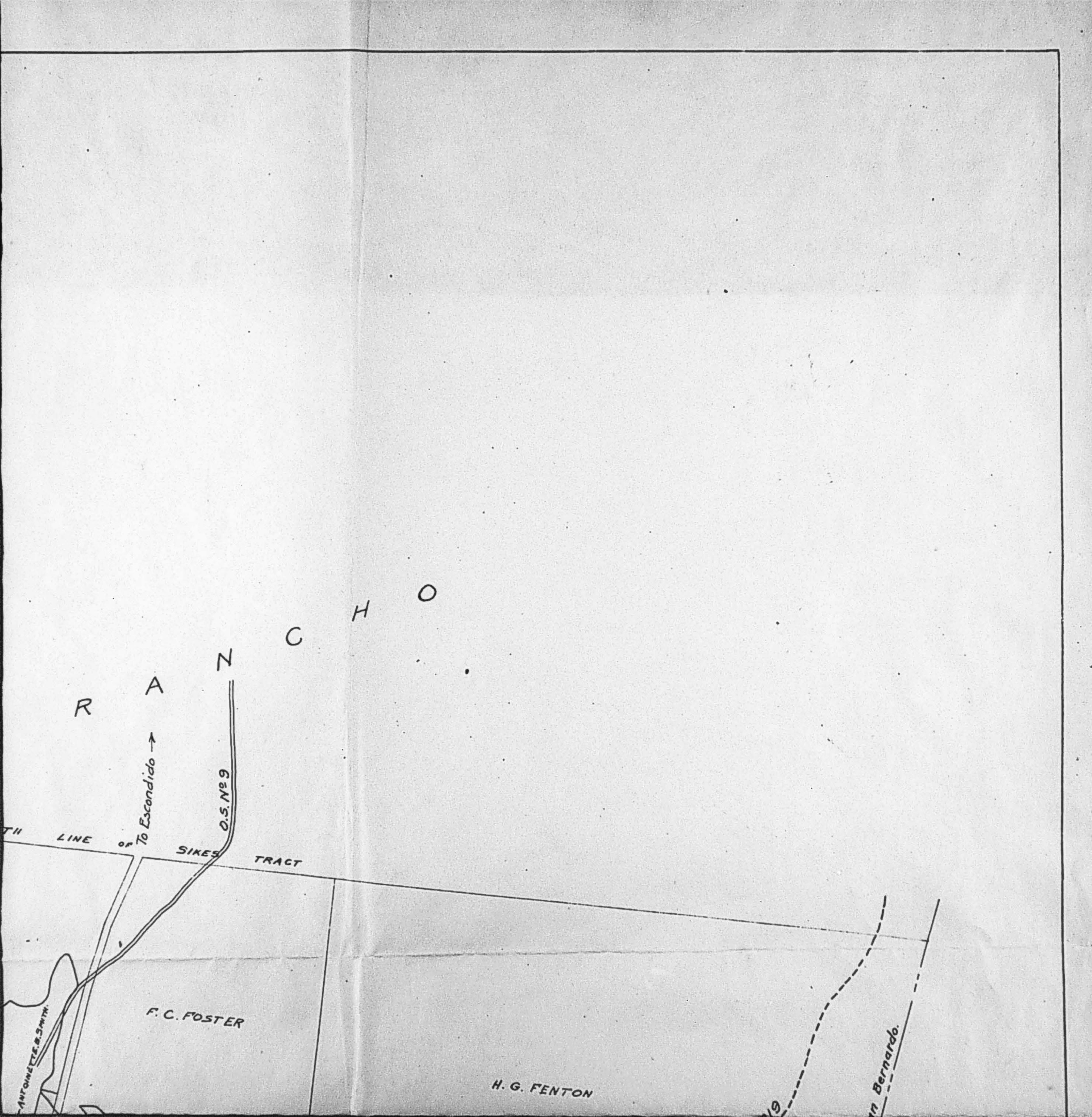

Surveyed land

7

Stevens

SE x NW SW NE

18

7 8 7 8 18 17

N.S. No 3

O.S. 124

315 Contbu

N.S. No 3

O.S. No 57

O.S. No 124

West Line Rancho San Bernardo

EUCALYPTUS CULTURE COMPANY

S

A

Appra

MELANCTON BARNETT.

B
E
R

Approx. Location of Road shown on 1880 Road Map

315 Contour

CENTER LINE of

BERNARDO RIVER

315 Contour

O.S. No 9

To San Diego

MARY LOUISA CHAPMAN

Green Canyon

COMPANY

N

A

ED FLE

#277

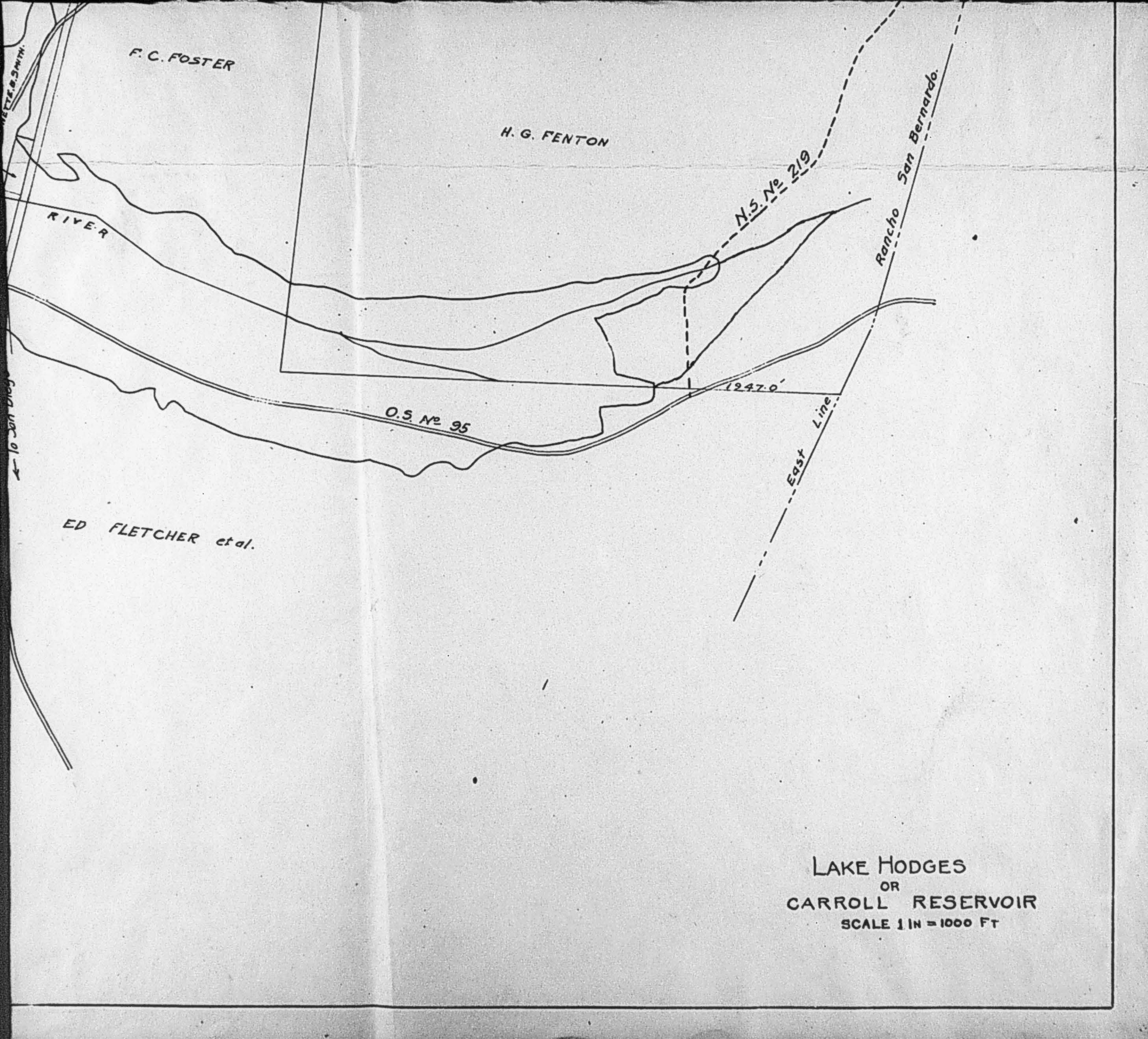

F. C. FOSTER

H. G. FENTON

RIVER

N.S. No 219

Rancho San Bernardo

O.S. No 95

1247.0'

East Line

ED FLETCHER et al.

LAKE HODGES
OR
CARROLL RESERVOIR
SCALE 1 IN = 1000 FT

METERS 0.3 MIN.

to San Diego

277

L.V.

NOTICE FOR PUBLICATION
of filing township plat.
DEPARTMENT OF THE INTERIOR
UNITED STATES LAND OFFICE
Los Angeles, California

December 16, 1923.

NOTICE IS HEREBY GIVEN that plat of the following numbered township has been received and will be filed in this office, on January 30, 1923, at 9:00 A. M., and that on and after January 10, 1923, applications will be received for entry of all public lands in said township. All applications, filings, and selections, filed on January 10, 1923, and to January 30, 1923, 9:00 A. M., inclusive, will be held and treated as having been simultaneously filed.

13 2
Pace. Tp. 13 S., R. 2 W., S.B.M.

The SW¹/₄NE¹/₄; SE¹/₄NE¹/₄; Sec. 18, are embraced in Wyandotte and Valentine Scrip locations, and are not subject to entry.

United States Officer's, Soldier's, Sailor's, Marines or Nurses who have served in the war with Germany shall have a preference right of entry under the homestead and desert land laws for a period of 91 days beginning with January 30, 1923, if properly qualified and with certain exceptions.

DUDLEY S. VALENTINE

Register

B. B. SMITH

Receiver

L.V.

7 277

NOTICE FOR PUBLICATION
of filing township plat.
DEPARTMENT OF THE INTERIOR
UNITED STATES LAND OFFICE
Los Angeles, California

December 16, 1923.

NOTICE IS HEREBY GIVEN that plat of the following
numbered township has been received and will be
filed in this office, on January 30, 1924,
at 9:00 A. M., and that on and after January 10, 1924,
applications will be received for entry of all public
lands in said township. All applications, filings,
and selections, filed on January 10, 1924, and
to January 30, 1924, 9:00 A. M., inclusive,
will be held and treated as having been simultaneously
filed.

13
2
Pres. Tp. 13 S., R. 2 W., S.B.M.

The ~~sections~~; ~~sections~~; Sec. 15, are embraced in Wyandotte and
Valentine Scrip locations, and are not subject to entry.

United States Officer's, Soldier's, Sailor's, Marines
or Nurses who have served in the war with Germany shall have
a preference right of entry under the Homestead and desert land
laws for a period of 91 days beginning with January 30, 1924,
if properly qualified and with certain exceptions.

DUDLEY S. VALENTINE

Register

B. B. SMITH

Receiver

Office Jan. 8, 1923

Mr. King:

Have Edward immediately take this land up 160 acres where I have marked with a circle that is not taken up and take it up under the stone and timber act. If there are only 80 acres, take up the 80 marked Stevens under the Stone and Timber Act and show that he was a soldier in the war with Germany. Get these papers out and get them filed as I do not think it can ever be homesteaded as it is not farming land, but get Edward's application in.

E.F.

SOUTH COAST LAND COMPANY

BY RECEIVED

WELCHER-STEVENSON INVESTMENT COMPANY

Handwritten signature/initials

10

DEPARTMENT OF THE INTERIOR.

TIMBER OR STONE ENTRY.

U. S. LAND OFFICE, Los Angeles, Calif., No.

RECEIPT No.

APPLICATION AND SWORN STATEMENT.

(TO BE MADE IN DUPLICATE.)

I, Ed Fletcher, Jr. (Male), (Give full Christian name.) (Male or female.)

hereby make application to purchase the West half of the Southeast quarter of Section 7, and the Northwest quarter of the Northeast quarter and the Northeast quarter of the Northwest quarter of, Section 7 & 18 Section 18.

Township 13 S, Range 2 W, San Bernardino Meridian,

containing 1600 acres, within the Los Angeles Calif. land

district, in the State of California, and the timber thereon, at such value as may be fixed by appraisalment, made under authority of the Secretary of the Interior, under the act of June 3, 1878, commonly known as the "Timber and Stone Law," and acts amendatory thereof, and in support of this application I do solemnly swear that I

(Applicant must state whether native born, naturalized, or has filed declaration of intention to become a citizen. If not native born, certified copy of naturalization or declaration of intention, as case may be, must be filed with this affidavit. If female, state whether married or single, and if married since March 2, 1907, the citizenship of the husband must be shown.)

Ed Fletcher, Jr., am a native born citizen of California and

citizen of the United States, of the age of 32 years, and by occu-

pation a rancher; that I did, on January 26th,

1923, examine said land, and from my personal knowledge state that said land is unfit for cultivation and is valuable chiefly for its

Stone timber; and that to my best knowledge and belief, based upon said

examination, the land is worth \$150.00

dollars, and the Stone timber thereon, which I estimate to be

feet, board measure, is worth \$250.00

dollars, making a total value for the land and Stone timber of

\$400.00 dollars, and no more; that

the land is uninhabited; that it contains no mining or other improvements, nor, as I verily believe, any valuable deposit of gold, silver, cinnabar, copper, coal, or other minerals, salt springs, or deposits of salt; that I have made no other application under said acts; that I do not apply to purchase the land above described on speculation, but in good faith to appropriate it to my own exclusive use and benefit, and that I have not, directly or indirectly, made any agreement or contract, in any way or manner, with any person or persons whomsoever, by which the title I may acquire from the Government of the United States may inure in whole or in part to the benefit of any person except myself; that since August 30, 1890, I have not entered and acquired title to, nor am I now claiming, under an entry made under any of the nonmineral public-land laws, an amount of land which, together with the land now applied for, will exceed in the aggregate 320 acres; that I am not a member of any association, or a stockholder in any corporation which has filed an application and sworn statement under said act; and that my post-

office address is 920 Eighth Street

(If a city, street and number must be given.)

at which place any notice affecting my rights under this application may be sent.

I request that notice be furnished me for publication in the

Escondido Advocate

newspaper, published

(The newspaper must be one of general circulation, published nearest the land.)

at Escondido, Calif.

(Sign here, with full Christian name.)

NOTE.—Every person swearing falsely to the above affidavit will be punished as provided by law for such offense. (See Sec. 5392, R. S., below.)

In addition thereto, the money that may be paid for the land is forfeited, and all conveyances of the land, or of any right, title, or claim thereto, are absolutely null and void as against the United States.

I HEREBY CERTIFY that the foregoing affidavit was read to or by affiant in my presence before affiant affixed signature thereto; that affiant is to me personally known (or has been satisfactorily identified before me by _____);

(Give full name and post-office address.)

that I verily believe affiant to be a qualified applicant and the identical person hereinbefore described, and that said affidavit was duly subscribed and sworn to before me at my office, in _____

(Town.)

(County and State.)

_____, within the _____ land district, this _____ day of _____, 19____

County Clerk and ex-officio clerk of the Superior Court of San Diego County, State of California.

(Official designation of officer.)

United States Land Office, _____

_____, 19____

I HEREBY CERTIFY that the foregoing application is for surveyed land; that there is no prior valid adverse right to the same, and that the original of which this is a duplicate has been forwarded to the Chief of Field Division.

Register.

REVISED STATUTES OF THE UNITED STATES. TITLE LXX.—CRIMES.—CHAP. 4.

Sec. 5392. Every person who, having taken an oath before a competent tribunal, officer, or person, in any case in which a law of the United States authorizes an oath to be administered, that he will testify, declare, depose, or certify truly, or that any written testimony, declaration, deposition, or certificate by him subscribed is true, willfully and contrary to such oath states or subscribes any material matter which he does not believe to be true, is guilty of perjury, and shall be punished by fine of not more than two thousand dollars, and by imprisonment, at hard labor, not more than five years; and shall, moreover, thereafter be incapable of giving testimony in any court of the United States until such time as the judgment against him is reversed. (See Sec. 1750.)

NOTE.—In addition to the above penalty, every person who knowingly or willfully in anywise procures the making or presentation of any false or fraudulent affidavit pertaining to any matter within the jurisdiction of the Secretary of the Interior may be punished by fine or imprisonment.

277

January 26, 1923.

Department of Interior,
U. S. Land Office,
Los Angeles, Calif.

Gentlemen:

Inclosed herewith you will find application under the Timber or Stone Act, together with U. S. postal money order for \$10.00 to cover filing fee. I wish to claim whatever rights or privileges which may accrue to my benefit by reason of service in the World War. I was in the Air Service, Army Serial No. 874110, having enlisted on November 7th, 1918.

Yours very truly,

(Signed) Ed Fletcher Jr.

Dictated by
J. H. King &
Ed Fletcher, Jr.

DEPARTMENT OF THE INTERIOR
UNITED STATES LAND OFFICE

Los Angeles, Calif.,

(Place.)

Jan. 31, 1923

(Date.)

Ed. Fletcher, Jr.,
920-8th St.
San Diego, Cal.

NOTICE OF REJECTION
or Suspension.

Sir:

In reference to your Timber & Stone application No. 035860

for the
W $\frac{1}{2}$ SE $\frac{1}{4}$ Sec. 7; NW $\frac{1}{4}$ NE $\frac{1}{4}$; NE $\frac{1}{4}$ NW $\frac{1}{4}$, Section 18,
Township 13 S, Range 2 W, S.B. Meridian,
you are advised that on Jan. 29, 1923, the Register and
Receiver of this office rejected the same for
(Insert "Rejected" or "Suspended" as case may be.)
the reason that you have exercised your Timber & Stone right
on Timber and Stone application No. 035269; 2-The W $\frac{1}{2}$ SE $\frac{1}{4}$ Sec. 7
is embraced in Homestead application No. 035061 of Louis M.
Richard, who claims preference right as a settler.

You are allowed thirty days from notice hereof in which to
withdraw your application

or to appeal from this decision to the Commissioner of the
General Land Office; and upon your failure to take such action
within the time specified, the case will be closed without fur-
ther notice to you from this office. If an appeal is taken here-
from it must be filed in this office.

Please return this letter, in case you take any action or
desire further information on the subject.

Respectfully,

Herbly D. Valenty, Register.

[Signature], Receiver.

February 10th, 1923

Department of Interior,
U. S. Land Office,
Los Angeles, California.

Gentlemen; In re Application No. 035860

Referring to the above application, I hereby
apply for withdrawal of same on the grounds that I
have already made application under this same act.

Yours very truly,

EF:ME

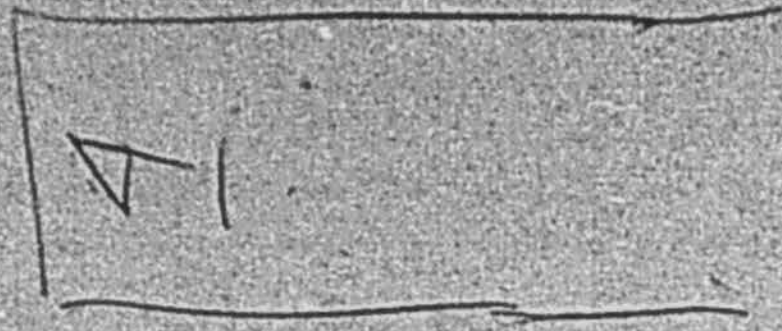

#279

Mr. King —

herewith return —

Dad says to figure out how he
can take it up under the stone
and timber set or some other
way

Ed —

DEPARTMENT OF THE INTERIOR.

HOMESTEAD ENTRY.

This Homestead application was refused & land later taken up by Harry Taylor under Street Timber Act

U.S. LAND OFFICE, SERIAL NO.

APPLICATION. RECEIPT NO.

I, William Earl Stevens (male), a resident of

San Diego County, California, do hereby apply

to enter, under Section 2289, Revised Statutes of the United States, the Southwest Quarter of the Southeast Quarter, Section 7; the Northwest

Quarter of the Northeast Quarter of Section Eighteen, all in

Township 13 South, Range 2 West, S.B.B. Meridian, containing

80 acres, within the Los Angeles land district;

and I do solemnly swear that I am not the proprietor of more than 160

acres of land in any State or Territory; that I am a native of

Ohio citizen of the United States, and

am the head of my family, married, 47 years of age

that my post-office address is Escondido, California;

that this application is honestly and in good faith made for the purpose of actual settlement and cultivation, and not for the benefit of any other person, persons, or corporation; that I will faithfully and honestly endeavor to comply with all the requirements of law as to settlement, residence, and cultivation necessary to acquire title to the land applied for; that I am not acting as agent of any person, corporation, or syndicate in making this entry, nor in collusion with any person, corporation, or syndicate to give them the benefit of the land entered, or any part thereof, or the timber thereon; that I do not apply to enter the same for the purpose of speculation, but in good faith to obtain a home for myself, and that I have not directly or indirectly made, and will not make, any agreement or contract, in any way or manner, with any person or persons, corporation or syndicate whatsoever, by which the title which I may acquire from the Government of the United States will inure in whole or in part to the benefit of any person except myself. I further swear that since August 30, 1890, I have not entered and acquired title to, nor am I now claiming, under an entry made under any of the nonmineral public-land laws, an amount of land which, together with the land now applied for, will exceed in the aggregate 320 acres; and that I have not heretofore made any entry under the homestead laws, or filed a soldier's or sailor's declaratory statement, except

(Here describe former homestead entry by section, township, range, land district, and number of entry; how perfected, or if not perfected state that fact.)

that I am well acquainted with the character of the land herein applied for and with each and every legal subdivision thereof, having personally examined same; that there is not to my knowledge within the limits thereof any vein or lode or quartz or other rock in place bearing gold, silver, cinnabar, lead, tin, or copper, nor any deposit of coal, placer, cement, gravel, salt spring, or deposit of salt, nor other valuable mineral deposit; that no portion of said land is claimed for mining purposes under the local customs or rules of miners, or otherwise; that no portion of said land is worked for mineral during any part of the year by any person or persons; that said land is essentially nonmineral land, and that my application therefor is not made for the purpose of fraudulently obtaining title to mineral land; that the land is not occupied and improved by any Indian.

William Earl Stevens

(Sign here, with full Christian name.)

I HEREBY CERTIFY that the foregoing affidavit was read to or by affiant in my presence before affiant affixed signature thereto; that affiant is to me personally known (or has been satisfactorily identified before me

by);
(Give full name and post-office address.)

that I verily believe affiant to be a qualified applicant and the identical person hereinbefore described; and that said affidavit was duly subscribed and sworn to before me, at my office, in San Diego (Town.)

San Diego, Calif. (County and State), within the Los Angeles

land district, this 26 day of September, 1922

J. B. Myers
County Clerk & Ex-Officio Elect. of the Superior Court
of the County of San Diego, State of California.
(Official designation of officer.)

UNITED STATES LAND OFFICE at

....., 19.....

I HEREBY CERTIFY that the foregoing application is for surveyed land of the class which the applicant is legally entitled to enter under Section 2289, Revised Statutes of the United States, that there is no prior valid adverse right to the same, and has this day been allowed.

Register.

UNITED STATES CRIMINAL CODE.—CHAP. 6.

Sec. 125. Whoever, having taken an oath before a competent tribunal, officer, or person, in any case in which a law of the United States authorizes an oath to be administered, that he will testify, declare, depose, or certify truly, or that any written testimony, declaration, deposition, or certificate by him subscribed, is true, shall willfully and contrary to such oath state or subscribe any material matter which he does not believe to be true, is guilty of perjury, and shall be fined not more than two thousand dollars and imprisoned not more than five years. (Act, March 4, 1909. 35 Stat., 1111.)

Ed Fletcher Papers

1870-1955

MSS.81

Box: 63 Folder: 11

Business Records - Land Companies - Volcan Land and Water Company - Stone and Timber Act Applications and Mining - Application #035860 for land near Lake Hodges



The Library
UC SAN DIEGO

Copyright: UC Regents

Use: This work is available from the UC San Diego Libraries. This digital copy of the work is intended to support research, teaching, and private study.

Constraints: This work is protected by the U.S. Copyright Law (Title 17, U.S.C.). Use of this work beyond that allowed by "fair use" requires written permission of the UC Regents. Permission may be obtained from the UC San Diego Libraries department having custody of the work (<http://libraries.ucsd.edu/collections/mscl/>). Responsibility for obtaining permissions and any use and distribution of this work rests exclusively with the user and not the UC San Diego Libraries.