

maps showing Stone & Timber Entries  
given to Miss May - July 11, 1924

Miss May has  
file concerning B. H. Taylor  
Winder & Stone entry at  
Pahukodges.

~~RECEIVED~~  
~~RECEIVED~~  
~~RECEIVED~~  
CITY OFFICE  
924 EIGHTH STREET, SAN DIEGO, CALIFORNIA

THOMAS H. KING, CHIEF ENGINEER  
924 EIGHTH STREET  
SAN DIEGO, CAL.

RECEIVED  
U. S. LAND OFFICE  
LOS ANGELES, CALIF.  
Date AUG 22 1922  
Hour \_\_\_\_\_

August 21st., 1922.

Department of Interior,  
U. S. Land Office,  
Los Angeles, California.

Gentlemen:-

Kindly send me application blanks under  
the Stone or Timber Act sufficient for 25 ap-  
plications.

Yours very truly,

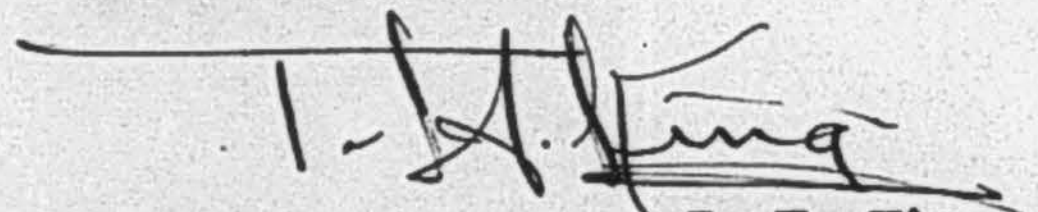
  
T. H. King.

THK/MG.

These blanks are supplied applicants only, and can not  
be furnished in quantities as requested by you.

#271

Applications under TIMBER OR STONE ACT  
must be filed in duplicate.

There is no segregation of the land  
until applications are filed and fees paid.

If thought desirable these authorizations  
may be filed with applications.

**SAN DIEGUITO IRRIGATION DISTRICT**

FIELD OFFICE  
ENCINITAS, SAN DIEGO COUNTY, CALIFORNIA

CITY OFFICE  
924 EIGHTH STREET, SAN DIEGO, CALIFORNIA

# 271

THOMAS H. KING, CHIEF ENGINEER  
924 EIGHTH STREET  
SAN DIEGO, CAL.

RECEIVED

AUG 26 1922

U. S. Land Office  
Los Angeles, Cal.

August 25, 1922

Department of Interior,  
U. S. Land Office,  
Los Angeles, California.

Gentlemen:

Inclosed herewith please find authorization to act as representative in all matters pertaining to their respective applications under the Stone and Timber Act of the following persons, together with the descriptions of the land desired by each.

~~Len B. Mathews,  
916 Eighth Street,  
San Diego, Calif.~~

The SW $\frac{1}{4}$  of SE $\frac{1}{4}$ , Sec. 31., T. 9 S., R. 1 W., S.B.B.M. 40

21 Irene Fait,  
R. 1, Box 126,  
National City, Calif.

NE $\frac{1}{4}$  of NW $\frac{1}{4}$ , Sec. 6, T. 10 S.,  
R. 1 W., S. B. B. M.

24 Catherine F. Taylor,  
3174 B Street,  
San Diego, Calif.

SE $\frac{1}{4}$  of NW $\frac{1}{4}$ , Sec. 31., T. 9 S.,  
R. 1 W., S.B.B.M.

23 Evelyn Z. M. Fait,  
R. 1, Box 126,  
National City, Calif.

Lot 3, Sec. 5, T. 10 S., R.  
1 W., S. B. B. M.

45 Cora Belle Fletcher,  
1453 Eighth Street,  
San Diego, Calif.

N.W $\frac{1}{4}$  of NE $\frac{1}{4}$ , Sec. 23., T.  
11 S., R. 2 E., S. B. B. M. 40

35 C. K. Fletcher,  
1453 Eighth Street,  
San Diego, Calif.

E $\frac{1}{2}$  of NW $\frac{1}{4}$ , Sec. 15, T. 11 S.,  
R. 2 E., S. B. B. M. 80

32 E. Fletcher Jr.  
810 Ash Street,  
San Diego, Calif.

The N $\frac{1}{2}$  of SW $\frac{1}{4}$ , SW $\frac{1}{4}$  of NW $\frac{1}{4}$ ,  
Sec. 24, T. 11 S., R. 2 E.,  
S. B. B. M.

25 Katherine L. May,  
3526 Park Blvd.,  
San Diego, Calif.

The S $\frac{1}{2}$  of the NE $\frac{1}{4}$ , the NE $\frac{1}{4}$   
of SE $\frac{1}{4}$  Section 15; Also the  
NW $\frac{1}{4}$  of SW $\frac{1}{4}$  of Sec. 14 all in  
T. 11 S., R. 2 E., S. B. B. M.

160

Will you be kind enough therefore to send me, at  
your early convenience, the necessary number of blank forms  
No. 4-522 for these applications.

I trust the rights of these applicants will be  
protected by this letter until such time as the regular  
forms can be filed with the Land Office.

Yours very truly,

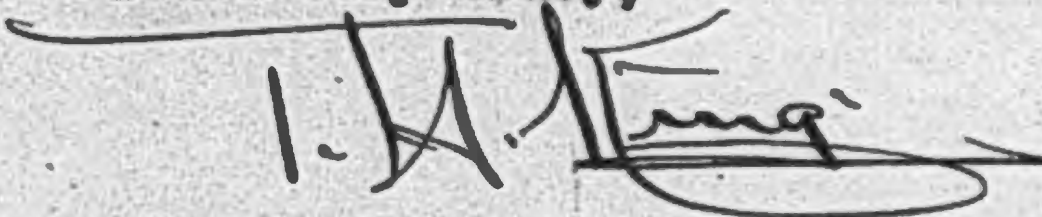

T. H. King.

THK:ME

Office - September 11, 1922

Colonel Fletcher,

Dear Sir:

Subject: Stone Entries

Attached hereto is a map showing the location of each of the various Stone Entries with the name of each applicant. It will be necessary for each applicant to view his or her property and make the statement whether or not the property is valuable for its stone or timber. I presume these will be valuable principally for stone, however, will you be kind enough to observe whether this is true or whether the timber is the valuable product. If timber, an estimate of the stumpage must be made.

I have left with Miss Edwards all of the affidavits. She can go with the applicants to the Court House and have them make affidavit that they have viewed the property. One thing is absolutely essential--these affidavits must be made before County Clerk McLees himself, personally. No deputy can take his place for this particular work.

Yours respectfully,

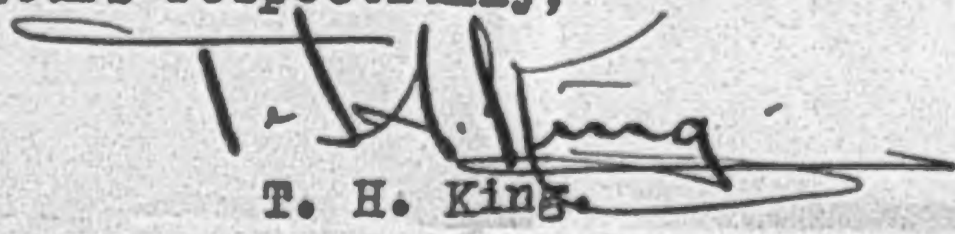

T. H. King

THK:ME

*Obsolete*

Lou B. Mathews

The SW $\frac{1}{4}$  of SE $\frac{1}{4}$ , Sec. 31, T. 9 S., R. 1 W., S.B.B.M.

Irene Fait

NE $\frac{1}{4}$  of NW $\frac{1}{4}$ , Sec. 6, T. 10 S., R. 1 W., S.B.B.M.

Catherine F. Taylor

SE $\frac{1}{4}$  of NW $\frac{1}{4}$ , Sec. 31, T. 9 S., R. 1 W., S.B.B.M.

Evelyn Z. M. Fait

Lot 3, Sec. 5, T. 10 S., R. 1 W., S.B.B.M.

Cora Belle Fletcher

NW $\frac{1}{4}$  of NE $\frac{1}{4}$ , Sec. 23, T. 11 S., R. 2 E., S.B.B.M.

C. K. Fletcher

E $\frac{1}{2}$  of NW $\frac{1}{4}$ , Sec. 15, T. 11 S., R. 2 E., S.B.B.M.

E. Fletcher Jr.

The N $\frac{1}{2}$  of SW $\frac{1}{4}$ , SW $\frac{1}{4}$  of NW $\frac{1}{4}$ , Sec. 24, T. 11 S., R. 2 E., S.B.B.M.

Katherine L. May

The S $\frac{1}{2}$  of the NE $\frac{1}{4}$ , the NE $\frac{1}{4}$  of SE $\frac{1}{4}$  Section 15; Also the NW $\frac{1}{4}$  of SW $\frac{1}{4}$  of Sec. 14 all in T. 11 S., R. 2 E., S.B.B.M.



DEPARTMENT OF THE INTERIOR  
UNITED STATES LAND OFFICE.  
Los Angeles, California.

Exparte

Cora Belle Fletcher.

Timber or Stone Application.

S $\frac{1}{2}$  of the NE $\frac{1}{4}$ , the NE $\frac{1}{4}$  of SE $\frac{1}{4}$ ,  
Sec. 15; Also the NW $\frac{1}{4}$  of SW $\frac{1}{4}$ ,  
Sec. 14, all in Township 11 S.,  
R. 2 E., S. B. B. E.

AUTHORIZATION AS REPRESENTATIVE.

I hereby appoint Thomas H. King, 924 Eighth Street,  
San Diego, California, as my representative to represent  
me in all matters pertaining to the above application be-  
fore the Department of Interior.

Cora Belle Fletcher

1453 Eighth Street,  
San Diego, California.

DEPARTMENT OF THE INTERIOR  
UNITED STATES LAND OFFICE.  
Los Angeles, California.

Exparte

J. L. Doyle

Timber or Stone Application.

The SE<sup>1</sup>/<sub>2</sub> of SE<sup>1</sup>/<sub>2</sub>, Sec. 24, T.  
11 S., R. 2 E., S. B. B. M.

AUTHORIZATION AS REPRESENTATIVE.

I hereby appoint Thomas H. King, 924 Eighth Street,  
San Diego, California, as my representative to represent  
me in all matters pertaining to the above application before  
the Department of Interior.

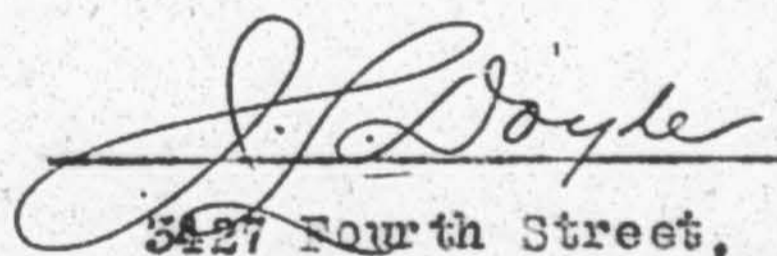
  
5427 Fourth Street,  
San Diego, California.

DEPARTMENT OF THE INTERIOR  
UNITED STATES LAND OFFICE  
Los Angeles, California.

Exparte

C. K. Fletcher.

Timber or Stone Application

NW $\frac{1}{2}$  of NE $\frac{1}{2}$ , Sec. 23, T. 11 S.,  
R. 2 E., S. B. B. M.

AUTHORIZATION AS REPRESENTATIVE.

I hereby appoint Thomas H. King, 924 Eighth Street,  
San Diego, California, as my representative to represent me  
in all matters pertaining to the above application before  
the Department of Interior.

C. K. Fletcher

1453 Eighth Street,  
San Diego, California.

DEPARTMENT OF THE INTERIOR  
UNITED STATES LAND OFFICE.  
Los Angeles, California.

Exparte

Catherine F. Taylor.

Timber or Stone Application.

Lot 3, Section 5, T. 10 S.,  
R. 1 W., S. B. B. M.

AUTHORIZATION AS REPRESENTATIVE.

I hereby appoint Thomas H. King, 924 Eighth Street,  
San Diego, California, as my representative to represent  
me in all matters pertaining to the above application be-  
fore the Department of Interior.

*Catherine F Taylor*

3174 B Street,  
San Diego, Calif.

DEPARTMENT OF THE INTERIOR  
UNITED STATES LAND OFFICE.  
Los Angeles, California.

Ex parte  
E. Fletcher Jr.

Timber or Stone Application.  
The NE 1/4 of SW 1/4, SW 1/4 of NW 1/4,  
Sec. 24, T. 11 S., R. 2E.,  
S. B. E. M.

80  
40  

---

120  
80  

---

200

AUTHORIZATION AS REPRESENTATIVE.

I hereby appoint Thomas H. King, 924 Eighth Street,  
San Diego, California, as my representative to represent  
me in all matters pertaining to the above application be-  
fore the Department of Interior.

E. Fletcher Jr.  
810 Ash Street,  
San Diego, Calif.

DEPARTMENT OF THE INTERIOR  
UNITED STATES LAND OFFICE  
Los Angeles, California.

Exparte

Timber or Stone Application.

Rebecca F. Doyle

The SE<sup>1</sup>/<sub>4</sub> of the SE<sup>1</sup>/<sub>4</sub> of Sec. 23,  
T. 11 S., R. 2 E., S. B. B. M.

AUTHORIZATION AS REPRESENTATIVE.

I hereby appoint Thomas H. King, 924 Eighth Street,  
San Diego, California, as my representative to represent  
me in all matters pertaining to the above application before  
the Department of Interior.

Rebecca F. Doyle  
3427 - 4/5/54

DEPARTMENT OF THE INTERIOR  
UNITED STATES LAND OFFICE.  
Los Angeles, California.

Exparte

Timber or Stone Application.

B. H. Taylor

The SE $\frac{1}{4}$  of NW $\frac{1}{4}$ , Sec. 51, T.  
9 S., R. 1 W., S. E. B. M.

AUTHORIZATION AS REPRESENTATIVE.

I hereby appoint Thomas H. King, 924 Eighth Street,  
San Diego, California, as my representative to represent  
me in all matters pertaining to the above application before  
the Department of Interior.

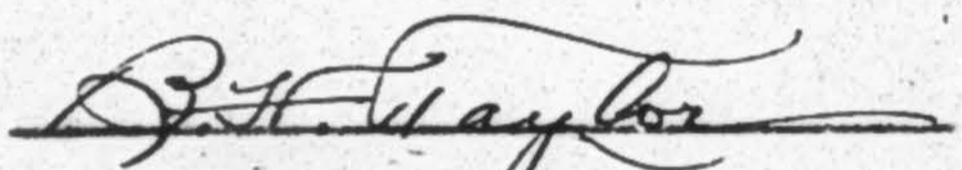

3174 B Street,  
San Diego, California.

DEPARTMENT OF THE INTERIOR.  
UNITED STATES LAND OFFICE.  
Los Angeles, California.

Exparte

Timber or Stone Application.

Irene Fait.

NE<sup>1</sup>/<sub>4</sub> of NW<sup>1</sup>/<sub>4</sub>, Sec. 6, T. 10 S.,  
R. 1 W., S. B. B. M.

AUTHORIZATION AS REPRESENTATIVE.

I hereby appoint Thomas H. King, 924 Eighth Street,  
San Diego, California, as my representative to represent  
me in all matters pertaining to the above application be-  
fore the Department of Interior.

Irene Fait

R. 1, Box 126,  
National City, Calif.



DEPARTMENT OF THE INTERIOR  
UNITED STATES LAND OFFICE.  
Los Angeles, California.

Exparte

Evalyn Z. M. Fait.

Timber or Stone Application.

The SW $\frac{1}{2}$  of SE $\frac{1}{2}$ , Sec. 31, T.  
9 S., R. 1 W., S. B. B. M.

AUTHORIZATION AS REPRESENTATIVE.

I hereby appoint Thomas H. King, 924 Eighth Street,  
San Diego, California, as my representative to represent  
me in all matters pertaining to the above application be-  
fore the Department of Interior.

*Evalyn Z. M. Fait*

R. 1, Box 126,  
National City, Calif.

DEPARTMENT OF THE INTERIOR  
UNITED STATES LAND OFFICE.  
Los Angeles, California.

Exparte  
K. L. May

Timber or Stone Application.

The E $\frac{1}{2}$  of NW $\frac{1}{4}$ , Sec. 15, T. 11  
S., R. 2 E., S. B. B. M.

AUTHORIZATION AS REPRESENTATIVE.

I hereby appoint Thomas H. King, 924 Eighth Street,  
San Diego, California, as my representative to represent  
me in all matters pertaining to the above application be-  
fore the Department of the Interior.

*K. L. May*

3526 Park Blvd.,  
San Diego, Calif.

DEPARTMENT OF THE INTERIOR  
UNITED STATES LAND OFFICE.  
Los Angeles, California.

Ex parte

Timber or Stone Application.

Mary C. B. Fletcher

SW $\frac{1}{4}$  of SW $\frac{1}{4}$  of Sec. 10, T. 11 S.,  
R. 2. E., S. B. M.

AUTHORIZATION AS REPRESENTATIVE.

I hereby appoint Thomas H. King, 924 Eighth Street,  
San Diego, California, as my representative to represent  
me in all matters pertaining to the above application be-  
fore the Department of Interior.

Mary C. B. Fletcher

810 Ash Street,  
San Diego, California.

R I V E R

R 4 W

R 3 W

R 2 W

R 1 W

BOUNDARY  
LINE

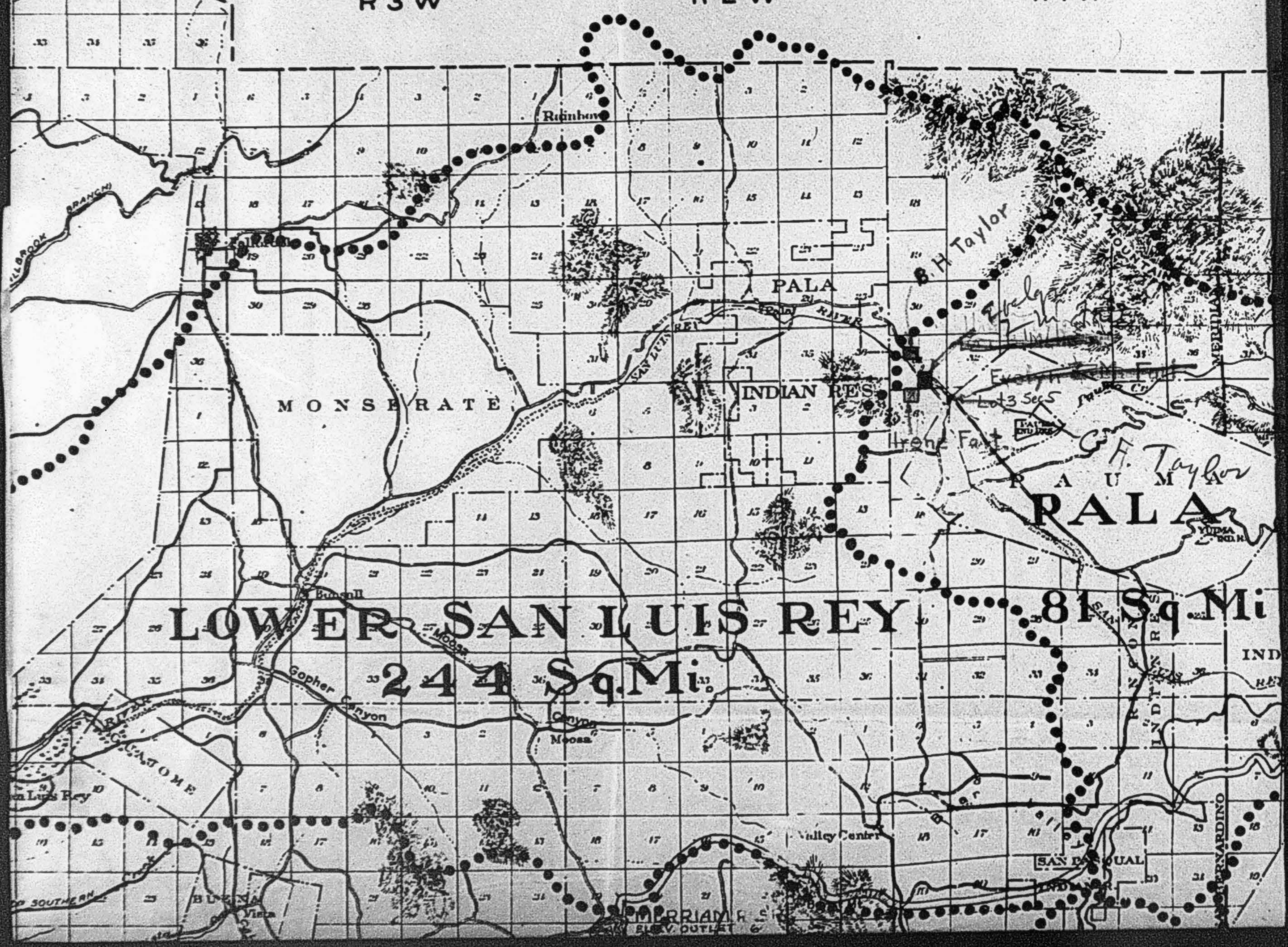

MONSERATE

INDIAN RES

LOWER SAN LUIS REY

244 Sq. Mi.

81 Sq. Mi.

PALA

Rainbow

B.H. Taylor

F. Taylor

Iron Falls

PALA

EL BROOK BRANCH

Gopher Canyon

Valley Center

Merriam

SAN BERNARDINO

SOUTHERN

BUENA VISTA

MERRIAM R. ELEV. OUTLET

SAN BERNARDINO

IND

REY

IND

REY

IND

REY

IND

REY

IND

REY

R I V E R S I D E C O

R 1 E

R 2 E

R 3 E

R 4 E

RIVERSIDE CO  
SAN DIEGO CO.

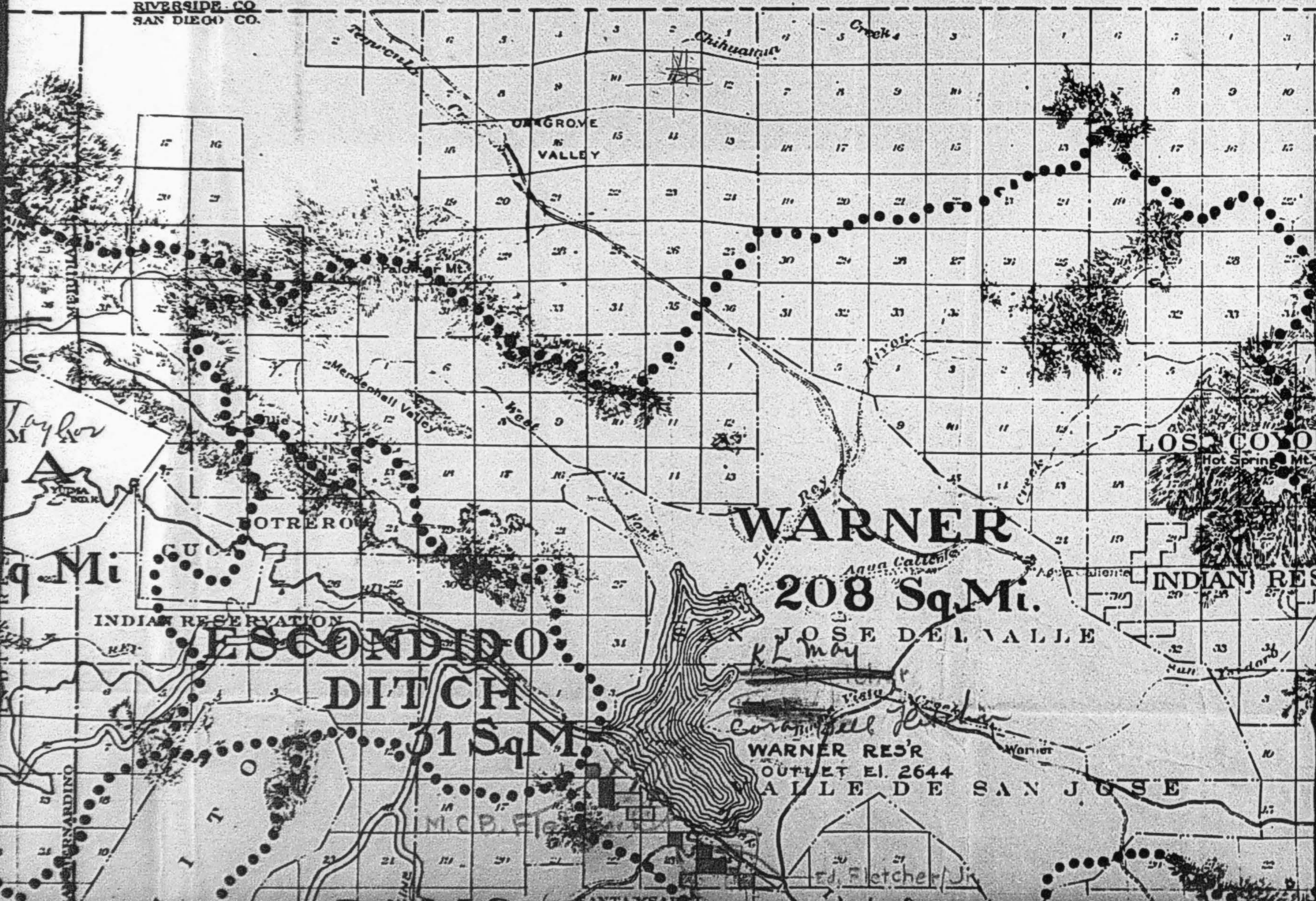

Taylor

q. Mi

BERNARDINO

ESCONDIDO  
DITCH  
31 Sq. Mi.

WARNER  
208 Sq. Mi.  
JOSE DEL VALLE

WARNER RES'R  
OUTLET EL. 2644  
VALLE DE SAN JOSE

LOS COYO

INDIAN RES

SANTA YEA

Ed. Fletcher Jr.

E C O U N T Y #271

R 2 E

R 3 E

R 4 E

R 5 E

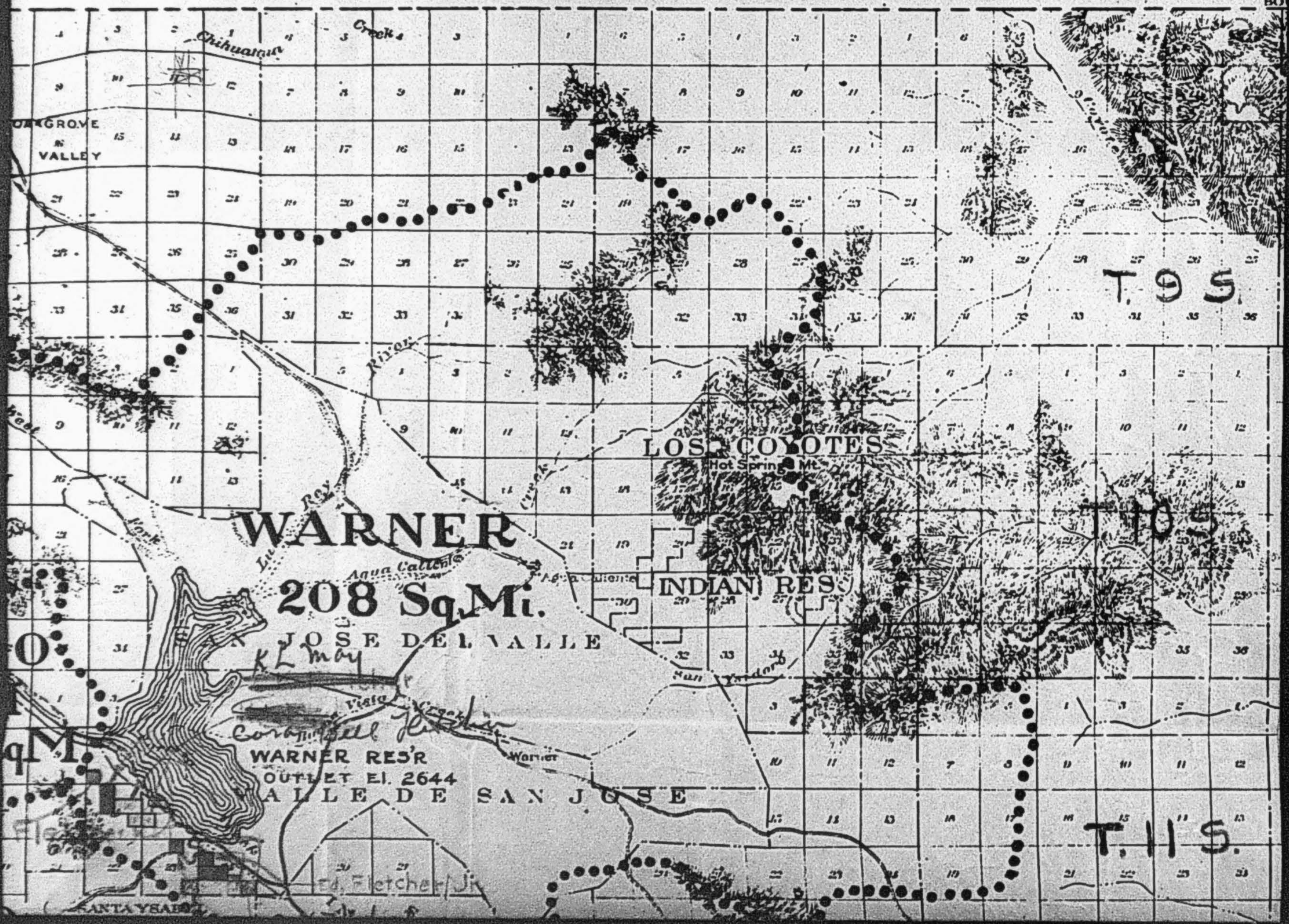

OAK GROVE VALLEY

Chihuahua Creek

Creek

LOS COYOTES

Hot Spring Mt.

WARNER

208 Sq. Mi.

JOSE DEL VALLE

INDIAN RES.

WARNER RESR

OUTLET EL. 2644

VALLE DE SAN JOSE

T. 9 S.

T. 11 S.

Ed. Fletcher/Jr.

SANTA YSABEL

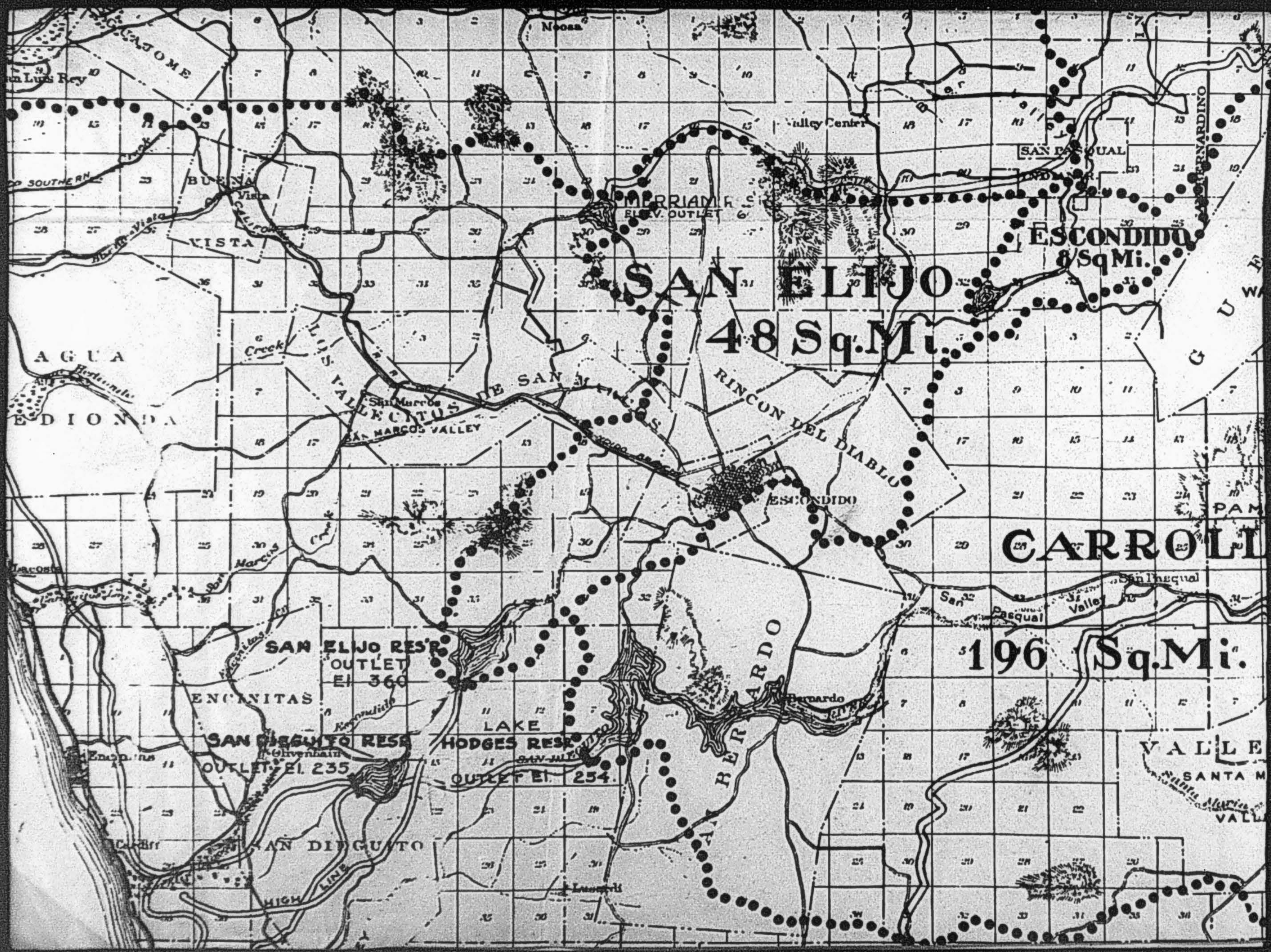

**SAN ELIJO**  
48 Sq. Mi.

**ESCONDIDO**  
8 Sq. Mi.

**CARROLL**

196 Sq. Mi.

AGUAJOME

SOUTHERN

AGUA

EDIONDA

TACOSTA

ENCINITAS

SAN DIEGO

HIGH LINE

NOOSA

Valley Center

MERRIAM  
ELEV. OUTLET

SAN PASQUAL

BERNARDINO

VISTA

Creek

SAN MARCOS VALLEY

SAN JUAN

RINCON DEL DIABLO

ESCONDIDO

SAN ELIJO RESERVOIR  
OUTLET  
Elev. 360

ENCINITAS

SAN DIEGO RESERVOIR  
OUTLET  
Elev. 235

LAKE HODGES RESERVOIR  
OUTLET  
Elev. 254

HERARDO

Bernardo

San Pasqual

San Pasqual Valley

VALLE

SANTA M

VALL

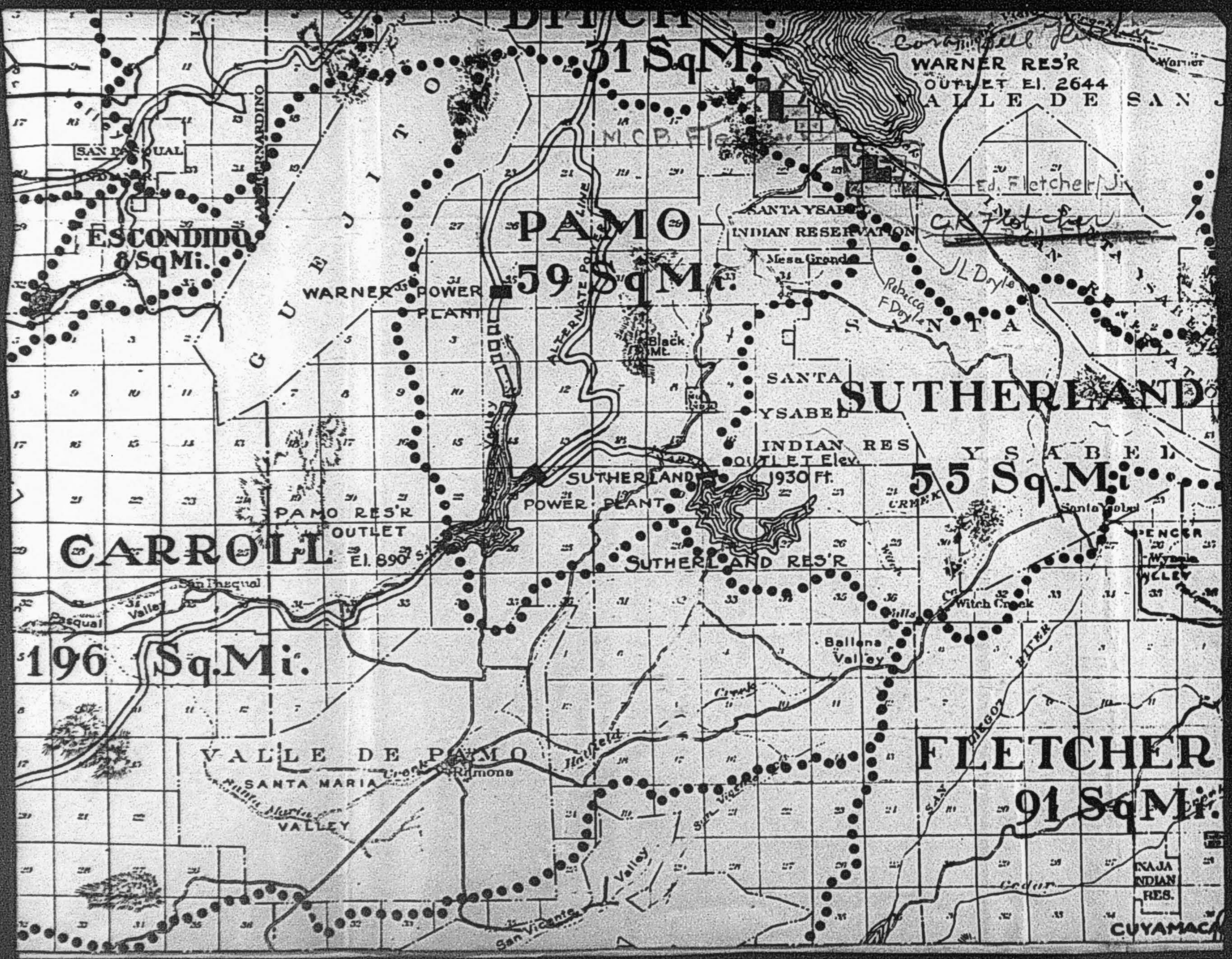

31 Sq. Mi.

WARNER RES'R  
OUTLET EL. 2644  
VALLE DE SAN J

ESCONDIDO  
8 Sq. Mi.

PAMO

SANTA YSABEL  
INDIAN RESERVATION

WARNER POWER PLANT  
59 Sq. Mi.

SUTHERLAND

SANTA YSABEL  
INDIAN RES  
OUTLET Elev.  
1930 FT.

55 Sq. Mi.

CARROLL  
PAMO RES'R  
OUTLET  
EL. 890

SUTHERLAND  
POWER PLANT

SUTHERLAND RES'R

196 Sq. Mi.

VALLE DE PAMO  
SANTA MARIA  
VALLEY

FLETCHER

91 Sq. Mi.

NAJA  
INDIAN  
RES.

CUYAMACA



WARNER RESR  
OUTLET EL. 2644

VALLE DE SAN JOSE

T. 11 S.

Ed. Fletcher Jr

*CR Plot*

JL Doyle

Rebecca  
F Doyle

SUTHERLAND

55 Sq. Mi.

T. 12 S.

FLETCHER DAM

91 Sq. Mi.

T. 13 S.

SANTA YSABEL  
INDIAN RESERVATION

Mesa Grande

SANTA  
YSABEL

INDIAN RES  
OUTLET ELEV.  
1930 FT.

LAND RESR

Ballena  
Valley

SPENCER  
WYBENA  
VALLEY

Julian

Banner

KAJA  
INDIAN  
RES.

CUYAMACA RESR

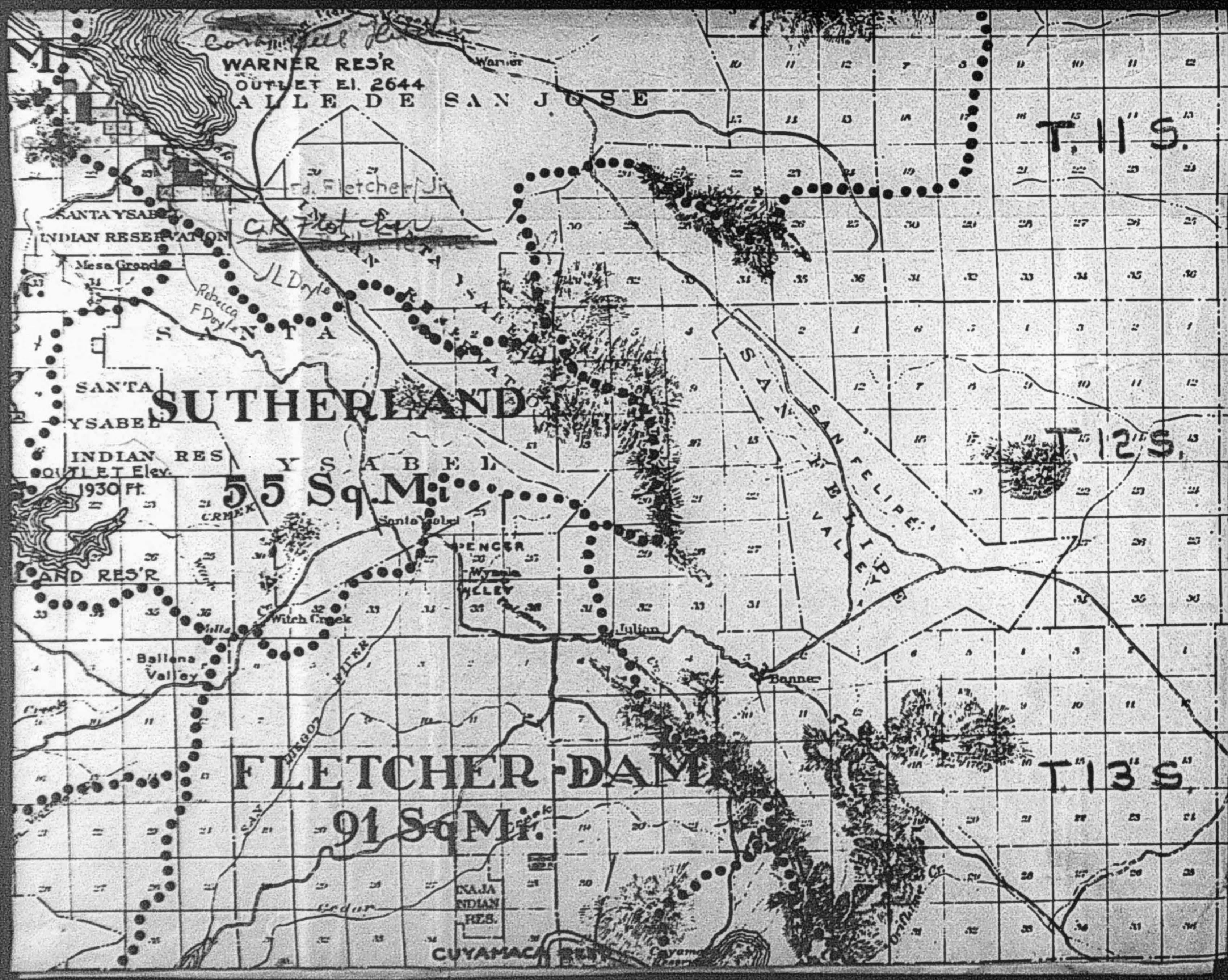

B.H.T.  
Evalyn Z.M. Fort

# R I V E R S

R 4 W

R 3 W

R 2 W

R 1 W

BOUNDARY  
LINE

RIVER  
SAN

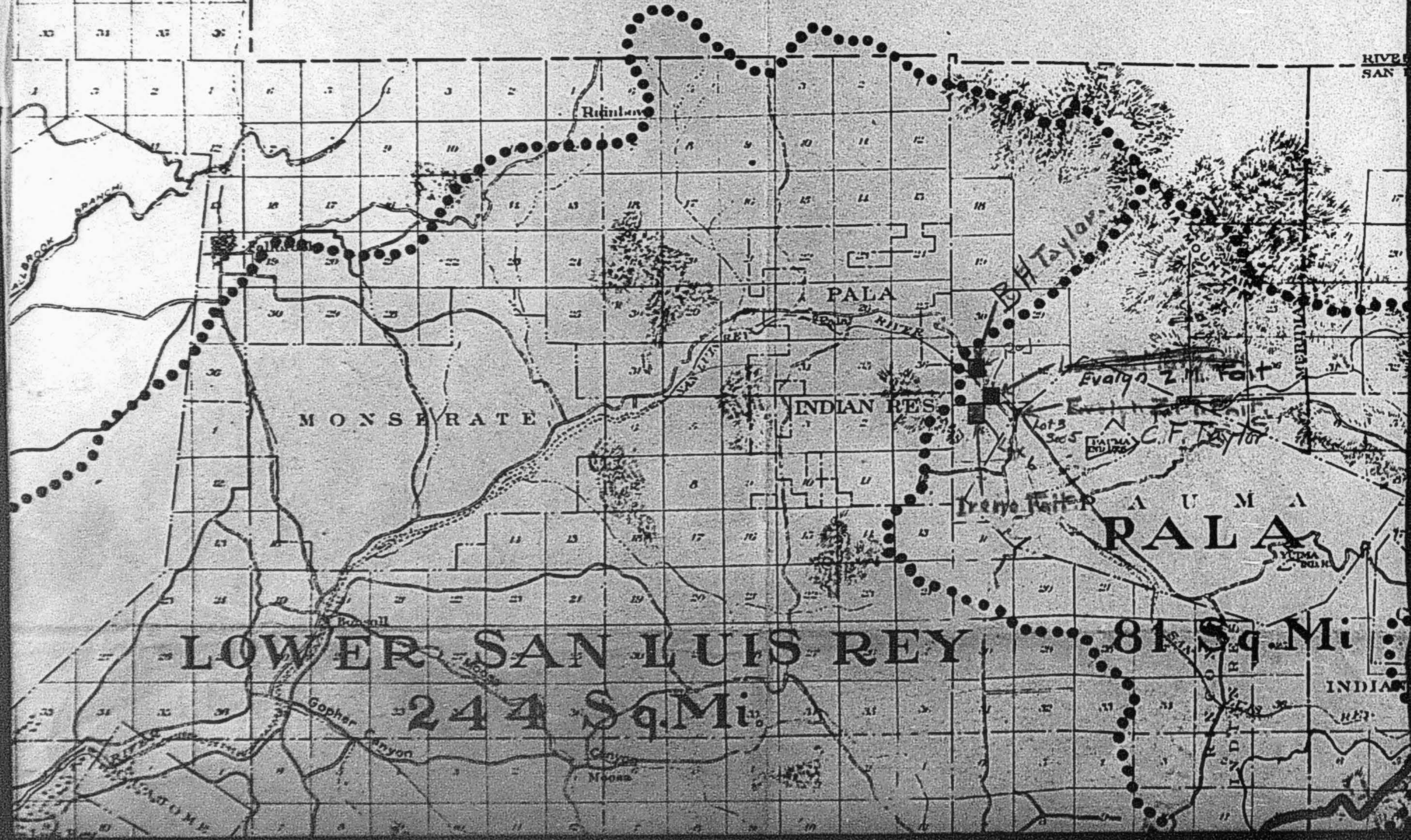

LOWER SAN LUIS REY

244 Sq. Mi.

81 Sq. Mi.

INDIAN

# RIVERSIDE

# C

W

R1E

R2E

R3E

RIVERSIDE CO.  
SAN DIEGO CO.



U M A  
ALA  
Sq. Mi.

LOS  
INDIA

WARNER

208 Sq. Mi.

JOSE DEL VALLE

R.L. May

Belle Fletcher

WARNER RESR

INDIAN RESERVATION

DITCH

1 Sq. Mi.

# E C O U N T Y

R 2 E

R 3 E

R 4 E

R 5 E

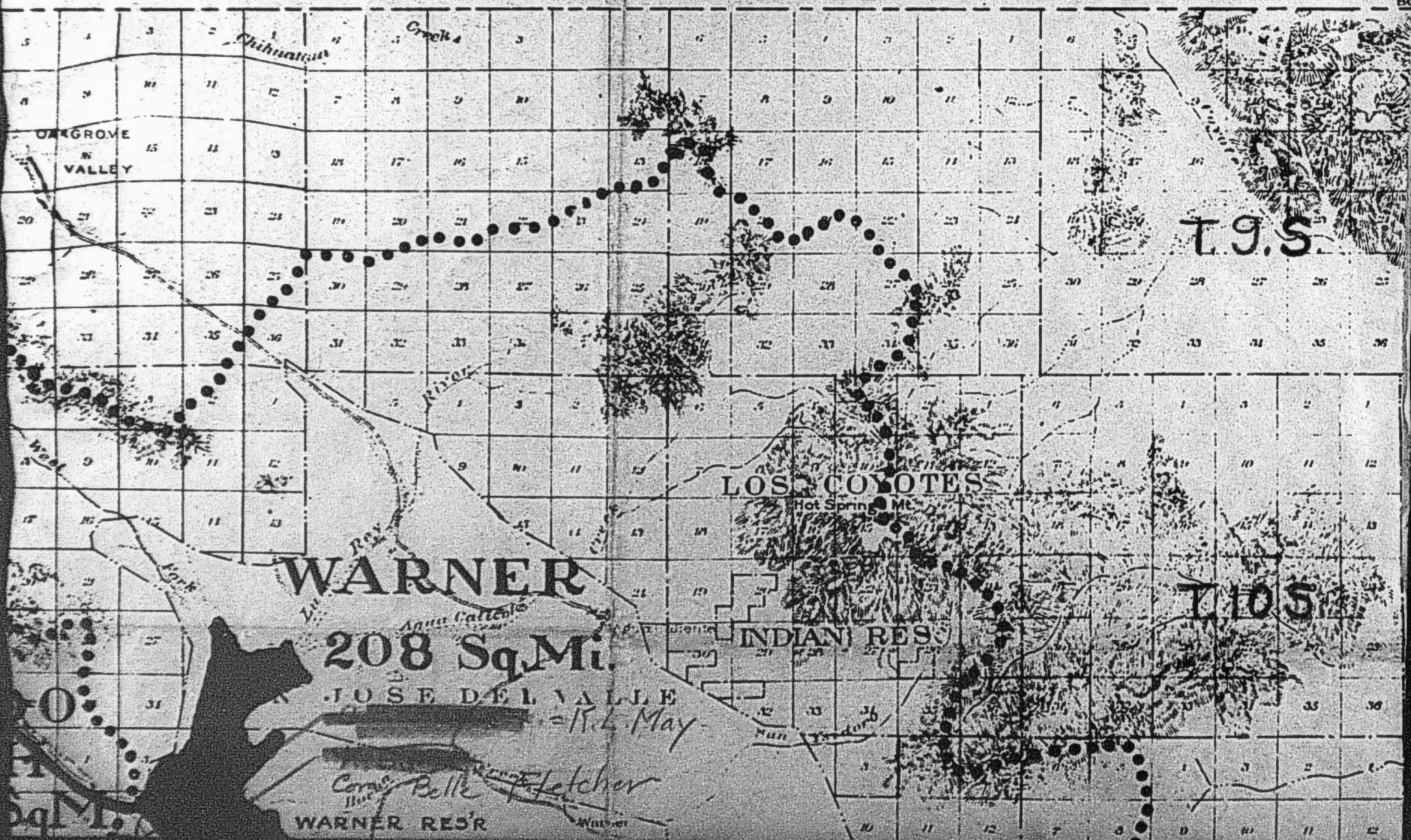

T 9 S

LOS COYOTES

Hot Springs Mt.

INDIAN RES

WARNER

208 Sq. Mi.

JOSE DEL VALLE

K.L. May

Cora Belle Fletcher

WARNER RESR

T 10 S

# LOWER SAN LUIS REY

244 Sq.Mi.

SAN ELIJO  
48 Sq.Mi.

ESCONDIDO  
8 Sq.Mi.

196 Sq.Mi.

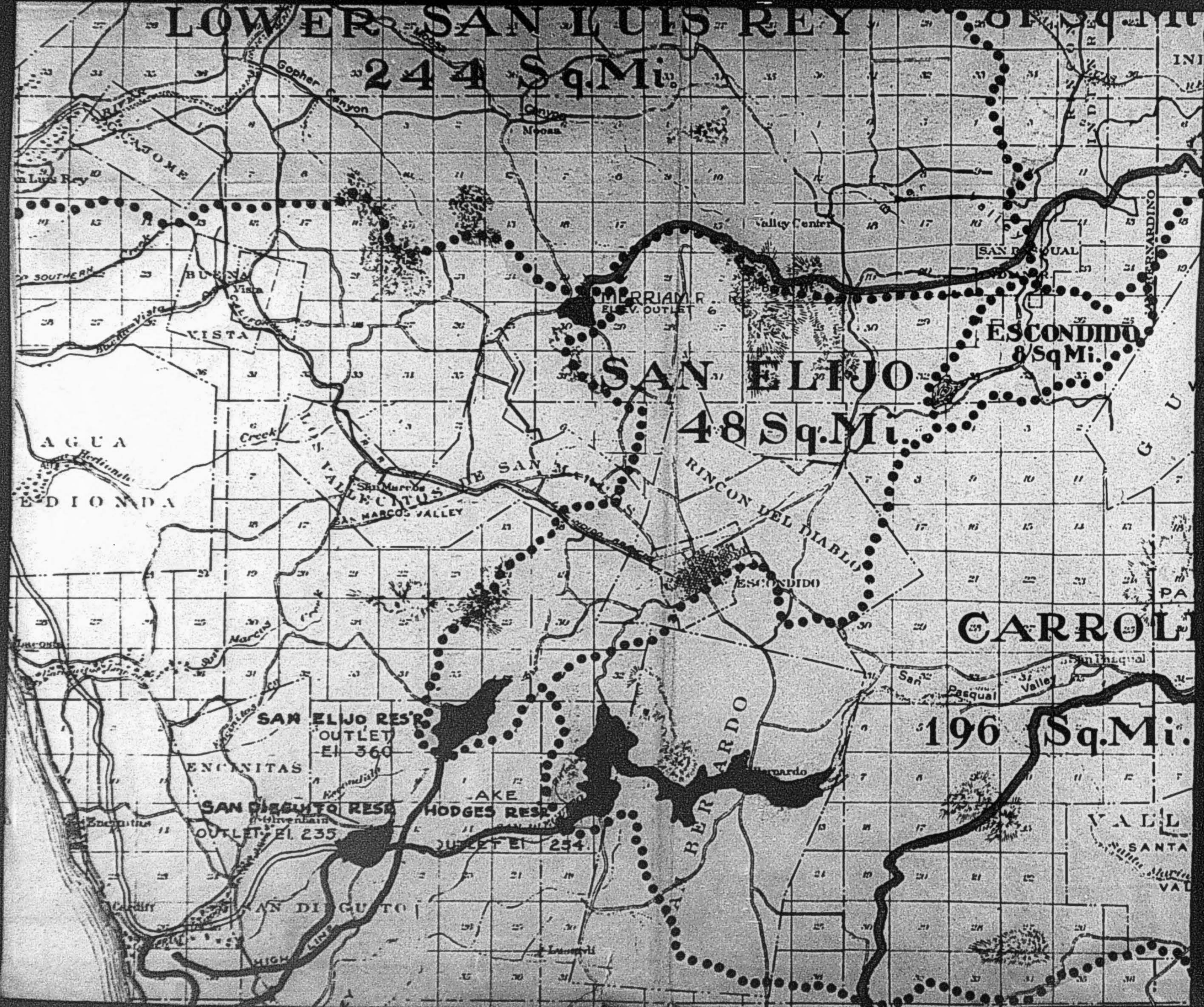

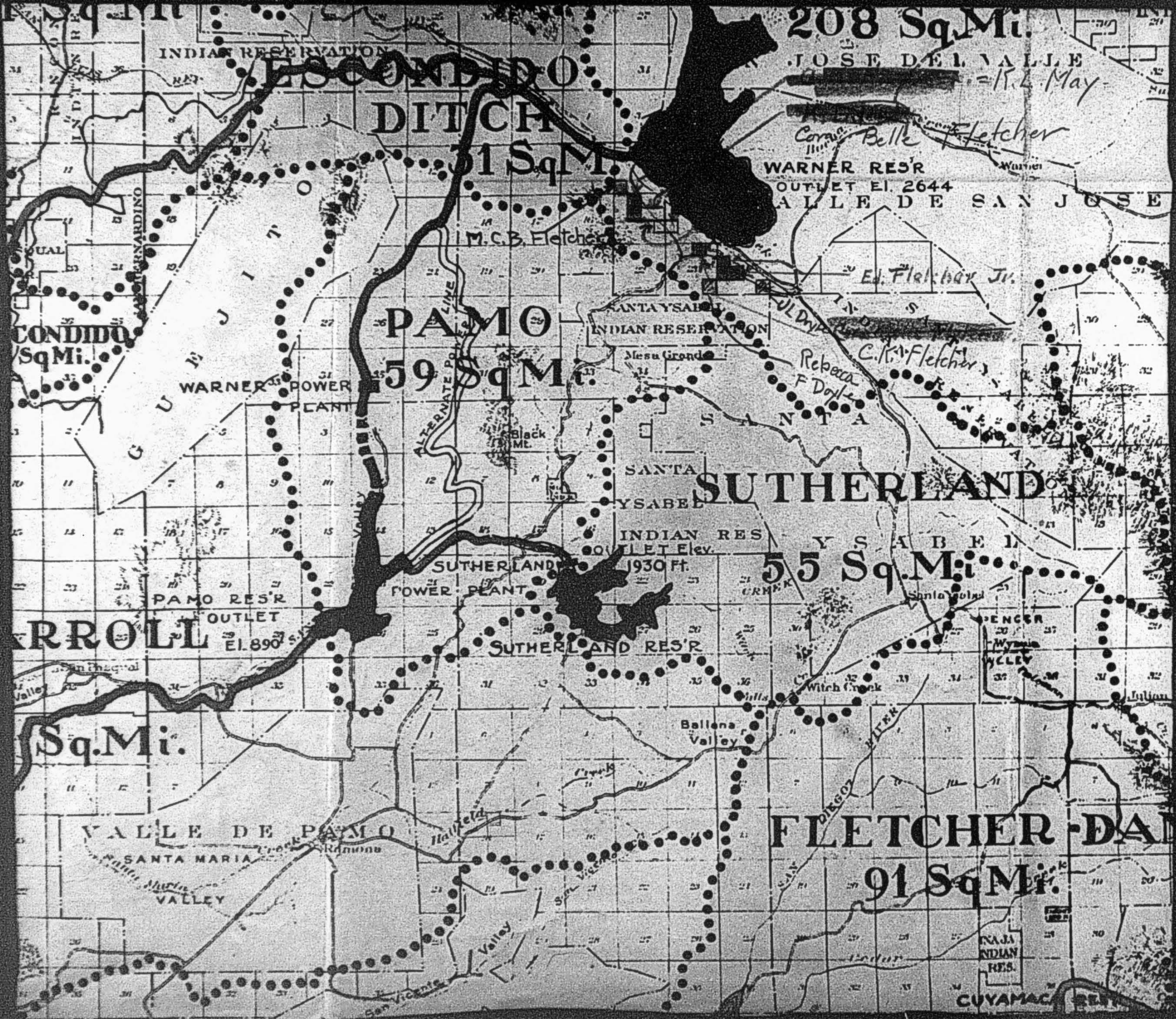

208 Sq. Mi.

JOSE DEL VALLE  
= R. L. May

*Corona Belle Fletcher*

WARNER RESR  
OUTLET El. 2644  
VALLE DE SAN JOSE

*Ed. Fletcher Jr.*

*C.K. Fletcher*

*Rebecca F. Doyle*

SUTHERLAND

55 Sq. Mi.

ESCONDIDO  
DITCH  
31 Sq. Mi.

PAMO  
159 Sq. Mi.

SUTHERLAND RESR

FLETCHER-DAL  
91 Sq. Mi.

CONDIDO  
Sq. Mi.

Sq. Mi.

VALLE DE PAMO  
SANTA MARIA  
VALLEY

INDIAN RESERVATION

SANTA YSABEL  
INDIAN RESERVATION

INDIAN RES  
Y S A B E L

WARNER POWER PLANT

POWER PLANT

PAMO RESR  
OUTLET  
El. 890

OUTLET Elev.  
1930 Ft.

PENCER  
VALLEY

Ballena  
Valley

Hallfield

Valley

INDIAN  
RES.

CUYAMAC RESR

ALTERNATE POWER LINE

DIEGO WATER

BERNARDINO

San Phagual

Valley

San Vicente

San Vicente

Black Mt.

Mesa Grande

Santa Ysabel

Witch Creek

Cedar

208 Sq. Mi.

JOSE DEL VALLE

15.4 May

Corona Belle Fletcher

WARNER RESR

OUTLET EI. 2644

VALLE DE SAN JOSE

T115

El. Fletcher Jr.

UL Dry

Rebecca C.K. Fletcher

F Doyle

SUTHERLAND

55 Sq. Mi.

T125

INDIAN RES

OUTLET Elev. 1930 Ft.

PENCER

WYNNE VALLEY

Julian

Witch Creek

Ballena Valley

FLETCHER DAM

91 Sq. Mi.

T135

INDIAN RES.

CUYAMAC RES.

DO  
H  
Sq. M.

B. Fletcher

O  
M

Black Mt.

LAND

SUTHERLAND RESR

5

20

25

30

35

30

25

20

15

10

5

0

1

2

3

4

5

6

7

8

9

10

11

12

STONE OR TIMBER APPLICATION

Sept. 18th, 1922

2/28/23  
271

STONE OR TIMBER APPLICATION

O.K.  
10/26/22

✓ Cora Belle Fletcher

SE $\frac{1}{2}$  of the NE $\frac{1}{4}$ , the NE $\frac{1}{4}$  of SE $\frac{1}{4}$ ,  
Sec. 15; Also the NW $\frac{1}{4}$  of SW $\frac{1}{4}$ ,  
Sec. 14, all in Township 11 S.,  
R. 2 E., S. B. B. M. ✓

✓ Jarvis Lothrop Doyle

The SE $\frac{1}{4}$  of SE $\frac{1}{4}$ , Sec. 24, T.  
11 S., R. 2 E., S. B. B. M. ✓

Charles Kimball Fletcher

NW $\frac{1}{4}$  of NE $\frac{1}{4}$ , Sec. 23, T. 11 S.,  
R. 2 E., S. B. B. M. ✓

✓ Catherine F. Taylor

Lot 3, Section 5, T. 10 S.,  
R. 1 W., S. B. B. M. ✓

✓ Ed Fletcher, Jr.

The E $\frac{1}{2}$  of SW $\frac{1}{4}$ , SW $\frac{1}{4}$  of NW $\frac{1}{4}$ ,  
Sec. 24, T. 11 S., R. 2 E.,  
S. B. B. M. ✓

Benjamin Harrison Taylor

The SE $\frac{1}{4}$  of NW $\frac{1}{4}$ , Sec. 31, T.  
9 S., R. 1 W., S. B. B. M. ✓

(Rejected acct.)  
(Letter "G")

✓ Irene Fait

NE $\frac{1}{4}$  of NW $\frac{1}{4}$ , Sec. 6, T. 10 S.,  
R. 1 W., S. B. B. M. ✓

✓ Rebecca Fletcher Doyle

The SE $\frac{1}{4}$  of the SE $\frac{1}{4}$  of Sec. 23,  
T. 11 S., R. 2 E., S. B. B. M. ✓

Evalyn Z. M. Fait

The SW $\frac{1}{4}$  of SE $\frac{1}{4}$ , Sec. 31, T.  
9 S., R. 1 W., S. B. B. M. ✓

(Rejected acct.)  
(Letter "G")

✓ Katherine Lee May

The E $\frac{1}{2}$  of NW $\frac{1}{4}$ , Sec. 15, T. 11  
S., R. 2 E., S. B. B. M. ✓

✓ Mary Catherine Batchelder Fletcher

SW $\frac{1}{4}$  of SW $\frac{1}{4}$  of Sec. 10,  
T. 11 S., R. 2 E., S. B. B. M. ✓

Cora Belle Fletcher

SE $\frac{1}{4}$  of the NE $\frac{1}{4}$ , the NE $\frac{1}{4}$  of SE $\frac{1}{4}$ ,  
Sec. 15; Also the NW $\frac{1}{4}$  of SW $\frac{1}{4}$ ,  
Sec. 14, all in Township 11 S.,  
R. 2 E., S. B. B. M. ✓

Jarvis Lothrop Doyle

The SE $\frac{1}{4}$  of SE $\frac{1}{4}$ , Sec. 24, T.  
11 S., R. 2 E., S. B. B. M. ✓

Charles Kimball Fletcher

NW $\frac{1}{4}$  of NE $\frac{1}{4}$ , Sec. 23, T. 11 S.,  
R. 2 E., S. B. B. M. ✓

Catherine F. Taylor

Lot 3, Section 5, T. 10 S.,  
R. 1 W., S. B. B. M. ✓

Ed Fletcher, Jr.

The E $\frac{1}{2}$  of SW $\frac{1}{4}$ , SW $\frac{1}{4}$  of NW $\frac{1}{4}$ ,  
Sec. 24, T. 11 S., R. 2 E.,  
S. B. B. M. ✓

Benjamin Harrison Taylor

The SE $\frac{1}{4}$  of NW $\frac{1}{4}$ , Sec. 31, T.  
9 S., R. 1 W., S. B. B. M. ✓

Rejected  
with Letter G

Irene Fait

{ NE $\frac{1}{4}$  NW $\frac{1}{4}$  =  
Lot 6 }

Called Lot 6 on Application  
NW $\frac{1}{4}$  of NW $\frac{1}{4}$ , Sec. 6, T. 10 S.,  
R. 1 W., S. B. B. M. ✓

Rebecca Fletcher Doyle

The SE $\frac{1}{4}$  of the SE $\frac{1}{4}$  of Sec. 23,  
T. 11 S., R. 2 E., S. B. B. M. ✓

Evalyn Z. M. Fait

The SW $\frac{1}{4}$  of SE $\frac{1}{4}$ , Sec. 31, T.  
9 S., R. 1 W., S. B. B. M. ✓

Rejected  
with Letter G

Katherine Lee May

The E $\frac{1}{2}$  of NW $\frac{1}{4}$ , Sec. 15, T. 11  
S., R. 2 E., S. B. B. M. ✓

2/28/23



Have no Application Blank

Mary Catherine Batchelder Fletcher

SW $\frac{1}{4}$  of SW $\frac{1}{4}$  of Sec. 10,  
T. 11 S., R. 2 E., S. 2. N.

September 18, 1922

Department of Interior,  
U. S. Land Office,  
Los Angeles, California.

Gentlemen:

Inclosed herewith you will please find the applications and sworn statement under the Stone and Timber Law, together with their respective authorizations for me to act as their representative, from the following persons.

- Cora Belle Fletcher
- J. L. Doyle
- C. K. Fletcher
- Catherine F. Taylor
- Ed Fletcher, Jr.
- B. H. Taylor
- Irene Fait
- Rebecca F. Doyle
- Evalyn Z. M. Fait
- K. L. May

Yours very truly,

T. H. King.

THK:ME

DEPARTMENT OF THE INTERIOR  
UNITED STATES LAND OFFICE

Los Angeles, California

(Place.)

Sept. 21, 1922.

(Date.)

Ed Fletcher, Jr.,  
810 Ash St.,  
San Diego, California.

NOTICE OF REJECTION  
or Suspension.

Sir:

In reference to your application to purchase Timber or  
Stone for the  
N $\frac{1}{2}$ SW $\frac{1}{2}$ , SW $\frac{1}{2}$ NW $\frac{1}{2}$ , Section 24,  
Township 11 S., Range 2 E., S.B. Meridian,  
you are advised that on Sept. 20, 1922, the Register and  
Receiver of this office Rejected the same for  
(Insert "Rejected" or "Suspended" as case may be.)  
the reason that (1) \$10.00 fee not paid

(We cannot recognize Mr. King as your agent for the reason  
he has never been admitted to practice before this office  
As an Agent or Attorney.)

You are allowed thirty days from notice hereof in which to  
make payment of the ten dollar fee.

or to appeal from this decision to the Commissioner of the  
General Land Office; and upon your failure to take such action  
within the time specified, the case will be closed without fur-  
ther notice to you from this office. If an appeal is taken here-  
from it must be filed in this office.

Please return this letter, in case you take any action or  
desire further information on the subject.

Respectfully,

*Lendley D. Valentine*, Register.

*[Signature]*, Receiver.

DEPARTMENT OF THE INTERIOR  
UNITED STATES LAND OFFICE

Los Angeles, California

(Place.)

Sept. 21, 1922.

(Date.)

*Charles Kimball Hitchcock*  
C. K. Fletcher,  
1453 Eighth St.,  
San Diego, California.

NOTICE OF REJECTION  
or Suspension.

Sir:

In reference to your application to ~~make~~<sup>purchase</sup> Timber or Stone  
for the  
NW $\frac{1}{2}$ NE $\frac{1}{2}$ , Section 23,  
Township 11 S., Range 2 E., S.B. Meridian,  
you are advised that on Sept. 20, 1922, the Register and  
Receiver of this office Rejected the same for  
(Insert "Rejected" or "Suspended" as case may be.)  
the reason that (1) \$10.00 fee not paid (2) Full Christian name  
not given; kindly file an affidavit reciting your full Christian  
name.

(We cannot recognize Mr. King as your agent for the reason  
he has never been admitted to practice before this office  
as an Attorney or Agent

You are allowed thirty days from notice hereof in which to  
complete your application

or to appeal from this decision to the Commissioner of the  
General Land Office; and upon your failure to take such action  
within the time specified, the case will be closed without fur-  
ther notice to you from this office. If an appeal is taken here-  
from it must be filed in this office.

Please return this letter, in case you take any action or  
desire further information on the subject.

Respectfully,

*Lendley D. Valentine*, Register.

*[Signature]*, Receiver.

# 271

STATE OF CALIFORNIA )  
County of San Diego ) ss

C. K. Fletcher

BEING FIRST DULY SWORN, deposes and says: That his full Christian name is Charles Kimball Fletcher.

AND FURTHER deponent saith not.

Subscribed and sworn to before me, this )  
26th day of September, 1922..... )

KA

4-868

035271 #271

OK

DEPARTMENT OF THE INTERIOR  
UNITED STATES LAND OFFICE

Los Angeles, California

(Place.)

Sept. 21, 1922.

(Date.)

J. L. Doyle,  
3427--4th Street,  
San Diego, California.

NOTICE OF REJECTION  
or Suspension.

Sir:

In reference to your application to purchase under the  
Timber or Stone Act for the  
SE<sup>1</sup>SE<sup>1</sup>, Section 24  
Township 11 S., Range 2 E., S.B. Meridian,  
you are advised that on Sept. 20, 1922, the Register and  
Receiver of this office Rejected the same for  
(Insert "Rejected" or "Suspended" as case may be.)  
the reason that (1) \$10.00 fee not paid (2) Full Christian name  
not given; kindly file an affidavit reciting your full Christian  
name, as required.

(We cannot recognize Mr. King as your agent for the reason  
he has never been admitted to practice before this office  
as an Attorney or Agent.)

You are allowed thirty days from notice hereof in which to  
complete your application

or to appeal from this decision to the Commissioner of the  
General Land Office; and upon your failure to take such action  
within the time specified, the case will be closed without fur-  
ther notice to you from this office. If an appeal is taken here-  
from it must be filed in this office.

Please return this letter, in case you take any action or  
desire further information on the subject.

Respectfully,

*W. L. King* Register.

*W. L. King* Receiver.

STATE OF CALIFORNIA )  
County of San Diego )ss

J. L. Doyle

BEING FIRST DULY SWORN, deposes and says: \_\_\_\_\_

My full Christian name is Jarvis Lothrop Doyle

AND FURTHER deponent saith not.

Subscribed and sworn to before me, this )  
26th day of September, 1922 . . . . . ) \_\_\_\_\_

\_\_\_\_\_  
\_\_\_\_\_

OK

DEPARTMENT OF THE INTERIOR  
UNITED STATES LAND OFFICE

Los Angeles, California  
(Place.)

Sept. 21, 1922.  
(Date.)

K. L. May,  
3526 Park Blvd.,  
San Diego, California.

NOTICE OF REJECTION  
or Suspension.

Sir:

In reference to your application to make timber or stone  
entry for the

E<sup>1</sup>/<sub>2</sub>NW<sup>1</sup>/<sub>4</sub>, Section 15,  
Township 11 S., Range 2 E., S.B. Meridian,

you are advised that on Sept. 20, 1922, the Register and  
Receiver of this office Rejected the same for  
(Insert "Rejected" or "Suspended" as case may be.)

the reason that (1) \$10 fee not paid (2) full Christian name  
not given (3) full data as to citizenship not shown. You should file  
an affidavit showing your full Christian name, and stating whether  
married or single and if married the citizenship of your husband.

(We cannot recognize Mr. King as your agent for the reason he has  
never been admitted to practice before this office as an Agent  
or Attorney.)

You are allowed thirty days from notice hereof in which to  
complete your application

or to appeal from this decision to the Commissioner of the  
General Land Office; and upon your failure to take such action  
within the time specified, the case will be closed without fur-  
ther notice to you from this office. If an appeal is taken here-  
from it must be filed in this office.

Please return this letter, in case you take any action or  
desire further information on the subject.

Respectfully,

*Jendley D. Valentini* Register.

*[Signature]* Receiver.

STATE OF CALIFORNIA )  
County of San Diego ) ss

K. L. May

BEING FIRST DULY SWORN, deposes and says: \_\_\_\_\_

My full Christian name is Katherine Leo May

I was born in St. Joseph, Missouri

I am a single person

AND FURTHER deponent saith not.

Subscribed and sworn to before me, this }  
26th day of September, 1922 \_\_\_\_\_

DEPARTMENT OF THE INTERIOR  
UNITED STATES LAND OFFICE

Los Angeles, California

Sept. 21, 1922

NOTICE OF REJECTION  
or Suspension.

Rebecca F. Doyle,  
3427--4th St.,  
San Diego, California.

Sir:

In reference to your application to make timber or stone  
entry \_\_\_\_\_ for the  
S.E. 1/4 \_\_\_\_\_, Section 23  
Township 11 S., Range 2 E., S.B. Meridian,  
you are advised that on Sept. 20, 1922, the Register and  
Receiver of this office Rejected the same for  
(Insert "Rejected" or "Suspended" as case may be.)  
the reason that (1) \$10 fee not paid (2) Full data as to citizen-  
ship not shown, you should file an affidavit showing whether you  
are married or single and if married the citizenship of your  
husband. Married - 1887 Boston Mass.

(We cannot recognize Mr. King as your agent for the reason  
he has never been admitted to practice before this office  
As an Agent or Attorney.)

You are allowed thirty days from notice hereof in which to  
Full name Rebecca Fletcher Doyle  
Husband Jarvis Poetrop Doyle - both born in Massachusetts

or to appeal from this decision to the Commissioner of the  
General Land Office; and upon your failure to take such action  
within the time specified, the case will be closed without fur-  
ther notice to you from this office. If an appeal is taken here-  
from it must be filed in this office.

Please return this letter, in case you take any action or  
desire further information on the subject.

Respectfully,

Leander J. Valentine Register.

[Signature] Receiver.

STATE OF CALIFORNIA )  
COUNTY OF SAN DIEGO ) ss

REBECCA F. DOYLE

BEING FIRST DULY SWORN, deposes and says: That her full Christian name is Rebecca Fletcher Doyle; that she is a citizen of the United States, having been born in Massachusetts; that she is a married woman. Her husband's name is Jarvis Lothrop Doyle a citizen of the United States, having been born in Massachusetts.

AND FURTHER deponent saith not.

Subscribed and sworn to before me, this )  
26th day of September 1922 . . . . . )

DEPARTMENT OF THE INTERIOR  
UNITED STATES LAND OFFICE

Los Angeles, California

Sept. 21, 1922.  
(Date.)

Catherine F. Taylor,  
3174 "B" Street,  
San Diego, California.

NOTICE OF REJECTION  
or Suspension.

Sir:

In reference to your application to purchase under the Timber or Stone Act for the Lot 3, Section 5, Township 10 S., Range 1 W., S.B. Meridian, you are advised that on Sept. 20, 1922, the Register and

Receiver of this office Rejected the same for

(Insert "Rejected" or "Suspended" as case may be.)  
the reason that (1) \$10.00 fee not paid (2) Full data as to citizenship is now shown. You should file an affidavit showing whether you are married or single and if married the citizenship of your husband.

(We cannot recognize Thomas H. King as your agent for the reason he has never been admitted to practice before this office as an Attorney or Agent.)

You are allowed thirty days from notice hereof in which to complete your application

to appeal from this decision to the Commissioner of the General Land Office; and upon your failure to take such action within the time specified, the case will be closed without further notice to you from this office. If an appeal is taken herefrom it must be filed in this office.

Please return this letter, in case you take any action or desire further information on the subject.

Respectfully,

*Stanley J. Alentis*, Register.

*[Signature]*, Receiver.

#271

STATE OF CALIFORNIA )  
COUNTY OF SAN DIEGO ) ss

CATHERINE F. TAYLOR

BEING FIRST DULY SWORN, deposes and says: that she is a citizen of the United States; having been born in the state of California. She is married to Benjamin Harrison Taylor who is also a citizen of the United states having been born in the state of Indiana.

AND FURTHER deponent saith not.

Subscribed and sworn to before me, this )  
26th day of September, 1922 ..... ) \_\_\_\_\_

KA

4-868

035266 #271

DEPARTMENT OF THE INTERIOR  
UNITED STATES LAND OFFICE

Los Angeles, California  
(Place.)  
Sept. 21, 1922.  
(Date.)

Cora Belle Fletcher,  
1453--8th Street,  
San Diego, California

NOTICE OF REJECTION  
or Suspension.

Sir:

In reference to your application to make timber or stone entry for the S $\frac{1}{2}$ NE $\frac{1}{4}$ , NE $\frac{1}{4}$ SE $\frac{1}{4}$ , Sec. 15, NW $\frac{1}{4}$ SW $\frac{1}{4}$ , Section 14, Township 11 S., Range 2 E., S.B. Meridian, you are advised that on Sept. 20, 1922, the Register and Receiver of this office Rejected the same for the reason that (1) \$10 fee not paid (2) Full data as to citizenship not shown, you should file an affidavit showing whether you are married or single and if married the citizenship of your husband.

(We cannot recognize Mr. King as your agent for the reason he has never been admitted to practice before this office as an Agent or Attorney.)

You are allowed thirty days from notice hereof in which to complete your application

or to appeal from this decision to the Commissioner of the General Land Office; and upon your failure to take such action within the time specified, the case will be closed without further notice to you from this office. If an appeal is taken herefrom it must be filed in this office.

Please return this letter, in case you take any action or desire further information on the subject.

Respectfully,

*Herdey O. Valentini* Register.  
*[Signature]* Receiver.

STATE OF CALIFORNIA )  
COUNTY OF SAN DIEGO ) ss

CORA BELLE FLETCHER

BEING FIRST DULY SWORN, deposes and says: That she is  
a citizen of the United States, having been born in  
the state of Massachusetts; that she is a single person.

AND FURTHER deponent saith not.

Subscribed and sworn to before me, this )  
26th day of September, 1922 ..... ) \_\_\_\_\_

\_\_\_\_\_

\_\_\_\_\_

KA

4-262

035262 ✓ #271

DEPARTMENT OF THE INTERIOR  
UNITED STATES LAND OFFICE

Los Angeles, California

(Place.)

Sept. 21, 1922.

(Date.)

B. H. Taylor,  
3174 "B" St.,  
San Diego, California.

NOTICE OF REJECTION  
or Suspension.

Sir:

In reference to your application to make timber or stone  
entry ..... for the  
SE 1/4 NW 1/4, ..... Section 31,  
Township 9 S., Range 1 W., ..... S.B. Meridian,  
you are advised that on Sept. 20, 1922, the Register and  
Receiver of this office Rejected the same for  
(Insert "Rejected" or "Suspended" as case may be.)  
the reason that (1) full Christian name not given (2) \$10 fee not  
paid (3) Land was withdrawn by letter "G" of May 6, 1903 for the  
Mission Indians.

(We cannot recognize Mr. King as your agent for the reason  
that he has not been admitted to practice before this office  
as an Agent or Attorney.)

You are allowed thirty days from notice hereof in which to  
withdraw your application, or to complete it by payment of the  
\$10 fee and filing an affidavit showing your full name, and

~~xxx~~ to appeal from this decision to the Commissioner of the  
General Land Office; and upon your failure to take such action  
within the time specified, the case will be closed without fur-  
ther notice to you from this office. If an appeal is taken here-  
from it must be filed in this office.

Please return this letter, in case you take any action or  
desire further information on the subject.

Respectfully,

Landley S. Valentines Register.

[Signature], Receiver.



STATE OF CALIFORNIA )  
County of San Diego ) ss

B. H. Taylor

BEING FIRST DULY SWORN, deposes and says: That his full  
Christian name is Benjamin Harrison Taylor.

AND FURTHER deponent saith not.

Subscribed and sworn to before me, this )

26th day of September, 1922 . . . . . )

KA

4-863

035263

#271

DEPARTMENT OF THE INTERIOR

UNITED STATES LAND OFFICE

Los Angeles, California

(Place.)

Sept. 21, 1922.

(Date.)

Evalyn Z. M. Fait,  
Box 126, Route #1,  
National City, California.

NOTICE OF REJECTION  
or Suspension.

Sir:

In reference to your application to make timber or stone  
entry for the  
SW $\frac{1}{2}$ SE $\frac{1}{4}$ , Section 31,  
Township 9 S., Range 1 W., S.B. Meridian,  
you are advised that on Sept. 20, 1922, the Register and  
Receiver of this office Rejected the same for  
(Insert "Rejected" or "Suspended" as case may be.)  
the reason that (1) land was withdrawn by letter "G" of May 6, 1903  
for the Mission Indians (2) also applied for by Charles Hile, on  
Sept. 19, 1922, as T & S 033258, which was rejected (3) the \$10  
fee not paid (4) Full data as to citizenship not shown, you should  
show whether married or single and if married the citizenship of  
your husband.

(We cannot recognize Mr. King as your agent for the reason that  
he has not been admitted to practice before this office as an  
Agent or Attorney.)

You are allowed thirty days from notice hereof in which to  
withdraw your application, or to complete it and

~~you~~ to appeal from this decision to the Commissioner of the  
General Land Office; and upon your failure to take such action  
within the time specified, the case will be closed without fur-  
ther notice to you from this office. If an appeal is taken here-  
from it must be filed in this office.

Please return this letter, in case you take any action or  
desire further information on the subject.

Respectfully,

*Leudley J. Valentine* Register.

Receiver.

STATE OF CALIFORNIA )  
County of San Diego ) ss

Evalyn Z. M. Fait

BEING FIRST DULY SWORN, deposes and says: That she is a  
citizen of the United States, having been born in the  
State of North Dakota; that she is a single person.

AND FURTHER deponent saith not.

Subscribed and sworn to before me, this )  
26th day of September, 1922 . . . . . )

KA

4-869

035264

# 271

DEPARTMENT OF THE INTERIOR  
UNITED STATES LAND OFFICE

Los Angeles, California

Sept. 21, 1922.

Irene Fait,  
Box 126, Route #1,  
National City, California.

NOTICE OF REJECTION  
or Suspension.

Sir:

In reference to your application to purchase under the  
Timber or Stone Act for the  
Lot 6, Section 6,  
Township 10 S., Range 1 W., S.B. Meridian,  
you are advised that on Sept. 20, 1922, the Register and  
Receiver of this office Rejected the same for  
(Insert "Rejected" or "Suspended" as case may be.)  
the reason that (1) \$10.00 fee not paid (2) Full data as to  
citizenship not shown. You should file an affidavit showing  
whether you are married or single and if married the citizenship  
of your husband must be shown. (We cannot recognize Thomas H. King  
as your agent for the reason he has never been admitted to prac-  
tice before this office as an Attorney or Agent.)

You are allowed thirty days from notice hereof in which to  
complete your application

or to appeal from this decision to the Commissioner of the  
General Land Office; and upon your failure to take such action  
within the time specified, the case will be closed without fur-  
ther notice to you from this office. If an appeal is taken here-  
from it must be filed in this office.

Please return this letter, in case you take any action or  
desire further information on the subject.

Respectfully,

*Leudley N. Valentin* Register.

*[Signature]* Receiver.

STATE OF CALIFORNIA )  
County of San Diego ) ss

IRENE FAIT

BEING FIRST DULY SWORN, deposes and says:

That she is a single person.

That she is a citizen of the United States,  
having been born in the state of Washington.

AND FURTHER deponent saith not.

Subscribed and sworn to before me, this )  
26th day of September, 1922 )

#271

Jan. 15, 1923

Department of the Interior,  
U. S. Land Office,  
Los Angeles, California.

Gentlemen:

Will you be kind enough to send me, at  
your early convenience, several application forms for  
entry under the Timber and Stone Act.

Yours very truly,

T. H. King.

THK:ME

April 16, 1923.

Mr. C. C. Crouch,  
Spreckels Bldg.,  
City.

My dear Crouch:

Enclosed herewith find form of Stone and Timber Entry on which we filed on some land around Henshaw Lake, also copy of Notice of Rejection, which each person who made application has received. I want to appeal from this decision, and want you to prepare the necessary papers. There are nine cases to appeal, and we will be glad to furnish the legal descriptions, etc. as soon as you are ready for them. You will notice that our time limit seems to be up on April 30th.

Yours truly,

KLM

CHARLES C. CROUCH

HUGH A. SANDERS

CROUCH & SANDERS  
ATTORNEYS  
SPRECKELS BUILDING  
SAN DIEGO, CALIFORNIA  
PHONE 66446

April 21, 1923

Colonel Ed Fletcher,  
Fletcher Bldg.,  
City

TIMBER AND STONE APPLICATION.

My dear Colonel:

I am in receipt of yours of the 16th inclosing notice of rejection of timber or stone application 035289 of Mary C. B. Fletcher in which you request me to prepare papers for the appeal to the Commissioner of the General Land Office.

Please at once furnish me with the names of all of the nine applicants, together with the number of their applications, and the description of the property filed upon. This would all appear in their various notices of rejection, which I request you to procure from each of them and mail to me without delay.

Very truly yours,

*Charles C. Crouch*

COC:W

Recd under 4-24-23  
Crouch

April 23, 1923.

Mr. C. C. Crouch,  
Spreckels Bldg.,  
San Diego, Calif.

My dear Crouch:

Answering yours of April 21st, following is the list of names, descriptions and numbers of Applications on the properties which I wish to appeal on.

✓ Cora Belle Fletcher, 1453 - 8th St., San Diego, Calif.  
No. 035266 Dated 4-2-23  
S $\frac{1}{2}$  of NE $\frac{1}{2}$ , NE $\frac{1}{2}$  SE $\frac{1}{2}$  Sec. 15, NW $\frac{1}{2}$  SW $\frac{1}{2}$   
Section 14, Township 11 S., Range 2 East, SBM } 120 Ac.

✓ J. L. Doyle, 2427 - 4th St.,  
No. 035271 Dated March 31, 1923  
SE $\frac{1}{2}$  SE $\frac{1}{2}$  Section 24, Twp. 11 S., Range 2 E, S.B.M. } 40 Ac

✓ C. K. Fletcher, 1453 - 8th St.  
No. 035270 Dated April 2, 1923  
NW $\frac{1}{2}$  NE $\frac{1}{2}$ , Section 23, Twp. 11 S., Range 2 East } 40 Ac  
S.B.M.

✓ Catherine F. Taylor, 3174 B St  
No. 035265 Dated April 2, 1923  
Lot No. 3, Section 5, Twp. 10 S., Range 1 West, S. B. M. } 3.48 Ac

✓ Ed Fletcher, Jr., 810 Ash St.  
No. 035269 Dated March 31, 1923  
E $\frac{1}{2}$  SW $\frac{1}{2}$ , SW $\frac{1}{2}$  NW $\frac{1}{2}$ , Section 24, Twp. 11 S., Range 2 E., S.B.M. } 120 Ac

✓ Irene M. Vait, R #1, Box 126, National City, Cal  
No. 035264 Dated April 2, 1923  
NE $\frac{1}{2}$  NW $\frac{1}{2}$ , Section 6, Twp. 10 S., Range 1 West, S.B.M. } 39.81

✓ Rebecca F. Doyle, 2427 - 4th St.,  
No. 035268 Dated April 21, 1923  
SE $\frac{1}{2}$  SE $\frac{1}{2}$ , Section 23, Twp. 11 S., R. 2 East SBM } 40

✓ K. L. May, 3526 Park Blvd.,  
No. 035267 Mar. 30, 1923  
E $\frac{1}{2}$ NW $\frac{1}{4}$ , Section 15, Twp. 11 S., Range  
2 East, S.B.M.

} 802

✓ Mrs. Mary C. B. Fletcher, 810 Ash St.  
No. 035289 March 30, 1923  
SW $\frac{1}{4}$ SW $\frac{1}{4}$  Section 10, Twp. 11 S., Range 2 E., S.B.M.

402

We are also enclosing herewith the notices of rejection for the above mentioned applications as these will have to be returned with any appeal made from the decision.

If it is necessary to make copies of these will you kindly advise when returning the papers for our signatures, so we may make copies before send the papers on.

Yours truly,

KLM

035266  
Department of the Interior,  
UNITED STATES LAND OFFICE,

Los Angeles, Cal.

POSTMASTER: Return after 30 days,  
if unclaimed (P. L. and R. Sec. 670)



No. 271

Return receipt requested

Cora Belle Fletcher,

1453, 8th St.,

San Diego, Cal.

Deliver only to addressee or  
agent authorized in writing.

REGISTERED NO. ~~114099~~ 114099

035271  
Department of the Interior,  
UNITED STATES LAND OFFICE,

Los Angeles, Cal.

POSTMASTER: Return after 30 days,  
if unclaimed (P. L. and R. Sec. 670)

Return receipt requested

J. H. Doyle,  
3427 4th St.,  
San Diego, Calif.

Deliver only to addressee or  
agent authorized in writing.

REGISTERED NO. ~~114094~~ 114094

*Notice 4/18/23*



#271

*4/9  
Give notice 1/8*

035270  
Department of the Interior,  
UNITED STATES LAND OFFICE,  
Los Angeles, Cal.

POSTMASTER: Return after 30 days,  
if unclaimed (P. L. and R. Sec. 670)



#271

*Notice*

Return receipt requested

C.K. Fletcher,

1453, 8th St.,

San Diego, Cal.

Deliver only to addressee or  
agent authorized in writing.

REGISTERED NO. ~~114097~~ 114097

28348



34826



28349





035265  
Department of the Interior.  
UNITED STATES LAND OFFICE,  
Los Angeles, Cal.

POSTMASTER: Return after 30 days,  
if unclaimed (P. L. and R. Sec. 670)



Return receipt requested

Catherine F. Taylor,  
3174 B St.,  
San Diego, Cal.

Deliver only to addressee or  
agent authorized in writing.

114098

REGISTERED NO. 114098

032269  
Department of the Interior.  
UNITED STATES LAND OFFICE,  
Los Angeles, Cal.

POSTMASTER: Return after 30 days,  
if unclaimed (P. L. and R. Sec. 670)



Return receipt requested

Ed Fletcher, Jr.,  
810 Ash St.,  
San Diego, Calif.

Deliver only to addressee or  
agent authorized in writing.

REGISTERED NO. 114095

114095

035264  
Department of the Interior.  
UNITED STATES LAND OFFICE,  
Los Angeles, Cal.

POSTMASTER: Return after 30 days,  
if unclaimed (P. L. and R. Sec. 670)



Return receipt requested

% Cuyamaca Water Co,  
916-8 + E Sts,  
National City, Cal.

Deliver only to addressee or  
agent authorized in writing.

Irene M. Tait, 1923  
National City, Cal.

114102

REGISTERED NO. 114102

F.No.1, Box 126.

4526 Panosana Ave  
San Diego  
Cal.

34824



28350



28909

34906



035268  
Department of the Interior.  
UNITED STATES LAND OFFICE,  
Los Angeles, Cal.

POSTMASTER: Return after 30 days,  
if unclaimed (P. L. and R. Sec. 670)



*Noted 4/19/23  
no index*

*Give notice 15*

Return receipt requested

Deliver only to addressee or  
agent authorized in writing.

Rebecca B. Doyle  
~~3427 - 4~~  
2427, 4th St.,

San Diego, Cal.

REGISTERED NO. 114100

114100

035267  
Department of the Interior.  
UNITED STATES LAND OFFICE,  
Los Angeles, Cal.

POSTMASTER: Return after 30 days,  
if unclaimed (P. L. and R. Sec. 670)



*Return  
4/19/23  
will call  
4/19/23*

K. L. May,

3526 Park Blvd.,

San Diego, Cal.

Return receipt requested

Deliver only to addressee or  
agent authorized in writing.

114096

REGISTERED NO. 114096

035289  
Department of the Interior.  
UNITED STATES LAND OFFICE,  
Los Angeles, Cal.

POSTMASTER: Return after 30 days,  
if unclaimed (P. L. and R. Sec. 670)



Mary C. B. Fletcher,

810 Ash St.,

San Diego, Cal.

Return receipt requested

Deliver only to addressee or  
agent authorized in writing.

REGISTERED NO. 114101

114101

34823



34825



28347



## NOTICE OF HEARING.

DEPARTMENT OF THE INTERIOR,  
UNITED STATES LAND OFFICE.

SERIAL NO. 035289CONTEST NO. 5205

✓  
Los Angeles, California.

December 20, 1923.

A sufficient <sup>protest</sup> ~~contest affidavit~~ having been filed in this office ~~by~~  
for the United States, contestant, against timber and stone  
(Kind of entry.)  
Entry No. \_\_\_\_\_, Serial No. 035289, made September 29, 1922, for  
SW $\frac{1}{4}$  SW $\frac{1}{4}$  Section 10,  
Township 11 S., Range 2 E., S. B. Meridian,  
by Mary C. B. Fletcher, Contestee, in which it is alleged that  
land more valuable for grazing than for timber and stone,

and the said contestee having filed a sufficient answer thereto, said  
parties are hereby notified to appear, respond, and offer evidence  
touching said allegation at 10 o'clock a. m. on February 19th, 1924,  
before Clerk of Superior Court, at San Diego, California.

\*(and that final hearing will be held at 10 o'clock a. m. on March  
20th, 1924, before) the Register and Receiver at the  
United States Land Office in Los Angeles, California.

Jendley D. Valentini, Register.

[Signature], Receiver.

## NOTICE OF HEARING.

DEPARTMENT OF THE INTERIOR,  
UNITED STATES LAND OFFICE.

SERIAL NO. 035269CONTEST NO. 5202Los Angeles, California.December 20, 1923.

A sufficient ~~contest~~ <sup>protest</sup> having been filed in this office ~~by~~  
for the United States, contestant, against timber and stone  
(Kind of entry.)  
 Entry No. 035269, Serial No. 035269, made September 20, 1922, for  
N $\frac{1}{2}$  SW $\frac{1}{4}$ ; SW $\frac{1}{4}$  NW $\frac{1}{4}$  Section 24,  
 Township 11 S., Range 2 E., S.B. Meridian,  
 by Ed. Fletcher, Jr., Contestee, in which it is alleged that  
the land more valuable for grazing than for timber and stone,

and the said contestee having filed a sufficient answer thereto, said  
 parties are hereby notified to appear, respond, and offer evidence  
 touching said allegation at 10 o'clock a. m. on February 18th, 1924,  
 before the Clerk of Superior Court at San Diego, California.

\*(and that final hearing will be held at 10 o'clock a. m. on March  
20th, 1924, before) the Register and Receiver at the  
 United States Land Office in Los Angeles, California.

Jendley D. Valentini, Register.

[Signature], Receiver.

# NOTICE OF HEARING.

DEPARTMENT OF THE INTERIOR,  
UNITED STATES LAND OFFICE.

SERIAL NO. 035264

CONTEST NO. 5197

Los Angeles, California.

December 20, 1923.

A sufficient ~~contest~~ <sup>protest</sup> having been filed in this office ~~by~~  
~~for the United States~~, contestant, against timber and stone  
(Kind of entry.)  
 Entry No. \_\_\_\_\_, Serial No. 035264, made September 20, 1923, for  
NE $\frac{1}{2}$  NW $\frac{1}{4}$  Section 6,  
 Township 10 S., Range 1 W., S. B. Meridian,  
 by Irene Fait, Contestee, in which it is alleged that  
the land is more valuable for grazing than for timber and stone.

and the said contestee having filed a sufficient answer thereto, said  
 parties are hereby notified to appear, respond, and offer evidence  
 touching said allegation at 10 o'clock a. m. on February 18th, 1924,  
 before Clerk of Superior Court, at San Diego, California.

\*(and that final hearing will be held at 10 o'clock a. m. on March  
20th, 1924, before) the Register and Receiver at the  
 United States Land Office in Los Angeles, California.

*Judley D. Valentin* Register.  
*[Signature]* Receiver.

\*If the testimony is to be taken before the Register and Receiver, and not under Rule 23, the words in () parentheses should be erased.

## NOTICE OF HEARING.

DEPARTMENT OF THE INTERIOR,  
UNITED STATES LAND OFFICE.

SERIAL NO. 035267CONTEST NO. 5200Los Angeles, California.December 20, 1923.

## protest

A sufficient ~~contestant's protest~~ protest having been filed in this office by  
the United States, contestant, against timber and stone  
(Kind of entry.)  
Entry No. \_\_\_\_\_, Serial No. 035267, made September 20, 1922, for  
E $\frac{1}{2}$  NW $\frac{1}{4}$  Section 15,  
Township 11 S., Range 22 E., S. B. Meridian,  
by K. L. May, Contestee, in which it is alleged that  
land more valuable for grazing than for timber and stone,

and the said contestee having filed a sufficient answer thereto, said  
parties are hereby notified to appear, respond, and offer evidence  
touching said allegation at 10 o'clock a. m. on February 20, 1924,  
before Clerk of the Superior Court, at San Diego, California.

\*(and that final hearing will be held at 10 o'clock a. m. on March  
20th, 1924, before) the Register and Receiver at the  
United States Land Office in Los Angeles, California.

Lendley D. Valentine, Register.

[Signature], Receiver.



## NOTICE OF HEARING.

DEPARTMENT OF THE INTERIOR,  
UNITED STATES LAND OFFICE.

SERIAL NO. 035266

CONTEST NO. 5199

Los Angeles, California.

December 20, 1923.

## protest

A sufficient ~~contest~~ <sup>protest</sup> ~~entry~~ having been filed in this office ~~by~~  
for United States \_\_\_\_\_, contestant, against timber and stone \_\_\_\_\_  
(Kind of entry.)  
Entry No. \_\_\_\_\_, Serial No. 035266, made September 20, 1922, for  
S $\frac{1}{2}$  NE $\frac{1}{2}$ ; NE $\frac{1}{2}$  SE $\frac{1}{2}$ , Section 15, NW $\frac{1}{2}$  SW $\frac{1}{2}$  of \_\_\_\_\_ Section 14  
Township 11 S., Range 2 E., \_\_\_\_\_ S. B. Meridian,  
by Cora Belle Fletcher \_\_\_\_\_, Contestee, in which it is alleged that  
the land is more valuable for grazing than for timber and stone.

and the said contestee having filed a sufficient answer thereto, said  
parties are hereby notified to appear, respond, and offer evidence  
touching said allegation at 10 o'clock a. m. on February 19, 1924,  
before Clerk of Superior Court, San Diego, California.

\*(and that final hearing will be held at 10 o'clock a. m. on March  
20th, 1924, before) the Register and Receiver at the  
United States Land Office in Los Angeles, California.

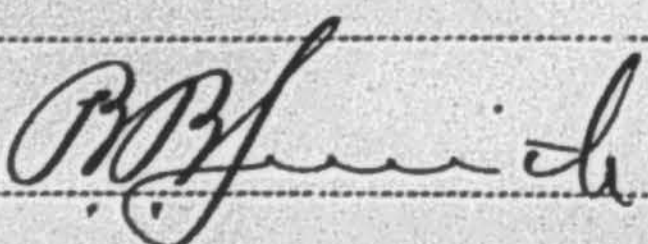
\_\_\_\_\_, Register.  
  
\_\_\_\_\_, Receiver.

# NOTICE OF HEARING.

DEPARTMENT OF THE INTERIOR,  
UNITED STATES LAND OFFICE.

SERIAL NO. 035265

CONTEST NO. 5198

Los Angeles, California.

December 20, 1923.

A sufficient ~~contest~~ <sup>protest</sup> having been filed in this office ~~by~~  
~~for the United States~~, contestant, against timber and stone  
(Kind of entry.)  
 Entry No. \_\_\_\_\_, Serial No. 035265, made September 20, 1922, for  
Lot 3 Section 5,  
 Township 10 S., Range 1 W., S. B. Meridian,  
 by Catherine F. Taylor, Contestee, in which it is alleged that  
~~the land is more valuable for grazing than for timber and stone,~~

and the said contestee having filed a sufficient answer thereto, said  
 parties are hereby notified to appear, respond, and offer evidence  
 touching said allegation at 10 o'clock a. m. on February 18, 1924,  
 before Clerk of the Superior Court, at San Diego, California.

\*(and that final hearing will be held at 10 o'clock a. m. on March  
20th, 1924, before) the Register and Receiver at the  
 United States Land Office in Los Angeles, California.

Hendley D. Valencia, Register.  
[Signature], Receiver.

\*If the testimony is to be taken before the Register and Receiver, and not under Rule 25, the words in ( ) parentheses should be erased.

## NOTICE OF HEARING.

DEPARTMENT OF THE INTERIOR,  
UNITED STATES LAND OFFICE.

SERIAL NO. 035268CONTEST NO. 5201Los Angeles, California.December 20, 1923.

A sufficient <sup>protest</sup> ~~contest~~ having been filed in this office ~~by~~  
for the United States, contestant, against timber and stone  
(Kind of entry.)  
 Entry No. \_\_\_\_\_, Serial No. 035268, made September 20, 1922, for  
SE $\frac{1}{4}$  SE $\frac{1}{4}$  Section 23,  
 Township 11 S., Range 2 E., S. B. Meridian,  
 by Rebecca F. Doyle, Contestee, in which it is alleged that  
land more valuable for grazing than for timber and stone.

and the said contestee having filed a sufficient answer thereto, said  
 parties are hereby notified to appear, respond, and offer evidence  
 touching said allegation at 10 o'clock a. m. on February 20th, 19 24,  
 before Clerk of Superior Court, at San Diego, California.

\*(and that final hearing will be held at 10 o'clock a. m. on March  
20th, 1924, before) the Register and Receiver at the  
 United States Land Office in Los Angeles, California.

Hendley D. Valentine, Register.  
[Signature], Receiver.

## NOTICE OF HEARING.

DEPARTMENT OF THE INTERIOR,  
UNITED STATES LAND OFFICE.

SERIAL NO. 035271  
CONTEST NO. 5204

✓  
Los Angeles, California.

December 19, 1923.

A sufficient contest affidavit having been filed in this office ~~by~~  
for the United States, contestant, against timber & stone  
(Kind of entry.)  
Entry No. \_\_\_\_\_, Serial No. 035271, made September 20, 1922, for  
SE<sup>1</sup> SE<sup>1</sup> of \_\_\_\_\_ Section 24,  
Township 11 S., Range S.E., \_\_\_\_\_ S. B. Meridian,  
by Jarvis L. Doyle, Contestee, in which it is alleged that  
the land is more valuable for grazing than for timber & stone.

and the said contestee having filed a sufficient answer thereto, said  
parties are hereby notified to appear, respond, and offer evidence  
touching said allegation at 10 o'clock a. m. on February 20, 1924,  
before Clerk of Superior Court, San Diego, California.

\*(and that final hearing will be held at 10 o'clock a. m. on March  
20, 1924, before) the Register and Receiver at the  
United States Land Office in Los Angeles, California.

Ludley D. Valentini, Register.  
[Signature], Receiver.

**Ed Fletcher Papers**

**1870-1955**

**MSS.81**

**Box: 63 Folder: 12**

**Business Records - Land Companies - Volcan  
Land and Water Company - Stone and Timber  
Act Applications and Mining - Application  
#035289 for San Luis Rey riparian lands - File 271**



**Copyright:** UC Regents

**Use:** This work is available from the UC San Diego Libraries. This digital copy of the work is intended to support research, teaching, and private study.

**Constraints:** This work is protected by the U.S. Copyright Law (Title 17, U.S.C.). Use of this work beyond that allowed by "fair use" requires written permission of the UC Regents. Permission may be obtained from the UC San Diego Libraries department having custody of the work (<http://libraries.ucsd.edu/collections/mscl/>). Responsibility for obtaining permissions and any use and distribution of this work rests exclusively with the user and not the UC San Diego Libraries.