

FIELD NOTES

of

T. 11 S. R. 4 E. S.B.M.

Pgs 289 to 322

Plotted on Map 394 G1
May 6, 1914
E. L. Pruitt

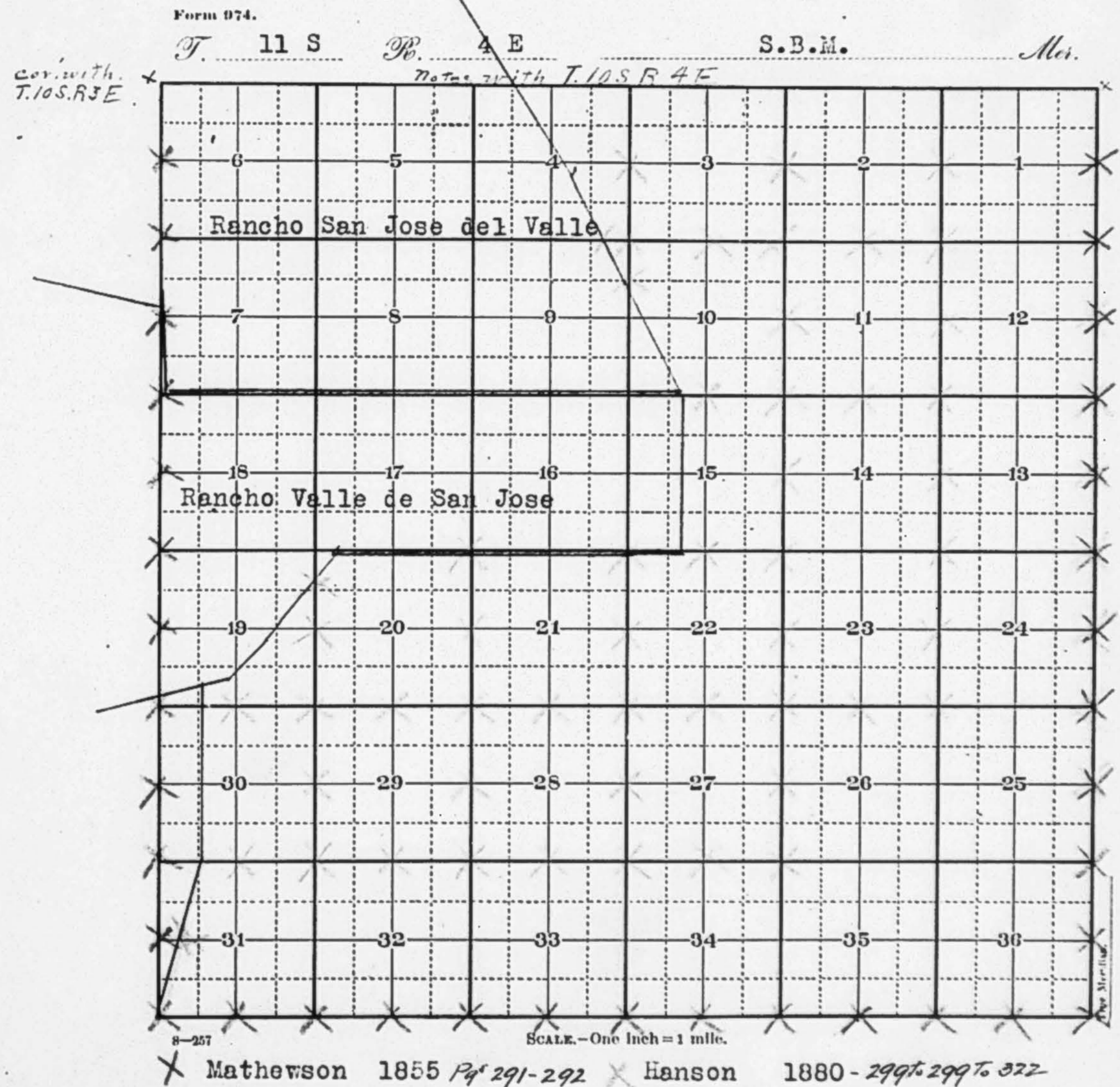

E.B. T. 11 S. R. 3 E. S.B.M.

Commenced June 29, at cor. Ts. 10, 11 S. Rs. 3, 4, E. and ran South on E.B. of T. 11 S. R. 3 E.

Va. 13° 30' E.

1st Mile

South bet. secs. 1, 6.

- 40.00 Set 1/4 sec. post in md. of earth with trench and pits as per inst.
- 40.06 Cross trail from Buena Vista to San Ysidro brs. E.
- 80.00 Set sec. post, cor. secs. 1, 6, 7, 12, in md. of earth with trench and pits as per inst.

Land undulating with good grass but destitute of timber.

2nd Mile.

South bet. secs. 7, 12.

- 40.00 Set 1/4 sec. post in md. of earth with trench &c., as per inst.
- 68.50 Cross road from Agua Caliente to San Felipe brs. SE.
- 80.00 Set sec. post, cor. secs. 7, 12, 13, 18, in md. of earth &c., from which a

Black oak 36 in. brs. N. 20° W. 150 lks.

Land undulating with good grass and scattered oak timber.

3rd Mile.

South bet. secs. 13, 18.

- 7.25 Cross wagon road from Warner's Ranch to San Felipe brs. E.
- 10.00 Leave Warner's Valley and commenced to ascend mountain.

1.

E.B. T. 11 S. R. 3 E. S.B.M.

- 40.00 Set 1/4 sec. post in md. of earth with trench &c. as per inst.
 - 80.00 Set sec. post, cor. secs. 13, 18, 19, 24, in md. of earth with trench and pits as per inst.
- Brushy and broken, slopes N.

4th Mile.

South bet. secs. 19, 24.

- 40.00 Set 1/4 sec. post in md. of earth with trench, &c. as per inst.
 - 80.00 Set sec. post, cor. secs. 19, 24, 25, 30, in md. of earth with trench and pits as per inst.
- Same as last mile.

5th Mile.

South bet. secs. 25, 30.

- 40.00 Set 1/4 sec. post in md. of earth with trench, &c. as per inst.
 - 80.00 Set sec. post, cor. secs. 25, 30, 31, 36, in md. of earth with trench and pits as per inst.
- Same as last mile.

6th Mile.

South bet. secs. 31, 36.

- 40.00 Set 1/4 sec. post in md. of earth with trench &c. as per inst.
- 80.00 Established cor. Ts. 11, 12 S. Rs. 3, 4, E. on a Pine tree 36 ins. dia. on N. side of a very steep mountain, about half way up.

Broken & brushy with pine timber.
Vol. 173-14

June 30, 1855
R. C. MATHEWSON.

2.

Commenced July 11th, at cor. Tps. 10, 11 S. Rs. 4, 5, E. and ran South on E.B. of T. 11 S. R. 4 E.

Va. 13° 30' E.

1st Mile

South bet. secs. 1, 6.

40.00 Set 1/4 sec. post in mound of rock as per inst.

80.00 Set sec. post, cor. secs. 1, 6, 7, 12, in mound of rock as per inst.

Rugged and rocky mountains.

2nd Mile

South bet. secs. 7, 12.

40.00 Set 1/4 sec. post in mound of rock as per inst.

80.00 Set sec. post, cor. secs. 7, 12, 15, 18, in mound of rock as per inst.

Same as last mile.

3rd Mile.

South bet. secs. 13, 18.

40.00 Set 1/4 sec. post in mound of earth with trench, etc., as per inst.

80.00 Set sec. post, cor. secs. 13, 18, 19, 24, in mound of earth with trench and pits as per inst.

Same as last mile.

4th Mile

South bet. secs. 19, 24.

40.00 Set 1/4 sec. post in mound of rock as per inst.

80.00 Set sec. post, cor. secs. 19, 24, 25, 30, in mound of earth with trench and pits as per inst.

Same as last mile.

5th Mile.

South bet. secs. 25, 30.

40.00 Set 1/4 sec. post in mound of earth with trench, etc. as per inst.

80.00 Set sec. post, cor. secs. 25, 30, 31, 36, in mound of rock, as per inst.

Broken, rocky and brushy mountains.

July 11th.

6th Mile.

South bet. secs. 31, 36.

40.00 Set 1/4 sec. post in mound of earth with trench, etc. as per inst.

80.00 Set Tp. cor. Tps. 11, 12 S. Rs. 4, 5, E. in mound of rock as per inst.

Same as last mile.

Thence ran

West on S.B. of T. 11 S. R. 4 E. Random line.

Va. 15° 30' E.

Ran West 6 miles and 1.47 chs., setting temp. 1/4 sec. and sec. posts and intersected Meridian line bet. Rs. 3, 4, E. 178 lks. S.

of cor. Tps. 11, 12 S. Rs. 3, 4, E.

July 12th.

Commenced at cor. Tps. 11, 12 S. Rs. 3, 4, E. and ran

East on S.B. of Tp. 11 S. R. 4 E. True line.

Va. 13° 17' E.

1st Mile.

East bet. secs. 6, 31.

- 30.00 Summit of low ridge brs. N. & S.
- 41.47 Established 1/4 sec. cor. on a small pine 2 ins. in dia.
- 43.00 Leave pine timber and commence to descend mountain.
- 55.00 Cross deep gulch, run S.
- 81.47 Set sec. post, cor. secs. 5, 6, 31, 32 in mound of rock as per inst.

Broken, rocky and brushy mountains.

2nd Mile.

East bet. secs. 5, 32.

- 40.00 Set 1/4 sec. post in mound of rock as per inst.
- 80.00 Set sec. post, cor. secs. 4, 5, 32, 33, in mound of rock in deep canon, running NE. about 40 chs. SW. from the Indian Rancheria of La Puerta de San Felipe, situated at the mouth of the Canon in the NW. cor. of the San Felipe Valley.

3rd Mile.

East bet. secs. 4, 33.

- 40.00 Set 1/4 sec. post in mound of earth with trench, etc., as per inst.

- 73.00 Cross dry bed of arroyo, at head of San Felipe Valley runs SE.
 - 80.00 Set sec. post, cor. secs. 3, 4, 33, 34, in mound of earth with trench and pits as per inst.
- Sandy and rocky mountain spurs.

4th Mile.

East bet. secs. 3, 34.

- 7.25 Cross wagon road from Warner's ranch to San Felipe brs. SE.
- 28.00 Foot of low hills brs. NW. & SE.
- 40.00 Set 1/4 sec. post in mound of earth with trench, etc., as per inst.
- 41.00 Base of mountains brs. N. & S.
- 80.00 Set sec. post, cor. secs. 2, 3, 34, 35, in mound of rock as per inst.

Barren and rocky hills and mountains.

5th Mile.

East bet. secs. 35, 2.

- 20.00 Summit of mountain ridge brs. NW. & SE.
 - 40.00 Set 1/4 sec. post in mound of rock as per inst.
 - 80.00 Set sec. post cor. secs. 1, 2, 35, 36, in mound of rock as per inst.
- Rough, rocky mountains.

6th Mile.

East bet. secs. 1, 36.

40.00 Set 1/4 sec. post in mound of rocks as per inst.
80.00 To cor. Tps. 11, 12, S. Rs. 4, 5, E.
Rough, rocky, barren and broken mountains.

July 13th, 1855

R. C. MATHEWSON.

Vol. 9-7

RETRACING

From the cor. to secs. 25, 36, 30 and 31, I run
North on a random line bet. secs. 25 and 30,

Va. 13° 50' E.

Ascend.

40.00 Set temp. 1/4 sec. cor.
44.78 Top of spur brs. E. & W. & descend.
53.63 Cross sag brs. NE. & SW. & ascend.
80.00 Set temp. sec. cor.

North on a random line bet. secs. 19 and 24.

Va. 13° 50' E.

Ascend gradually.

21.88 Enter level mesa brs. E. & W.
40.00 Set temp. 1/4 sec. cor.
52.85 Cross trail brs. N. 78° W. & S. 78° E.
80.00 Set temp. sec. cor.

RETRACING

North on a random line bet. secs. 13 and 18.

Va. 13° 50' E.

40.00 Set temp. 1/4 sec. cor.

80.00 Set temp. sec. cor.

North on a random line bet. secs. 7 and 12.

Va. 13° 50' E.

40.00 Set temp. 1/4 sec. cor.

63.20 Leave mesa and continue ascent.

80.50 To a point 1.78 lks. W. of cor. to secs. 1, 6, 7 and 12,
from which cor. I run

S. 19' W. on a true line bet. secs. 7 and 12.

Va. 13° 50' E.

40.06 Set post 4 in. dia. 1 ft. in earth 1 ft. above stone mound 4 ft.
in dia. at base by 2 ft. in height for 1/4 sec. cor.

80.12 Set post 4 in. sq. 1 ft. in earth 1 ft. above stone mound 4½ ft.
in dia. at base by 2 ft. in height for cor. to secs. 7, 12, 13, 18.
Land mountainous, soil 2nd and 3d rate.

Timber & undergrowth of oak and chaparral.

S. 19' W. bet. secs. 13 and 18.

Va. 13° 50' E.

40.06 Set post 4 in. dia. 1 ft. in earth 1 ft. above stone mound 4 ft.
in dia. at base by 2 ft. in height for 1/4 sec. cor.

80.12 Set post 4 in. sq. 1 ft. in earth 1 ft. above earth mound 4½ ft.

RETRACING

in dia. at base by 2 ft. in height and dug pits 24 x 18 x 12,
8 lks. dist. at 4 angles for cor. to secs. 15, 24, 18, 19.
Land mountainous, soil 2nd and 3d rate.
Timber & undergrowth of oak and chaparral.

S. 19° W. bet. secs. 19 and 24.

40.06 Set post 4 in. dia. 1 ft. in earth 1 ft. above earth mound 4 ft.
in dia. at base by 2 ft. in height and dug pit 24 x 18 x 12,
8 lks. E. for 1/4 sec. cor.

80.13 Set post 4 in. sq. 1 ft. in earth 1 ft. above stone mound 4 1/2 ft.
in dia. at base by 2 ft. in height for cor. to secs. 24, 25, 19, 30.
Land mountainous, soil 2nd and 3d rate.
Timber & undergrowth of oak and chaparral.

S. 19' W. bet. secs. 25 and 30.

40.06 Set stone 18 x 12 x 7 in stone mound 4 ft. in dia. at base by 2 ft.
in height for 1/4 sec. cor.

80.13 The cor. to secs. 25, 36, 30, 31,
Land mountainous, soil 3d rate.

Timber & undergrowth of oak and chaparral.

Sept. 27, 1880

I am unable after diligent search to find any old cors. on this
line.

A. P. HANSON

Vol. 175-4

North bet. secs. 25, 26.

Va. 13° 50' E.

80.00

Set post 4 in. sq. 1 ft. in earth 1 ft. above earth mound 4 1/2 ft.
in dia. at base by 2 ft. in height and dug pits 24 x 18 x 12,
8 lks. dist. at 4 angles for cor. to secs. 25, 24, 25, 26.
Land mountainous, soil 3d rate.
Timber & undergrowth of pine, oak and chaparral.

North bet. secs. 23, 24.

Va. 13° 50' E.

40.00

Across mesa.

Set post 4 in. dia. 1 ft. in earth 1 ft. above earth mound 4 ft
in dia. at base by 2 ft. in height and dug pit 24 x 18 x 12,
8 lks. E. for 1/4 sec. cor.

76.85

Cross trail brs. E. & W.

80.00

Set post 4 in. sq. 1 ft. in earth 1 ft. above earth mound 4 1/2 ft.
in dia. at base by 2 ft. in height and dug pits 24 x 18 x 12,
8 lks. dist. at 4 angles for cor. to secs. 13, 14, 23, 24,
from which brs. a

Live oak 61 in. dia. N. 32 1/2° W. 420 lks. dist.

Live oak 48 in. dia. S. 33° W. 485 lks. dist.

Live oak 32 in. dia. S. 34° E. 464 lks. dist.

Land mountainous, soil 3d rate.

Timber & undergrowth of pine, oak and chaparral.

North bet. secs. 13, 14.

Va. 13° 50' E.

Across Mesa, ascending gradually.

40.00 ✓ Set post 4 in. dia. 1 ft. in earth 1 ft. above earth mound 4 ft. in dia. at base by 2 ft. in height and dug pit 24 x 18 x 12, 8 lks. E. for 1/4 sec. cor.

80.00 ✓ Set post 4 in. sq. 1 ft. in earth 1 ft. above earth mound 4 1/2 ft. in dia. at base by 2 ft. in height and dug pits 24 x 18 x 12, 8 lks. dist. at 4 angles for cor. to secs. 11, 12, 13, 14. Land mountainous, soil 3d rate.

Timber & undergrowth of pine, oak, and chaparral.

Sept. 28, 1880

North bet. secs. 11, 12.

Va. 15° 30' E.

Ascend gradually.

25.40 ✓ Leave mesa, brs. NE. & SW. & continue ascent.

40.00 ✓ Set stone 24 x 14 x 8 in earth mound 4ft. in dia. at base by 2 ft in height and dug pit 24 x 18 x 12, 8 lks. E. for 1/4 sec. cor.

51.76 ✓ Top of spur brs. E. & W. & descend.

73.95 ✓ Cross gulch with brook, 10 lks. wide, course SE. & ascend.

80.00 ✓ Set stone 26 x 8 x 7, in stone mound 4 1/2 ft. in dia. at base by 2 ft. in height for cor. to secs. 1, 2, 11, 12, from which brs. a

White oak 24 in. dia. N. 77° W. 76 lks. dist.

White oak 22 in. dia. S. 66° W. 66 lks. dist.

White oak 20 in. dia. N. 35° E. 80 lks. dist.

Land mountainous, soil 3d rate.

Timber & undergrowth of pine, oak, cedar and chaparral.

North on a random line bet. secs. 1, 2.

Va. 13° 50' E.

Ascend abruptly.

40.00 ✓ Set temp. 1/4 sec. cor.

68.95 ✓ Summit of ridge brs. E. & W. & descend.

80.31 ✓ Int. N.B. of Tp. 5 lks. E. of cor. to secs. 1, 2, 35, 36, from which cor. I run

S. 2' E. on a true line bet. secs. 1, 2.

Va. 13° 50' E.

40.31 ✓ Set stone 15 x 8 x 5 in stone mound 4 ft. in dia. at base by 2 ft in height for 1/4 sec. cor.

80.31 ✓ The cor. to secs. 1, 2, 11, 12.

Land mountainous, soil 3d rate.

Timber & undergrowth of pine, oak and chaparral.

North bet. secs. 34, 35.

Va. 13° 50' E.

80.00 ✓ Set stone 15 x 8 x 8 in stone mound 4 1/2 ft. in dia. at base by 2 ft in height for cor. to secs. 26, 27, 34, 35.

Land mountainous, soil 3d rate.

Timber & undergrowth of pine, oak and chaparral.

North bet. secs. 26, 27.

Va. 13° 50' E.

Ascend.

- ✓ 18.50 Top of spur brs. E. & W. & descend.
- 40.00 Set stone 21 x 17 x 11 in stone mound 4 ft. in dia. at base by 2 ft. in height for 1/4 sec. cor.
- 43.09 Cross gulch 38 lks. wide N. 75° E. & ascend.
- 67.35 Top of spur brs. N. 75° E. & S. 75° W. & descend.
- 80.00 Set post 4 in. sq. 1 ft. in earth 1 ft. above earth mound 4½ ft. in dia. at base by 2 ft. in height and dug pits 24 x 18 x 12, 8 lks. dist. at 4 angles for cor. to secs. 22, 23, 26 and 27. Land mountainous, soil 3d rate. Timber & undergrowth of pine, oak and chaparral.

East on a random line bet. secs. 25, 26.

Va. 13° 50' E.

Across small Flat.

- 4.00 Leave same, brs. N. & S. & ascend gradually.
- 12.13 A Live oak 15 in. dia.
- 35.23 Enter mesa brs. N. & S.
- 80.20 Int. N. & S. line 24 lks. S. of cor. to secs. 23, 24, 25, 26, from which cor. I run S. 89° 50' W. on a true line bet. secs. 23, 26.
- 40.10 ✓ Set post 4 in. dia. 1 ft. in earth 1 ft. above earth mound 4 ft in dia. at base by 2 ft. in height and dug pit 24 x 18 x 12, 8 lks.

N. for 1/4 sec. cor.

- ✓ 80.20 The cor. to secs. 22, 23, 26, 27. Land mountainous, soil 3d rate. Timber & undergrowth of pine, oak and chaparral.

North bet. secs. 22, 23.

Va. 13° 50' E.

Ascend.

- ✓ 5.00 Top of spur brs. E. & W. & descend.
- 11.15 Cross flat ravine 400 lks. wide course NW. & ascend.
- 40.00 Set stone 23 x 13 x 11 in stone mound 4 ft. in dia. at base by 2 ft. in height for 1/4 sec. cor.
- 55.24 Summit of ridge brs. E. & W. & descend.
- 72.18 Enter mesa brs. N. 21° W. & S. 21° E.
- 80.00 ✓ Set post 4 in. sq. 1 ft. in earth 1 ft. above stone mound 4½ ft. in dia. at base by 2 ft. in height for cor. to secs. 14, 15, 22, 23. Land mountainous, soil 3d rate. Timber & undergrowth of pine, oak and chaparral.

East on a random line bet. secs. 14, 23.

Va. 13° 50' E.

Across mesa.

- 40.00 Set temp. 1/4 sec. cor.
- 77.12 Cross trail brs. N. 65° W. & S. 65° E.
- 80.09 ✓ Int. N. & S. line 10 lks. N. of cor. to secs. 15, 14, 25, 24, from which cor. I run

N. 89° 56' W. on a true line bet. secs. 14, 23.

Va. 13° 50' E.

40.05 Set a post 4 in. dia. 1 ft. in earth 1 ft. above earth mound 4 ft. in dia. at base by 2 ft. in height and dug pit 24 x 18 x 12, 8 lks. N. for 1/4 sec. cor., from which brs.

Helm's house N. 34° E. about 18 chs. dist.

80.09 The cor. to secs. 14, 15, 22, 23.

Land mountainous, soil 2nd and 3d rate.

Timber & undergrowth of pine, oak and chaparral.

West on a random line bet. secs. 15 and 22.

Va. 13° 50' E.

Descend gradually.

40.00 Set temp. 1/4 sec. cor.

54.78 Int. Bdy. line of Rancho Valle de San Jose, 27 lks. N. of cor.

No. 15, from which cor. I run

N. 89° 43' E. on a true line bet. secs. 15 and 22.

Va. 13° 50' E.

14.78 Set post 4 in. dia. 1 ft. in earth 1 ft. above stone mound 4 ft. in dia. at base by 2 ft. in height for 1/4 sec. cor.

54.78 The cor. to secs. 14, 15, 22, 23.

Land mountainous, and rolling, soil 3d rate.

Timber " undergrowth of pine, oak and chaparral.

North bet. secs. 14, 15.

Va. 13° 50' E.

Across mesa.

14.40 Enter timber brs. E. & W.

21.98 Cross road brs. E. & W.

24.35 Leave timber brs. E. & W.

40.00 Set post 4 in. dia. 1 ft. in earth 1 ft. above earth mound 4 ft. in dia. at base by 2 ft. in height and dug pit 24 x 18 x 12, 8 lks. E. for 1/4 sec. cor.

66.22 Leave mesa brs. E. & W. & ascend.

80.00 Set stone 22 x 11 x 6 in stone mound 4 1/2 ft. in dia. at base by 2 ft. in height for cor. to secs. 10, 11, 14, 15.

Land mountainous, soil 2d rate.

Timber & undergrowth of pine, oak and chaparral.

East on a random line bet. secs. 11, 14.

Va. 13° 50' E.

Ascend.

27.44 Top of ridge brs. N. 34° E. & S. 34° W. & descend.

34.43 Cross ravine course S. 37° W. & ascend.

40.00 Set temp. 1/4 sec. cor.

47.22 Summit of ridge brs. N. 33° E. & S. 33° W. & descend.

61.30 Enter mesa brs. N. 34° E. & S. 34° W.

79.72 Int. N. & S. line 25 lks. N. of cor. to secs. 11, 12, 13, 14, from which cor. I run

N. 89° 45' W. on a true line bet. secs. 11, 14.

Va. 13° 50' E.

39.86 Set post 4 in. dia. 1 ft. in earth 1 ft. above stone mound 4 ft.

in dia. at base by 2 ft. in height for 1/4 sec. cor.

79.72

The cor. to secs. 10, 11, 14, 15.

Land mountainous, soil 3d rate.

Timber & undergrowth of pine, oak and chaparral.

Sept. 30, 1880

West on a random line bet. secs. 10 and 15.

Va. 13° 50' E.

Descend.

39.82

Cross brook 9 lks. wide course S. 20° W.

40.00

Set temp. 1/4 sec. cor.

54.00

Int. Bdy. line of Rancho Valle de San Jose 16 lks. N. of cor.

No. 14, from which cor. I run

N. 89° 50' E. on a true line bet. secs. 10 and 15.

Va. 13° 50' E.

14.00

Set stone 18 x 8 x 6 in stone mound 4 ft. in dia. at base by 2 ft. in height for 1/4 sec. cor.

54.00

The cor. to secs. 10, 11, 14, 15.

Land mountainous, soil 3d rate.

Timber & undergrowth of pine, oak, cedar and chaparral.

North bet. secs. 10 and 11.

Va. 13° 50' E.

Ascend.

29.42

Top of spur brs. NE. & SW. & descend.

40.00

Set post 4 in. dia. 1 ft. in earth 1 ft. above earth mound 4 ft.

in dia. at base by 2 ft. in height and dug pit 24 x 18 x 12, 8 lks

E. for 1/4 sec. cor.

46.18

Cross gulch with brook 12 lks. wide course SW. & ascend abruptly.

80.00

Set post 4 in. sq. 1 ft. in earth 1 ft. above stone mound 4 1/2 ft. in dia. at base by 2 ft. in height for cor. to secs. 2, 3, 10 and 11, from which brs. a

✓ Pine 15 in. dia. N. 85° E. 28 lks. dist.

✓ Pine 8 in. dia. S. 36° W. 20 lks. dist.

Land mountainous, soil 2nd and 3d rate.

Timber & undergrowth of pine, oak and chaparral.

East on a random line bet. secs. 2 and 11.

Va. 13° 50' E.

Descend abruptly.

22.71

Cross gulch with brook 21 lks. wide course S., soon turns SW. & ascend.

40.00

Set temp. 1/4 sec. cor.

52.15

Top of mountain brs. N. & S. & descend.

76.47

Cross gulch with brook 11 lks. wide course SE. & ascend.

80.35

Int. N. & S. line 17 lks. S. of cor. to secs. 1, 2, 11, 12, from which cor. I run

✓ S. 89° 53' W. on a true line bet. secs. 2 and 11.

Va. 13° 50' E.

40.18

Set post 4 in. dia. 1 ft. in earth 1 ft. above stone mound 4 ft. in dia. at base by 2 ft. in height for 1/4 sec. cor.

80.35

The cor. to secs. 2, 3, 10, 11.

Land mountainous, soil 3d rate.

East on a random line bet. secs. 22, 27

Va. 13° 50' E.

Ascend.

- 11.13 Top of spur brs. N. & S. & descend.
- 25.30 Cross ravine 12 lks. wide course N. & ascend.
- 34.80 Top of ridge brs. N. & S. & descend.
- 40.00 Set temp. 1/4 sec. cor.
- 79.93 Int. N. & S. line 9 lks. N. of cor. to secs. 22, 25, 26, 27,
from which cor. I run
N. 89° 56' W. on a true line bet. secs. 22, 27.

Va. 13° 50' E.

- 39.97 Set stone 14 x 10 x 8 in stone mound 4 ft. in dia. at base by
2 ft. in height for 1/4 sec. cor.

- 79 93 The cor. to secs. 21, 22, 27, 28.
Land mountainous, soil 3d rate.
Timber & undergrowth of pine, oak and chaparral.

North bet. secs. 21, 22.

Va. 13° 50' E.

Descend.

- 37.71 Cross gulch 20 lks. wide course NE. & ascend.
- 40.00 Set stone 16 x 14 x 8 in stone mound 4 ft. in dia. at base by
2 ft. in height for 1/4 sec. cor.
- 46.00 Top of ridge brs. NE. & SW. & descend.
- 79 40 Int. Bdy. line of Rancho Valle de San Jose 25.90 chs. W. of cor.
No. 15 and set stone 14 x 12 x 9 in earth mound 4½ ft. in dia.

at base by 2 ft. in height and dug pits 24 x 18 x 12, 8 lks.
dist. at 4 angles for closing cor. to secs. 21 and 22.

Land mountainous, soil 3d rate.

Timber & undergrowth of pine, oak and chaparral.

North bet. secs. 32, 33.

Va. 13° 50' E.

- 80.00 Set post 4 in. sq. 1 ft. in earth 1 ft. above earth mound 4½ ft.
in dia. at base by 2 ft. in height and dug pits 24 x 18 x 12,
8 lks. dist. at 4 angles for cor. to secs. 28, 29, 32, 33,
from which brs. a

- ✓ Live oak 40 in. dia. N. 52° W. 414 lks. dist.
- ✓ Live oak 24 in. dia. S. 64° W. 81 lks. dist.
- ✓ Live oak 10 in. dia. S. 16° E. 94 lks. dist.
- ✓ Willow 8 in. dia. N. 32° E. 252 lks. dist.

Land mountainous, soil 2nd and 3d rate.

Timber & undergrowth of pine, oak, cedar, willow & chaparral.

East on a random line bet. secs. 28, 33.

Va. 13° 50' E.

Through valley.

- 1.81 Cross road from Los Angeles to Fort Yuma brs. NW. & SE.
- 40.00 Set temp. 1/4 sec. cor.
- 44.37 Leave valley brs. N. & S. & ascend.
- 79,71 Int. N. & S. line 11 lks. S. of cor. to secs. 27, 28, 33, 34,

from which cor. I run

S. 89° 55' W. on a true line bet. secs. 28, 33.

Va. 13° 50' E.

39.86 Set stone 14 x 11 x 6 in earth mound 4 ft. in dia. at base by 2 ft. in height and dug pit 24 x 18 x 12, 8 lks. N. for 1/4 sec. cor.

79.71 The cor. to secs. 28, 29, 32, 33.

Land mountainous, except in valley, soil 2nd and 3d rate.

Timber & undergrowth of pine, oak, cedar and chaparral.

Oct. 2, 1880

North bet. secs. 28, 29.

Va. 13° 50' E.

✓ Through valley.

2.00 Cross road from Los Angeles to Fort Yuma brs. NW. & SE.

14.12 Leave valley brs. E. & W. & ascend.

40.00 Set stone 14 x 11 x 6 in earth mound 4 ft. in dia. at base by 2 ft. in height and dug pit 24 x 14 x 12, 8 lks. E. for 1/4 sec. cor.

75.46 Top of spur brs. N. 68° E. & S. 68° W. & descend.

80.00 Set stone 20 x 14 x 12, in stone mound 4½ ft. in dia. at base by 2 ft. in height for cor. to secs. 20, 21, 28, 29, in a gulch 16 lks. wide course S. 64° W.

Land mountainous, soil 2nd and 3d rate.

Timber & undergrowth of pine, oak, cedar and chaparral.

East on a random line bet. secs. 21 and 28.

Va. 13° 50' E.

✓ Ascend.

29.46 Top of spur brs. NE. & SW. & descend.

40.00 Set temp. 1/4 sec. cor.

44.75 Cross gulch 15 lks. wide course N. & ascend.

80.12 Int. N. & S. line 17 lks. S. of cor. to secs. 21, 22, 27, 28, from which cor. I run

S. 89° 53' W. on a true line bet. secs. 21, 28.

Va. 13° 50' E.

40.06 Set stone 16 x 12 x 5 in stone mound 4 ft. in dia. at base by 2 ft. in height for 1/4 sec. cor.

80 12 The cor. to secs. 20, 21, 28, 29.

✓ Land mountainous, soil 3d rate.

Timber & undergrowth of pine, oak and chaparral.

North bet. secs. 20, 21.

Va. 13° 50' E.

✓ Ascend.

27.30 Summit of mountain brs. E. & W. & descend.

40.00 Set stone 26 x 8 x 7 in stone mound 4 ft. in dia. at base by 2 ft. in height for 1/4 sec. cor.

72.24 Cross gulch 13 lks. wide course N. 74° W. & ascend.

76.15 Summit of ridge brs. NW. & SE. & descend.

78.90 Int. Bdy. line of Rancho Valle de San Jose and Set stone 18 x 11 x 9 in earth mound 4½ ft. in dia. at base by 2 ft. in height and dug pits 24 x 18 x 12, 8 lks. dist. at 4 angles for closing cor. to secs. 20, 21.

Timber & undergrowth of pine, oak and chaparral.

North on a random line bet. secs. 2, 3.

Va. 13° 50' E.

Ascend abruptly.

- 17.38 Top of mountain brs. N. 57° E. & S. 57° W. & descend.
- 40.00 Set temp. 1/4 sec. cor.
- 80.25 Int. N.B. of Tp. 17 lks. E. of cor. to secs. 2, 3, 34, 35, from which cor. I run

S. 7' E. on a true line bet. secs. 2, 3.

Va. 13° 50' E.

- 40.25 Set stone 22 x 12 x 9 in stone mound 4 ft. in dia. at base by 2 ft. in height for 1/4 sec. cor.

- 80.25 The cor. to secs. 2, 3, 10 and 11.

Land mountainous, soil 3d rate.

Timber & undergrowth of pine, oak and chaparral.

West bet. secs. 3, 10

Va. 13° 50' E.

Descend.

- 40.00 Set stone 17 x 12 x 5 in stone mound 4 ft. in dia. at base by 2 ft. in height for 1/4 sec. cor.
 - 50.25 Cross gulch 17 lks. wide course S. & ascend.
 - 67.54 Summit of ridge brs. NE. & SW. & descend.
 - 80.00 Set stone 19 x 11 x 9 in stone mound 4 1/2 ft. in dia. at base by 2 ft. in height for cor. to secs. 3, 4, 9, 10
- Land mountainous, soil 3d rate.

Timber & undergrowth of pine, oak and chaparral.

South bet. secs. 9, 10

Va. 13° 50' E.

Descend.

- 11.70 Int. Bdy. line of Rancho Valle de San Jose and
- Set stone 21 x 17 x 5 in earth mound 4 1/2 ft. in dia. at base by 2 ft. in height and dug pits 24 x 18 x 12, 8 lks. dist. at 4 angles for closing cor. to frac. secs. 9, 10.
- Land mountainous, soil 3d rate.
- Timber & undergrowth of pine, oak and chaparral.

North on a random line bet. secs. 3, 4.

Va. 13° 50' E.

Ascend.

- 13.00 Top of spur brs. E. & W. & descend.
- 23.90 Cross creek 22 lks. wide course SW., soon turns S. & ascend.
- 25.53 Cross trail brs. with creek.
- 40.00 Set temp. 1/4 sec. cor.
- 80.47 Int. N.B. of Tp. 13 lks. W. of cor. to secs. 3, 4, 33, 34, from which cor. I run
- S. 6' W. on a true line bet. secs. 3, 4.
- 40.47 Set stone 24 x 11 x 5 in earth mound 4 ft. in dia. at base by 2 ft. in height and dug pit 24 x 18 x 12, 8 lks. E. for 1/4 sec. cor.

Va. 13° 50' E.

80.47 The cor. to secs. 3, 4, 9, 10.
Land mountainous, soil 2nd and 3d rate.
Timber & undergrowth of pine, oak, cedar and chaparral.

West bet. secs. 4, 9.

Va. 13° 50' E.

Descend.

4.47 Int. Bdy. line of Rancho San Jose del Valle and
Set stone 15 x 6 x 5 in earth mound 4½ ft. in dia. at base by
2 ft. in height and dug pits 24 x 18 x 12, 8 lks. dist. at 4
angles for closing cor. to frac. secs. 4 and 9,
from which brs. a

Granite stone N. 20¾° W. 39.77 chs. dist.
Land mountainous, soil 3d rate.
Timber & undergrowth of pine, oak and chaparral.

Oct. 1, 1880

North bet. secs. 33, 34.

Va. 13° 50' E.

Descend.

80.00 Set stone 18 x 12 x 5 in stone mound 4½ ft. in dia. at base by
2 ft. in height for cor. to secs. 27, 28, 33, 34.
Land mountainous, soil 3d rate.
Timber & undergrowth of pine, oak and chaparral.

East on a random line bet. secs, 27 and 34.

Va. 13° 50' E.

Ascend gradually.

40.00 Set temp. 1/4 sec. cor.
52.28 Summit of ridge brs. N. 17° E. & S. 17° W. & descend.
79.85 Int. N. & S. line 39 lks. S. of cor. to secs. 26, 27, 34, 35,

from which cor. I run

S. 89° 43' W. on a true line bet. secs. 27, 34.

Va. 13° 50' E.

39.98 Set stone 15 x 9 x 5 in stone mound 4 ft. in dia. at base by
2 ft. in height for 1/4 sec. cor.

79,85 The cor. to secs. 27, 28, 33, 34.

Land mountainous, soil 3d rate.
Timber & undergrowth of pine, oak and chaparral.

North bet. secs. 27, 28.

Va. 13° 50' E.

Ascend.

40.00 Set stone 14 x 8 x 6 in earth mound 4 ft. in dia. at base by 2 ft
in height and dug pit 24 x 18 x 12, 8 lks. E. for 1/4 sec. cor.

59.00 Summit of ridge brs. E. & W. & descend.

80.00 Set stone 15 x 10 x 8 in stone mound 4½ ft. in dia. at base by
2 ft. in height for cor. to secs. 21, 22, 27, 28.

Land mountainous, soil 3d rate.
Timber & undergrowth of pine, oak and chaparral.

Land mountainous, soil 3d rate.

Timber & undergrowth of pine, oak and chaparral.

North bet. secs. 31, 32.

Va. 13° 50' E.

Descend.

80.00 Set post 4 in. sq. 1 ft. in earth 1 ft. above earth mound 4 1/2 ft in dia. at base by 2 ft. in height and dug pits 24 x 18 x 12, 8 lks. dist. at 4 angles for cor. to secs. 29, 30, 31, 32, from which brs. a

Live oak 22 in. dia. S. 66° E. 212 lks. dist.

Land mountainous, soil 3d rate.

Timber & undergrowth of pine, oak and chaparral.

East on a random line bet. secs. 29, 32.

Va. 13° 50' E.

Descend.

13.72 Cross ravine with brook 12 lks. wide course NE. & ascend.

24.50 Top of spur brs. NE. & SW. & descend.

40.00 Set temp. 1/4 sec. cor.

46.27 Cross gulch 14 lks. wide course N. & ascend.

54.05 Top of spur brs. N. & S. & descend.

76.78 Cross creek 125 lks. wide runs SE. & ascend.

80.14 Int. N. & S. line 51 lks. S. of cor. to secs. 28, 29, 32, 33,

from which cor. I run

S. 89° 38' W. on a true line bet. secs. 29, 32.

Va. 13° 50' E.

40.07 Set post 4 in. dia. 1 ft. in earth 1 ft. above earth mound 4 ft. in dia. at base by 2 ft. in height and dug pit 24 x 18 x 12, 8 lks. N. for 1/4 sec. cor., from which brs. a

Live oak 38 in. dia. N. 59° E. 25 lks. dist.

Live oak 14 in. dia. S. 37° W. 102 lks. dist.

80.14 The cor. to secs. 29, 30, 31, 32.

Land mountainous, soil 2nd and 3d rate.

Timber & undergrowth of pine, oak, cedar and chaparral.

West on a random line bet. secs. 30, 31.

Va. 13° 50' E.

Ascend.

24.16 Top of spur brs. NE. & SW. & descend.

36.70 Cross ravine 12 lks. wide course NE. & ascend.

40.00 Set temp. 1/4 sec. cor.

56.05 Int. the W.B. of Tp. 37 lks. N. of cor. to secs. 30, 31, 25, 36, from which cor. I run

N. 89° 37' E. on a true line bet. secs. 30 and 31.

Va. 13° 50' E.

16.05 Set stone 18 x 10 x 7 in earth mound 4 ft. in dia. at base by 2 ft. in height and dug pit 24 x 18 x 12, 8 lks. N. for 1/4 sec. cor.

56.05 The cor. to secs. 29, 30, 31, 32.

Land mountainous, soil 3d rate.

Timber & undergrowth of pine, oak and chaparral.

North bet. secs. 29, 30.

Va. 13° 50' E.

Ascend.

6.53 Top of spur brs. N. 68° E. & S. 68° W. & descend.

35.26 Cross ravine 14 lks. wide course E. & ascend.

40.00 Set post 4 in. dia. 1 ft. in earth 1 ft. above earth mound 4 ft. in dia. at base by 2 ft. in height and dug pit 24 x 18 x 12, 8 lks. E. for 1/4 sec. cor., from which brs. a

Boulder 20 ft. long 5 ft. high E. 12 lks. dist.

This cor. is on top of spur brg. E. & W. & descend.

44.36 Cross ravine 14 lks. wide course E. & ascend.

80.00 Set post 4 in. sq. 1 ft. in earth 1 ft. above earth mound 4 1/2 ft. in dia. at base by 2 ft. in height and dug pits 24 x 18 x 12, 8 lks. dist. at 4 angles for cor. to secs. 19, 20, 29, 30, from which brs. a

Live oak 15 in. dia. N. 48° W. 893 lks. dist.

Land mountainous, soil 3d rate.

Timber & undergrowth of pine, oak and chaparral.

Oct. 4, 1880

East on a random line bet. secs. 20, 29.

Va. 13° 50' E.

Descend.

18.32 Cross ravine 27 lks. wide course SE. & ascend.

18.78 Cross road from Los Angeles to Fort Yuma brs. NW. & SE.

40.00 Set temp. 1/4 sec. cor.

58.13 Top of spur brs. NE. & SW. & descend.

80.29 Int. N. & S. line 6 lks. N. of cor. to secs. 20, 21, 28, 29, from which cor. I run

N. 89° 57' W. on a true line bet. secs. 20, 29.

Va. 13° 50' E.

40.15 Set stone 15 x 11 x 7 in stone mound 4 ft. in dia. at base by 2 ft. in height for 1/4 sec. cor.

80.29 The cor. to secs. 19, 20, 29, 30.

Land mountainous, soil 3d rate.

Timber & undergrowth of pine, oak and chaparral.

West on a random line bet. secs. 19, 30.

Va. 13° 50' E.

Ascend.

40.00 Set temp. 1/4 sec. cor.

55.83 Int. W.B. of Tp. 74 lks. N. of cor. to secs. 19, 30, 24, 25, from which cor. I run

N. 89° 11' E. on a true line bet. secs. 19, 30.

Va. 13° 50' E.

15.83 Set stone 14 x 9 x 6 in earth mound 4 ft. in dia. at base by 2 ft. in height and dug pit 24 x 18 x 12, 8 lks. N. for 1/4 sec. cor.

55.83 The cor. to secs. 19, 20, 29, 30.

Land mountainous, soil 3d rate.

Timber & undergrowth of pine, oak and chaparral.

North bet. secs. 19 and 20.

Va. 13° 50' E.

Ascend.

- 14.21 Top of spur brs. NW. & SE. & descend.
- 32.00 Cross road from Los Angeles to Fort Yuma brs. N. 18° W. & S. 18° E.
- 40.00 Set post 4 in. dia. 1 ft. in earth 1 ft. above earth mound 4 ft. in dia. at base by 2 ft. in height and dug pit 24 x 18 x 12, 8 lks. E. for 1/4 sec. cor., from which brs. a

White oak 15 in dia. S. 52° E. 50 lks. dist.

Live oak 26 in. dia. S. 38° W. 31 lks. dist.

- 46.15 Cross road from Los Angeles to Fort Yuma brs. N. 26° E. & S. 26° W.

52.27 A Live oak 15 in. dia.

- 65.27 Int. Bdy. line of Rancho Valle de San Jose 17.45 chs. S. 36° W. of cor. No. 16, and set post 4 in. sq. 1 ft. in earth 1 ft. above earth mound 4 1/2 ft. in dia. at base by 2 ft. in height and dug pits 24 x 18 x 12, 8 lks. dist. at 4 angles for closing cor. to secs. 19 and 20, from which brs. a

Live oak 18 in. dia. S. 42° E. 52 lks. dist.

Land mountainous, soil 5d rate.

Timber & undergrowth of pine, oak and chaparral.

From SW. cor. of Tp. 1 run

N. 17 1/2° E. on a random line bet. secs. 36 and 31.

Va. 13° 50' E.

- 40.00 After diligent search, being unable to find old cor., I set temp. 1/4 sec. cor.

- 84.00 To a point 59 lks. E. of old cor. to secs. 19, 30, 24, 25, from which cor. I run

S. 17° 46' W. on a true line bet. secs. 36 and 31.

Va. 13° 50' E.

- 42.00 Set stone 12 x 9 x 6 in earth mound 4 ft. in dia. at base by 2 ft. in height and dug pit 24 x 18 x 12, 8 lks. E. for 1/4 sec. cor.

- 84.00 The cor. to Tps. 11 & 12 S. Rs. 3 & 4 E.

Land mountainous, soil 5d rate.

Timber & undergrowth of oak and chaparral.

Oct. 5, 1880

A. P. HANSON.

Vol. 175-3

Ed Fletcher Papers

1870-1955

MSS.81

Box: 43 Folder: 9

**Business Records - Field Notes - Township
11 S., Range 4 E., San Bernardino Meridian**



Copyright: UC Regents

Use: This work is available from the UC San Diego Libraries. This digital copy of the work is intended to support research, teaching, and private study.

Constraints: This work is protected by the U.S. Copyright Law (Title 17, U.S.C.). Use of this work beyond that allowed by "fair use" requires written permission of the UC Regents. Permission may be obtained from the UC San Diego Libraries department having custody of the work (<http://libraries.ucsd.edu/collections/mscl/>). Responsibility for obtaining permissions and any use and distribution of this work rests exclusively with the user and not the UC San Diego Libraries.