

Deed Recorded in Book 434, page 16

Recorded January 10, 1908.

D

We, the undersigned, owners of land on the Tia Juana River in the County of San Diego, State of California, hereby petition Southern California Mountain Water Company, a corporation, to continue the construction of its water works for the diversion of the water of the Pine and Cottonwood Creeks in said County, and we hereby grant to the said Southern California Mountain Water Company the right to construct dams across said creek or across either of said creeks and to divert the water of said creek by means of dams and conduits it may construct to the City of San Diego and to the lands between the Pacific Ocean and the said Cottonwood Creek and hereby relinquish so much of our riparian rights in and appurtenant to said land as may be affected by the diversion of said water.

Wm. Lane,
Levi I. Ware,
George Belcher,
Voltaire Averill,
J V Tavan,
W B Evans
H W George
J T Schultz
J H Cook
D S Lynchberg
D Anderson
Emma Gauteraux
W E Shaffer
J P Christensen
L A Blochman
V Bruschi
John Long
Phoebe Lewis Flint
Eisen Mayer F & P Co
W H Holderness

DATA REGARDING PROPOSED MARRON RESERVOIR
AND CONDUIT SYSTEM

Compiled by G. H. Lee,

May 6, 1915.

Jacob Busch
 J A McCan
 John Schussler
 Louie Bacthioni "X" his mark
 E K Drew
 F E Thomas
 N J Peavy
 T Jensen
 Joseph Poggi
 John Samanga
 Lorenzo Samanga
 F W Wadham
 J P Patterson
 Frank Fuqua
 G W Zimmerman
 Etoile E Ballou
 J H Louden
 Catharine Lint
 F C Wade
 Frank E Wadham
 Fred H Samborn
 P Sainsevain
 C S Hardy
 John H Ferry
 Adam Buck
 Clara M Buck
 Wm Sidney Thomas
 Maud Belcher
 Mrs E M Watkins
 Mrs Elizabeth D Stewart
 W H Ward
 Mrs Ella Schussler
 A E Drew
 H A George
 Anna B Parma
 Annie M Wade
 Maria B Averill
 Mrs C B George
 H C George
 Thomas J Coy
 Teresa J Coy
 Rebecca M McKean
 Flora J Copland
 Grace Leglar Benbaugh
 Mrs Clara Johnson
 Anson Titus
 L M Titus
 W W Whitney
 Louise Smith
 Herbert Peery
 Ellen M Hitchcock

Witnesses:

Geo. Belcher
 W H Moore

ACKNOWLEDGEMENTS.

DATA REGARDING PROPOSED MARRON RESERVOIR AND CONDUIT SYSTEM.

List of Land owners in Tia Juana Valley, San Diego County, California, who deeded their riparian rights to the Southern California Mountain Water Co. The form of deed in each case was identical with that recorded January 10, 1908 in Book 434, page 16 of San Diego County land records.

Book 432, page 182.	Bay City Investment Co.
" 432, " 183.	St. Josephs Hosp. & Sanitarium
" 432, " 184.	San Diego Realty Co.
" 432, " 185.	Wm. E. Baird & P E Baird
" 432, " 185.	Russ Lumber & Mill Co.
" 432, " 186.	Abstract Title & Trust Co.
" 432, " 187.	Hanna Shaubert
" 432, " 187.	San Diego Investment Co.
" 427, " 456.	Mrs. Addie L Burgess
" 431, " 158.	Ralston Realty Co.
" 431, " 200.	D. H. Allender
" 431, " 200.	Herbert F Sherman
" 431, " 200.	E. Sherman
" 431, " 200.	E. M. Pond
" 431, " 200.	Mrs. Daisy M. Scholl
" 431, " 200.	Daisy M. Scholl, Guardian
" 431, " 200.	Herman & Ralph Scholl, Minors.
" 431, " 202.	Alphonse Friedrich
" 431, " 202.	Catharine Schussler (X her mark)
" 431, " 202.	Catharine Morgan (X her mark)
" 431, " 202.	Geo. G. Paull
" 431, " 202.	John Langley
" 431, " 202.	E J Swayne, assigner for benefit of the creditors of Cal.Mtg. & Loan Co.
" 431, " 202.	N W Douns
" 431, " 202.	W I Warner
" 434, " 94.	L N Craig
" 434, " 132.	Clara L Reynolds
" 434, " 166.	Mrs A M Eisenmayer
" 434, " 177.	F B Johnson
" 434, " 246.	Mrs Mary A. Schmid
" 434, " 259.	G N Kenney
" 434, " 279	(Sylvester Kipp H T Weiss
" 434, " 281.	G W Hale
" 433, " 216.	Dora C Brown
" 433, " 233.	Ruth A George

Balance of names to be furnished

By Mr. Makin.

Book 433,	page 233,	H W George, Rt of way for pipe line over S $\frac{1}{2}$ of SE $\frac{1}{4}$ of Sec. 24, T 18, R 2 W
" 433,	" 243,	E J Swayne
" 433,	" 283,	Robt. A Smith
" 433,	" 314,	G A Yinawine
" 433,	" 315,	F M Jennings
" 433,	" 326,	Albert Kohlhardt
" 433,	" 345,	(Chas. Vallin (Mrs Augusta Vallin
" 433,	" 356,	(Mrs Johanna Utterberg (C A Utterberg (Julia Jensen
" 433,	" 367,	John E Vince
" 433,	" 395,	Reta L Rias H M Peavey Z N Soderlund Thomas Tatten
" 331,	" 245,	San Diego Land Co., SW $\frac{1}{2}$ of SW $\frac{1}{4}$ of NE $\frac{1}{4}$ of Sec. 33, 18, 2W.
" 331,	" 321,	John Mathews
" 331,	" 375,	Walter C Brown
" 331,	" 375,	Mary J Hartley
" 331,	" 379,	D.W. Gilmore
" 331,	" 383,	F W Brown
" 331,	" 391,	(N H Conklin (Myra S Conklin
" 439,	" 6,	Herman Trobisch
" 439,	" 16,	Florence E George
" 439,	" 27,	Henry W Wilcox
" 439,	" 46,	P J Anderson
" 439,	" 59,	Martha J Barrows

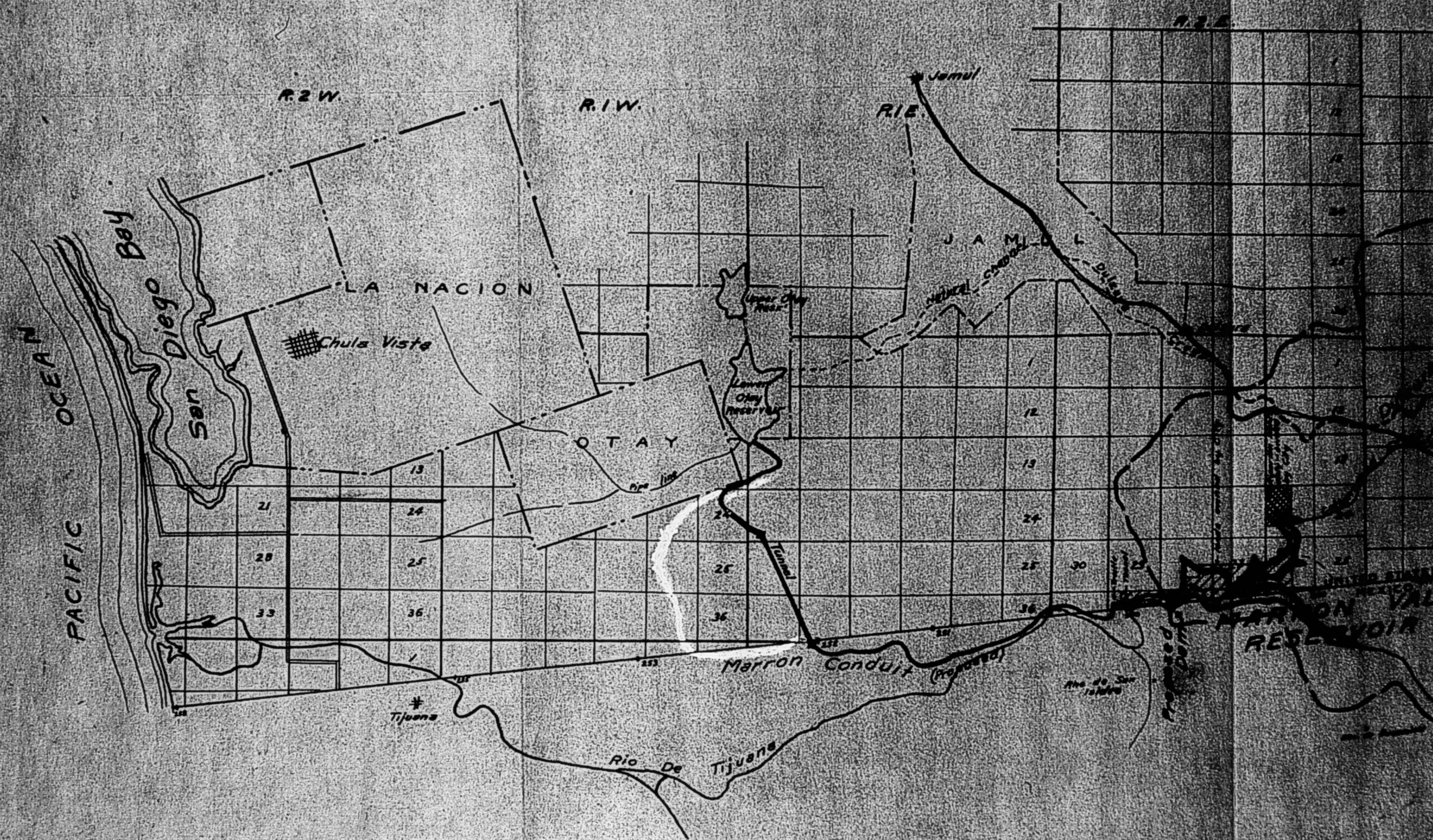

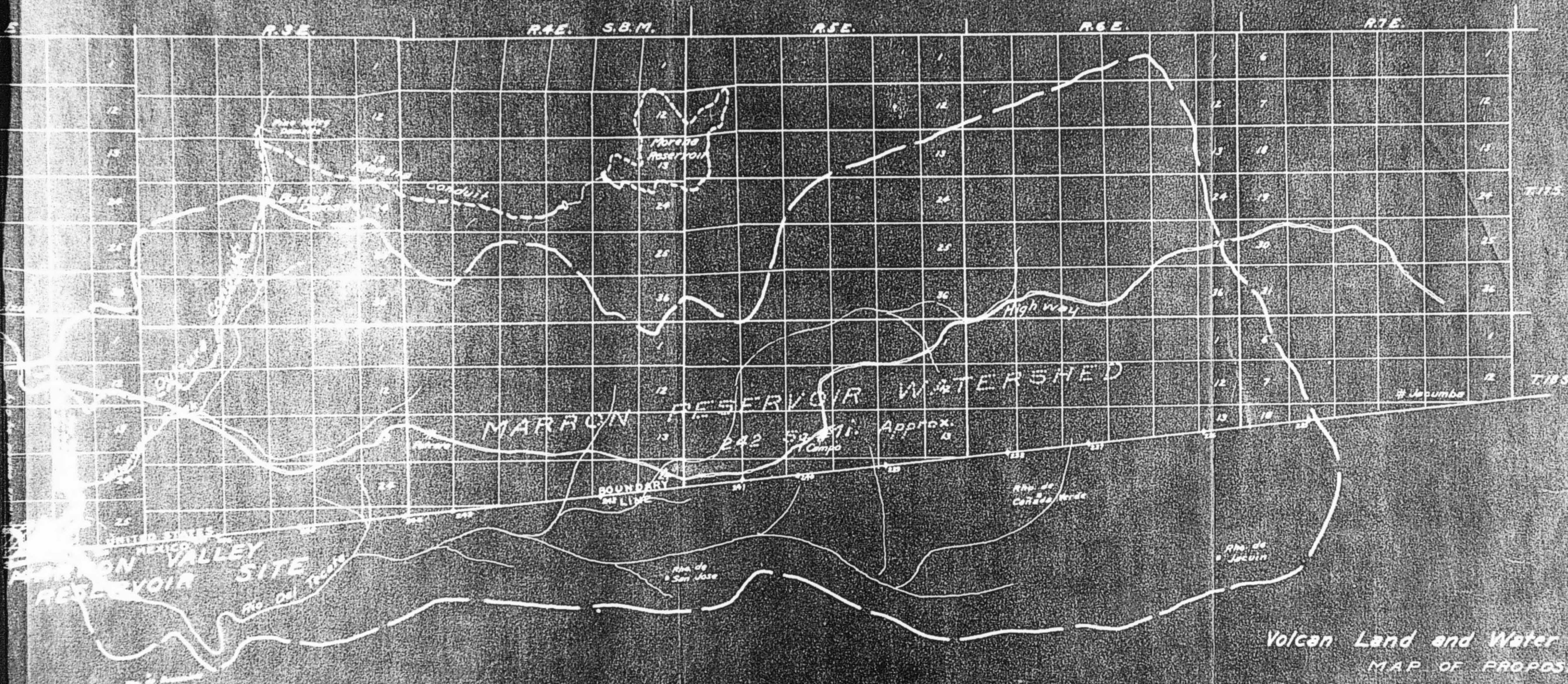

Volcan Land and Water Company
 MAP OF PROPOSED
MARRON RESERVOIR SYSTEM
 OF
 City of San Diego
 Showing Reservoir & Approximate Aqueduct Location
 SCALE: $\frac{1}{2}$ " = 1 MI.
 W.S. Post Engr. Drawing No. 510
 May 3, 1915 File No. 1-H

Marron Res. D-210 1-11

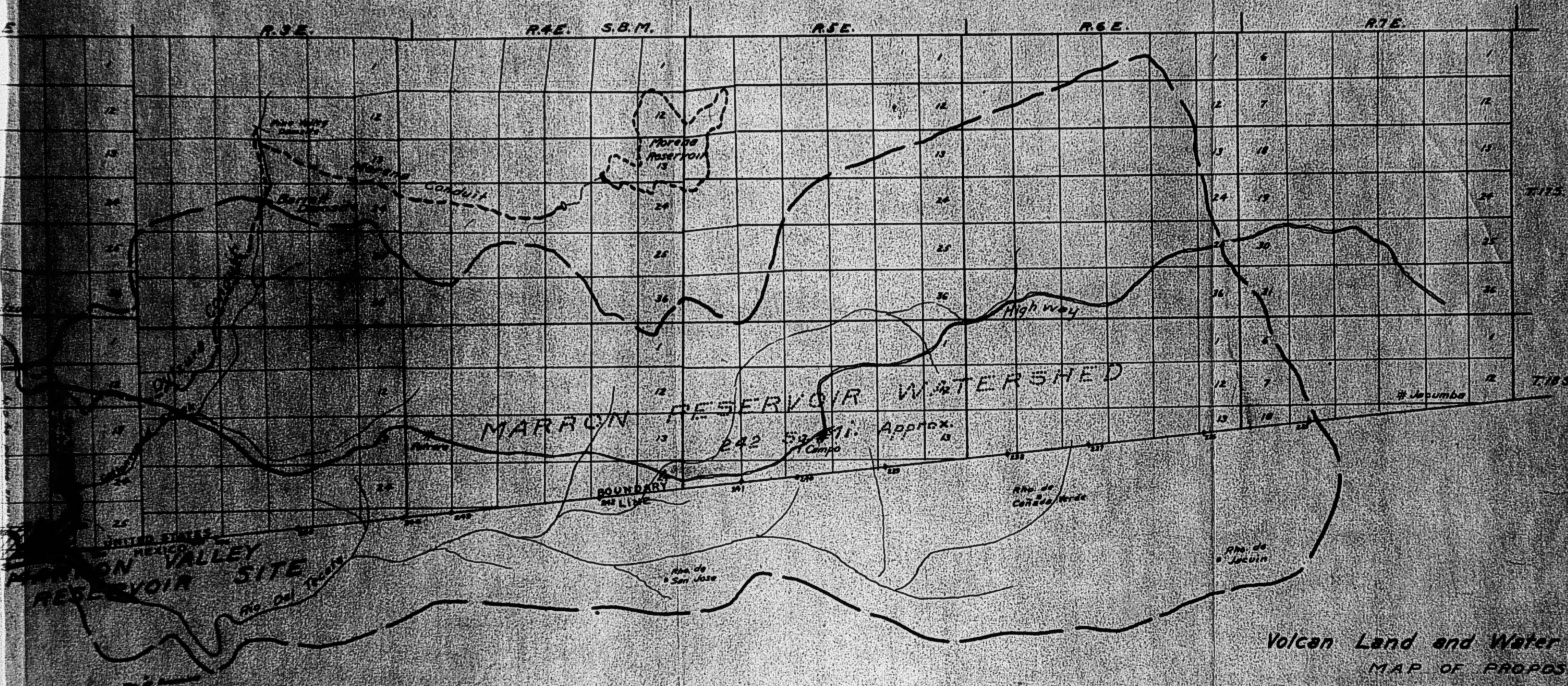

Volcan Land and Water Company
 MAP OF PROPOSED
MARRON RESERVOIR SYSTEM
 OF
City of San Diego
 Showing Reservoir & Approximate Aqueduct Location
 SCALE: $\frac{1}{2}$ " = 1 MI.
 W.S. Post Engr. Drawing No. 510
 May 5, 1915 File No. 1-H

Volcan Land and Water Company
 Drawing No. 510
 File No. 1-H

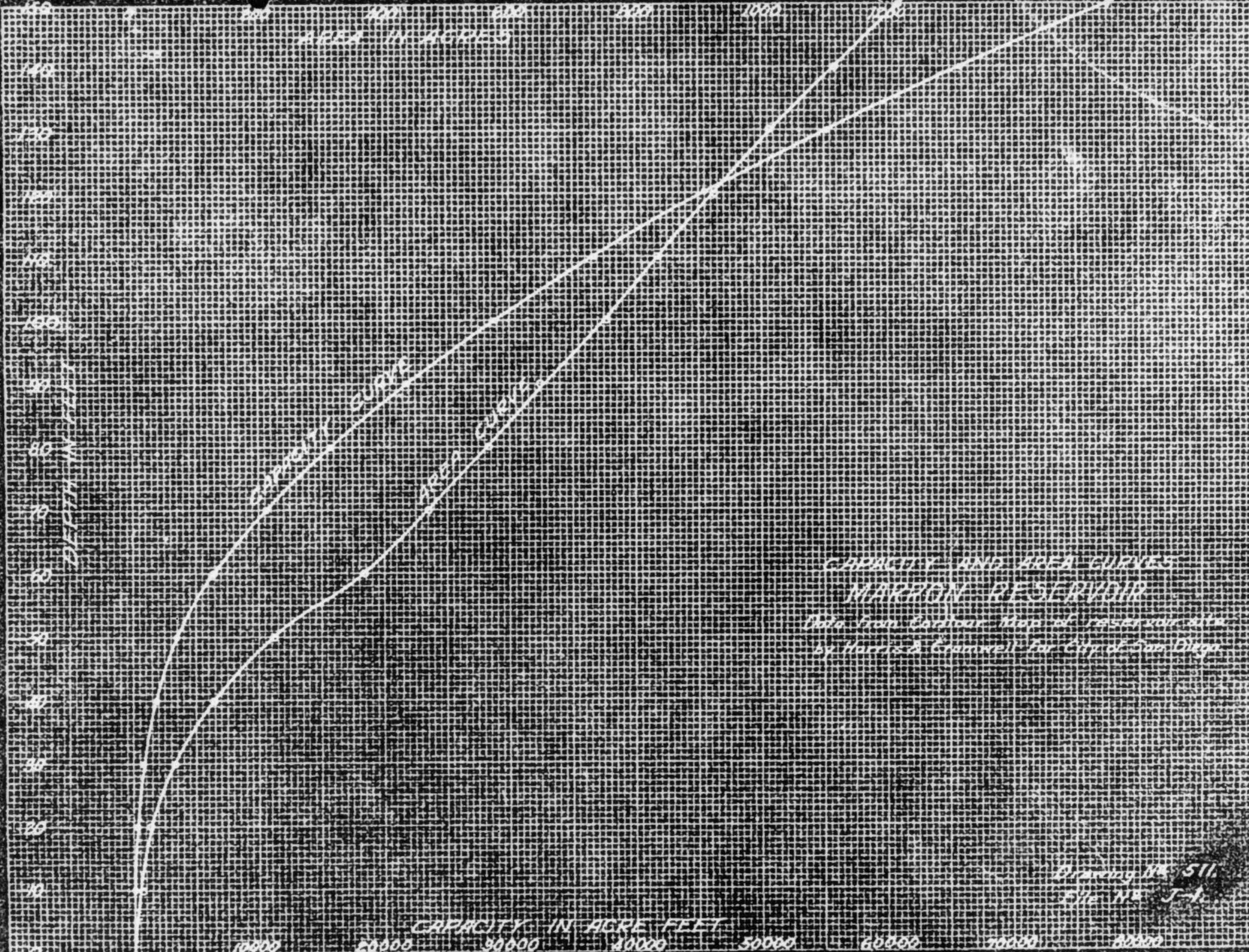

CHANGES IN AREA GUINNESS
 MARKET FOR REFINISHED

CAPACITY IN ACRE FEET

10000 20000 30000 40000 50000 60000 70000 80000

STI
 J-1

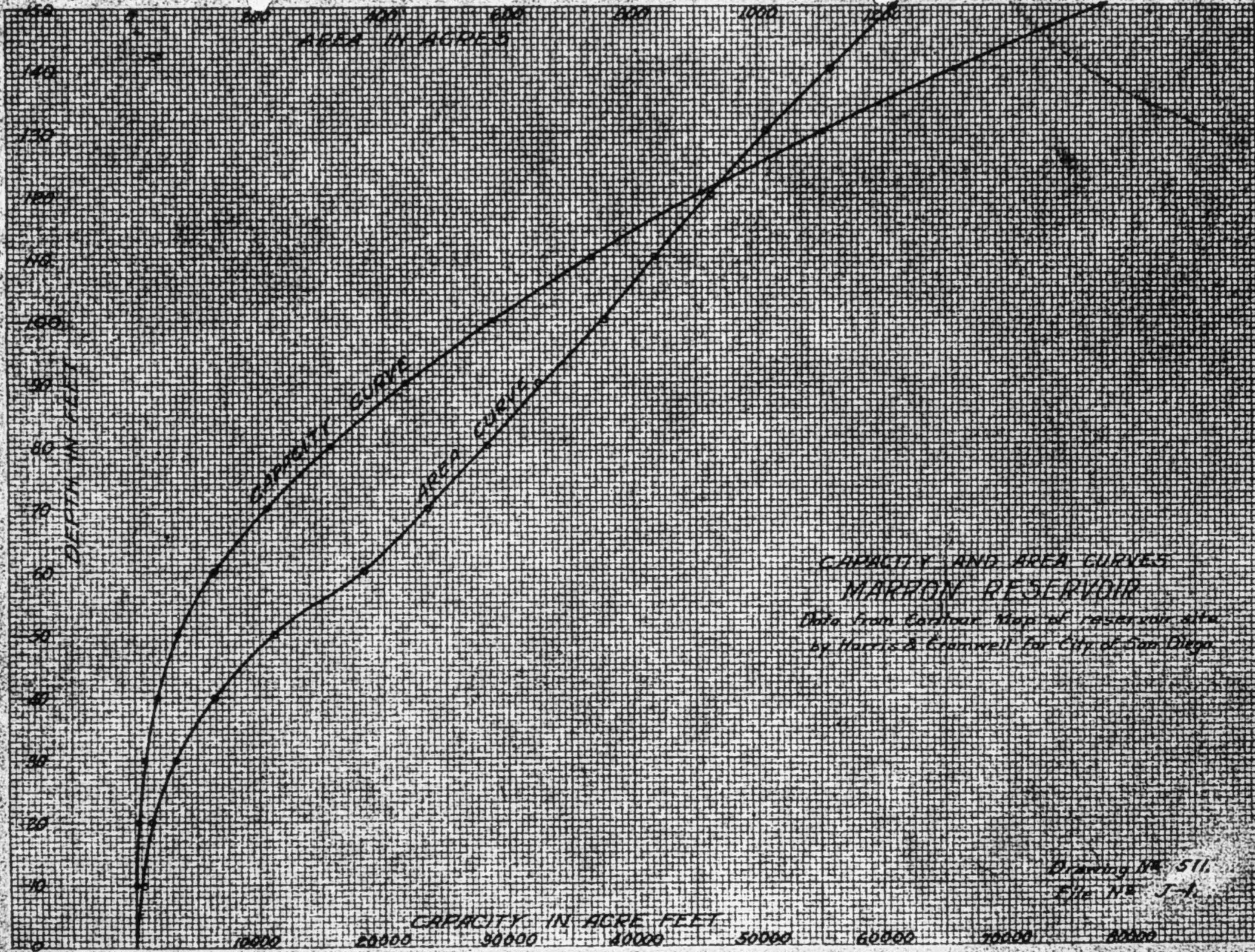

CAPACITY AND AREA CURVES
 MARRON RESERVOIR
 Data from Contour Map of reservoir site
 by Harris & Gramwell for City of San Diego

Drawing No. 511,
 File No. J-1.

DATA REGARDING PROPOSED MARRON RESERVOIR AND CONDUIT SYSTEM

Estimated safe net yield of Marron Reservoir for 110 foot dam⁺ and with Pine Valley Dam constructed.

Season	Total supply available for storage Ac. Ft.	In Storage first of season Ac. Ft.	Net evaporation Feet	Average area water surface during season Acres	Total Evapo-ration Ac. Ft.	Draft from Reservoir Ac. Ft.	Waste from Reservoir Ac. Ft.	In storage end of season Ac. Ft.
1894-5	68898	2500#	4.41	460X	2030	3000	32158	34210
1895-6	1160	34210	5.19	760	3950	3000	0	28420
1896-7	6270	28420	4.64	740	3440	3000	0	28250
1897-8	386	28250	5.18	695	3600	3000	0	22036
1898-9	193	22036	5.23	610	3190	3000	0	16039
1899-0	96	16039	5.04	515	2600	3000	0	10535
1900-01	2890	10535	4.79	465	2230	3000	0	8195
1901-02	1160	8195	5.01	320	1600	3000	0	4755
1902-03	3620	4755	4.61	230	1060	3000	0	4315
1903-04	289	4315	5.26	130	685	3000	0	919
1904-05	14130	919Ø	4.25	500	2125	3000	0	9924
1905-06	57550	9924	4.16	625	2600	3000	28234	33641
1906-07	33820	33641	4.57	790	3610	3000	27416	33435
1907-08	5550	33435	4.86	800	3890	3000	0	32095
1908-09	20930	32095	4.60	800	3680	3000	12985	33360
1909-10	8920	33360	4.78	800	3820	3000	2130	33330
1910-11	2890	33330	4.72	760	3590	3000	0	29630
1911-12	4820	29630	4.78	750	3580	3000	0	27870
1912-13	1160	27870	5.07	695	3520	3000	0	22510
1913-14	3860	22510	4.65	635	2950	3000	0	20420

+ = Proposed height of dam as stated in Sixth Annual Report of Water Department City of San Diego, page 85.

X = Reservoir filled after January 1.

Ø = In storage January 1, 1905, 0 ac. ft.

= Capacity of reservoir to 110 ft. flow line 36740 ac. ft.

DATA REGARDING PROPOSED MARRON RESERVOIR AND CONDUIT SYSTEM

 Estimated Seasonal Runoff of Tia Juana River at Marron Damsite exclusive
 of runoff at Barrett Damsite.

Assumed average runoff 40 ac. ft. per sq.mi. of drainage area.

Season	Percent seasons runoff to long term average runoff at Mor- ena Reservoir	Runoff per sq.mi. from Marron Res. drainage Ac. Ft.	Total runoff from 242 sq. mi. of Marron Res. drainage Ac.Ft.	Waste at Barrett with Pine Valley Res. in opera- tion Ac.Ft.	Total sup- ply avail- able for storage at Marron Res. Acre Feet.
1894-5	485	194	46,800	22,098	68,898
5-6	12	4.8	1,160	0	1,160
6-7	64	26	6,270	0	6,270
7-8	4	1.6	386	0	386
8-9	2	.8	193	0	193
1899-0	1	.4	96	0	96
1900-1	29	12	2,890	0	2,890
1-2	12	4.8	1,160	0	1,160
2-3	38	15	3,620	0	3,620
3-4	3	1.2	289	0	289
4-5	146	58	13,980	150	14,130
5-6	406	162	39,050	18,500	57,550
6-7	302	121	28,150	5,670	33,820
7-8	57	23	5,550	0	5,550
8-9	214	86	20,700	230	20,930
9-10	93	37	8,920	0	8,920
1910-11	29	12	2,890	0	2,890
11-12	49	20	4,820	0	4,820
12-13	12	4.8	1,160	0	1,160
13-14	41	16	3,860	0	3,860

 Average 40.0 9,597

CHL
5/5/15

DATA REGARDING PROPOSED MARRON RESERVOIR AND CONDUIT SYSTEM

Evaporation at Marron Reservoir.

Season	Percent seasons rainfall to long term observed average. Averaged for 8 San Diego County rainfall stations	Computed rainfall at Marron Reservoir Inches	Gross Evap- oration at Marron Res. Inches	Net Evaporation at Marron Res. Inches	Feet
1894-5	131	17.0	70	53.0	4.41
5-6	60	7.8	70	62.2	5.19
6-7	111	14.4	70	55.6	4.64
7-8	61	7.9	70	62.1	5.18
8-9	55	7.2	70	62.8	5.23
9-0	73	9.5	70	60.5	5.04
1900-1	96	12.5	70	57.5	4.79
1-2	75	9.8	70	60.2	5.01
2-3	112	14.6	70	55.4	4.61
3-4	53	6.9	70	63.1	5.26
4-5	146	19.0	70	51.0	4.25
5-6	155	20.1	70	49.9	4.16
6-7	116	15.1	70	54.9	4.57
7-8	89	11.6	70	58.4	4.86
8-9	113	14.7	70	55.3	4.60
1909-10	97	12.6	70	57.4	4.78
10-11	102	13.3	70	56.7	4.72
11-12	98	12.7	70	57.3	4.78
12-13	70	9.1	70	60.9	5.07
13-14	109	14.2	70	55.8	4.65

 Average 57.50 4.79

CHL
5/5/15

Ed Fletcher Papers

1870-1955

MSS.81

Box: 39 Folder: 9

**Business Records - Reports - Lee, Charles
H - "Report: Data Regarding Proposed
Marron Reservoir and Conduit System"**



Copyright: UC Regents

Use: This work is available from the UC San Diego Libraries. This digital copy of the work is intended to support research, teaching, and private study.

Constraints: This work is protected by the U.S. Copyright Law (Title 17, U.S.C.). Use of this work beyond that allowed by "fair use" requires written permission of the UC Regents. Permission may be obtained from the UC San Diego Libraries department having custody of the work (<http://libraries.ucsd.edu/collections/mscl/>). Responsibility for obtaining permissions and any use and distribution of this work rests exclusively with the user and not the UC San Diego Libraries.